

FEEL THE HEAT!

Revision No: 00
Revision Date: 5-20-2019

Front Bumper - Winch Compatible

Part # **01-1807 or 01-1808** Polaris RZR XP1000 Black

BRACKET KIT 01-1811 REQUIRED FOR Polaris RZR Turbo S Fitment

The Sport front bumper is built for protection in any riding situation. The compact and lightweight design is race inspired and designed for easy installation. With integrated winch compatibility, light mounting tabs and a skid plate, this bumper is a great solution for protecting the front of your Polaris RZR.

Be sure to check out the full line of DragonFire Accessories for your Polaris vehicle at your local authorized dealer or online at <http://www.DragonFireRacing.com>



WARNING

- Read and understand these instructions before installing product
- This product does not provide roll over protection
- Ensure doors are securely latched and locked prior to operating vehicle
- Do not use product if there are any signs of damage

Disclaimer

Off road activities can be hazardous and could lead to injury, dismemberment, paralysis and death. No warranty of representation is made as to the products ability to protect the user from any injury or death. The user assumes that risk. The acceptance and /or use of this merchandise purchased from DragonFire by the customer hereby shall release DragonFire from any and all liability pertaining to the use of such merchandise.

Pre-installation: Lay out components and compare to list and images. Images may not portray the full detail or exact shape of the parts; however, they represent parts that have same or similar function.

Refer to DragonFire Racing Website for ensure that you have the latest revision of instructions & templates.

Tools Required

19mm Wrench or Socket
17mm Wrench or Socket
5mm Allen Wrench or Bit
6mm Allen Wrench or Bit
Ratchet
Magnetic Picker (Below)
T28 Torx
T25 Torx



Part & Hardware List

ITEM	QTY	SIZE	LENGTH	TYPE	STEP USED
P1	1	-	-	Upper Mount Gusset Plate	7
P2	1	-	-	Lower Nut Plate	4
P3	1	-	-	Upper Nut Plate	5
P4	2	10MM	30MM	Hex Bolts	8
P5	2	10MM	-	Flat Washers	8
P6	1	8MM	20MM	Socket Head Bolt	4
P7	2	10MM	-	Lock Washers	8
P8	2	12MM	30MM	Hex Bolts	6, 6A
P9	2	12MM	-	Flat Washers	6, 6A
P10	2	12MM	-	Lock Washer	6, 6A
P11	1	8MM	20MM	Button Head Bolt	6, 6A
P12	2	10MM	-	Hex Bolt/Washer/Lock Washer	7
	1	-	-	Bumper with Skid Plate	

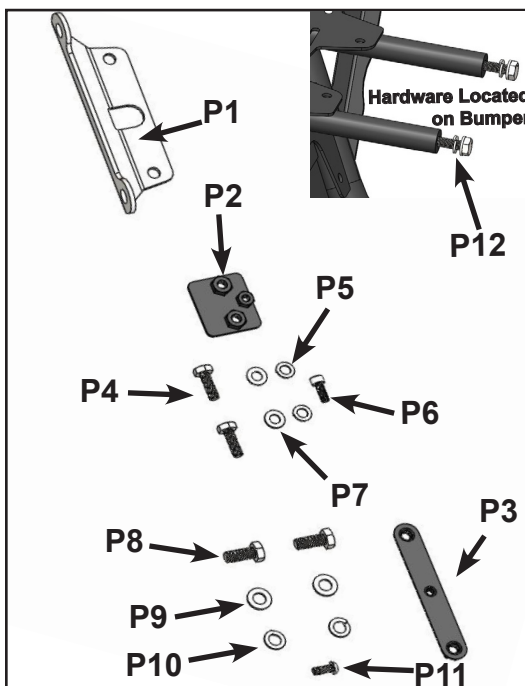

Note: An assistant may be needed to hold the product in place during installation.

Step 1: Place vehicle on a flat and level surface. Place gear selector in “Park” and remove keys from the ignition.

Step 2: Read through the instructions before starting.

Step 3: Remove front grille and front plastic cover (FIGURE A & B) for access. Remove front plastic trim screws (FIGURE C) Use an object to wedge out the front plastics from the frame to create better access to install upper nut plate. (FIGURE D)

Step 4: Remove factory front tow/tie down hook if applicable. Locate Lower Nut Plate (P2) and hold it behind lower front frame chassis while inserting a magnetic picker tool through top hole of frame (FIGURE E) and attach it to the top of the nut plate. Now slowly lower the nut plate down until it aligns with the frame holes. (FIGURE F) While holding in place, install retainer bolt (P6) to hold nut plate in place. NOTE: For Turbo S Models only install retainer bolt (P6) through the spacer plate and then into the nut plate. (FIGURE G)

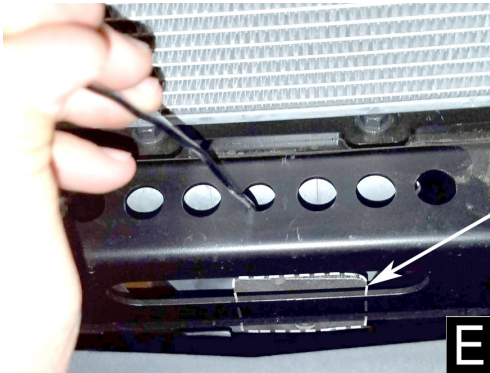
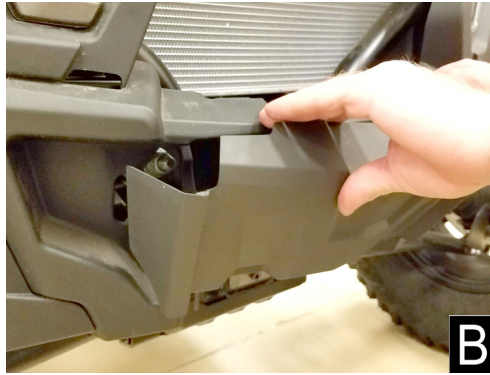
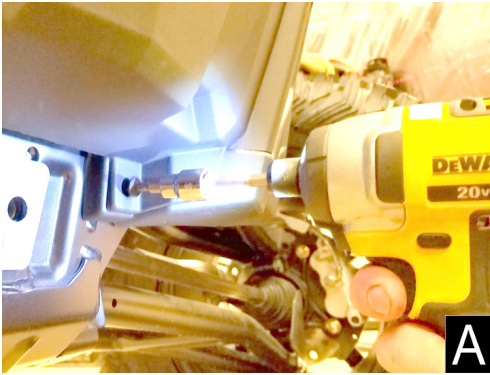

Step 5: Locate Part (P3 - Upper Nut Plate) and slide bracket in from front of frame opening (FIGURE H) and place on underside of cross support bracket on frame of vehicle just in front of the radiator. Install center retainer bolt (P11) through hole in cross support to retain Lower Nut Plate in place. (FIGURE I)



Step 6: If your vehicle is a RZR Turbo S Model Use Step 6A. For all other models install (P1 - Upper Gusset Plate) behind existing frame support aligning holes (FIGURE J). Install both hex bolts (P8) including a Lock Washer (P10) and Flat Washer (P9) into lower mounting holes on gusset plate. Keep bolts finger tight until remainder of installation is complete.

Step 6A: RZR Turbo S Model Only - Locate gusset plate from 01-1811 Turbo S Mount Kit (Sold Separately) and install using both hex bolts (P8) including a Lock Washer (P10) and Flat Washer (P9) on each. Keep bolts finger tight until remainder of installation is complete. (FIGURE K)

Step 7: Remove the two Bolts, Lock and Flat Washers (P12) that are threaded into the mounting bungs on the bumper. Now that the bolts are removed from the bung mounts, align front bumper mounts to the Upper Mount Bracket (P1) holes. (FIGURE L) and thread in the bolts you just removed from gusset plate and factory frame and thread them into the bung mounts on the bumper. Keep finger tight until all mounting is complete.

Step 8: Locate the two Hex Bolts (P4) and the two Lock Washers (P5) and the two Flat Washers (P7). Pre assemble the hardware with the Lock Washer first followed by the Flat Washer. Install this hardware through the lower mount plate on the front bumper. (FIGURE M).

Step 9: Ensure bumper is correctly aligned to vehicle by visual check. The bumper purposely has some tolerance to allow for minimal adjustment for better alignment to your front plastics and frame. Tighten all hardware when bumper is aligned to your liking.

WINCH MOUNTING: For winch installation and mounting, remove the skid plate to allow for access to bolt in winch. Reinstall skid plate, followed by fairlead Bumper will also accommodate factory mounted winch (in frame) with fairlead mounted to skid plate. This bumper accepts a fairlead mounting 6" to 6.5" wide and a winch mounting pattern of 2.82" to 3.17" tall by 6.56" wide.

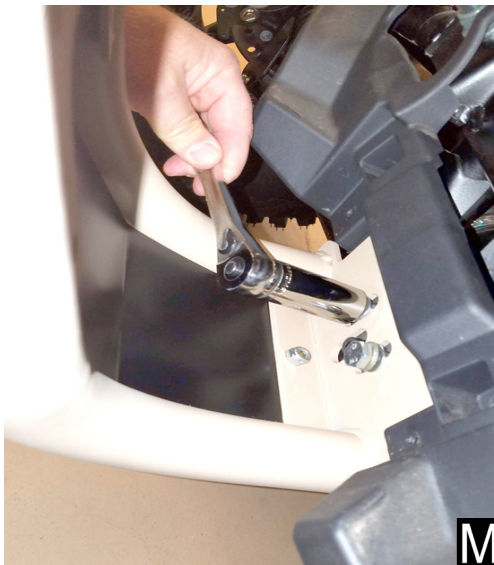
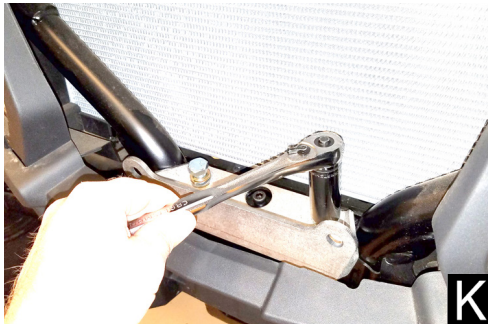
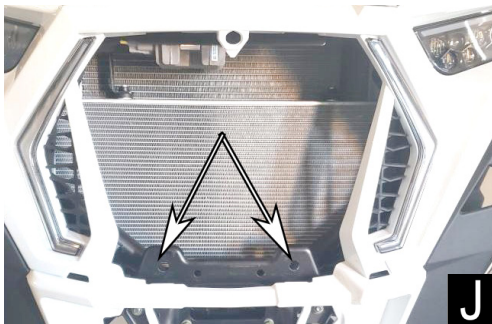

ProTip: Periodically check all hardware and re-tighten if needed.

For further assistance please contact us at customerservice@dragonfireracing.com or 1-800-708-9803.