

EN INSTALLATION MANUAL REAR BUMPER

DE MONTAGEEINLEITUNG

RU ИНСТРУКЦИЯ ПО УСТАНОВКЕ ЗАДНЕГО БАМПЕРА



For: Polaris Ranger XP 1000/ CREW 1000 (2018-)

444.7464.1
2444.7464.1



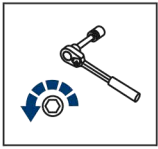

EN Regular fasteners
DE Originale montageteile
RU Штатный крепеж

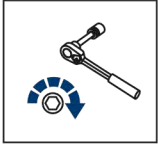

EN Regular fasteners
DE Originale montageteile
RU Штатный крепеж

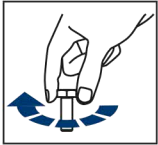

EN Screw a several turns
DE Für wenigen Umdrehungen befestigen
RU Вкрутить на несколько оборотов



EN Loosen bolts
DE Bolzen lockern
RU Выкрутить на несколько оборотов

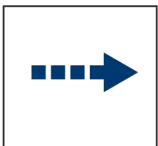

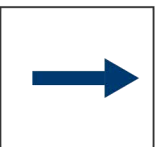

EN Movement Arrow
DE Bewegungsrichtung
RU Движение



EN Location/Position Arrow
DE Anordnung/Positionsrichtung
RU Расположение

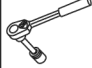
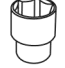

EN Screw Arrow
DE Drehungsrichtung
RU Поворот

 <p>EN Ratchet DE Ratsche RU Трещётка</p>	 <p>S - 10; S - 13</p>	 <p>HEX S - 5</p>	 <p>EN Office Knife DE Büromesser RU Канцелярский нож</p>
--	---	--	---

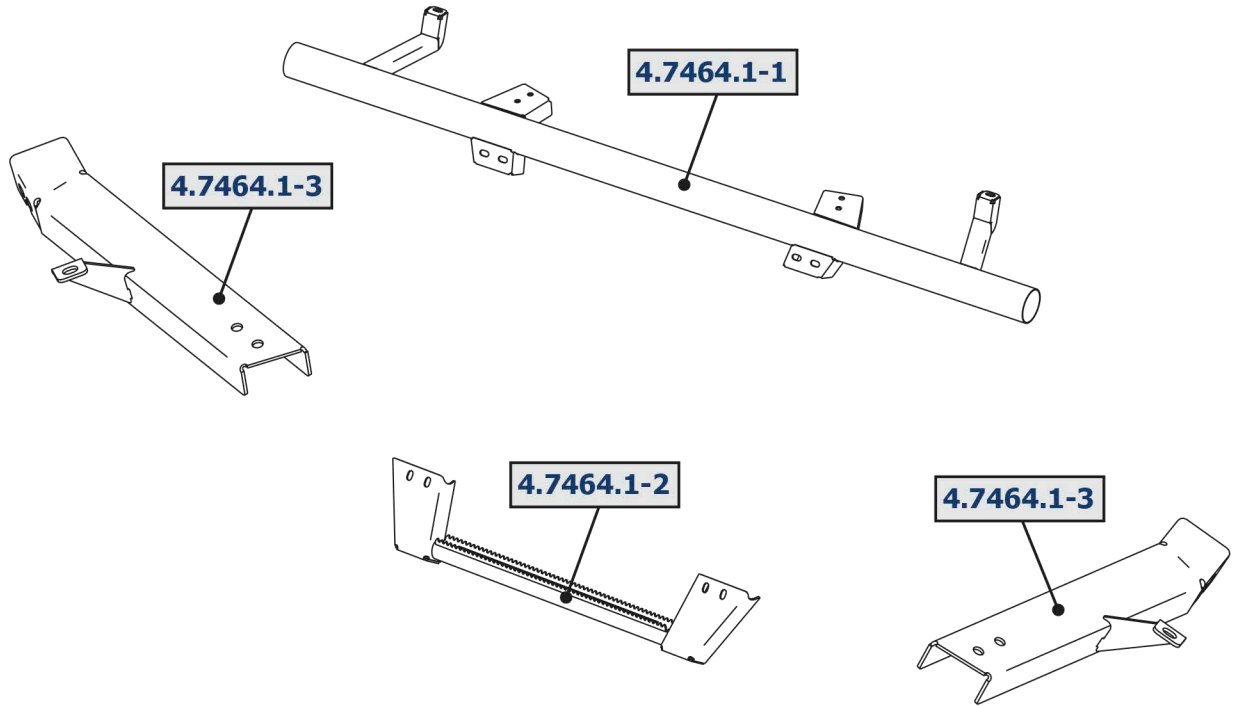

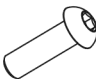
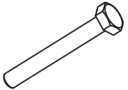
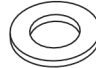
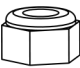
<p>1</p>  <p>M8x20 x10</p>	<p>2</p>  <p>M8x80 x4</p>	<p>3</p>  <p>Ø8 x26</p>	<p>4</p>  <p>Ø8 x12</p>		
--	---	---	---	--	--

