



RAVEK

POLARIS RANGER XP 1000 2025+

*GEN3 SPEAKEASY
TURN SIGNAL KIT*

WITH WHITE RUNNING LIGHTS



INSTALLATION INSTRUCTIONS

Part #: 64-1008SL Fitment: POLARIS RANGER XP 1000 2025+

TOOLS NEEDED:



Push Pin
Pliers



Pick



4mm Allen
Wrench



5mm Allen
Wrench



Ratchet



10mm
Socket



10mm
Wrench



Wire Fish*

PARTS INCLUDED:

- Controller (1x)
- Insert with Apex Light (2x)
- Horn (1x)
- Power Harness (1x)
- Turn Lever (1x)
- License Plate Bracket (1x)
- Dash Indicator Harness (2x)
- Wireless Receiver (1x)
- Input Harness (1x)
- Output Harness (1x)
- M6 Flat Washer (2x)
- M6 x 1.0 x 10mm Allen Screw (4x)
- M6 x 1.0 x 16mm Allen Screw (2x)
- Adhesive Promoter Wipe (1x)
- Rubbing Alcohol Wipe (1x)

Notice: This device complies with part 15 of the FCC Rules. Operation is subject to the following two conditions: (1) This device may not cause harmful interference, and (2) this device must accept any interference received, including interference that may cause undesired operation.

BEFORE YOU BEGIN — INSPECT YOUR KIT

Verify all components listed in the What's in the Kit section and Parts Addendum are present and undamaged before starting. If anything is missing or damaged, stop and contact RAVEK at 1-855-617-2787 before proceeding. Proceeding with installation constitutes acknowledgment that all components were received and inspected. RAVEK cannot be held responsible for incomplete installations resulting from uninspected or unreported missing components.

⚠ STREET LEGAL NOTICE

Installation of a RAVEK Turn Signal Kit does not automatically authorize your UTV / side-by-side for on-road use. Street-legal requirements for UTVs vary significantly by state, county, and municipality — and in some jurisdictions, no amount of added equipment qualifies a UTV for public road operation. It is the sole responsibility of the user to verify local requirements before operating on any public roadway.

INSTALLATION VIDEO GUIDE

SCAN CODE FOR VIDEO WALKTHROUGH:



1

DISCONNECT BATTERY

1

- Before you begin the installation, disconnect the battery to prevent any electrical damage.
- Tilt the passenger seat forward to gain access to the battery tray located underneath the seat:
 - 2-door models: the battery is beneath the front passenger seat.
 - 4-door models: the battery is beneath the rear passenger seat.
- Once the seat is tilted forward, remove the battery tray to fully expose the battery and create enough working space for disconnecting the terminals.
- Using a **10 MM WRENCH**, disconnect the battery terminals in the proper sequence:
 - Remove the negative (ground) cable first to eliminate the risk of grounding the system.
 - Then remove the positive cable to fully isolate the battery from the vehicle's electrical system.
 - Following this order helps prevent accidental sparks or short circuits.
- For visual reference during this step, see [FIGS. 1A & 1B].

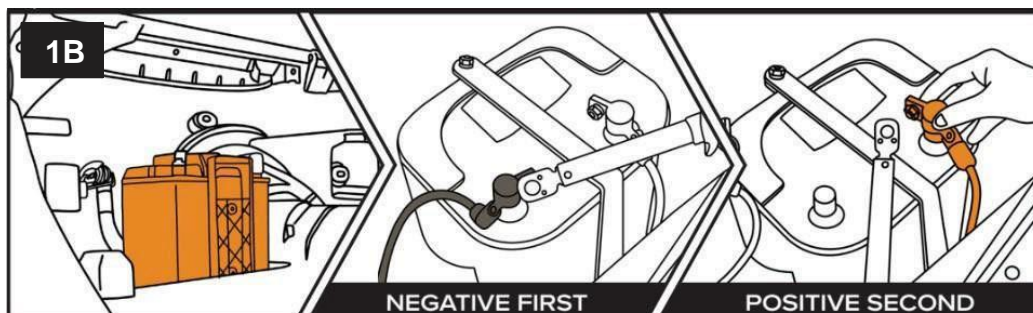
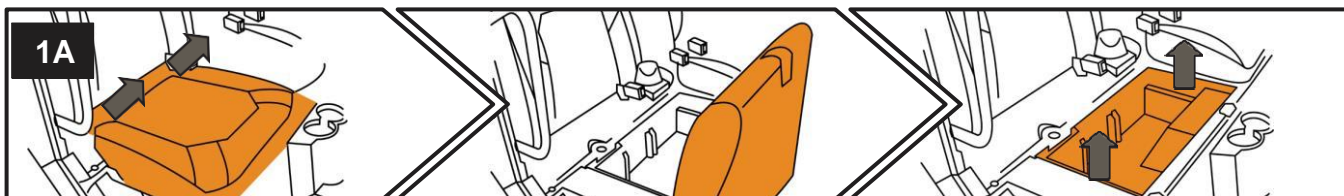

SCAN FOR TECH TIP



- Move to the front of the machine to access the hood area.
- Locate the two twist-lock knobs that secure the hood in place.
- Release both twist-lock knobs by turning them counterclockwise until they disengage.
- Once unlocked, slide the hood forward to disengage it from the front mounting points.
- With the hood fully released, lift it upward and remove it completely from the machine to open the front access area see FIG. 1A for visual guidance.

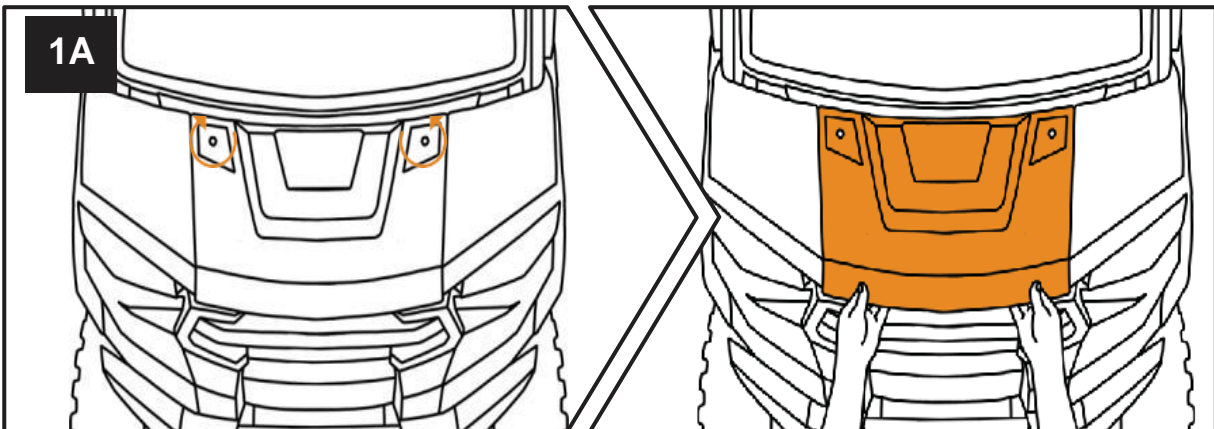

2

- With the hood removed, move to the area under the hood to mount the RAVEK turn signal controller.
- Identify a flat, clean mounting surface beneath the hood where the RAVEK controller can be securely installed.
- Prepare the surface by first wiping it down with the supplied alcohol wipe to remove dust, debris, or grease.
- After cleaning, apply the adhesive promoter to the same area to ensure maximum adhesion.
- Allow the prepared surface to dry completely before proceeding.
- Once dry, mount the RAVEK turn signal controller using the double-sided tape pre-installed on the RAVEK controller, pressing firmly to secure it in place as shown. SEE FIG. 2A for visual guidance.

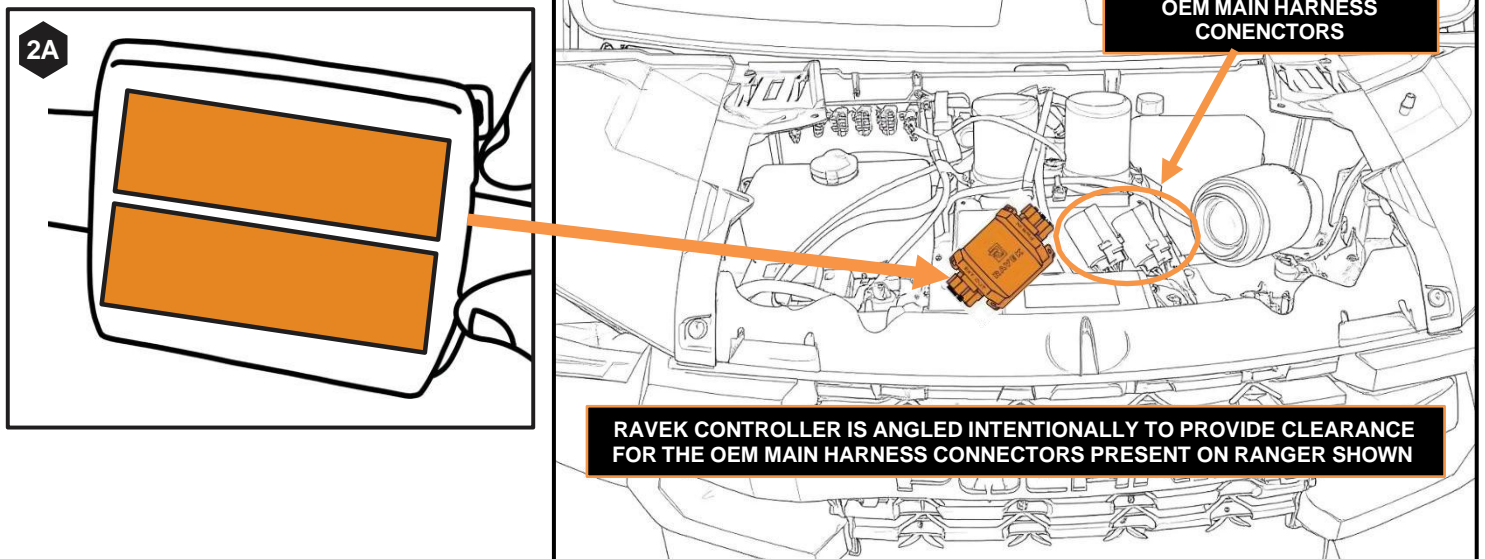

3

- Under the hood, locate the pulse bar where accessory power connections are made.
- Identify an open power port on the pulse bar and remove the dummy plug that is currently installed.
 - A **SMALL FLATHEAD SCREWDRIVER** may be helpful for gently prying the dummy plug out.
- After the dummy plug is removed, take the supplied power harness from your kit and plug it into the now-open port on the pulse bar.
 - SEE FIG. 3A & DIAGRAM A for visual orientation.
- Next, follow the opposite end of the power harness and connect it to the wire labeled “POWER” coming from the RAVEK turn signal controller.
 - SEE FIG. 3B & DIAGRAM A to ensure correct identification and routing.

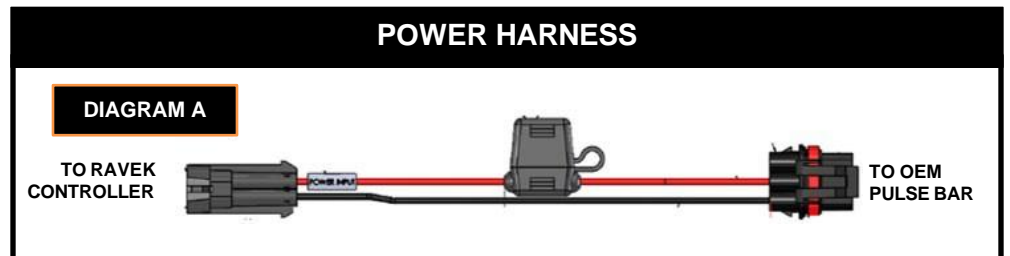
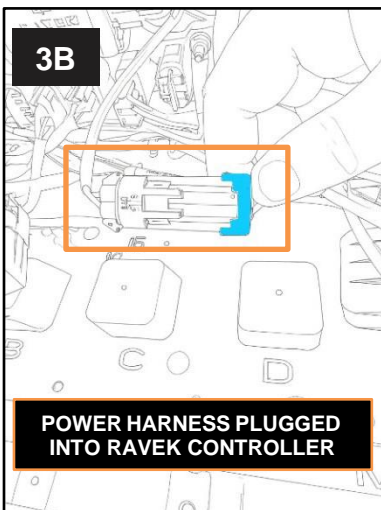
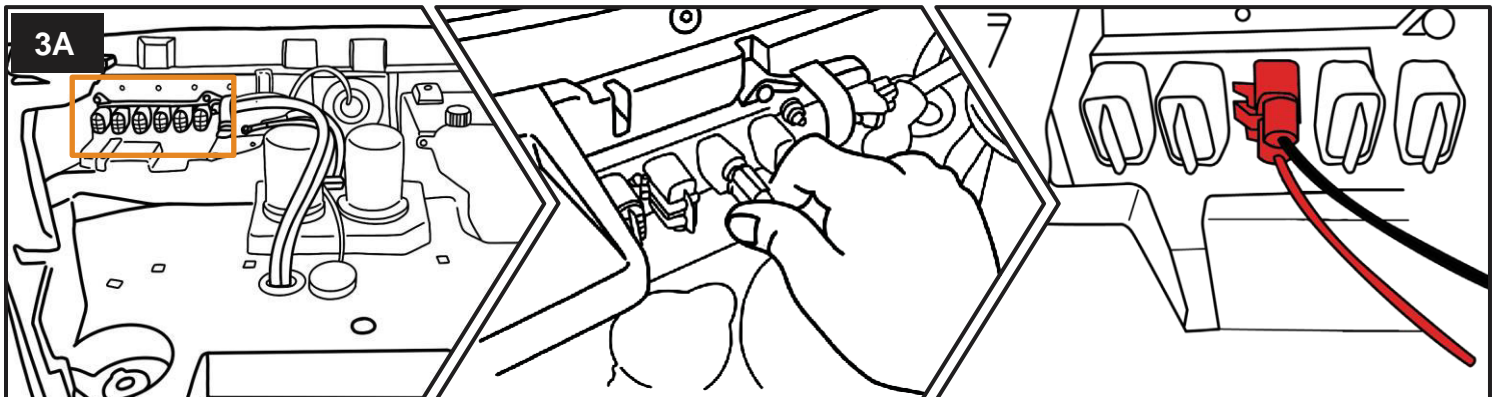

4

- Move to the dash area of the Ranger to access the switch panel.
- Using a pair of **PUSH-PIN PLIERS**, remove the two push pins located underneath the switch panel, see FIG. 4A for visual guidance.
- Once both push pins are removed, gently pull the switch panel outward from the dash to create an opening.
- Allow the switch panel to hang in place—there is no need to disconnect any rocker switches or fully remove the panel from the machine.
- This step is done solely to provide easier access for routing wiring from the front of the machine into the dash area in the upcoming steps.

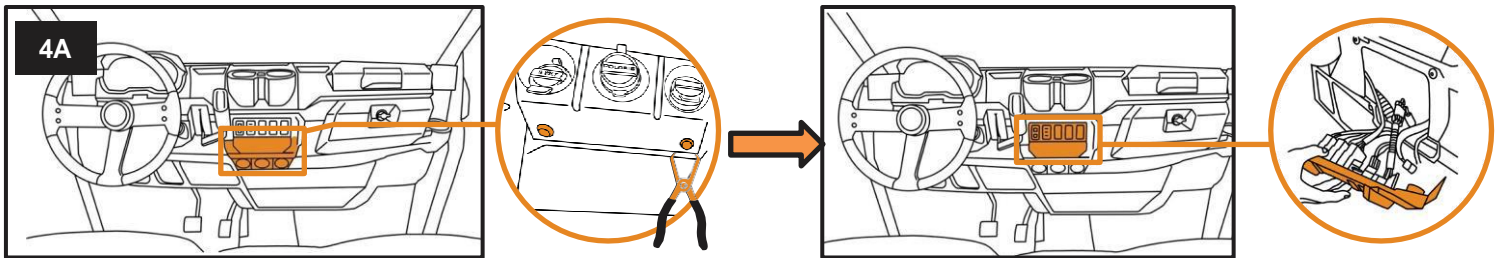

5

- Move to the dash area of the Ranger to access the gauge cluster.
- Using **PUSH-PIN PLIERS**, remove the two push pins located at the top of the gauge cluster see FIG. 5A for visual reference.
- After removing both push pins, gently pull the gauge cluster outward from the dash to expose the connector behind it.
- Carefully unplug the connector from the back of the gauge cluster to fully free it.
- **NOTE:** Unplugging the gauge cluster requires moderate thumb pressure to release the OEM tab. **Scan Tech Tip QR code below for guide on cluster plug release.**

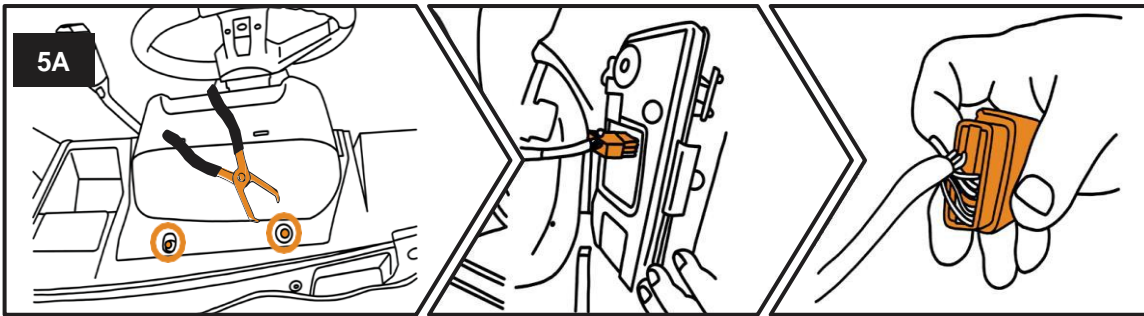

SCAN FOR TECH TIP



6

- Grab the dash indicator harnesses included in your kit, see FIG. 6A.
- Plug each harness into the correctly labeled ports on the turn signal controller (see **Turn Signal Kit Wiring Diagram in Page 24 & 25 for reference**):
 - RIGHT TURN (controller) → RIGHT TURN (dash indicator harness) see FIG. 6B.
 - LEFT TURN (controller) → LEFT TURN (dash indicator harness) see FIG. 6C
- Once both harnesses are connected, route the yellow wires with pins on the ends forward toward the firewall grommet; Wiring Diagram in Page 24 & 25 shows firewall grommet location.
- Feed the wires through the firewall grommet and into the dash area.
 - Using a wire fish can help, but it is not required—the wires can be fed through by hand.
- Continue routing the wires up toward the gauge cluster opening, ensuring they are not pinched, strained, or routed near moving components.
- This routing is necessary because, in the next step, you will connect the DI wires to the OEM gauge cluster connector, which enables proper dash indicator functionality.

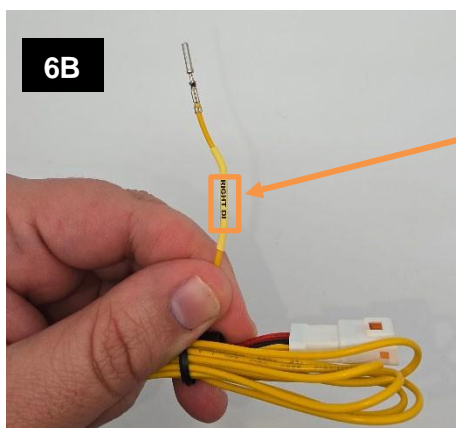

RIGHT DI

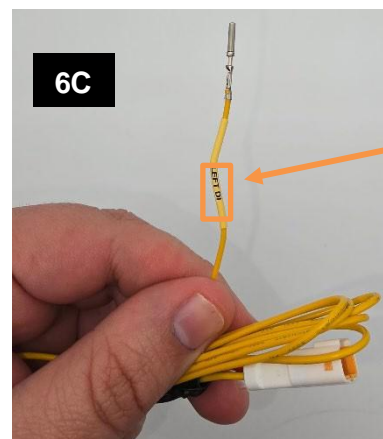

LEFT DI

7

- Using a **PICK TOOL**, release the locking tabs on both sides of the gauge cluster connector cover. See FIG. 7A.
- Carefully pry the cover upward until it loosens, then remove it completely from the connector see FIG. 7A for visual guidance.



8

- From the rear side of the connector, use a **SMALL FLATHEAD SCREWDRIVER** or **PRY TOOL** to gently open the connector housing.
- This will allow you to access the wires entering the gauge cluster connector.
- Locate Pins 6 and 7 inside the connector—these positions are clearly labeled on the connector body for easy identification.
- Using a **PICK TOOL**, carefully remove the plastic pin inserts from both Pin 6 and Pin 7 to prepare these locations for the new terminals, see FIGS. 8A & 8B for proper pin identification and orientation.

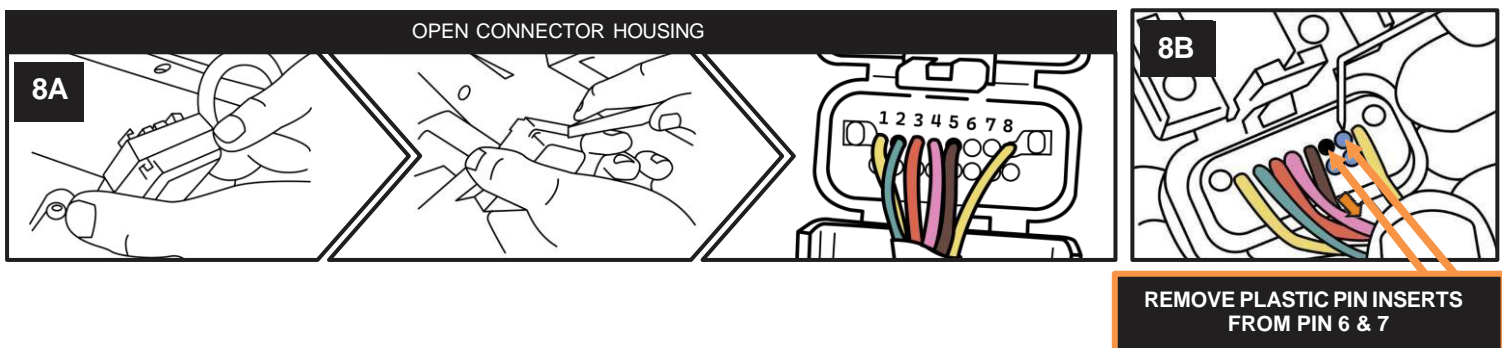

9

- Take the provided RIGHT DI wire and insert its terminal from the wire side of the connector into Terminal 6.
 - Push the pin inward until it is fully seated and sits evenly aligned with the surrounding terminals. SEE FIG. 9A
- Next, take the provided LEFT DI wire and insert its terminal from the wire side of the connector into Terminal 7.
 - Again, push the pin in until it is fully locked in place and aligned evenly with the other pins. SEE FIG. 9A
- After both DI wires are inserted and properly positioned, reinstall the connector cover by pressing it down until it snaps securely into place. SEE FIG. 9B

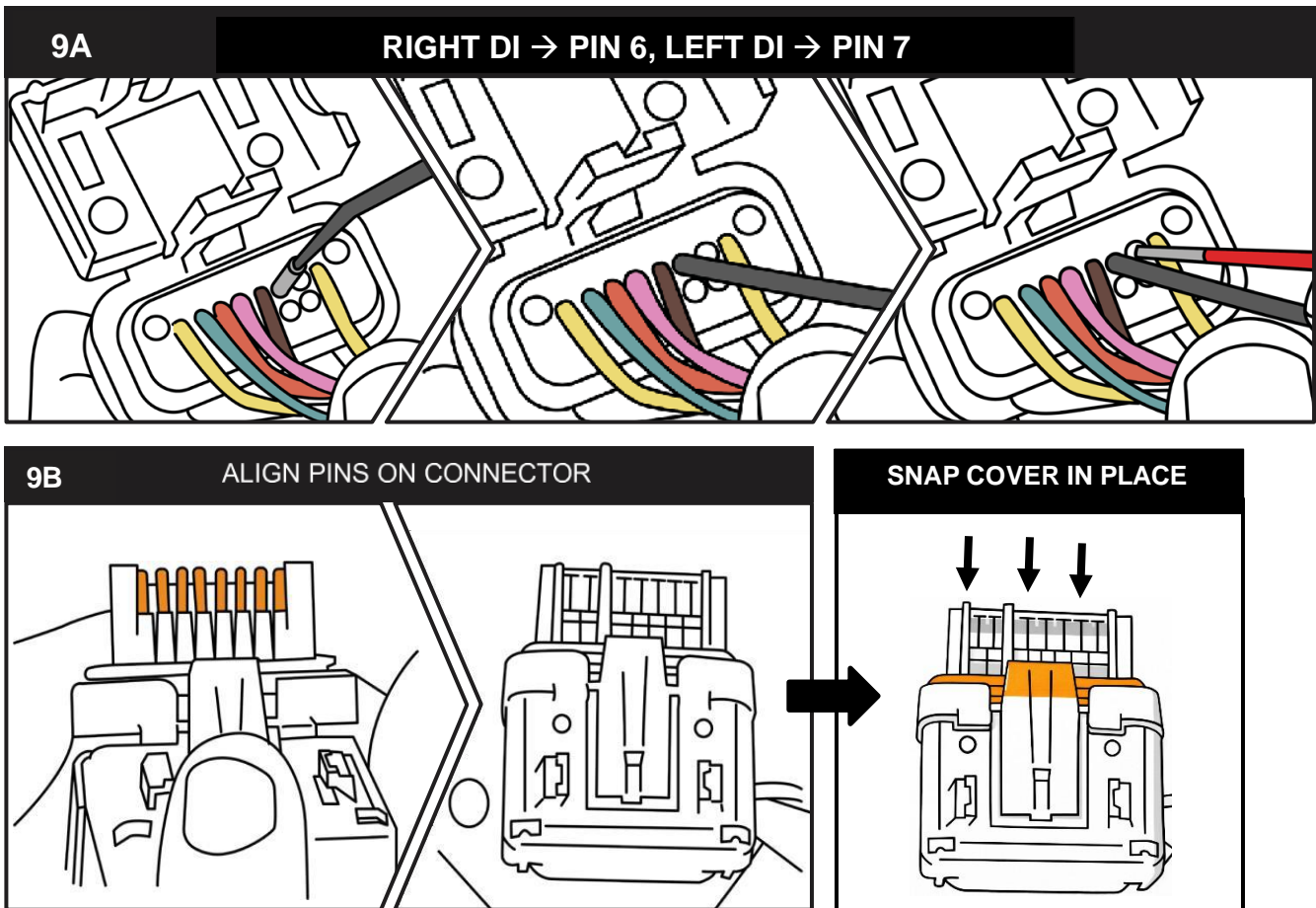

- Install the APEX lights onto the inserts provided in your kit using a **3 MM ALLEN** wrench (two screws per insert). [SEE FIGS. 10A & 10B]
- Move to the front of the machine and locate the bumper cavities where the bumper inserts will be installed.
- From the back side of the bumper, identify the mounting points for each insert.
- Install the supplied screw clips onto the bumper at each mounting location. [SEE FIG. 10C]
- These clips will receive the screws that secure the inserts.
- With the screw clips installed, position each bumper insert into its corresponding bumper cavity from behind the bumper, ensuring the insert is properly aligned and fully seated.
- Insert the provided mounting screws from the backside of the bumper, passing each screw through the bumper insert and threading it into the previously installed screw clips.
- Using a **10 MM WRENCH**, tighten the hardware securely so each bumper insert is firmly held in place.
- Connect the APEX bumper-insert lights to the Turn Signal Controller, using the dash indicator harness plugged into the LEFT TURN and RIGHT TURN connectors.
- **Important:** The APEX lights plug in-line with the dash indicator harness that connects to the controller.
- For full wiring details, refer to the **Turn Signal Wiring Diagram located at page 25.**

IDENTIFY BUMPER INSERTS WITH APEX LIGHTS

10A

PASSENGER-SIDE

DRIVER-SIDE



10B

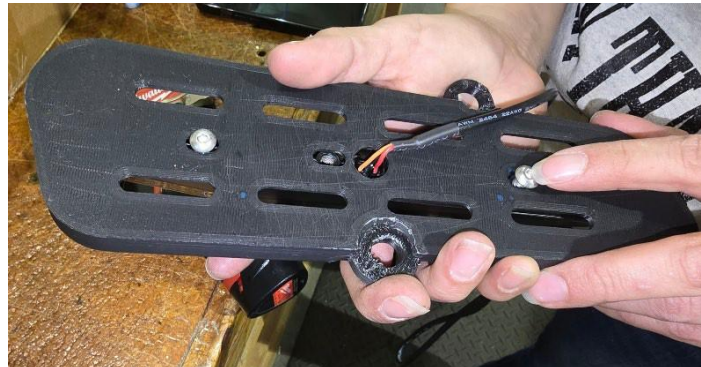

10C

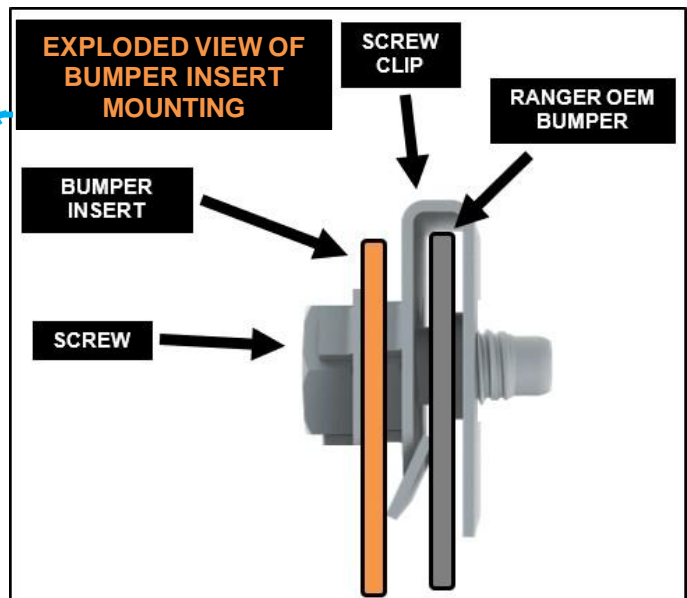
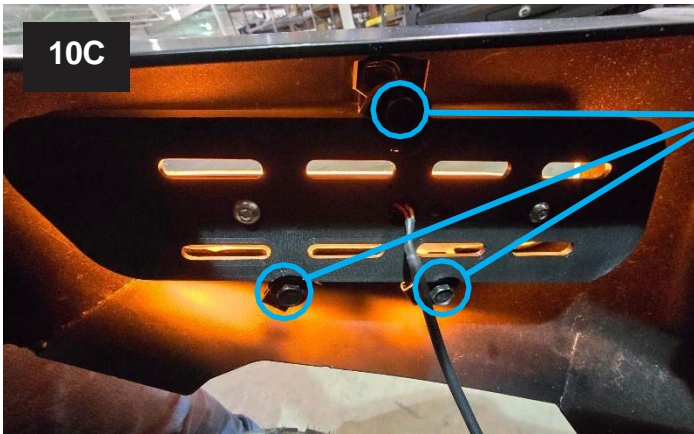

10D



- Gather the turn signal lever, mounting bracket, and the two M6 x 12 mm Allen screws.
- Assemble these components using a **5 MM ALLEN WRENCH**. SEE FIGS. 1A & 1B.

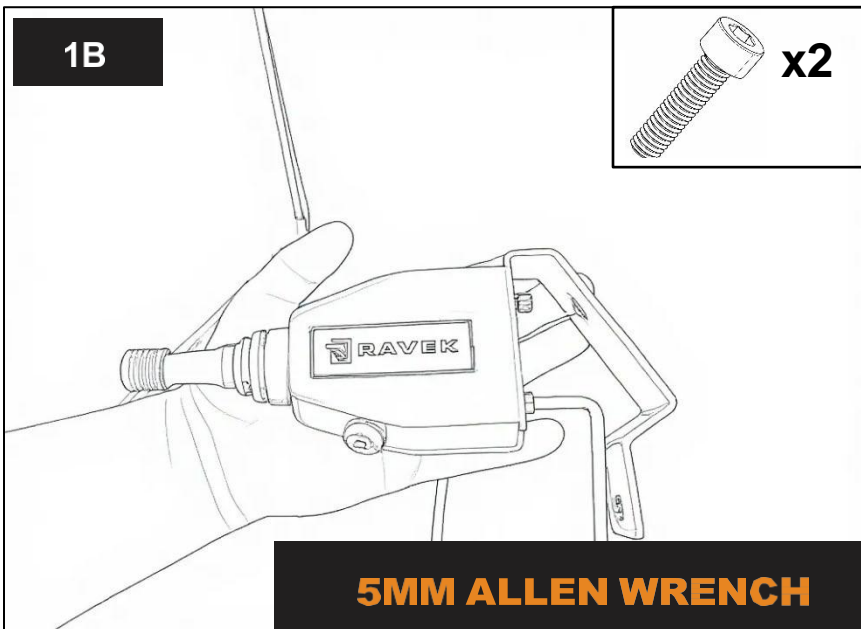
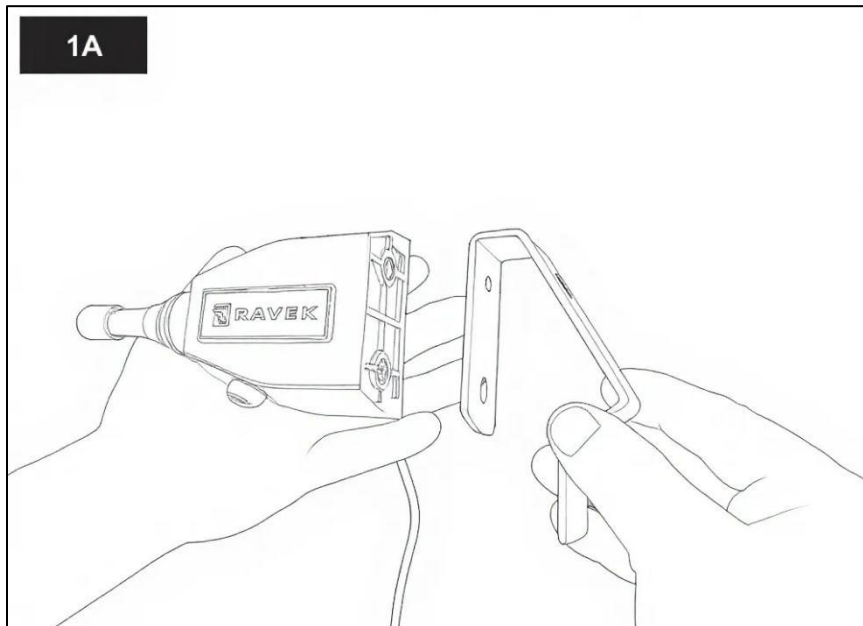

2

- Loosen the steering column mounting hardware using a **4 MM ALLEN WRENCH** on the bolt head while holding the nut on the opposite side with a **10 MM WRENCH**. Remove only the nut—leave the bolt in place to continue supporting the steering shaft. [SEE FIG. 2A]
- Position the turn signal lever and bracket onto the steering column and align it with the factory mounting holes.
 - **NOTE:** Depending on the bracket received, you may need to gently flex the bracket to help it wrap around the steering shaft.
- Thread the OEM nut onto the OEM bolt to secure the lever in place, then tighten the hardware firmly. [SEE FIG. 2B]

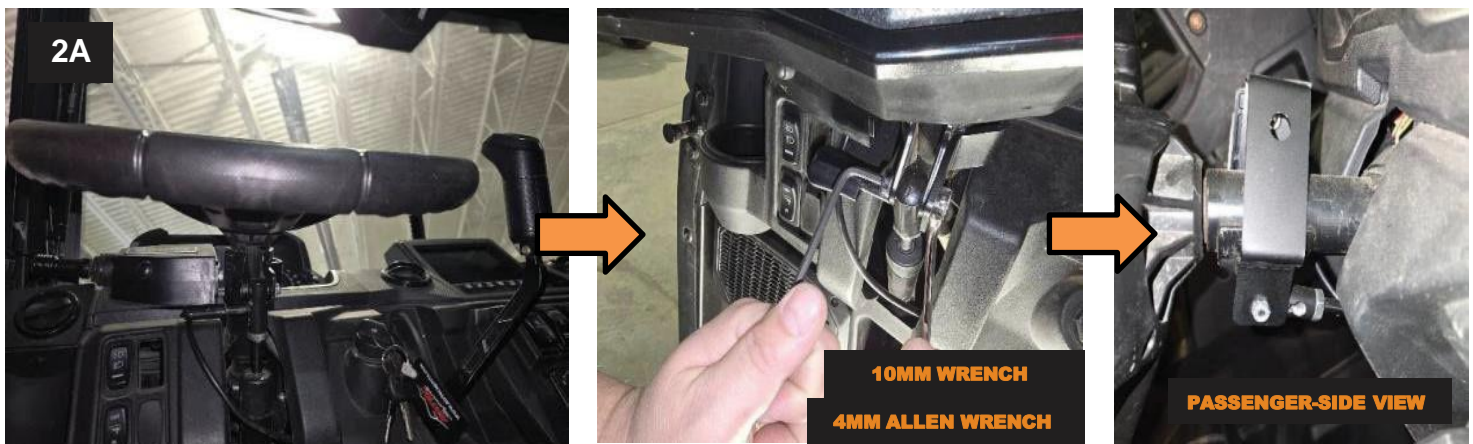

3

- Route the wiring from the turn signal lever behind the steering column shroud, through the firewall grommet, and toward the turn signal controller. Be sure to keep the wiring clear of any moving parts to prevent tangling or damage.
 - **NOTE:** A wire-fish tool may be helpful for guiding the wiring through tight areas and through the firewall grommet.
- Match the labeled connector from the lever to the corresponding connector on the controller. [SEE FIGS. 3A & 3B]

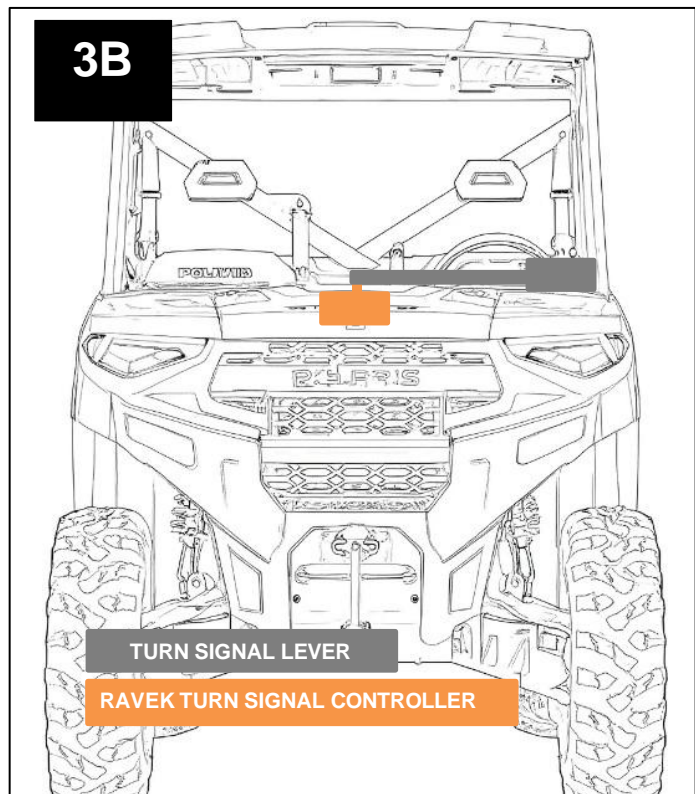
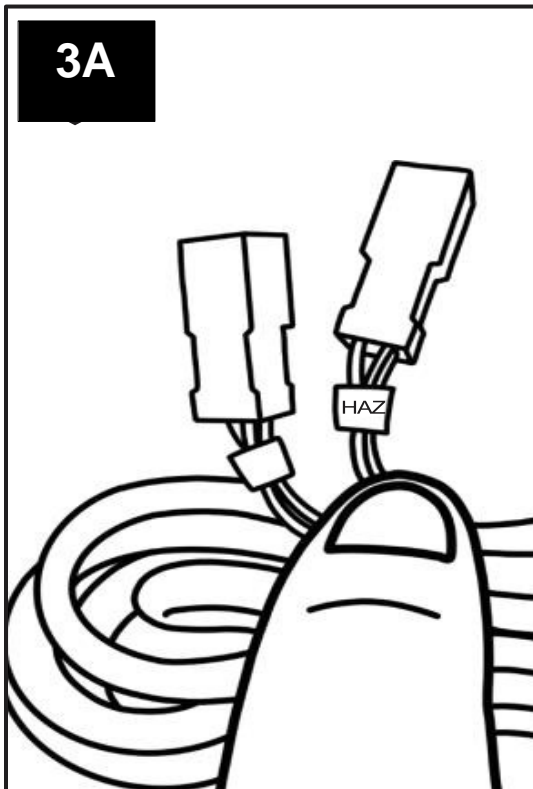

1

- Dump the bed of your Ranger to access the OEM multipin harness near the engine bay.
- Unplug the OEM multipin harness. [SEE FIG. 1A]
- Plug the supplied rear harness in-line with the OEM multipin harness. [SEE FIG. 1B & DIAGRAM A]
- Connect the wireless receiver to the following connectors on the rear harness:
 - 4-pin connector labeled “REAR EXTENSION.”
 - 2-pin connector labeled “LIC. PLATE”

1A

PLUG THE REAR HARNESS INLINE WITH CONNECTORS LOCATED UNDERNEATH THE BED

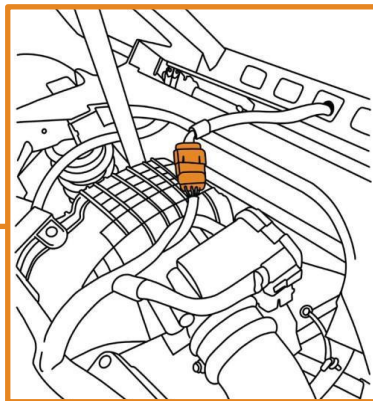
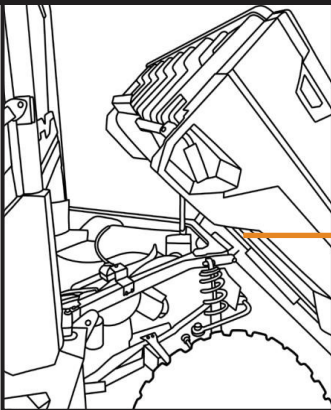

1B

REAR HARNESS SUPPLIED



REAR HARNESS DIAGRAM

DIAGRAM A

N/A. PLUGS FOR FUTURE RAVEK LIGHTS

TO OEM MALE 8-PIN CONNECTOR

TO RAVEK WIRELESS RECEIVER

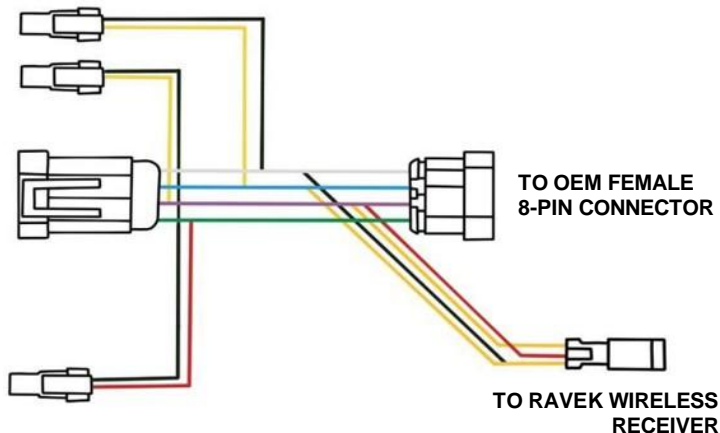

TO RAVEK WIRELESS RECEIVER

WIRELESS RECEIVER SUPPLIED



SCAN FOR TECH TIP



Notice: This device complies with part 15 of the FCC Rules. Operation is subject to the following two conditions: (1) This device may not cause harmful interference, and (2) this device must accept any interference received, including interference that may cause undesired operation.

2

- With the wireless receiver plugged into the rear harness:
- Route a supplied zip tie through the backside slot of the receiver. [SEE FIGS. 2A & 2B]
- Position the receiver against the machine's frame. [SEE FIG. 2C]
- Tighten the zip tie securely to hold the receiver firmly in place.
- Verify the receiver is not loose and does not interfere with any moving components.

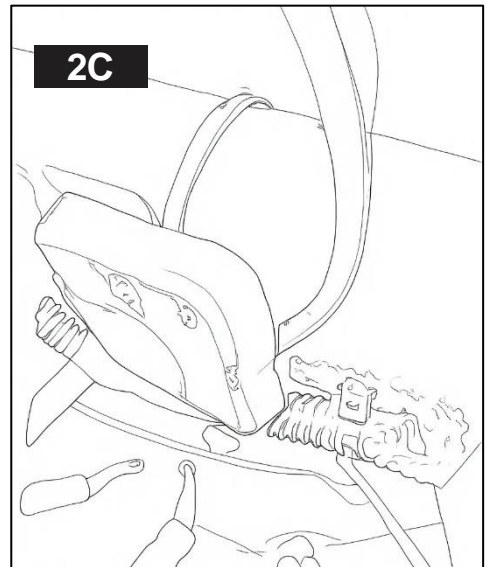
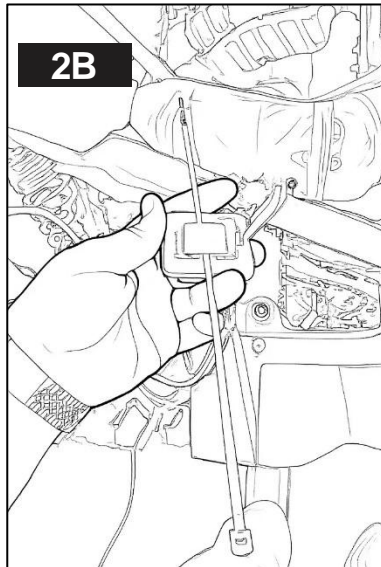
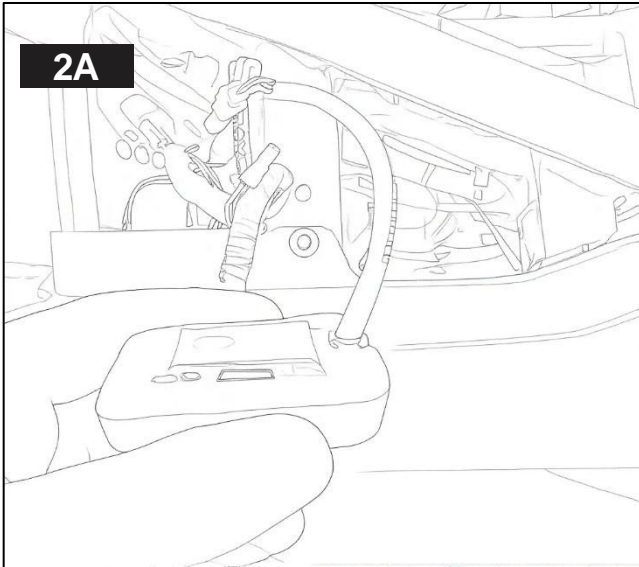

1

- Position the license plate bracket on the rear frame area under the tailgate (left side as shown in FIG. 1A).
- Hold the bracket in place and mark the two mounting hole locations using a marking tool.
- Remove the bracket and drill both marked locations using a 1/4" drill bit.
- Reposition the license plate bracket over the drilled holes.
- Insert the supplied bolts through the bracket and the frame.
- On the opposite side, thread the nuts onto the bolts.
- Tighten the nuts using a **10 MM WRENCH**, while holding the bolt head with a second **10 MM WRENCH** to secure it properly.

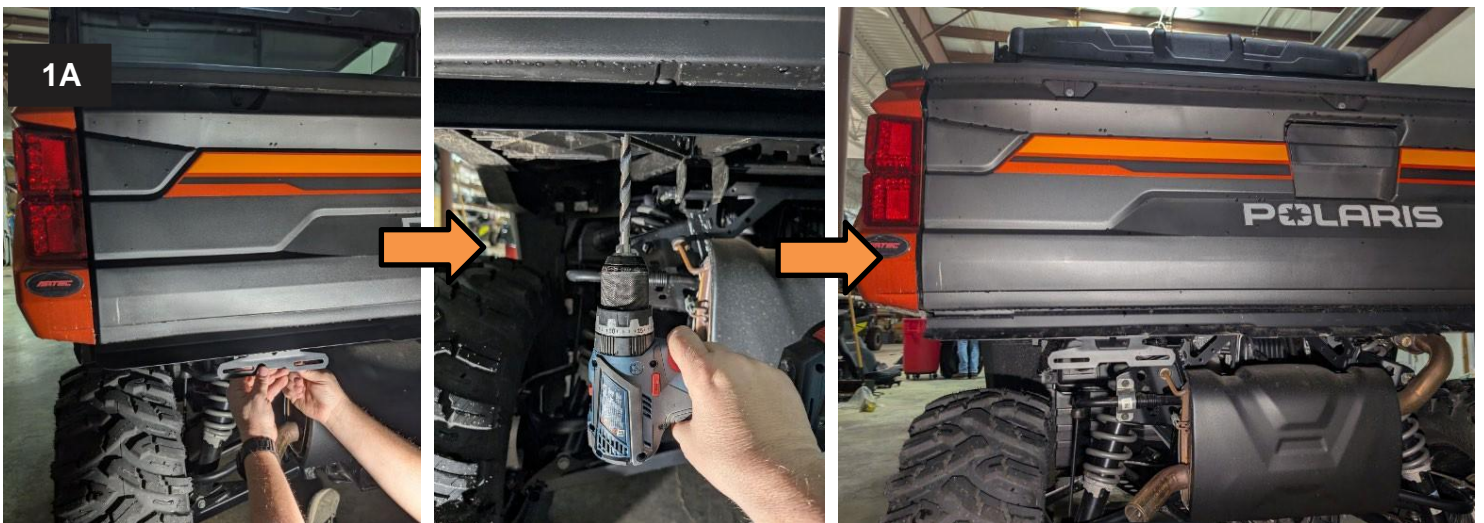

1

Go back to the battery and reconnect the terminals to supply power to the kit for the next few steps. [FIG. 1A]

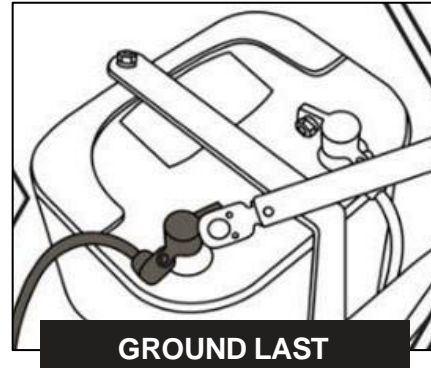
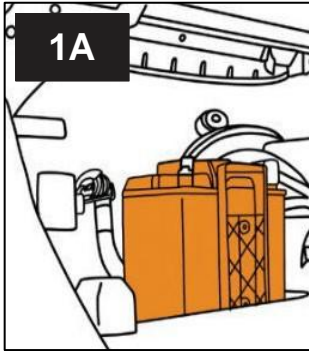

1

Turn your key to the ON position and test your lights.

1. **Hazard Lights:** Press the button located on the underside of the lever (see FIG. 1A) to activate your hazards.
2. **Turn Signals:** Push the lever down for a left turn or up for a right turn, just like in a car. The lever is momentary, so it automatically returns to the neutral position—no manual reset needed [SEE FIG. 1B]
 - a. Turn Signal Duration:
 - i. 1 toggle: 10-second signal
 - ii. 2 toggles: 20-second signal
 - iii. 3 toggles: 30-second signal
 - **NOTE:** You can manually cancel the turn signal at any time by moving the lever in the opposite direction.
3. Running brake lights
4. Running white lights
5. Brake light w/ pulse effect
6. Left turn signal dash indicator
7. Right turn signal dash indicator

1A

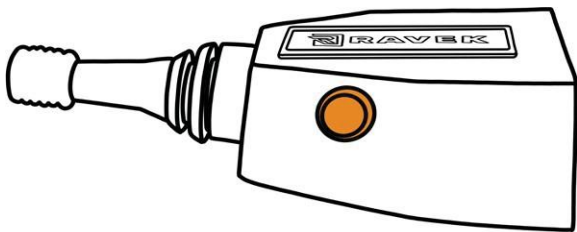

BOTTOM VIEW

1B

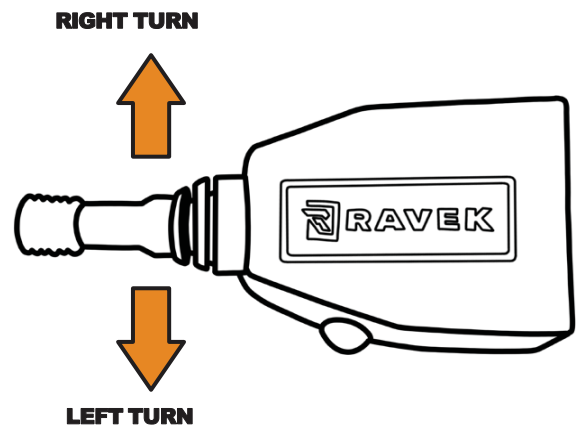

FRONT VIEW

1

- Under the hood, locate recommended mounting bolt shown in FIG. 1A.
- Position the horn in place and mount it using the OEM hardware (use **T-30 TORX** to first remove and then secure the bolt with the horn installed) Tighten the hardware securely to prevent movement.
- Ensure the horn is not touching any surrounding surfaces or panels, as contact can reduce or muffle the sound output.
- Connect both spade terminals from the extension harness to the horn's connectors — either terminal can be used (if not already plugged in). [SEE FIG. 1B]

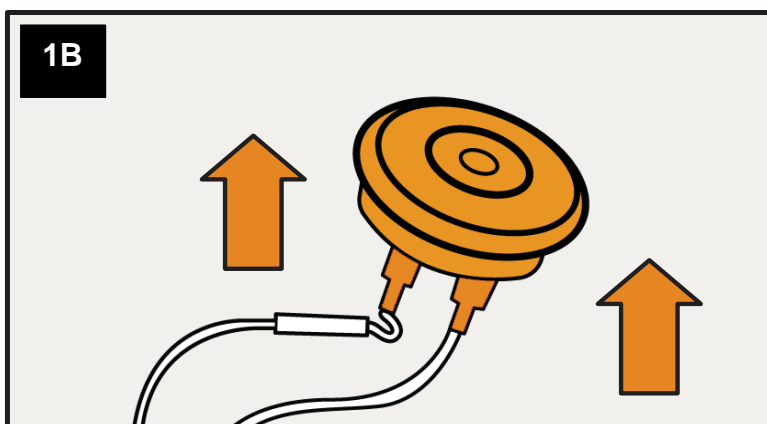
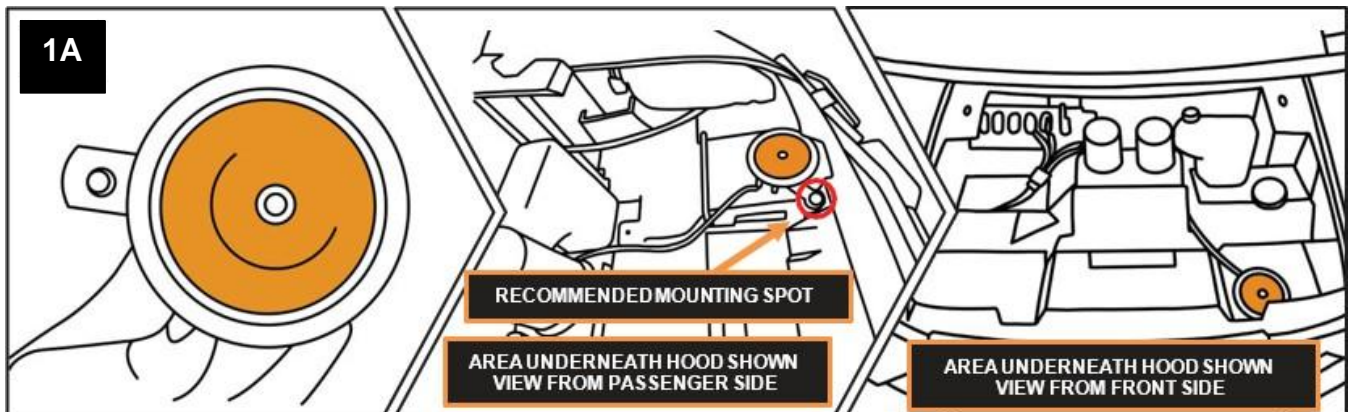

1

Close the hood, turn the key to the ON position, and test the horn.

1. Horn: To activate the horn, simply push or pull the lever. [SEE FIG. 1A]

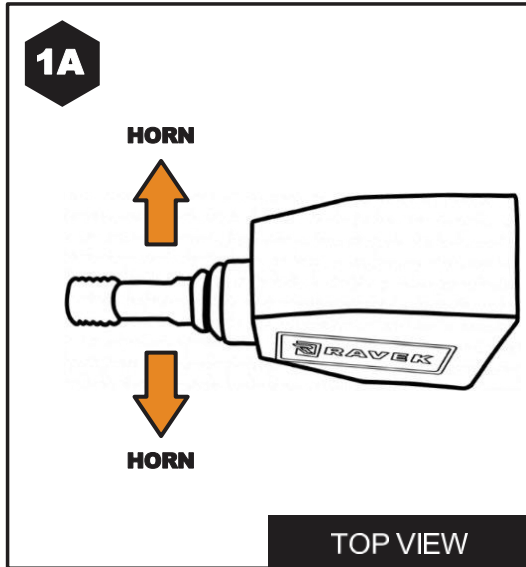

2

Once you have tested the kit and confirmed proper operation, reassemble your machine by reinstalling all panels in their correct positions.

1

See FIG. 1A for the Kit Overview Diagram.

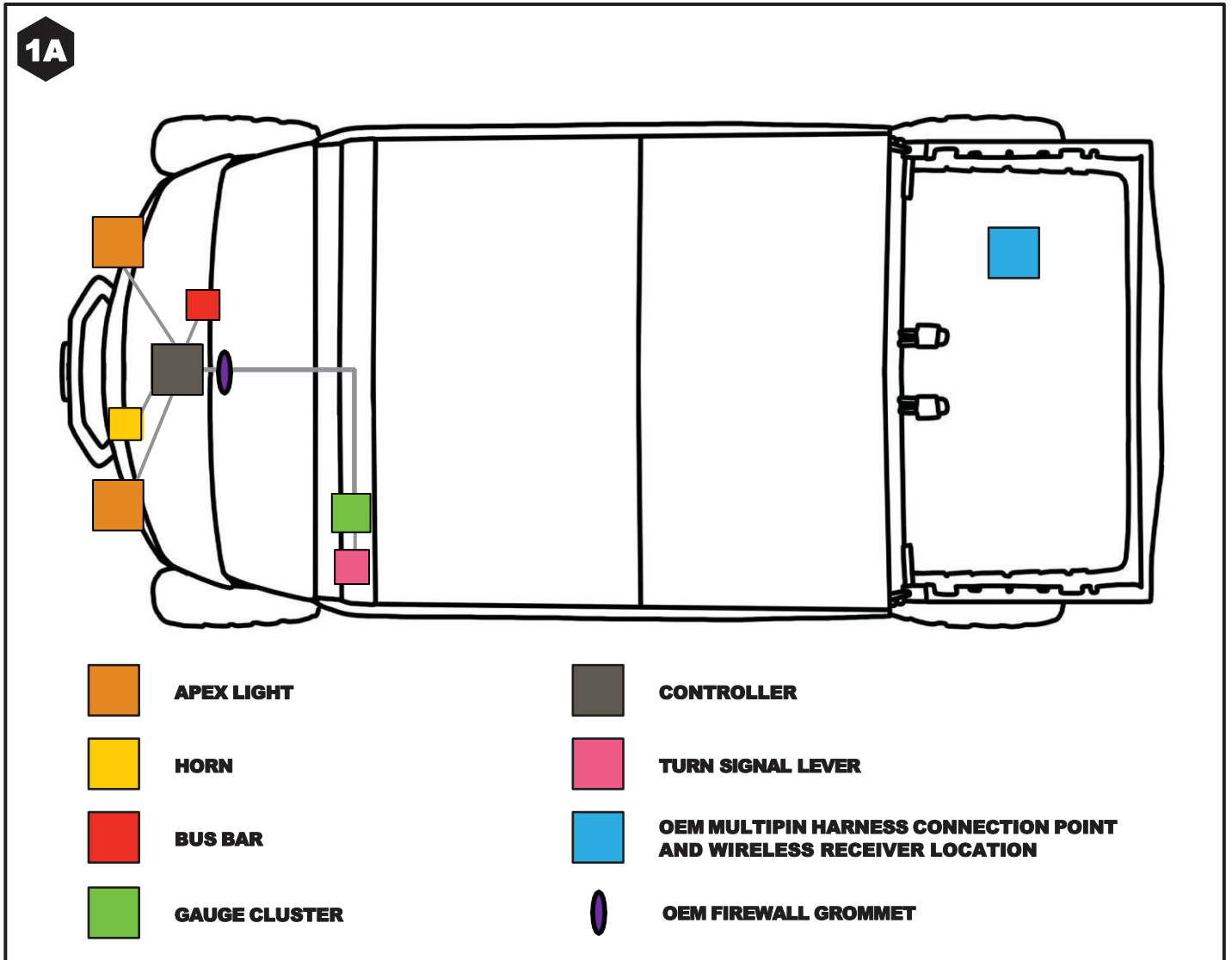

RAVEK CONTROLLER WIRING DIAGRAM

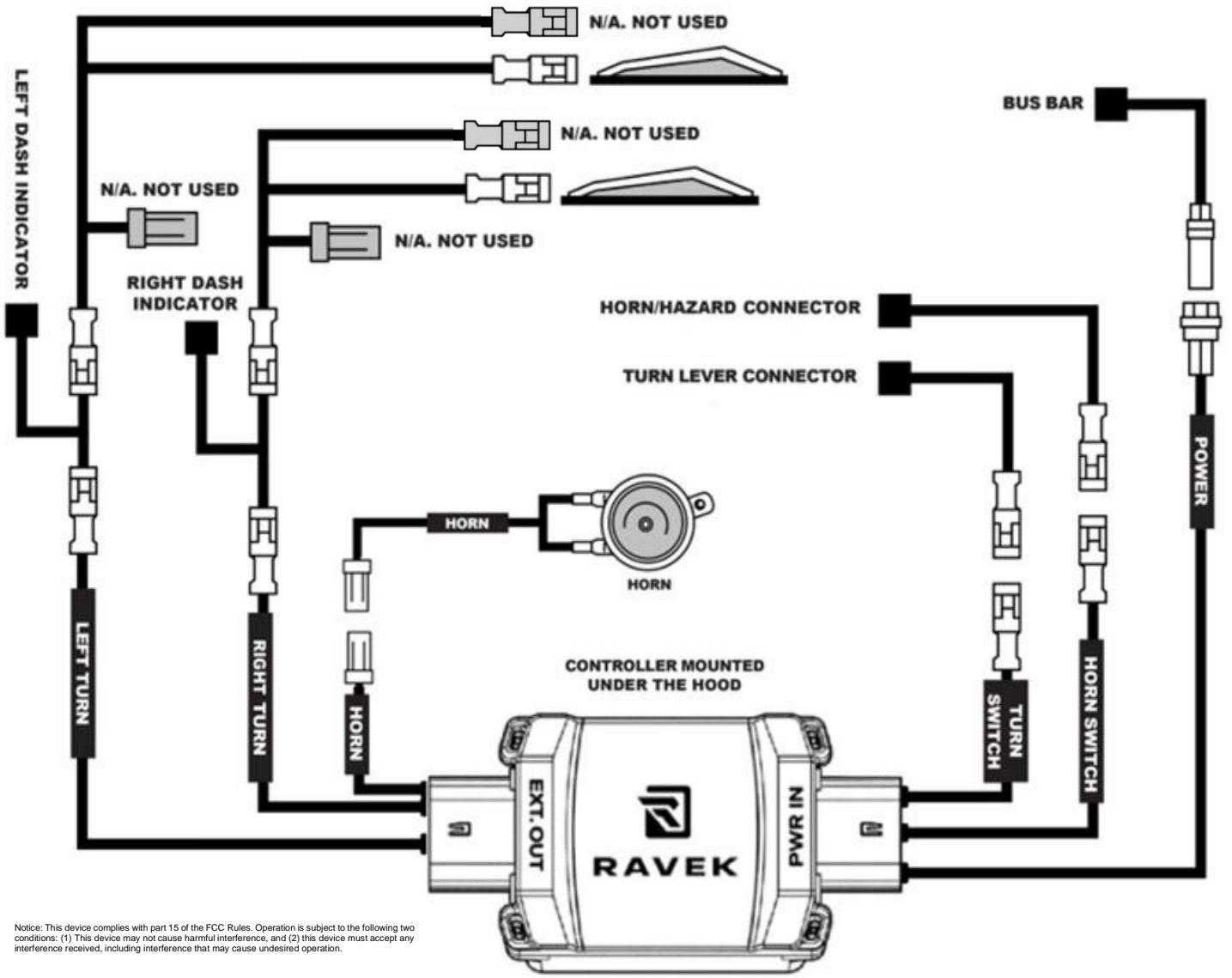

Notice: This device complies with part 15 of the FCC Rules. Operation is subject to the following two conditions: (1) This device may not cause harmful interference, and (2) this device must accept any interference received, including interference that may cause undesired operation.

REAR HARNESS & WIRELESS RECEIVER DIAGRAM

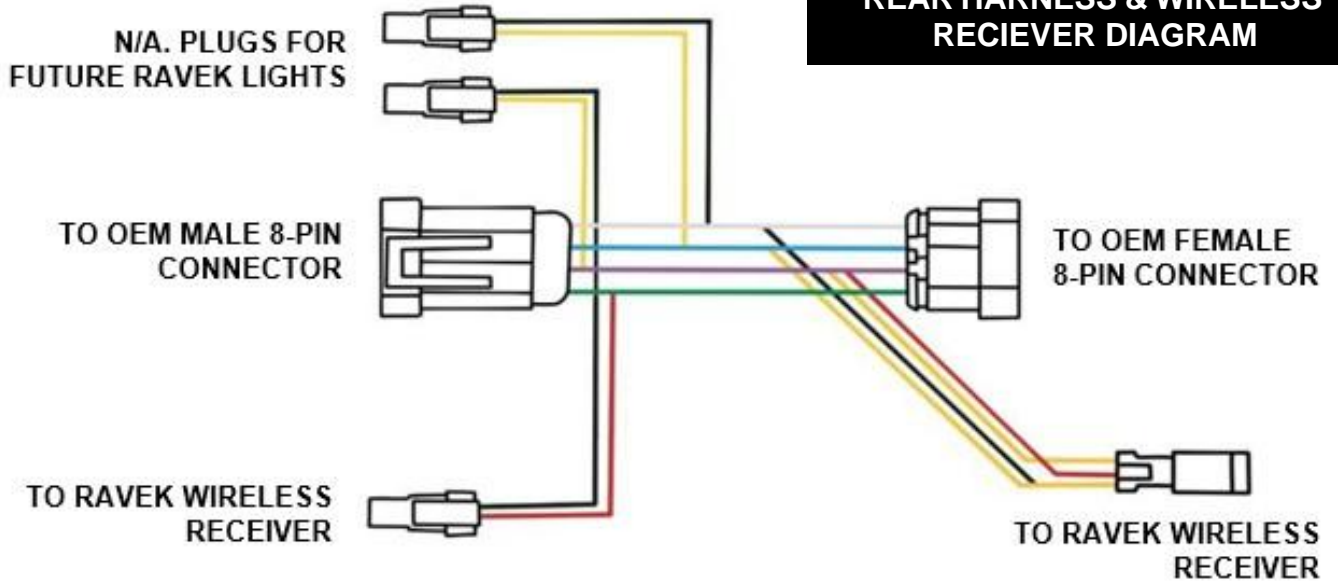



RAVEK
BUILT FOR MORE

RAVEK WISCONSIN TECH SUPPORT LINE: 855-617-2787