

SUPERATV Jump Starter with Air Compressor

USER MANUAL

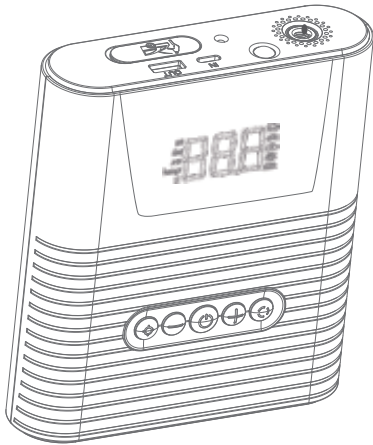

Tips:

Before using the product, please read this instruction manual carefully and keep it for future reference.

I .Product Structure

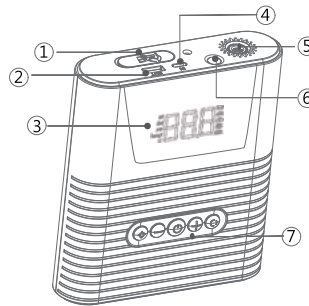

Button Definition

- Mode Switch/Light
- Increase Tire Pressure
- Power Button
- Decrease Tire Pressure
- Unit Switch/Light

- ① Smart clip socket
- ② USB port
- ③ LED Display
- ④ Charging port
- ⑤ Air outlet
- ⑥ LED light
- ⑦ Button area

II.Component Names

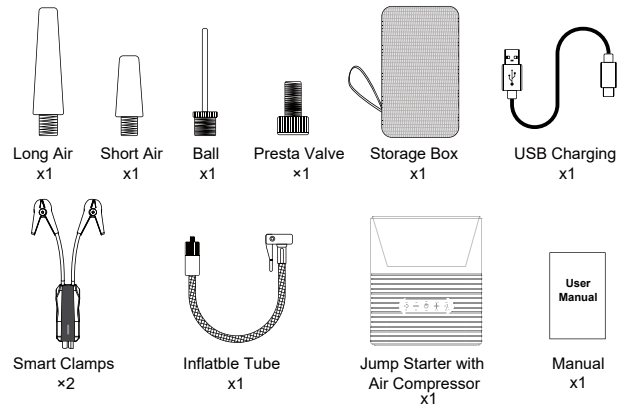

III.Product Parameter

Model: D9H
 Battery Capacity: 44.5Wh
 Starting Current: 600A(3s)
 Peak Current: 1000A
 USB-C In: 5V/2A
 USB Out: 5V/2A
 Air Pressure: 0-150 PSI Maximum
 Storage Tem: -4°F~140°F
 Working Tem: -20°F~122°F
 Charging Time: about 6 hours
 LED Lighting: 2 lighting modes (Bright &Flashing mode)
 Inflation Speed: about 5 mins (Tire Spec: 205/55/R16)



IV. Product Feature



1. Jump Starter & Air Compressor 2 in 1
2. Power Bank Function
3. LED Light
4. 4 Preset Mode with Default Value Correspond to 4 Target Devices
5. 4 Tire Pressure Units

V. Button Instruction



Due to the simple design concept, some buttons have integrated lighting function icons, please see below for operating instructions.

- **Power Button** 

Hold the  button for 3 seconds to turn on/off the air pump.
After setting the inflation mode, press the  button to start/stop work.
- **Unit Switch** 

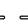
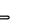
This product provides four air pressure units for your choice.
The four units are: "PSI", "BAR", "KPA" and "kg/cm2". You can switch by the unit button .
- **Mode Switch** 

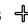
This product provides four inflation modes: "Car", "Motorcycle", "Bicycle", and "Ball".
You can short press the mode button  to switch between them.
- **Adjust Value**  

Press these 2 buttons  /  to increase or decrease the value (support long press to adjust quickly).
- **Tire pressure in various modes:**

				
Car	Motorcycle	Bicycle	Ball	Default PSI
				
				Adjustable PSI Range

VI. Operation Introduction - Jump Starter Function

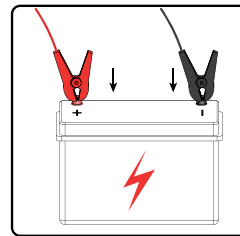

Step 1:

Connect to the Car battery

Red clamp connects to "+" terminal
Black clamp connects to "-" terminal

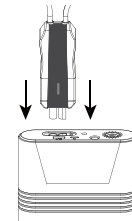

Step 2

Connect to the jump starter

Insert smart clamps into the jump starter (Insure it is fully inserted).

Turn on the machine.

Hold the Power Button for 3 seconds until the Green LED display turns on.

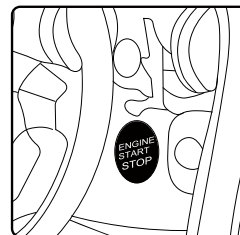

Step 3

Start the car within 60s

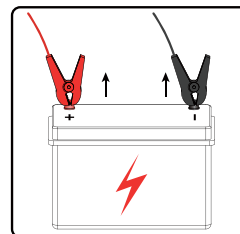

Step 4

Completed the operation

Remove the clamps within 30s after starting the car

Emergency Jump Starter function - Notes:

1. The jump starter function can not be used when the remaining battery is less than 30% (battery indicator needs more than 1 bar)
 2. Please re-plug to re-activate it when appear following conditions (indicator will show red light):

- ① Reversely connected with the "+" and "-" terminal
- ② Not start the car last for more than 60s after connected.
3. Compatible Vehicle Models.

≤ 8.5L Gas Engines

≤ 6L Diesel Engines

If more than, indicator will show red light and can not fire.

4. If you start the car more than 5 times in a row, the red light will be on (if you fail to start the car at once and start it 5 times in a row) Please re-plug to re-activate it to restore normal use.

2. Operation Introduction - Air Compressor Function

① Turn On and Set the Pressure Value

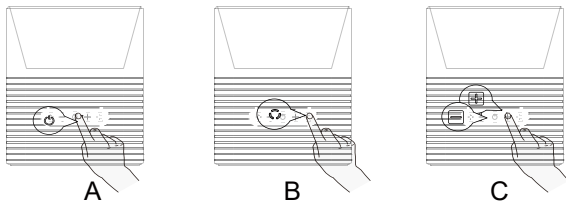

A. Long press the "Power Button" for 3 seconds to turn on the inflator;

B-1. Press the "Mode Button" to choose the inflation mode with default value;

B-2. Or press "+/-" to adjust to the value you need;

② Inflatable Tube Connection

Connect the "inflatable tube" to the "air outlet" of the air pump and screw it tightly;

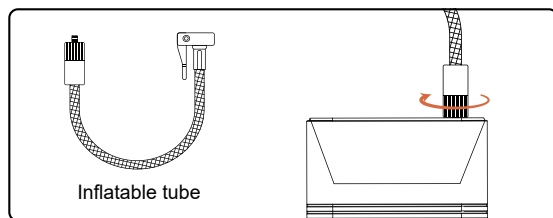

③ Connect with Inflatable Object

• For Car tires

Keep the black, foldable button of the tube open. Connect to the valve of car tire and press down the foldable button. The air pump screen will flash a few times, then display the current tire pressure value.

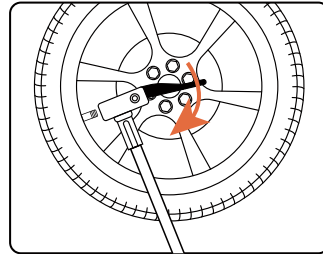

• For Ball, Swim Ring, Bike or Others

Choose the appropriate air nozzle / needle. Keep the black, foldable button of the tube open and put the nozzle / needle in the inflation port.

Press down the foldable button and connect with inflatable object.

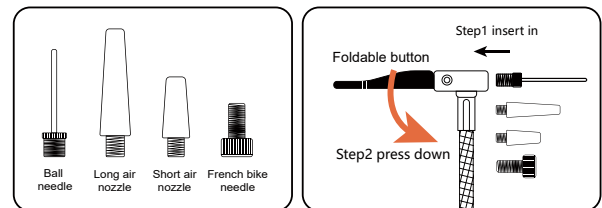

• Notes on Ball Needle

Please ensure the end of the ball needle is flat with the inflation port.

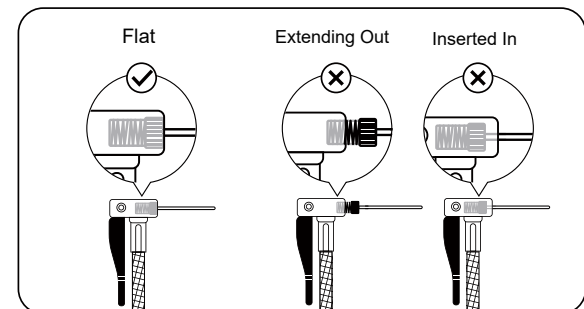

④ Start to Inflate

After connecting with the inflatable object, press the Power Button to start inflating. Compressor will automatically stop when the preset value is reached.

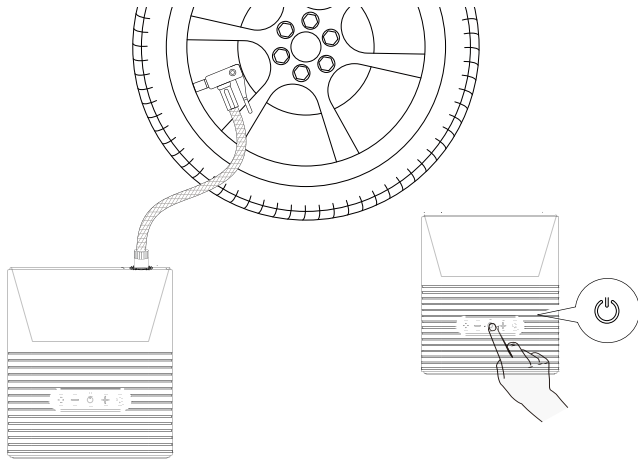

4. Power Bank Function

Turn on the air compressor, use the USB cable to connect the out port and the smartphone, then it will start charging automatically.

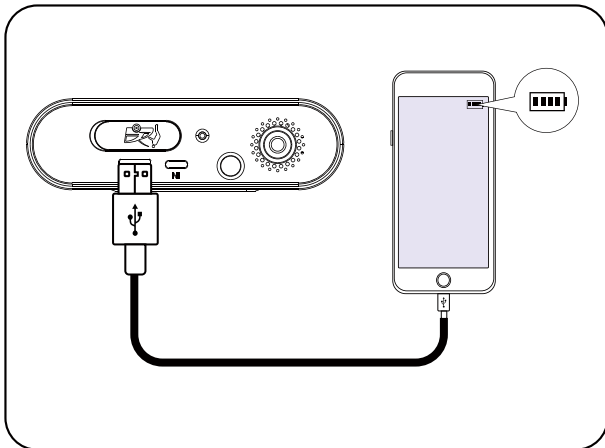

VII. Precautions

1. About Charge

- Compatible charger: output $\geq 5V/2A$;
- Full charging time: 4-5H;
- How to determine if unit has full charge: When at full charge, the battery bar on the screen will not flash.

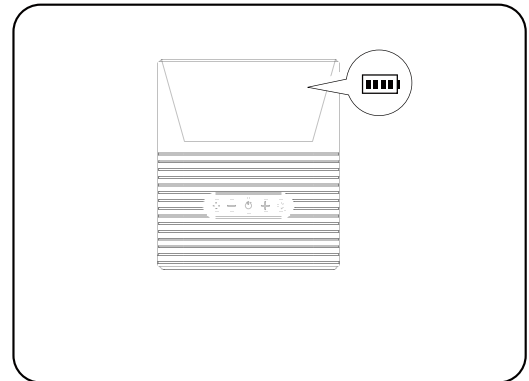

2. Temperature Protection

There is a temperature protection system to ensure safety. When the temperature is too high (works continuously more than 15mins), the system will be auto triggered and enter a mandatory rest state. In this time, the screen will show "HI".

How to use again: Cool it down for 15-20mins and can be use again.

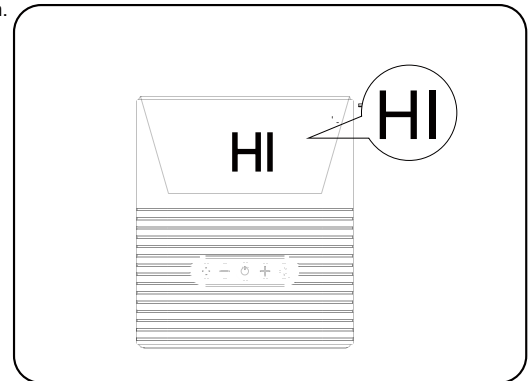

VIII. Troubleshoot

Issue	Cause/solution
Jump starter indicator shows red light	<p>①Please check whether the "+" and "-" terminals were reversed or not?</p> <p>②Not start the car last for more than 60s after connected. Please re-plug to re-active it.</p> <p>③Not compatible with your car(The compatible range: ≤8.5L gas engines; ≤6L diesel engines)</p> <p>④continuously use it to start a car over 5 times. Please re-plug to re-active it.</p>
Does not inflate	<p>①The air pump is in over-current protection mode. It will be reactivated after charge.</p> <p>②The air pump has insufficient power. Air pump needs to re-charge.</p> <p>③The air pump is in activated temperature protection mode. Please let unit cool down 15-20 minutes before use.</p> <p>④The inflation tube is not sealed with the tire valve. Please check to see if air leak is present;</p> <p>⑤If used on truck tires and inflation is higher than 87PSI, application is not suitable for this product.</p>
Inaccurate air pressure display	<p>①Check whether the connection between the inflation pipe joint and the tire air nozzle is too tight (some vehicles cannot be overtightened) Try to gradually loosen the interface for testing.</p> <p>②If the air pump works continuously, the internal air will expand due to increase temperature resulting in air pressure measurement to have a slight error. Allow air pump to cool down.</p> <p>③For more accurate display, please try to use Kpa or bar as unit.</p>
The inflatable tube is too hot to be unplugged	<p>①It is normal for inflation tube to get hot after working for a long time. Please try to rotate the black nylon part of the inflation tube instead of the orange silicone part to remove it;</p>
Power consumption is too fast	<p>①Due to our battery algorithm, the first 50% of the power consumption will be fast, but the subsequent 50% of the power consumption will be slower, it will not affect the number of inflate times;</p>

Cannot be charged	<p>① Check whether the output of charger is $\geq 5V/2A$. if not, please replace it;</p> <p>② Check if there is a battery icon flashing when charging, if not, please change a data cable to charge;</p> <p>③If it still fails to charge, please contact our customer service team;</p>
Can not inflate balls normally	<p>① Please check whether the connection between the ball needle and the inflation tube is correct.</p> <p>ENSURE THE END OF THE BALL NEEDLE BE FLAT WITH THE "INFLATION PORT", NOT STICK IT IN.</p>

IX. Notice

- ① This product is not a toy, and use by children is prohibited. During inflation, please keep children at a safe distance from the pump;
 - ② If the product is used less, it is recommended to charge it at least once every month;
 - ③Please make sure to select the correct measurement unit, avoid to over inflation;
- Common unit conversions:
1 PSI=6.89 kpa, 1PSI=0.068 bar, 1 PSI=0.07 kg/cm².
- ④ Please use in a dry and clean environment. This product is not waterproof. Do not rinse with water.
 - ⑤If there is abnormal noise or the temperature is too high during work, please shut it down immediately;
 - ⑥ Inflating will cause physical heating phenomenon of high pressure operation. Be careful when you remove the air pipe; Do not touch the orange silicone part when you remove the inflatable tube (it will be hot), please touch the black nylon of the inflatable tube (anti-hot)