

INSTALLATION INSTRUCTIONS

Half Doors: for CFMOTO U10XL

- Do not discard packaging until product has been successfully installed.
- Driver side installation shown in illustrations.

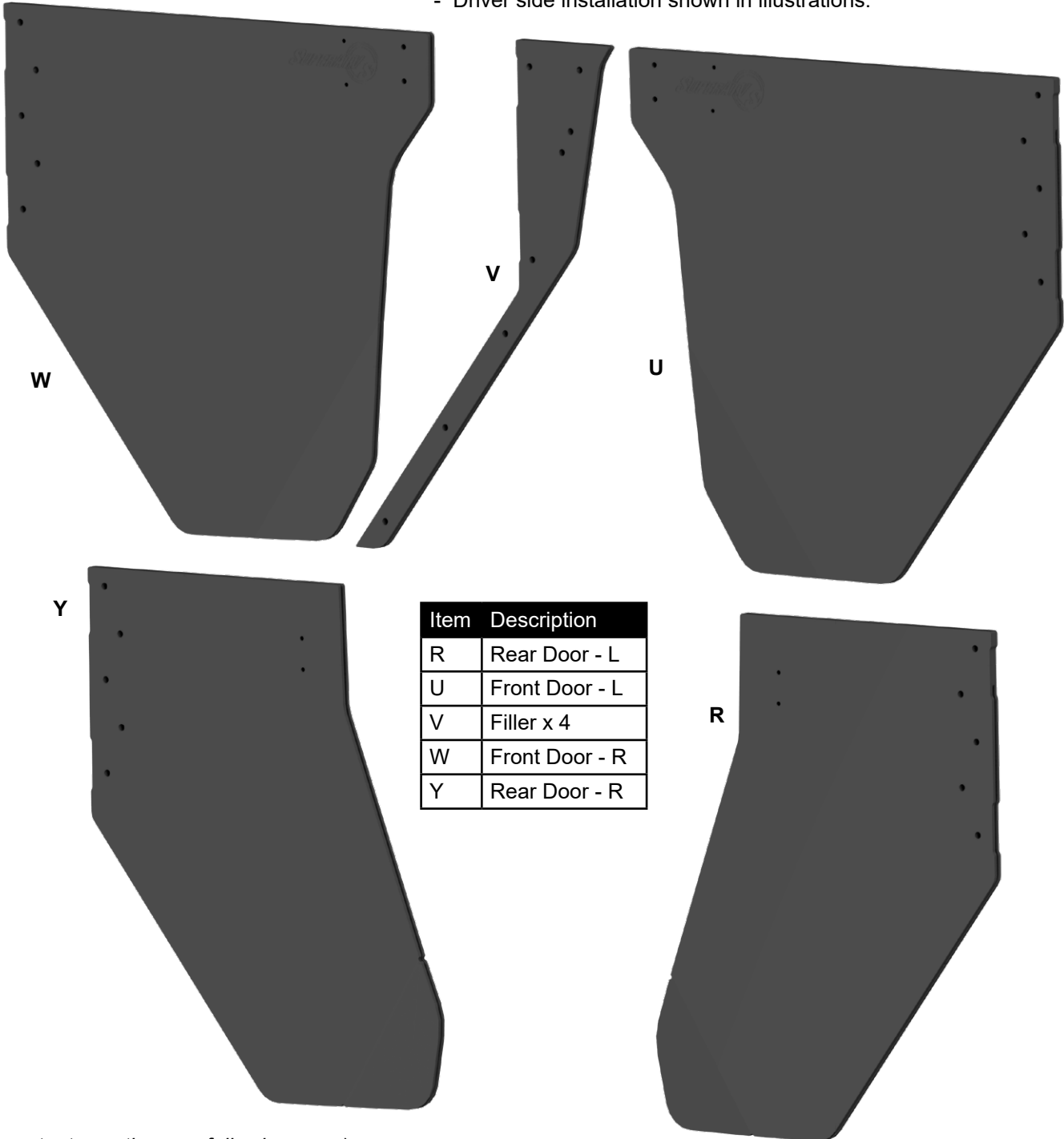

Item	Description
R	Rear Door - L
U	Front Door - L
V	Filler x 4
W	Front Door - R
Y	Rear Door - R

(kit contents continue on following page)

Need help with your installation?



sales@superatv.com



www.superatv.com



1-855-743-3427



8:00am - 8:00pm EST M-Th
 8:00am - 7:00pm EST Friday
 9:00am - 2:00pm EST Saturday

Read instructions and view illustrations before beginning.

Thank You

For Choosing



Bulb Seal

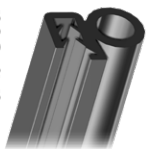

Seal



(kit contents continued)

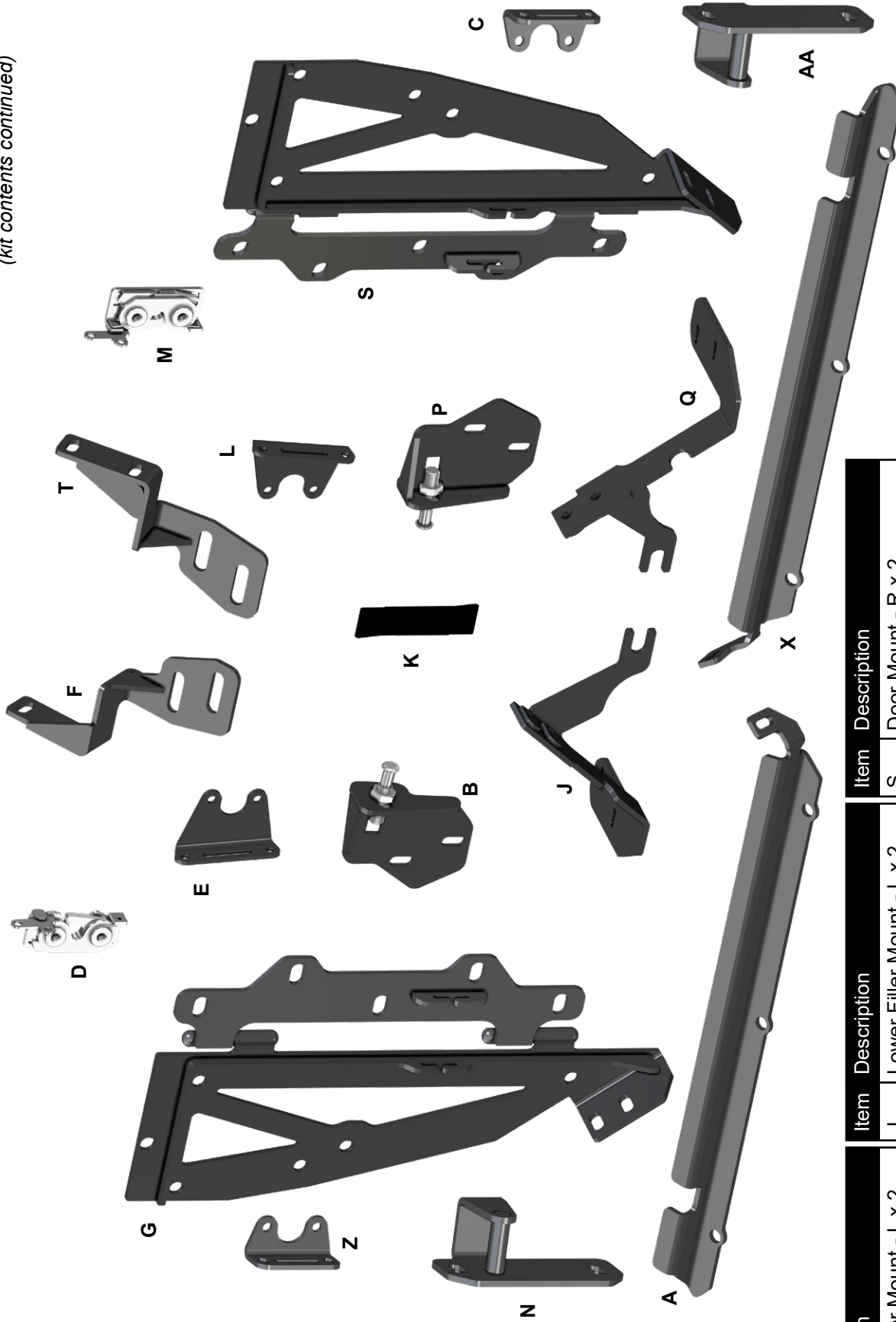

Item	Description	Item	Description	Item	Description
A	Lower Door Mount - L x 2	J	Lower Filler Mount - L x 2	S	Door Mount - R x 2
B	Front Striker Mount - L	K	Strap x 4	T	Filler Mount - R x 2
C	Rear Door Latch Mount - L	L	Front Door Latch Mount - R	X	Lower Door Mount - R x 2
D	Latch - L x 2	M	Latch - R x 2	Z	Rear Door Latch Mount - R
E	Front Door Latch Mount - L	N	Rear Striker Mount - R	AA	Rear Striker Mount - L
F	Filler Mount - L x 2	P	Front Striker Mount - R		
G	Door Mount - L x 2	Q	Lower Filler Mount - R x 2		

remove components / hardware shown; do not discard

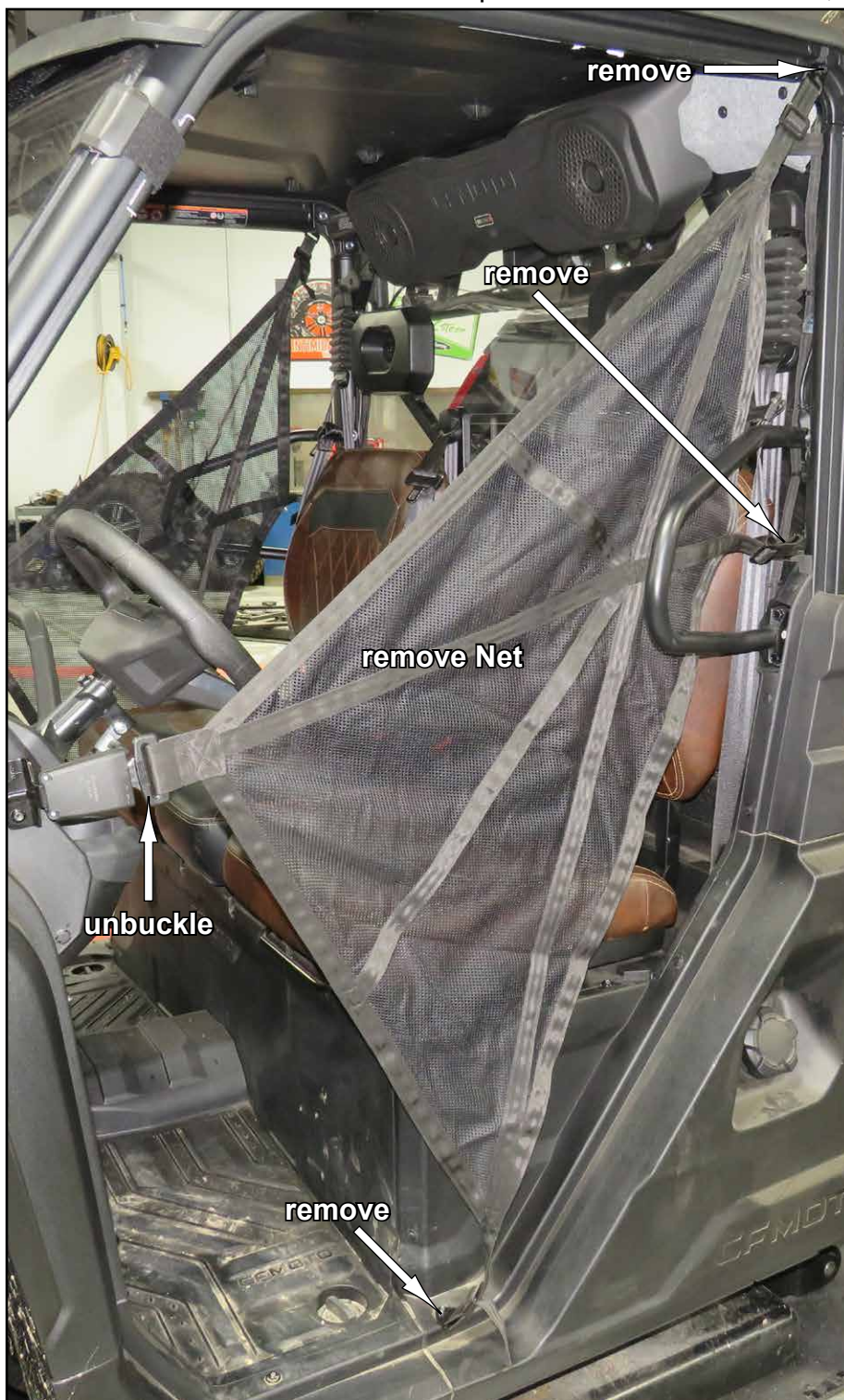

- Repeat for Rear.
- Bolsters and Nets will not be reinstalled

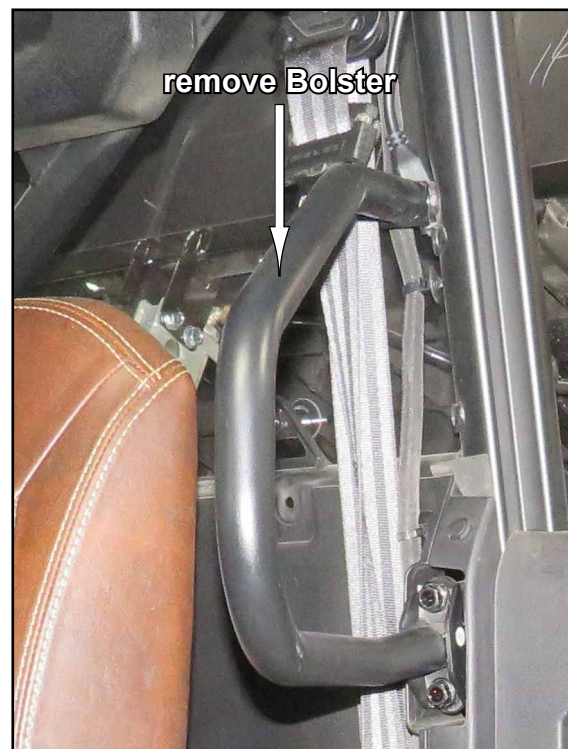

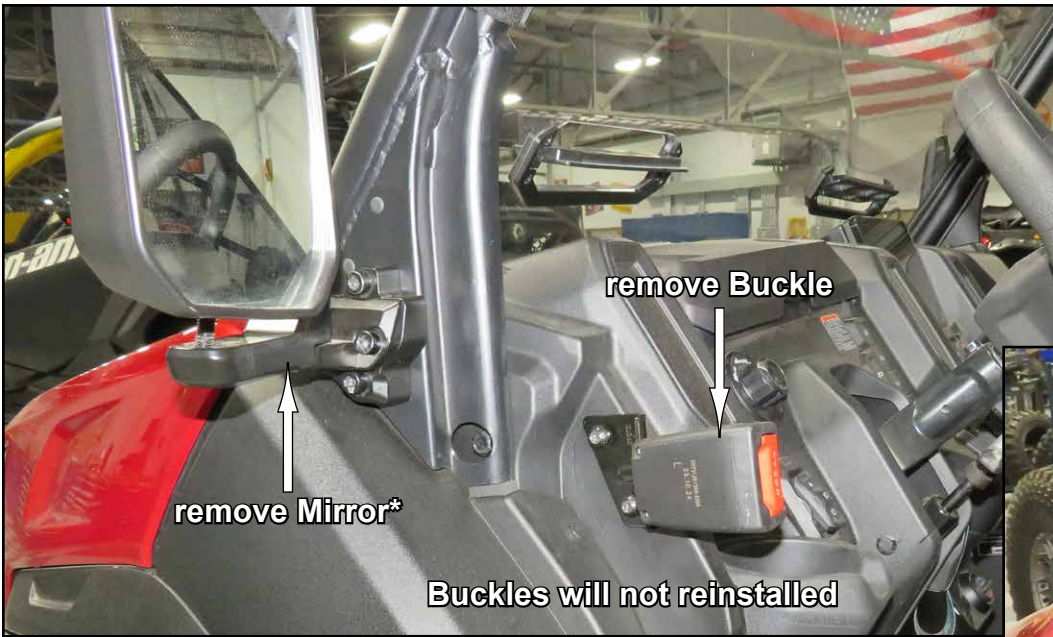

**Mirror can remain in stock location
or removed and installed to Door*

remove Rear Upper Panel

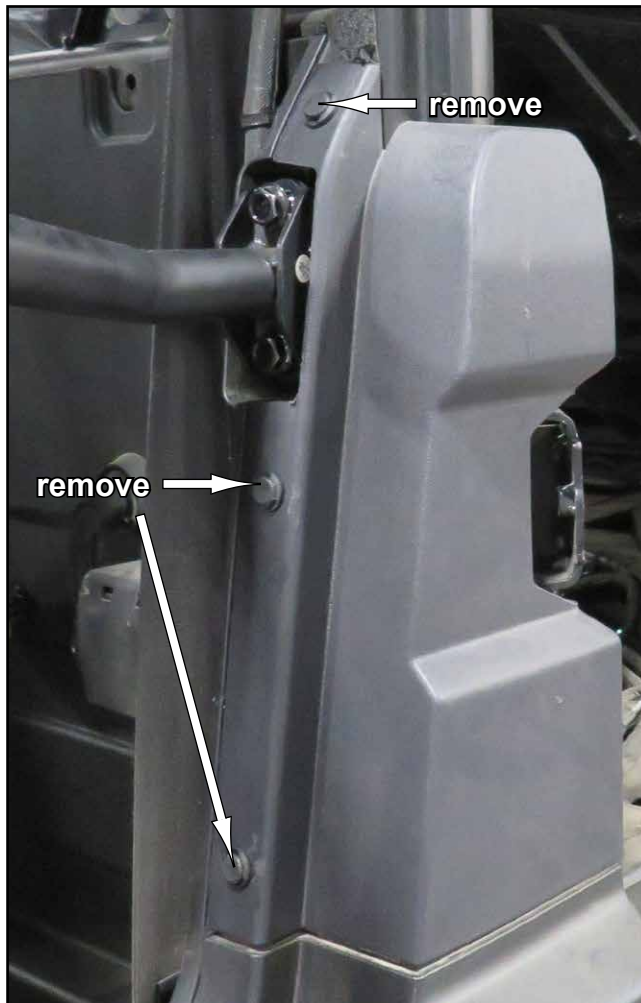

remove Front Upper Panel



Locate indentation shown on Front Upper Panel and cutout.

When installing slotted components, center hardware in slots.

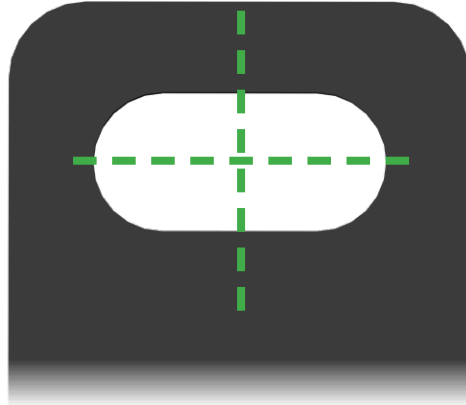

KEEP HARDWARE SNUG BUT NOT COMPLETELY TIGHT

- Reinstall Front Upper Panel.
- Install Rear Striker Mount - L (AA) with hardware shown.

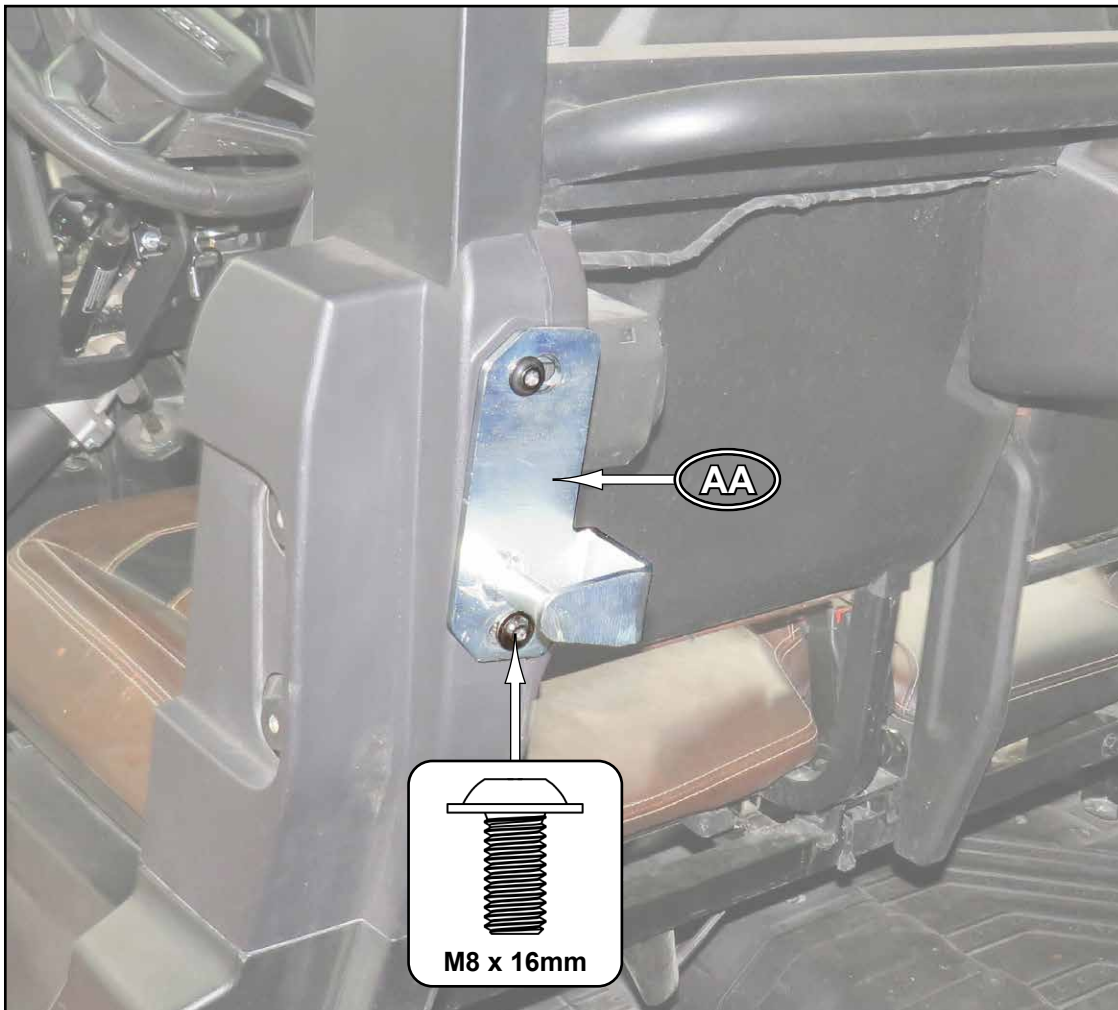

- Install Seals to locations shown on Front Door - L (U).

FRONT

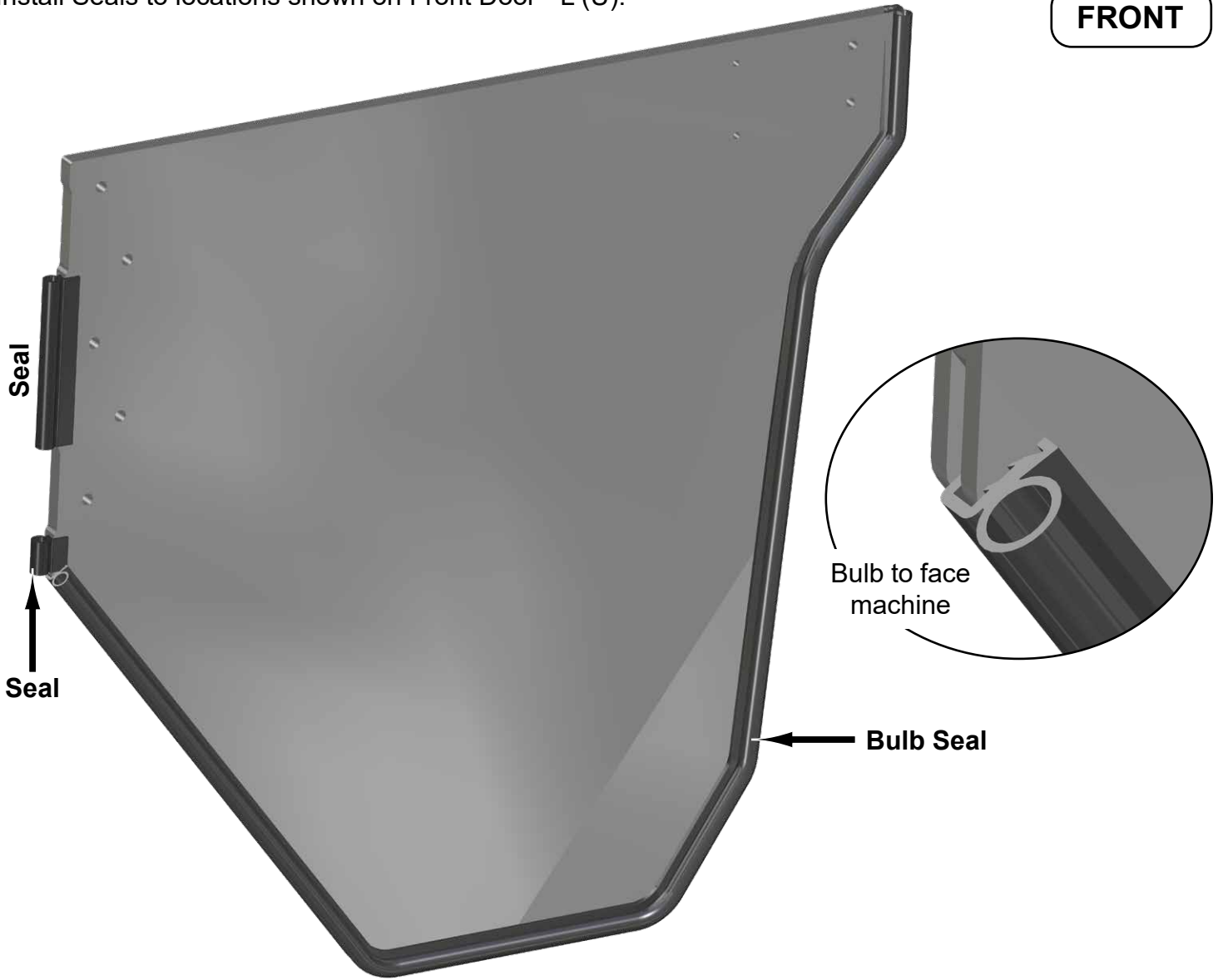

- Install Door Latch Mount - L (E) to Front Door - L (U) with hardware shown; tighten.

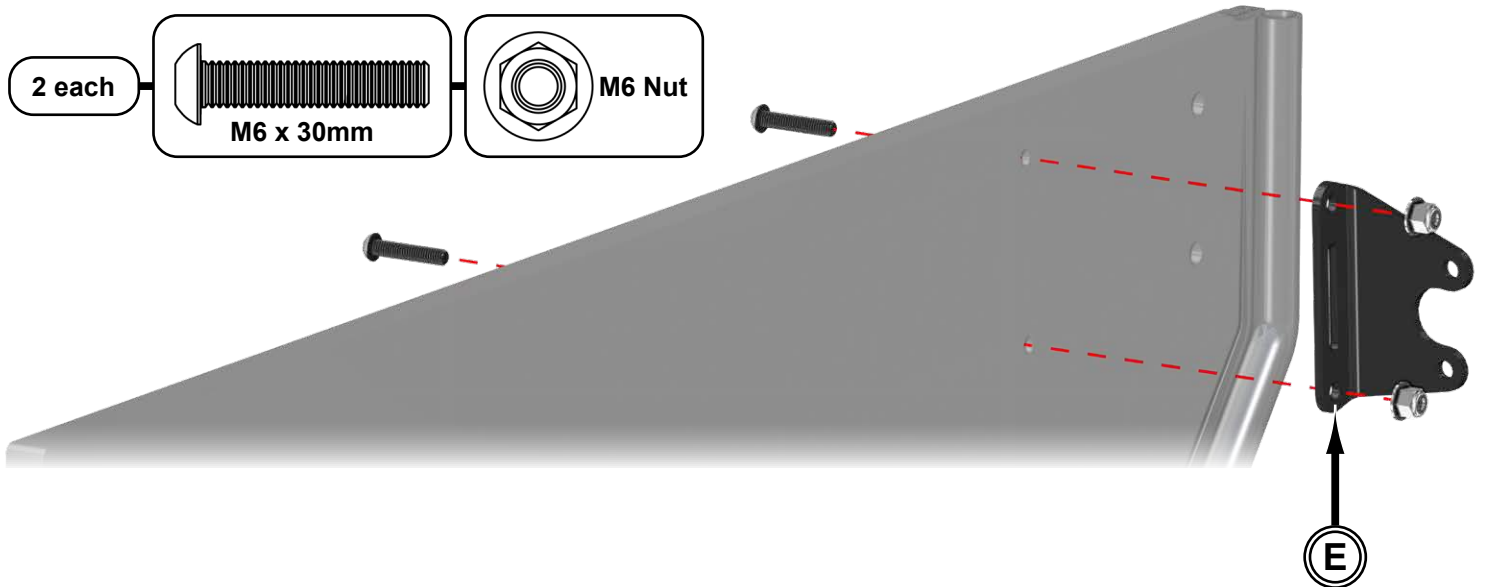

- Join Latch - L (D) to Door Latch Mount - L (E) with hardware shown; tighten.
- Install Knob to Latch - L (D) with hardware shown; tighten.

FRONT

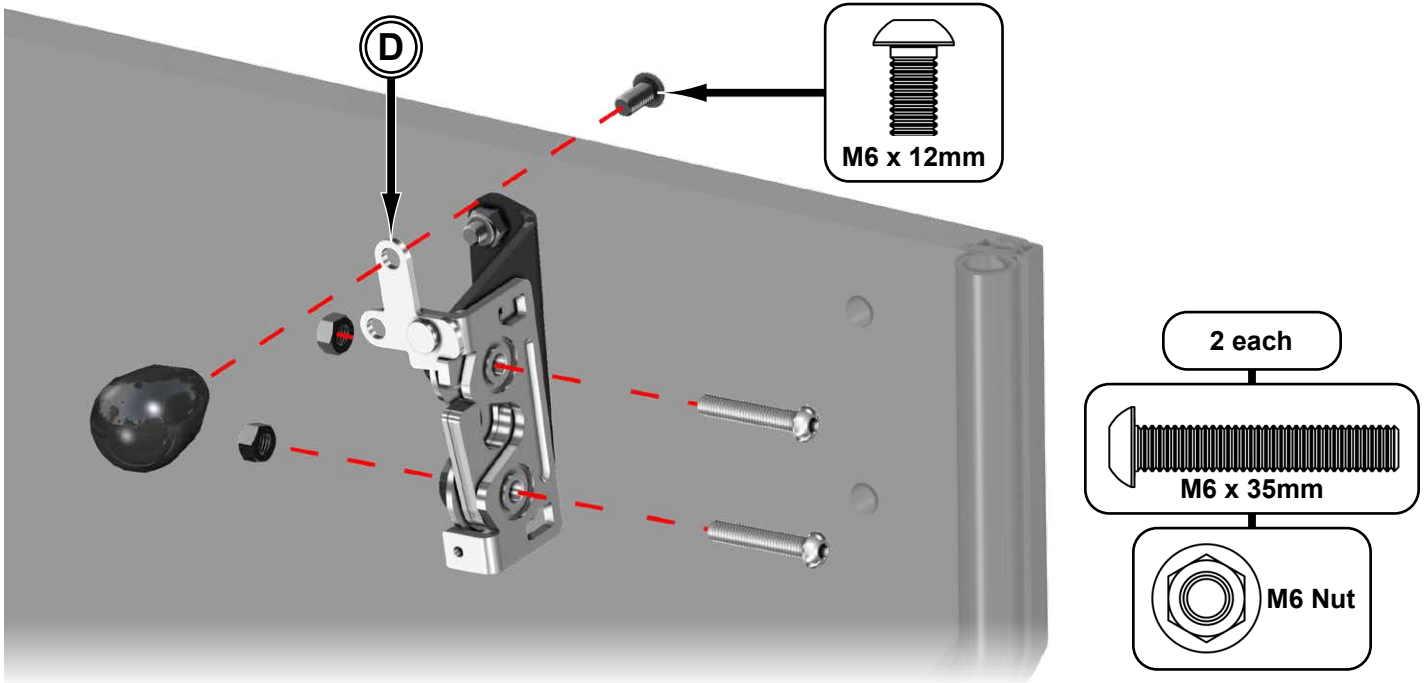

- Install Bulb Seal to location shown on Filler (V).

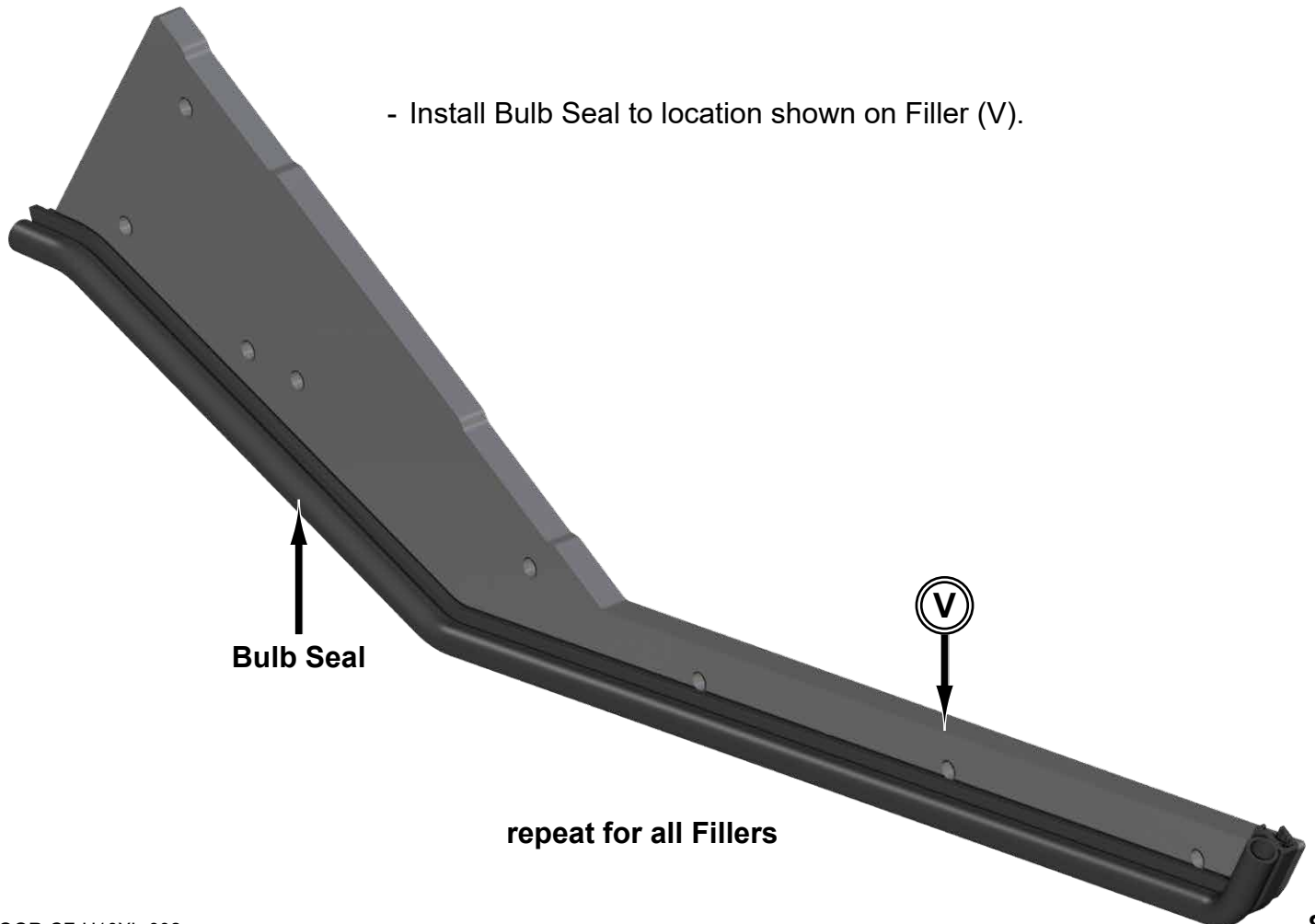

- Install Lower Door Mount - L (A) and Door Mount - L (G) to Filler (V) with hardware shown; tighten.

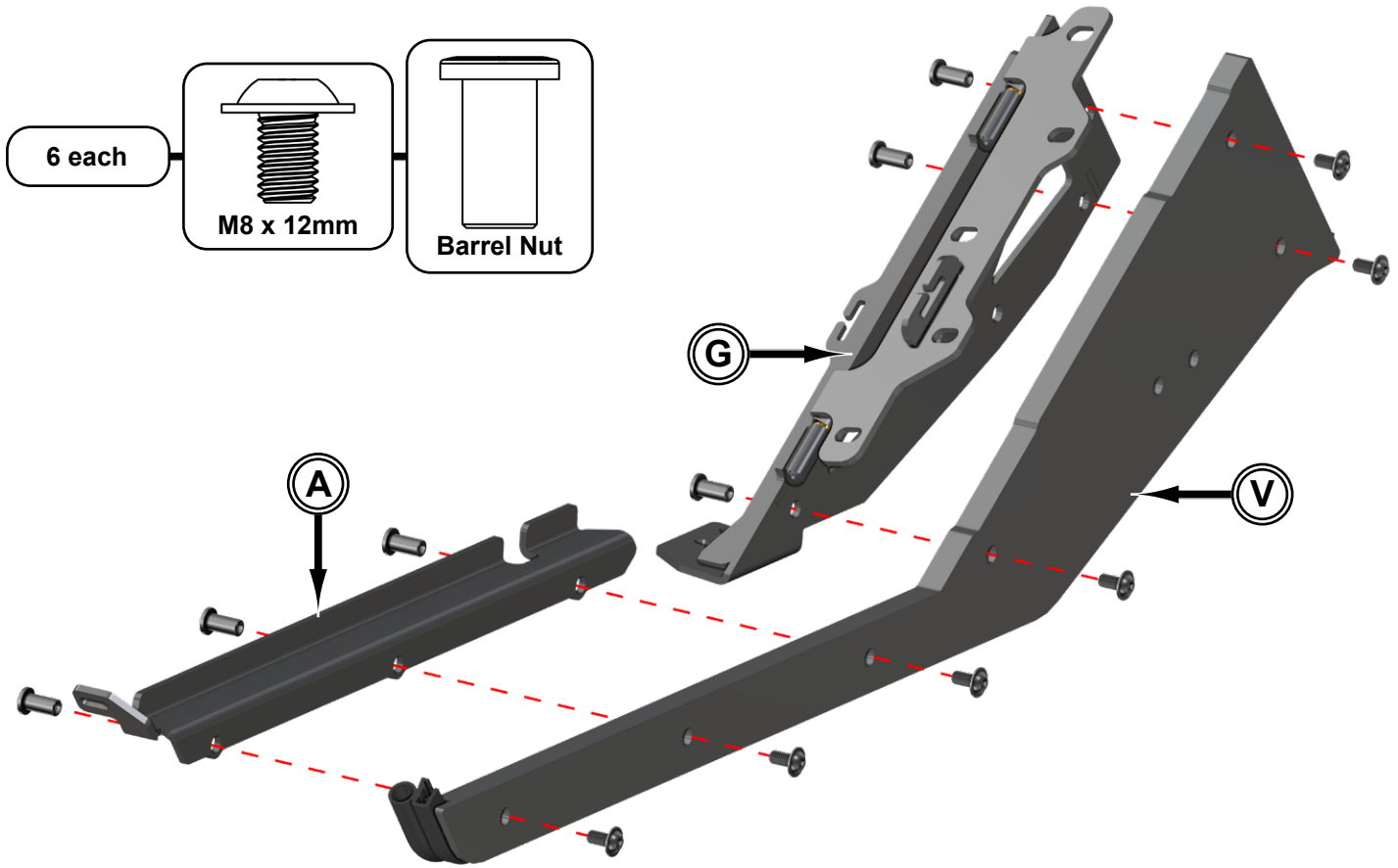

repeat for all Fillers

KEEP HARDWARE SNUG BUT NOT COMPLETELY TIGHT

FRONT

- Install Front Door - L (U) to Filler assembly with hardware shown.

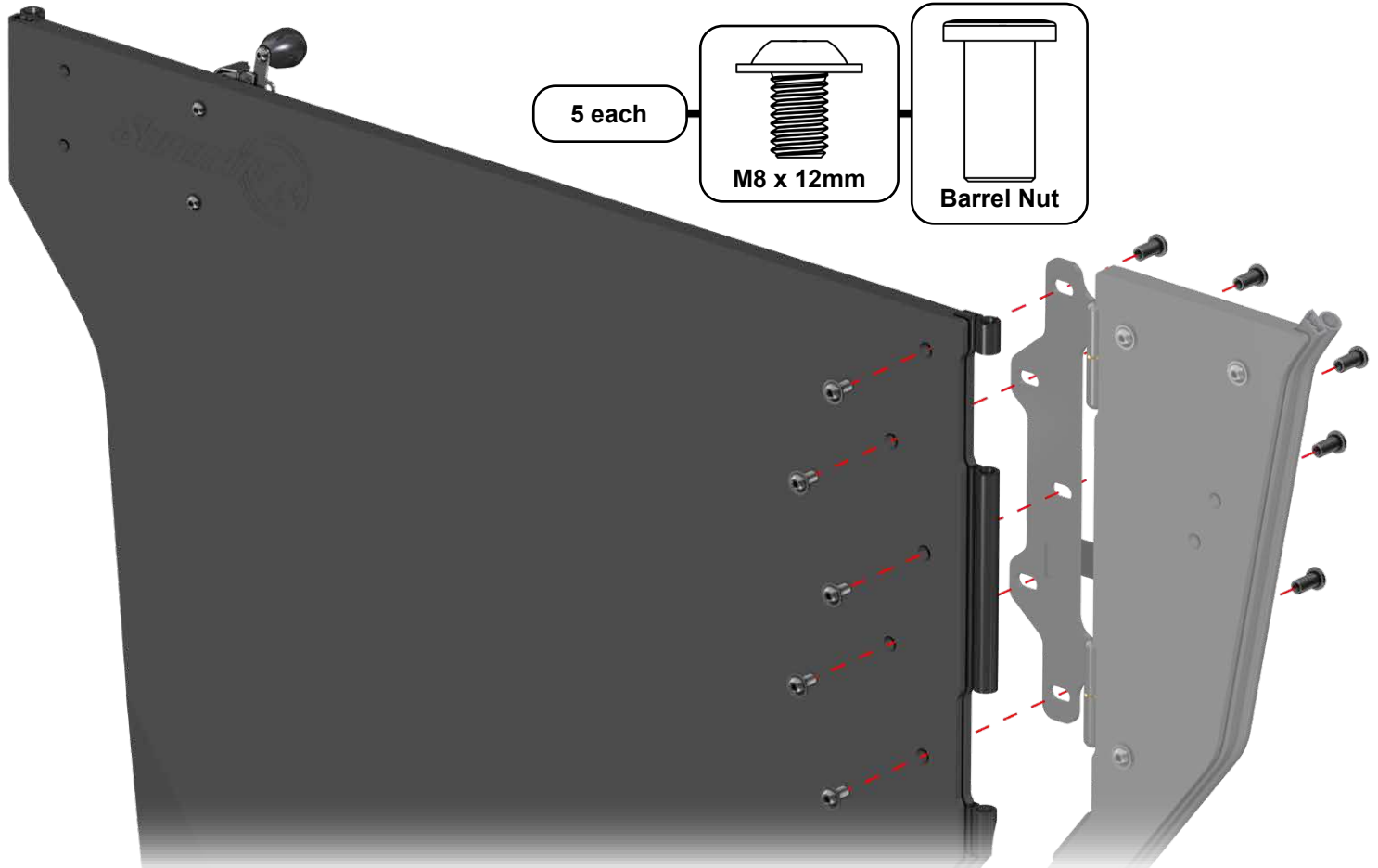

- Install Strap (K).



Strap (K) will install to all Doors

- Remove Seat Belt Hardware and install Washer.
- Reinstall hardware but do not tighten.

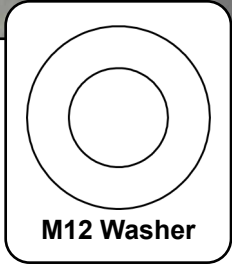
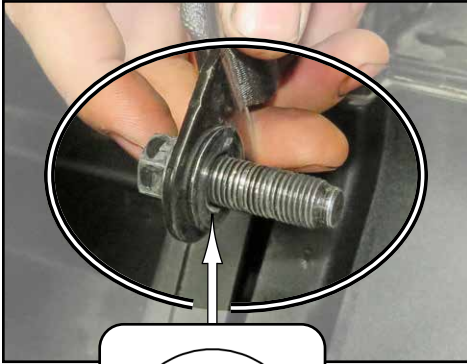

- Install Lower Filler Mount - L (J) onto Seat Belt Hardware.
- Secure with hardware shown; tighten.

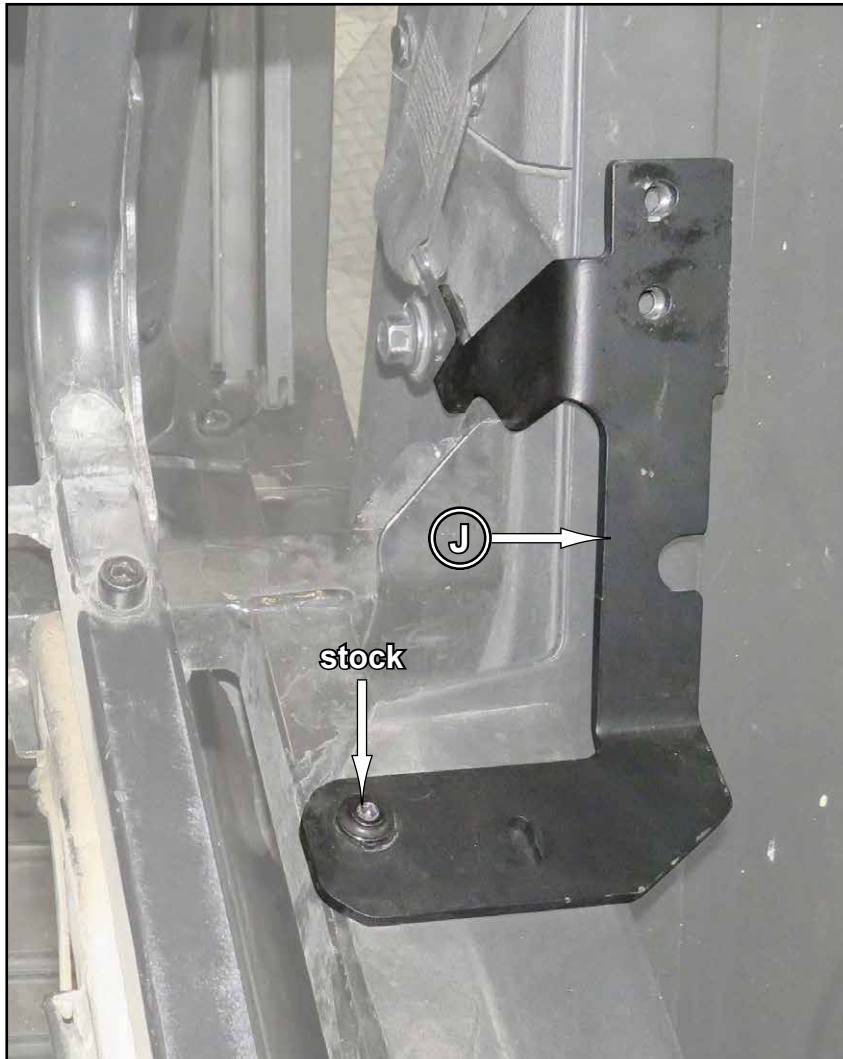

KEEP HARDWARE SNUG BUT NOT COMPLETELY TIGHT

- Install Door assembly to Lower Filler Mount - L (J) with hardware shown.

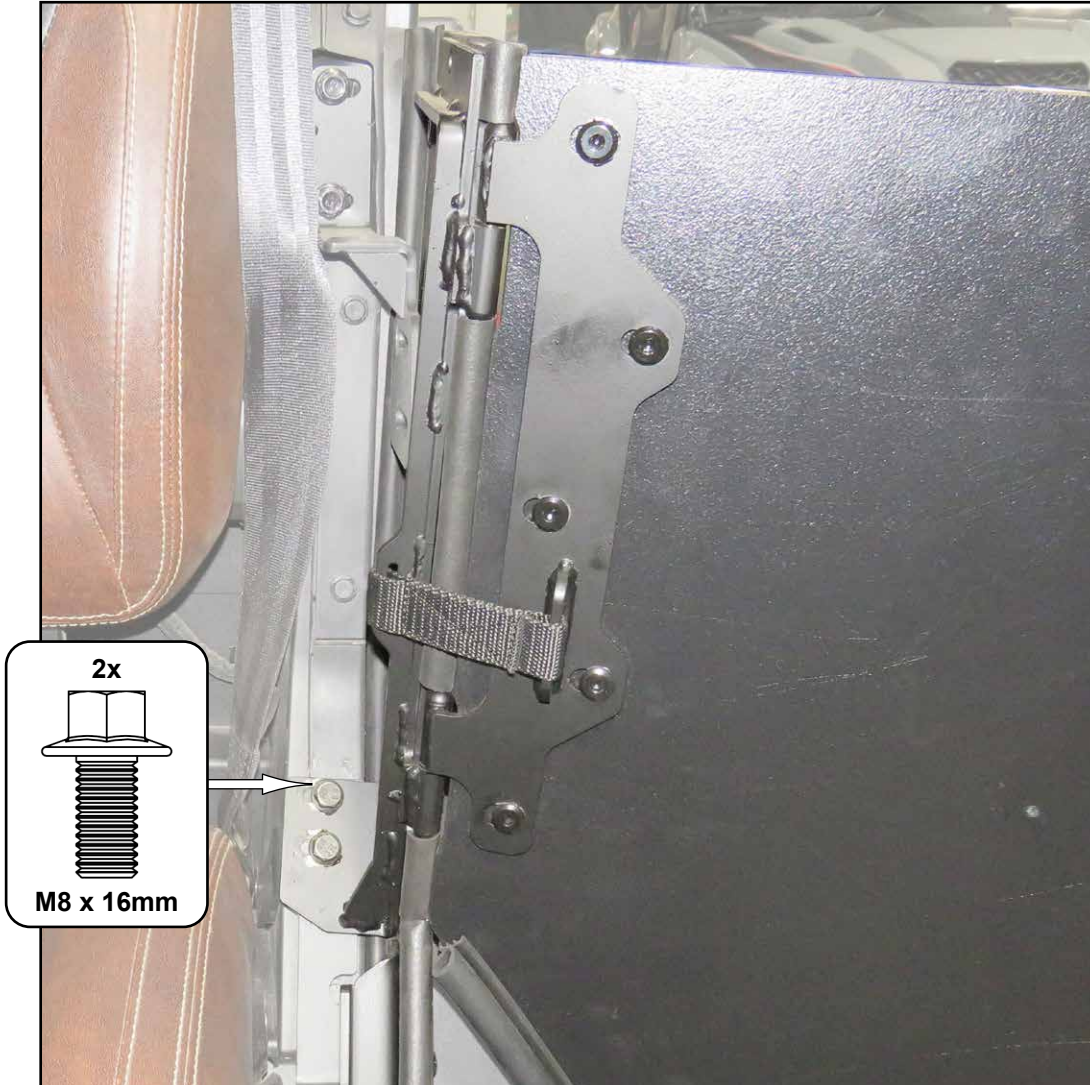

- Secure location on Lower Door Mount - L (A) to machine with hardware shown.



- Secure Filler (V) to Filler Mount - L (F) with hardware shown; tighten.



KEEP HARDWARE SNUG BUT NOT COMPLETELY TIGHT

- Install Striker Mount - L (B) to machine with stock hardware.





align Front Door to machine and tighten **all** hardware completely

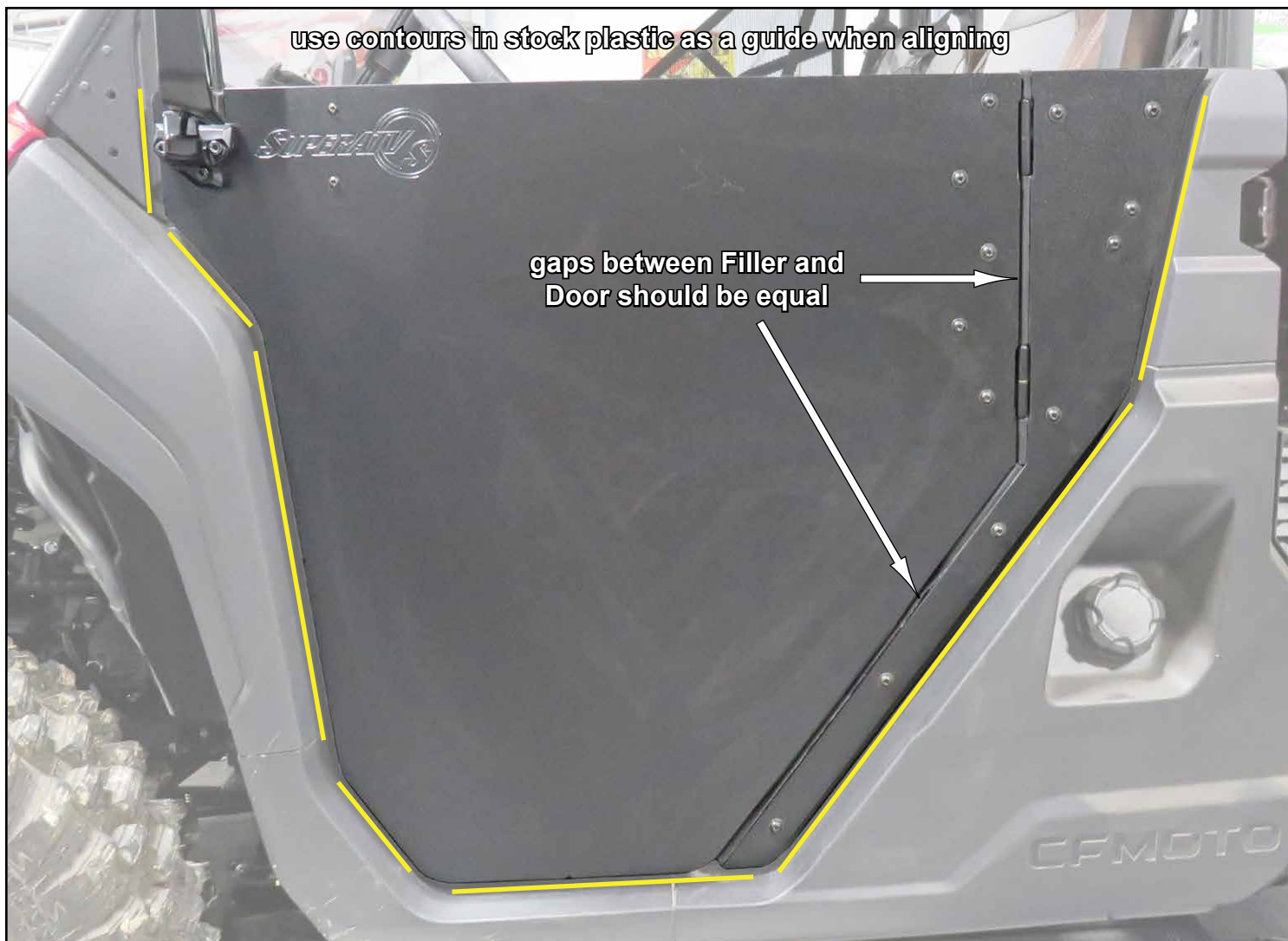

- Repeat steps for passenger side installation.
- Reinstall applicable stock components.

- Install Seals to locations shown on Rear Door - L (R).

REAR

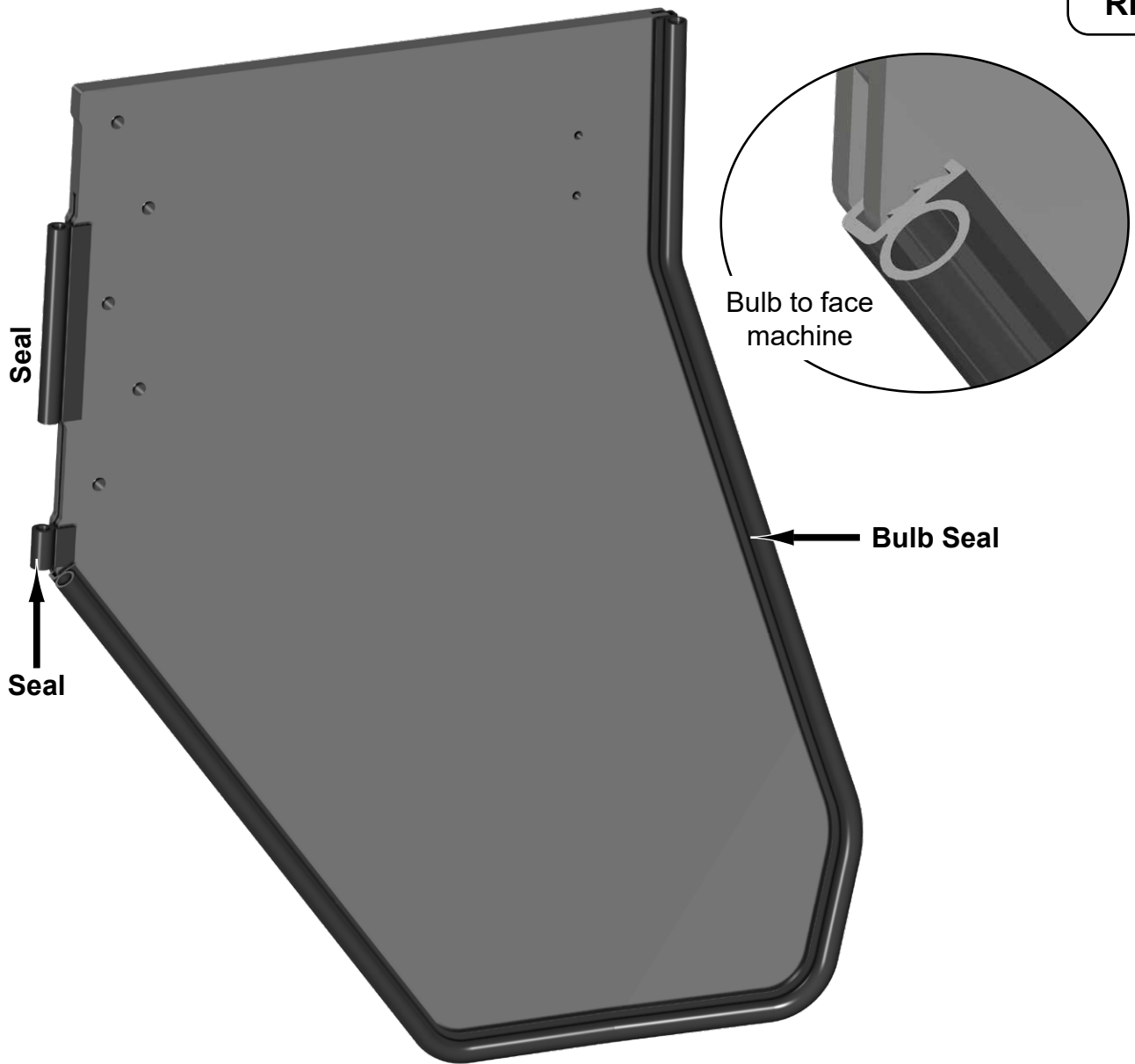

- Install Rear Door Latch Mount - L (C) to Door - L (R) with hardware shown; tighten.

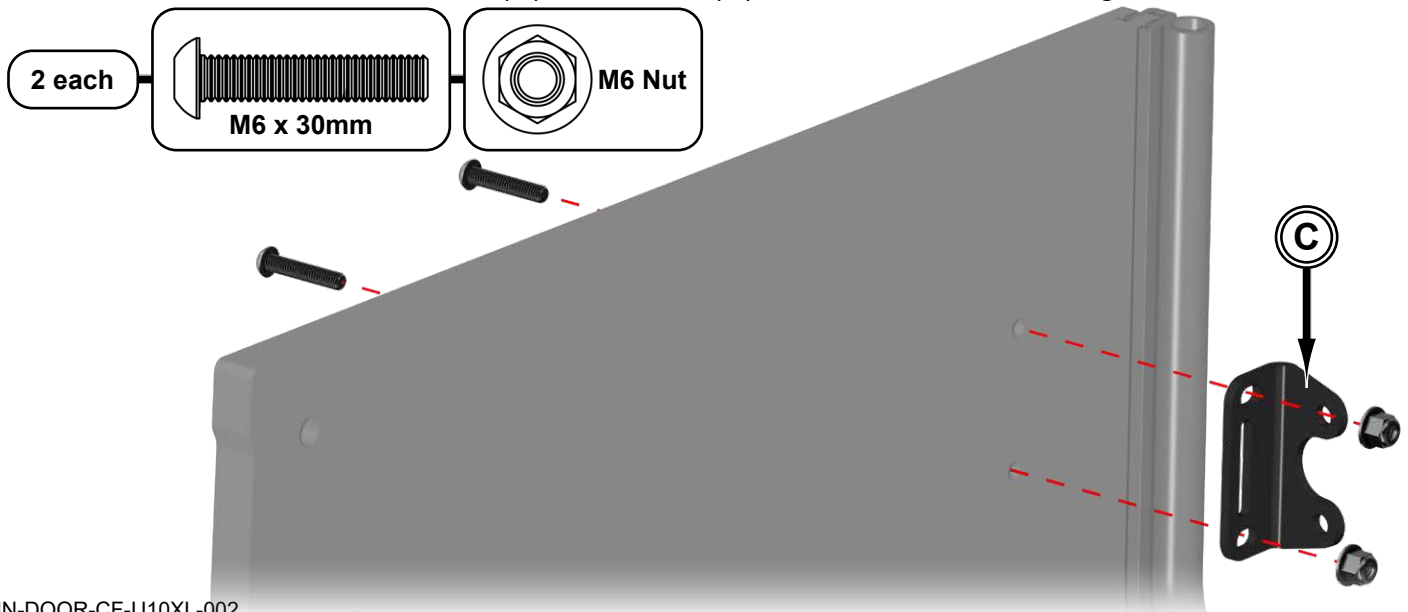

REAR

- Install Knob to Latch - L (D) with hardware shown; tighten.
- Join Latch - L (D) to Rear Door Latch Mount - L (C) with hardware shown; tighten.

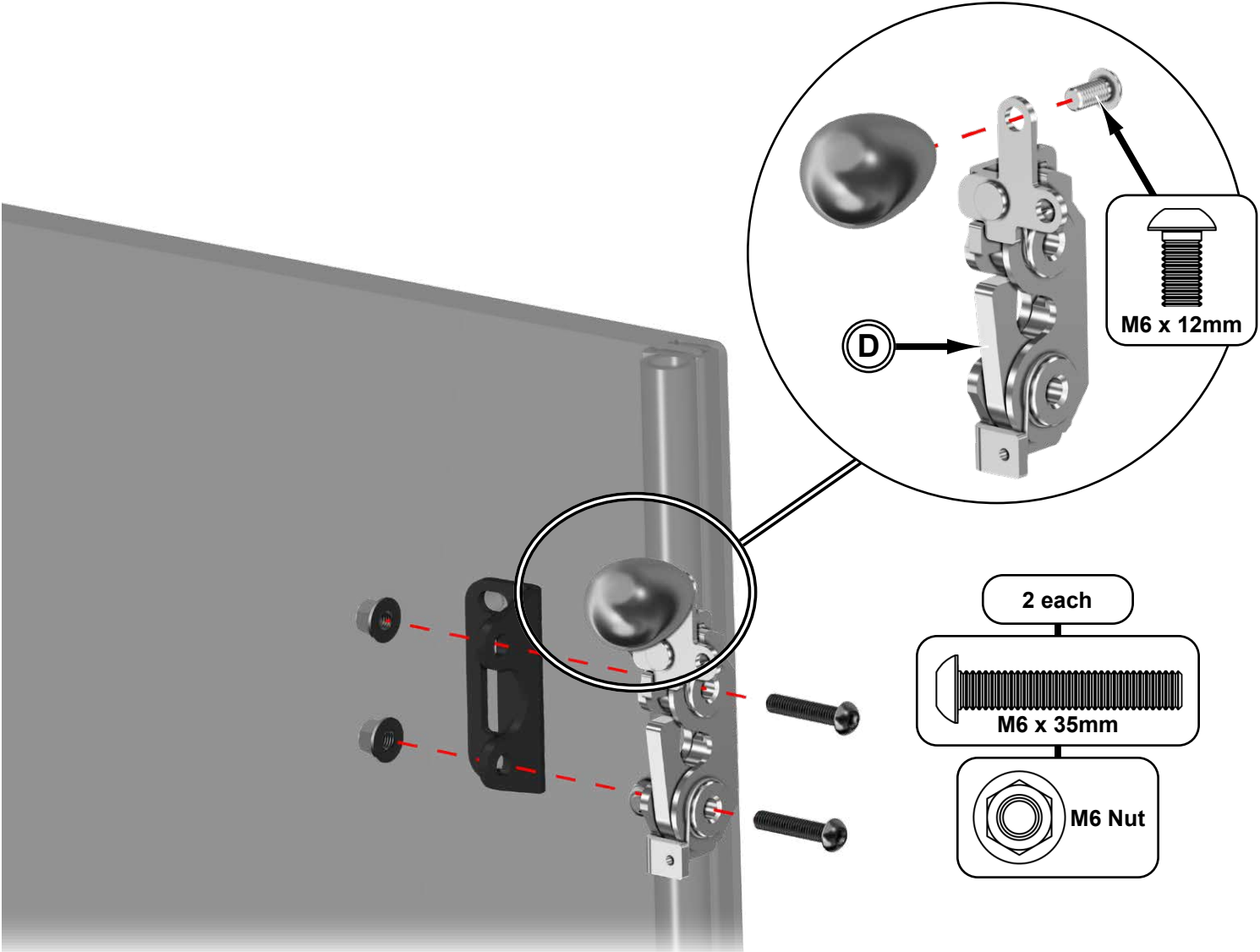

KEEP HARDWARE SNUG BUT NOT COMPLETELY TIGHT

- Install Rear Door - L (R) to Filler assembly with hardware shown.

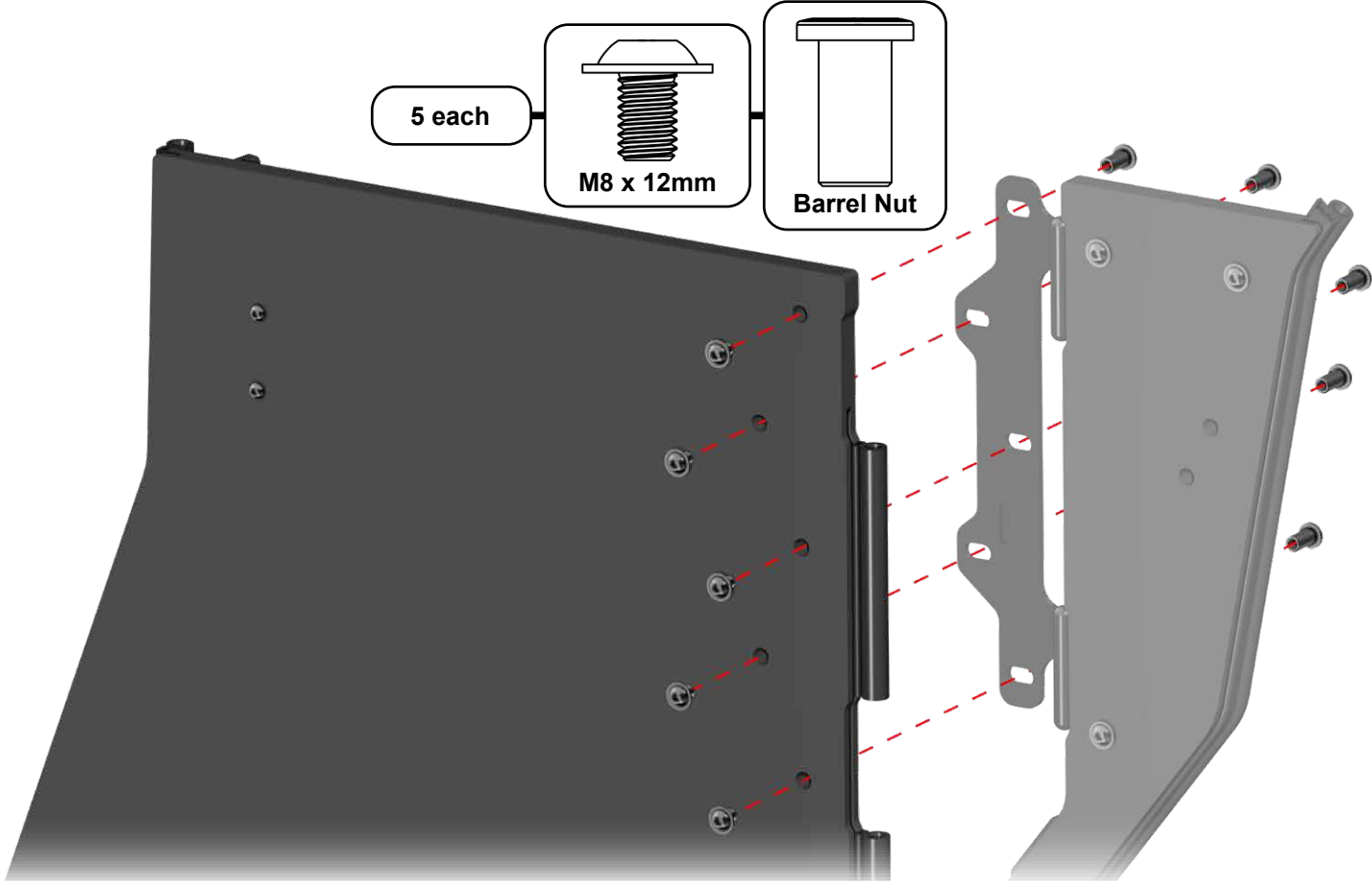

- Install Strap (K); see page 10.

following procedure is for driver side only
remove components shown and pull back Rear Panel

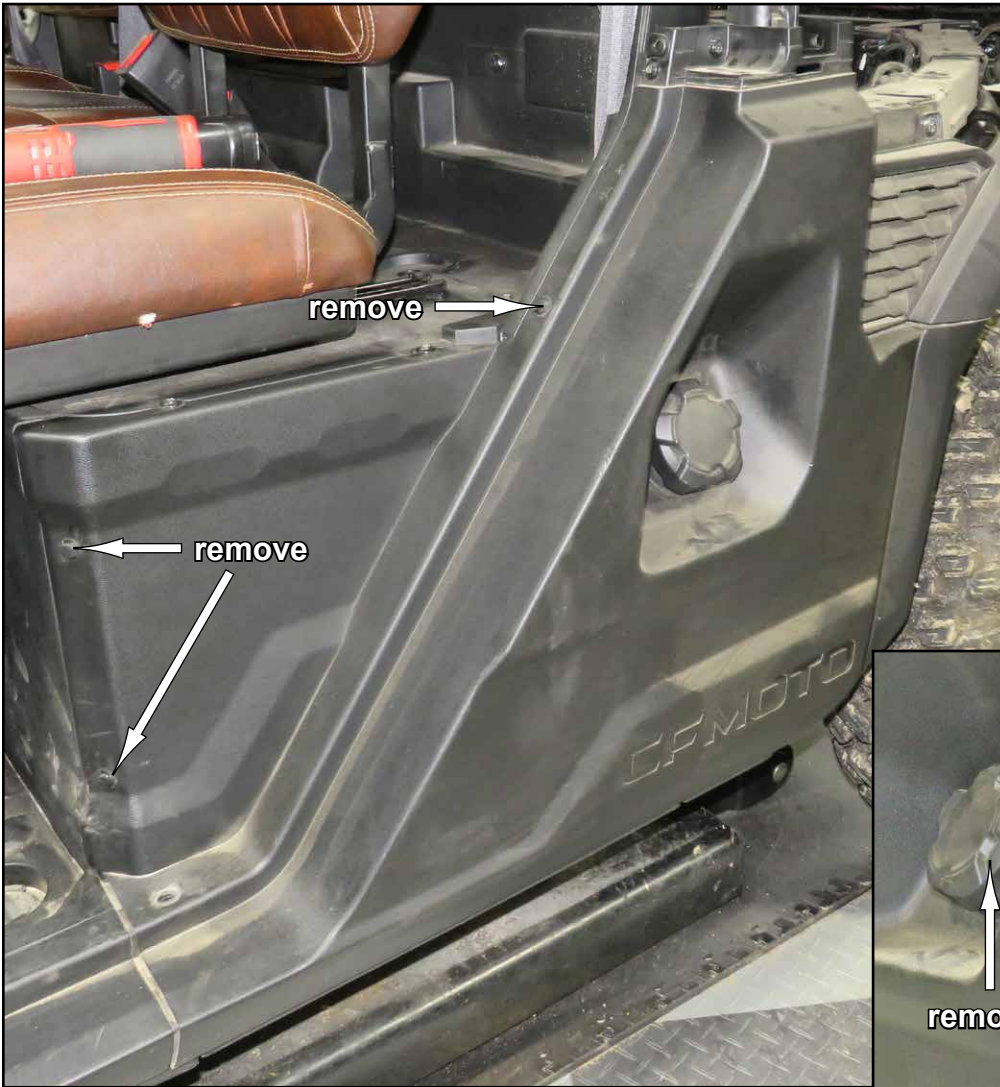

- Install Lower Filler Mount - L (J) and Washer to Seat Belt Hardware.

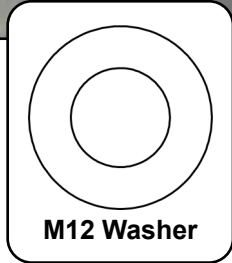
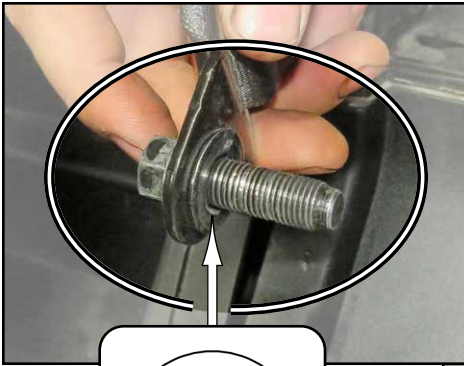

M12 Washer



REAR

- Secure Lower Filler Mount - L (J) with stock hardware.
- Tighten **all** hardware.



Replace components and place Rear Panel back into position; see previous page.

When installing Lower Filler Mount - R (Q), Seat Belt Hardware can be accessed by removing Passenger Seat and Seat Panel.

REAR



KEEP HARDWARE SNUG BUT NOT COMPLETELY TIGHT

- Install Filler Mount - L (F) with hardware shown.

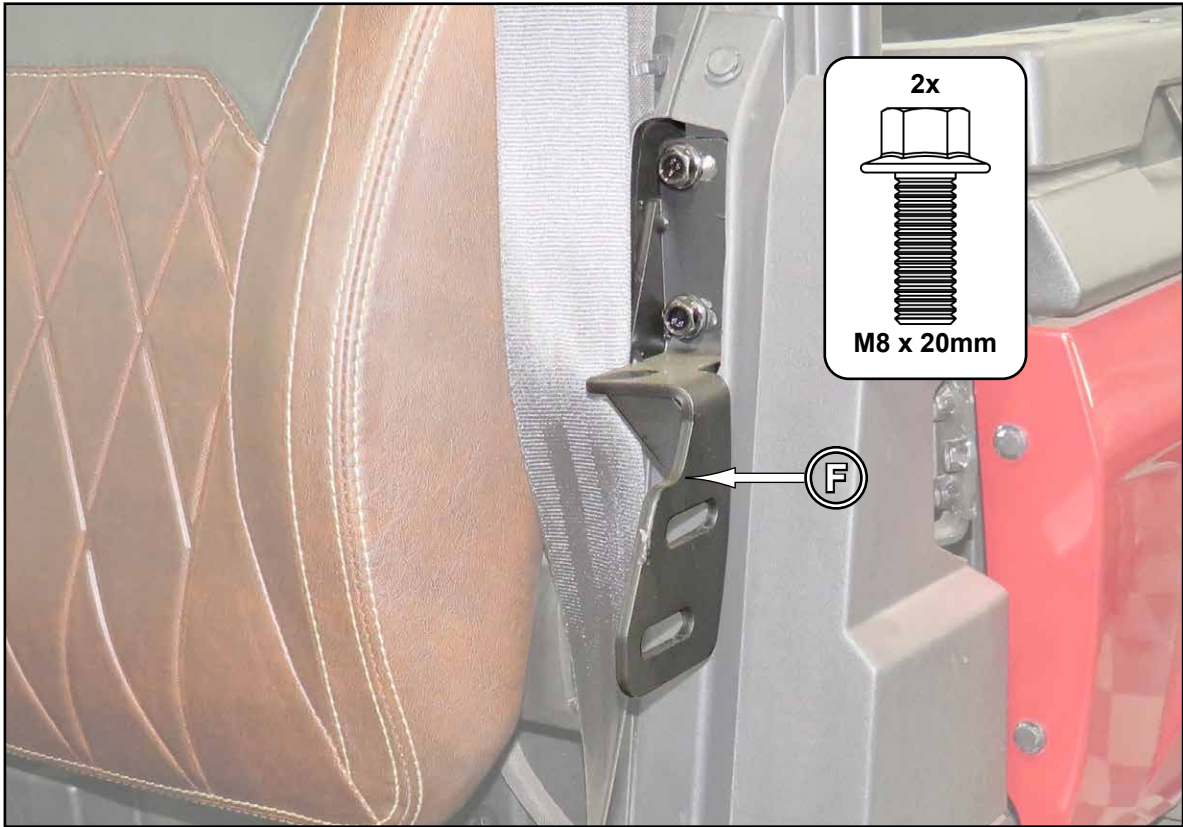

- Secure Filler (V) to Filler Mount - L (F) with hardware shown; tighten.



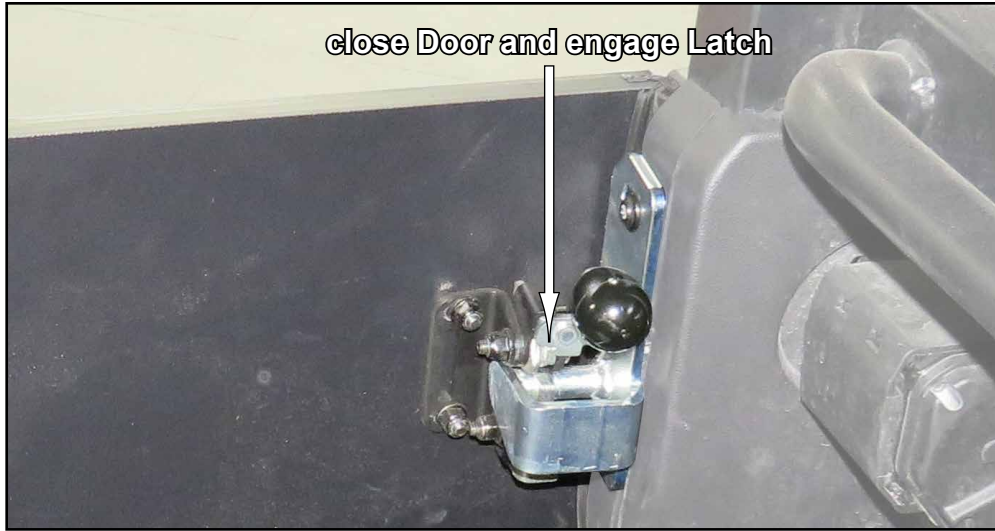

align Rear Door to machine and tighten **all** hardware completely

use contours in stock plastic as a guide when aligning



- Repeat steps for passenger side installation.
- Reinstall applicable stock components.

Optional Mirror to Door installation

- Install stock Mirror Mount to Door - L (U) with hardware shown; tighten.

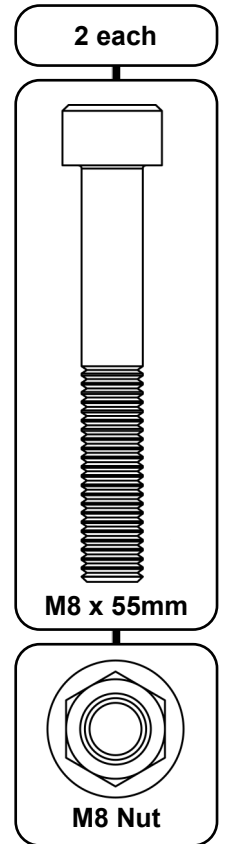

- Install Mirror to Mirror Mount with hardware shown; tighten.

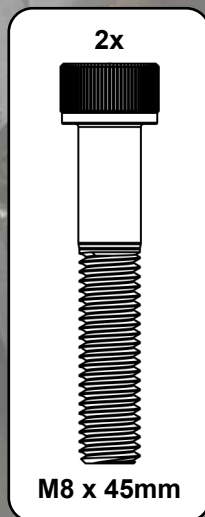

Liability Statement

SuperATV's® products are designed to best fit user's ATV/UTV under stock conditions. Adding, modifying, or fabricating any factory or aftermarket parts will void any warranty provided by SuperATV® and is not recommended. SuperATV's® products could interfere with other aftermarket accessories. If user has aftermarket products on machine, contact SuperATV® to verify that they will work together.

Although SuperATV® has thousands of satisfied customers, user should be aware that installing lift kits, long travel, or suspension kits, tires, etc. will change the ride of machine and may increase maintenance and part wear. Operating any off-road machine while, or after, consuming alcohol and/or drugs increases risk of bodily harm or death. No warranty or representation is made as to this product's ability to protect user from severe injury or death. SuperATV® urges operators and occupants to wear a helmet and appropriate riding gear at all times.

By purchasing and installing SuperATV® products, user agrees that should damages occur, SuperATV® will not be held responsible for loss of time, use, labor fees, replacement parts, or freight charges. SuperATV®, nor any 3rd party, will not be held responsible for any direct, indirect, incidental, special, or consequential damages that result from any product purchased from SuperATV®. The total liability of seller to user for all damages, losses, and causes of action, if any, shall not exceed the total purchase price paid for the product that gave rise to the claim.

SuperATV® will warranty only parts provided by SuperATV®. Any damage or problems with OEM housings, bearings, seals, or other manufacturers' products will not be covered by SuperATV®. SuperATV® parts and products are not warrantied if item was not installed properly, misused, or modified.

Installing, adding, modifying, or fabricating any factory or aftermarket product to your ATV/UTV may violate certain local, state, and federal laws. Be advised that laws vary depending on town, city, county, state, etc. Use of certain products on public streets, roads, or highways may be in violation law. The Buyer is solely and exclusively legally and personally responsible for any violation of the law by the installation or use of the product. You must abide by all local, state, and federal laws, including but not limited to vehicle safety, traffic laws, and ordinances. It is your responsibility to know the laws and how they apply to you.

The Buyer is responsible to fully understand the capability and limitations of his/her vehicle according to manufacturer specifications, warnings and instructions and agrees to hold SuperATV® harmless from any damage resulting from failure to adhere to such specifications, warnings and/ or instructions. The Buyer is also responsible to obey all applicable federal, state, and local laws and ordinances when operating his/her vehicle while using this product, and the Buyer agrees to hold SuperATV® harmless from any violation thereof.