

- Do not discard packaging until product has been successfully installed.
- While routing wires, follow factory wiring when possible and avoid rotating and/or hot components.
- Use provided wire ties and secure wires and Harnesses as needed.
- SuperATV does not recommend keeping Windshield installed while transporting on an open air trailer. Remove or secure with straps.
- Before beginning Power Flip Windshield installation, refer to optional Windshield Wiper Kit instructions. Some installation steps between products will occur.

Optional WWK-005 Wiper Kit is shown being installed. Disregard all Wiper Kit references if not installing Wiper Kit at this time.

Liability Statement

SuperATV's® products are designed to best fit user's ATV/UTV under stock conditions. Adding, modifying, or fabricating any factory or aftermarket parts will void any warranty provided by SuperATV® and is not recommended. SuperATV's® products could interfere with other aftermarket accessories. If user has aftermarket products on machine, contact SuperATV® to verify that they will work together.

Although SuperATV® has thousands of satisfied customers, user should be aware that installing lift kits, long travel, or suspension kits, tires, etc. will change the ride of machine and may increase maintenance and part wear. Operating any off-road machine while, or after, consuming alcohol and/or drugs increases risk of bodily harm or death. No warranty or representation is made as to this product's ability to protect user from severe injury or death. SuperATV® urges operators and occupants to wear a helmet and appropriate riding gear at all times.

By purchasing and installing SuperATV® products, user agrees that should damages occur, SuperATV® will not be held responsible for loss of time, use, labor fees, replacement parts, or freight charges. SuperATV®, nor any 3rd party, will not be held responsible for any direct, indirect, incidental, special, or consequential damages that result from any product purchased from SuperATV®. The total liability of seller to user for all damages, losses, and causes of action, if any, shall not exceed the total purchase price paid for the product that gave rise to the claim.

SuperATV® will warranty only parts provided by SuperATV®. Any damage or problems with OEM housings, bearings, seals, or other manufacturers' products will not be covered by SuperATV®. SuperATV® parts and products are not warranted if item was not installed properly, misused, or modified.

Installing, adding, modifying, or fabricating any factory or aftermarket product to your ATV/UTV may violate certain local, state, and federal laws. Be advised that laws vary depending on town, city, county, state, etc. Use of certain products on public streets, roads, or highways may be in violation law. The Buyer is solely and exclusively legally and personally responsible for any violation of the law by the installation or use of the product. You must abide by all local, state, and federal laws, including but not limited to vehicle safety, traffic laws, and ordinances. It is your responsibility to know the laws and how they apply to you.

The Buyer is responsible to fully understand the capability and limitations of his/her vehicle according to manufacturer specifications, warnings and instructions and agrees to hold SuperATV® harmless from any damage resulting from failure to adhere to such specifications, warnings and/ or instructions. The Buyer is also responsible to obey all applicable federal, state, and local laws and ordinances when operating his/her vehicle while using this product, and the Buyer agrees to hold SuperATV® harmless from any violation thereof.

Need help with your installation?



sales@superatv.com



www.superatv.com



1-855-743-3427



8:00am - 8:00pm EST M-Th
8:00am - 7:00pm EST Friday
9:00am - 2:00pm EST Saturday

Read instructions and view illustrations before beginning.

*Thank You
For Choosing*

SUPERATV.COM[®]

Item	Description
A	Windshield
B	Hinge x 2
C	Actuator Mount R
D	Actuator Mount L
E	Actuator Bracket R
F	Actuator Bracket L
G	Actuator x 2
H	Top
J	Wire Guide

(Kit contents)



Do not discard any Wire Guide. Optional Wiper Kit will also use a section of Wire Guide.

(Kit contents continued)

Switch Harness

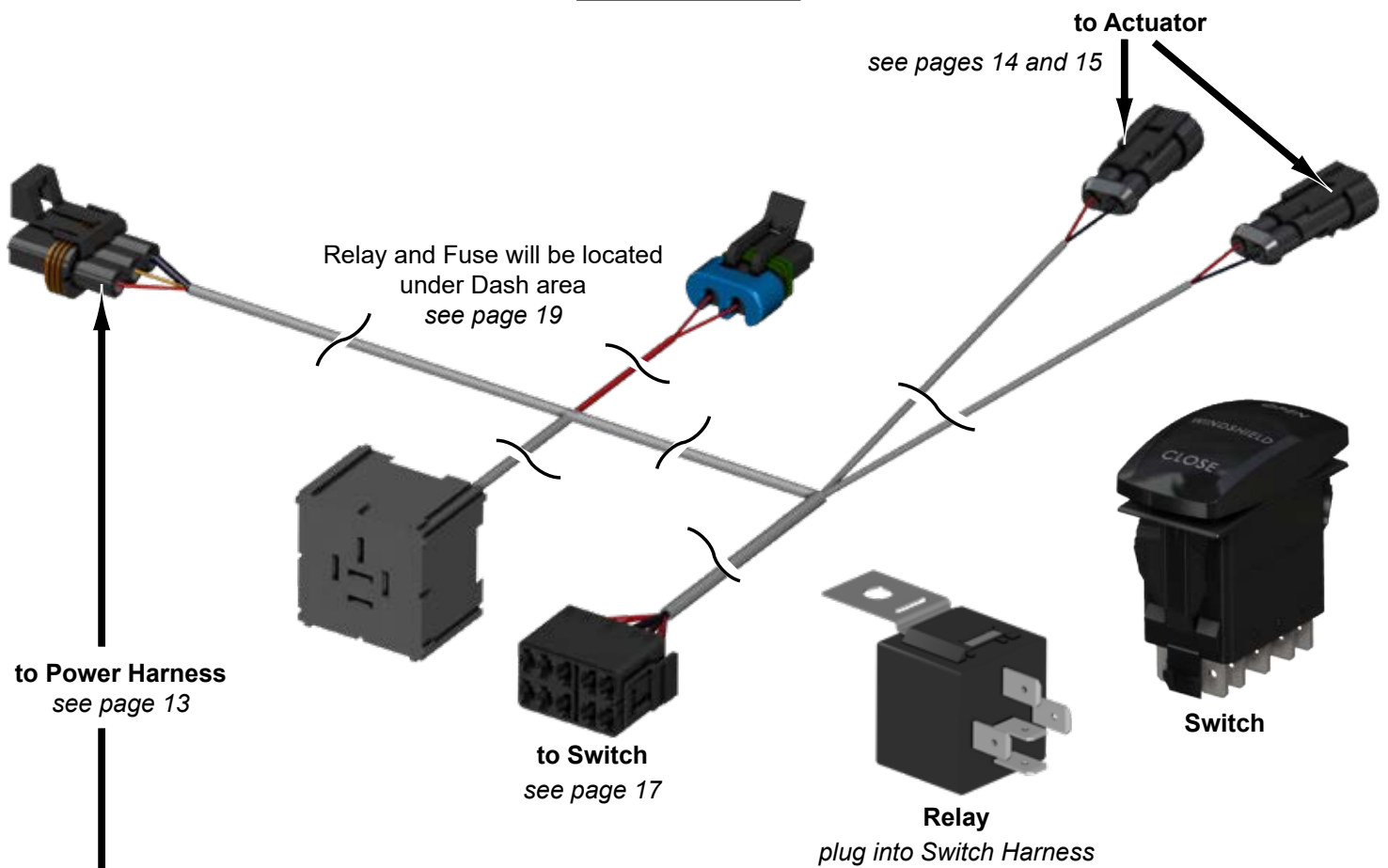

Power Harness

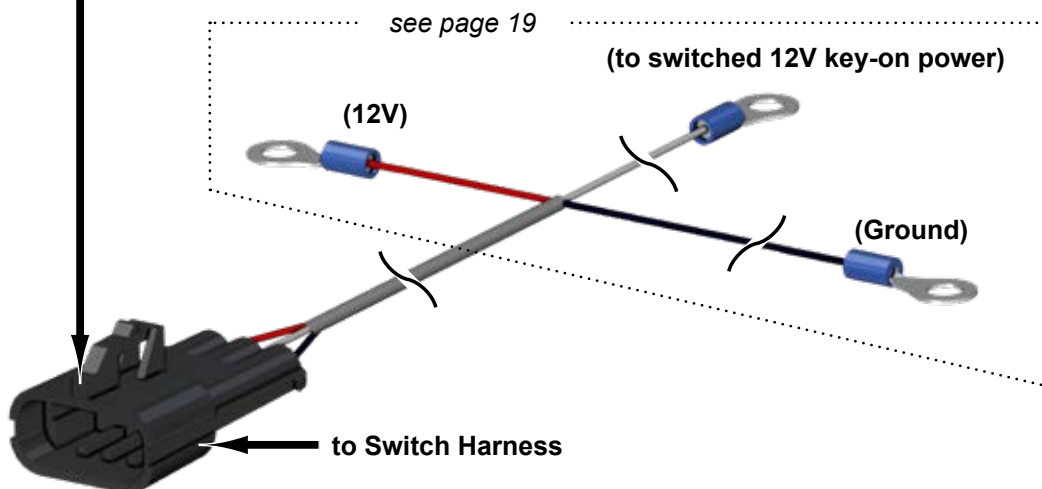

Windshield Wiper Kit:

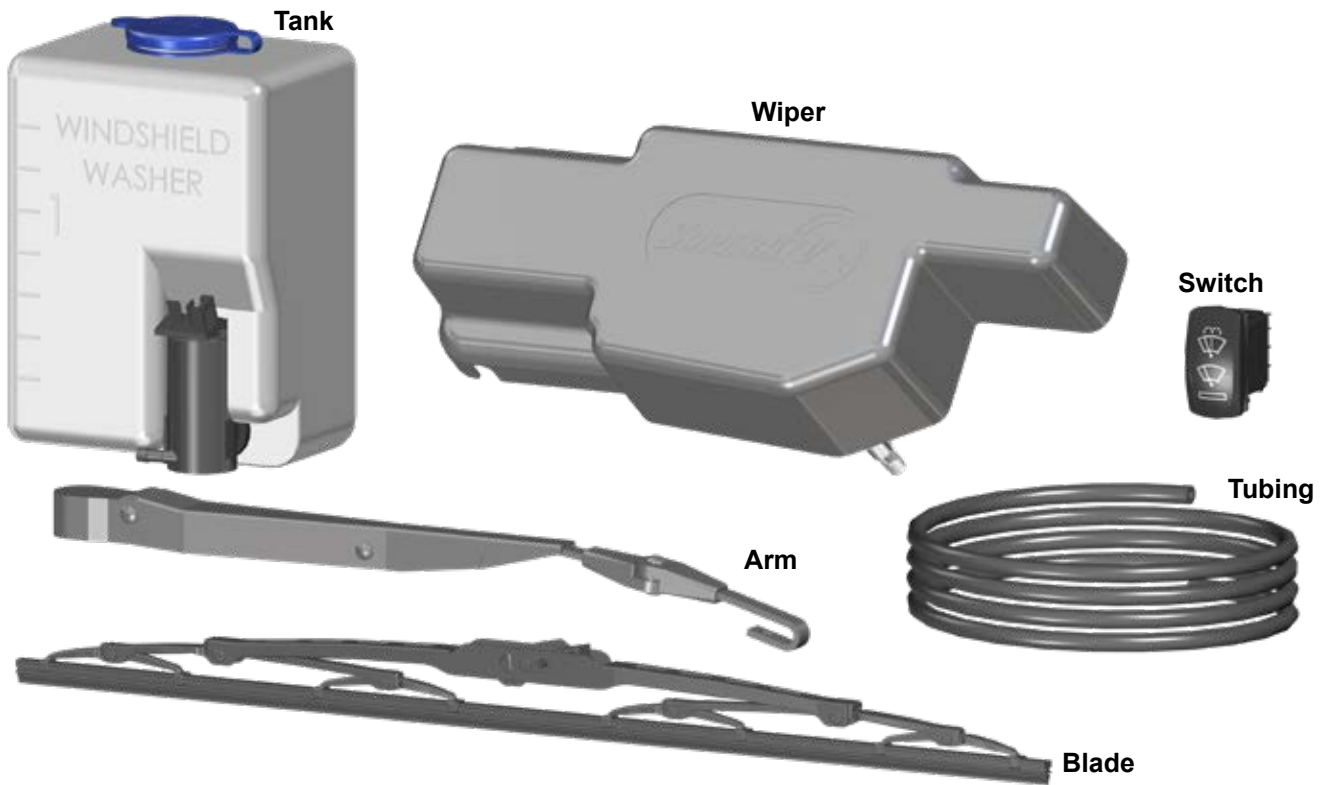

remove Tank Bracket from Tank →



Windshield Wiper Kit Switch Harness

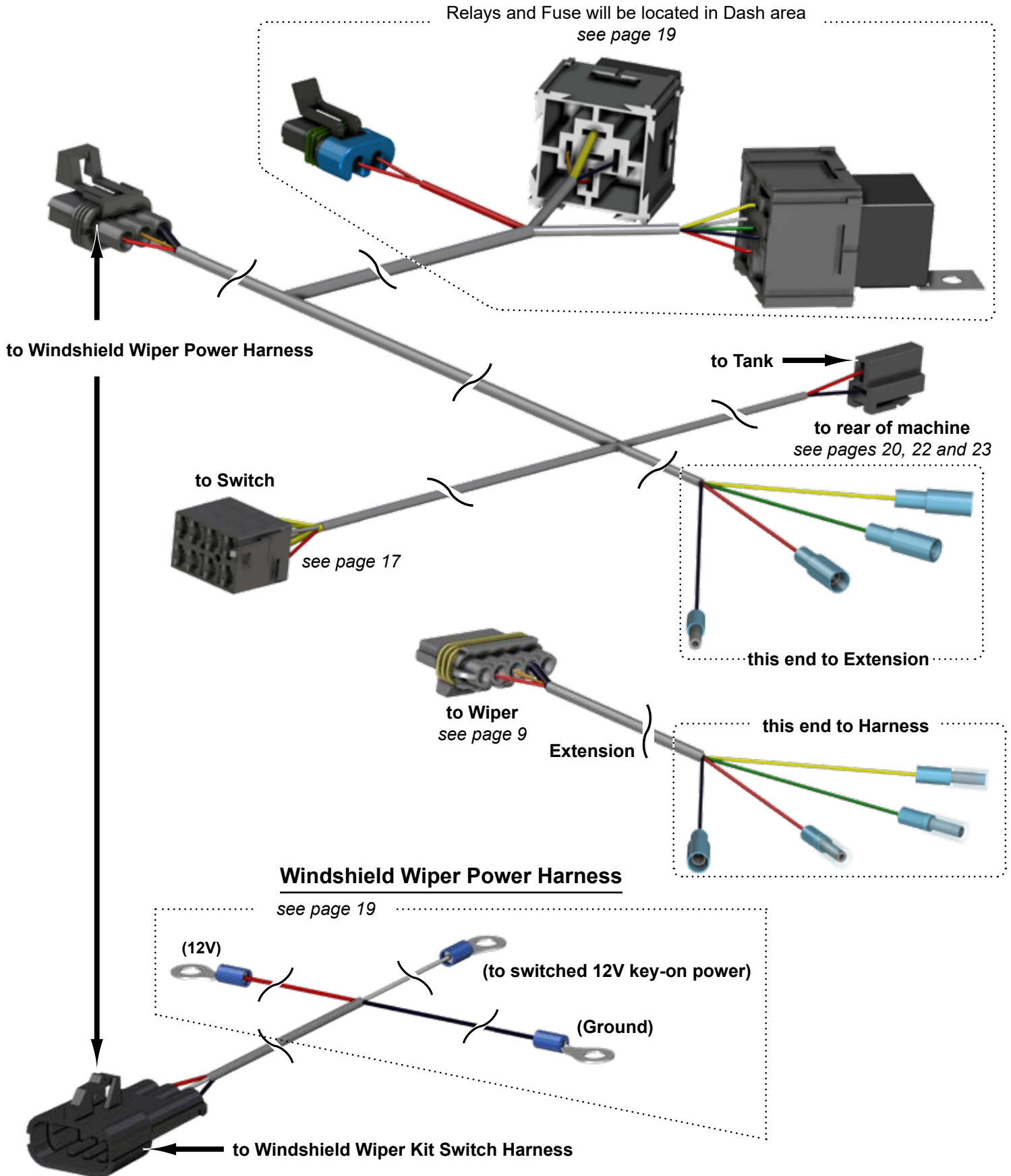

- Install Hinges (B) to Windshield (A) with hardware shown; tighten.

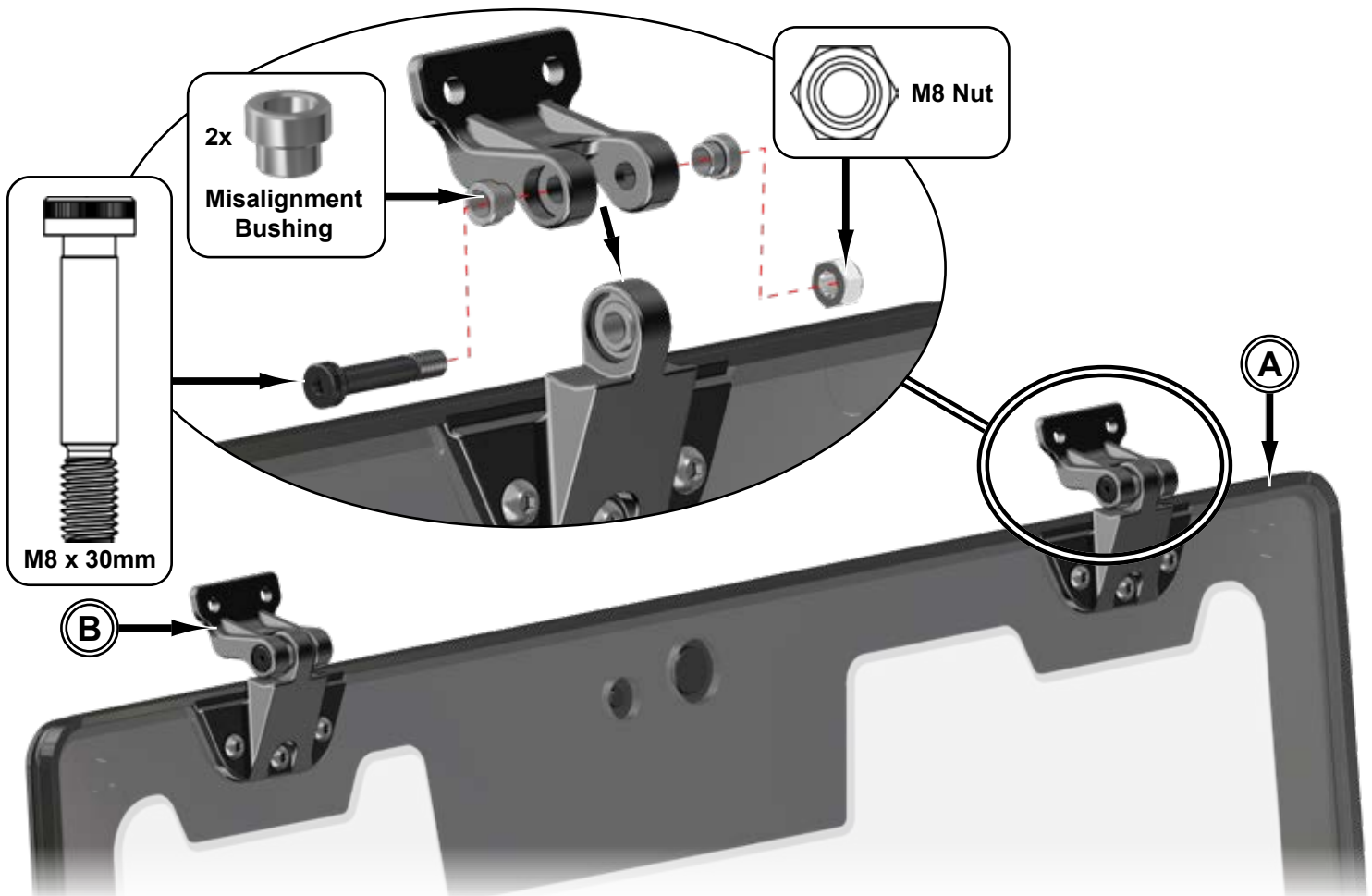

- Install D-Seal to sides of Top (H).

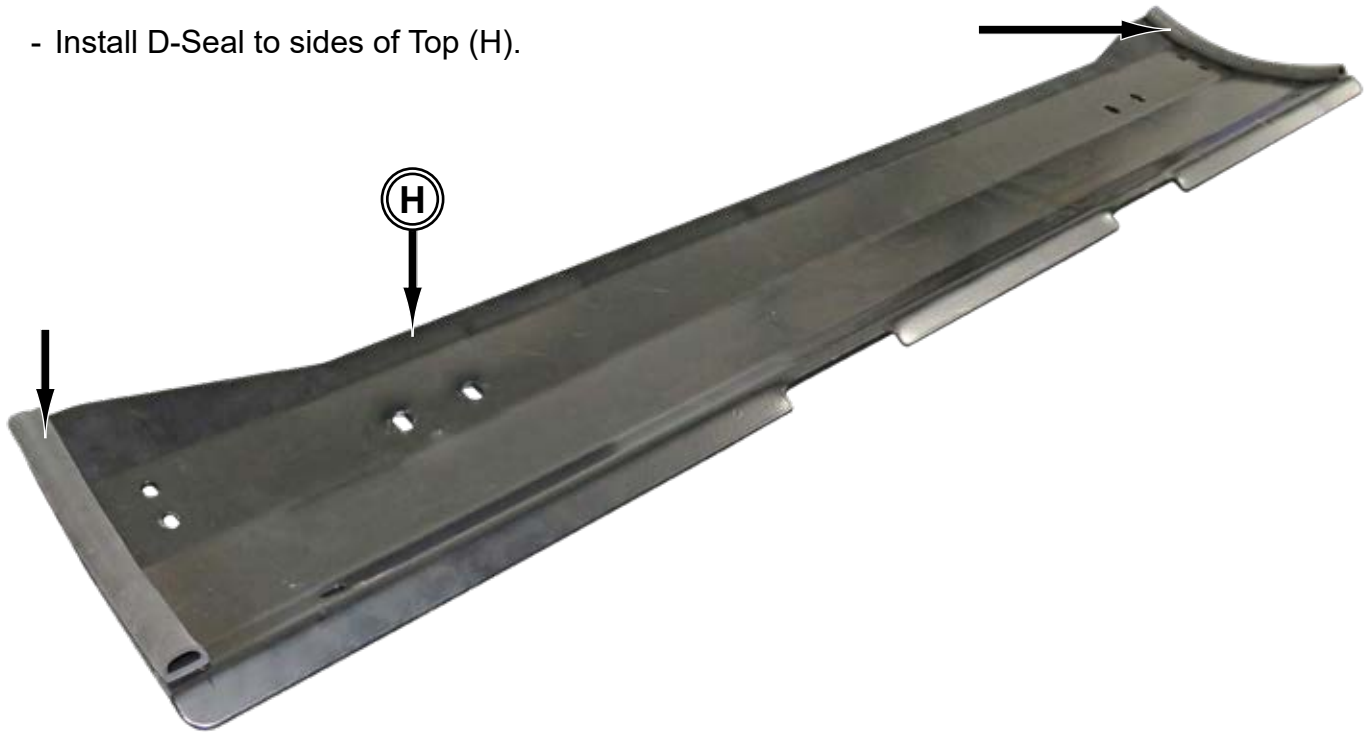

- Install Top (H) to machine with hardware shown; tighten.



- Install assembly to Top (H) with hardware shown; do not tighten.



- Adjust assembly so that gaps between sides of Windshield and Frame are equal.
- Tighten all hardware.



Windshield Wiper Kit only

Prep Wiper as shown.

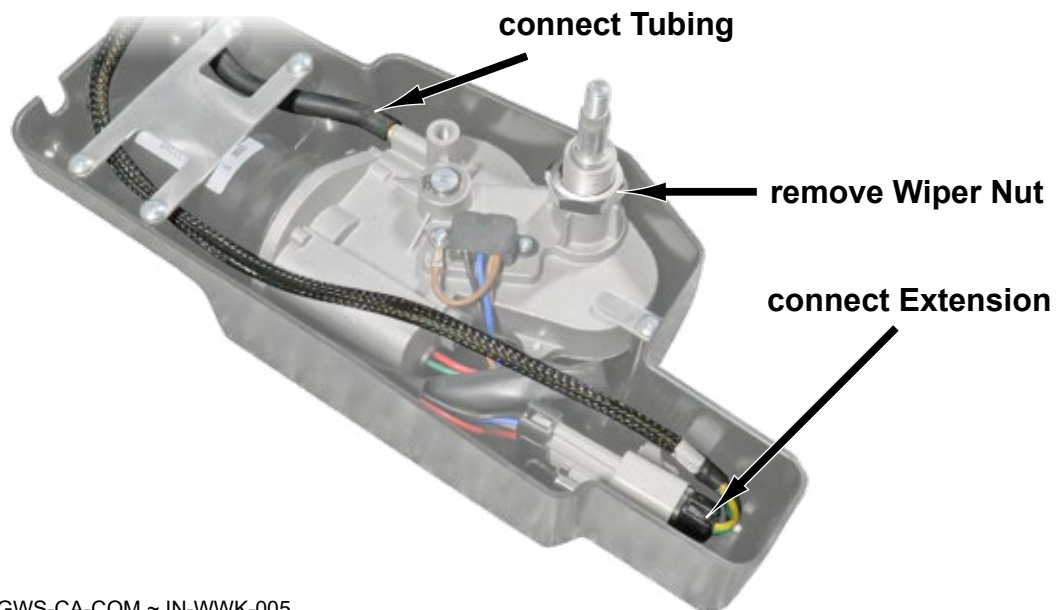

Windshield Wiper Kit only

- Remove Plugs from Windshield (A).
- Install Wiper to Windshield with components shown.
- Tighten hardware.

Nozzle should face bottom of Windshield and stick out approximately 13/16".

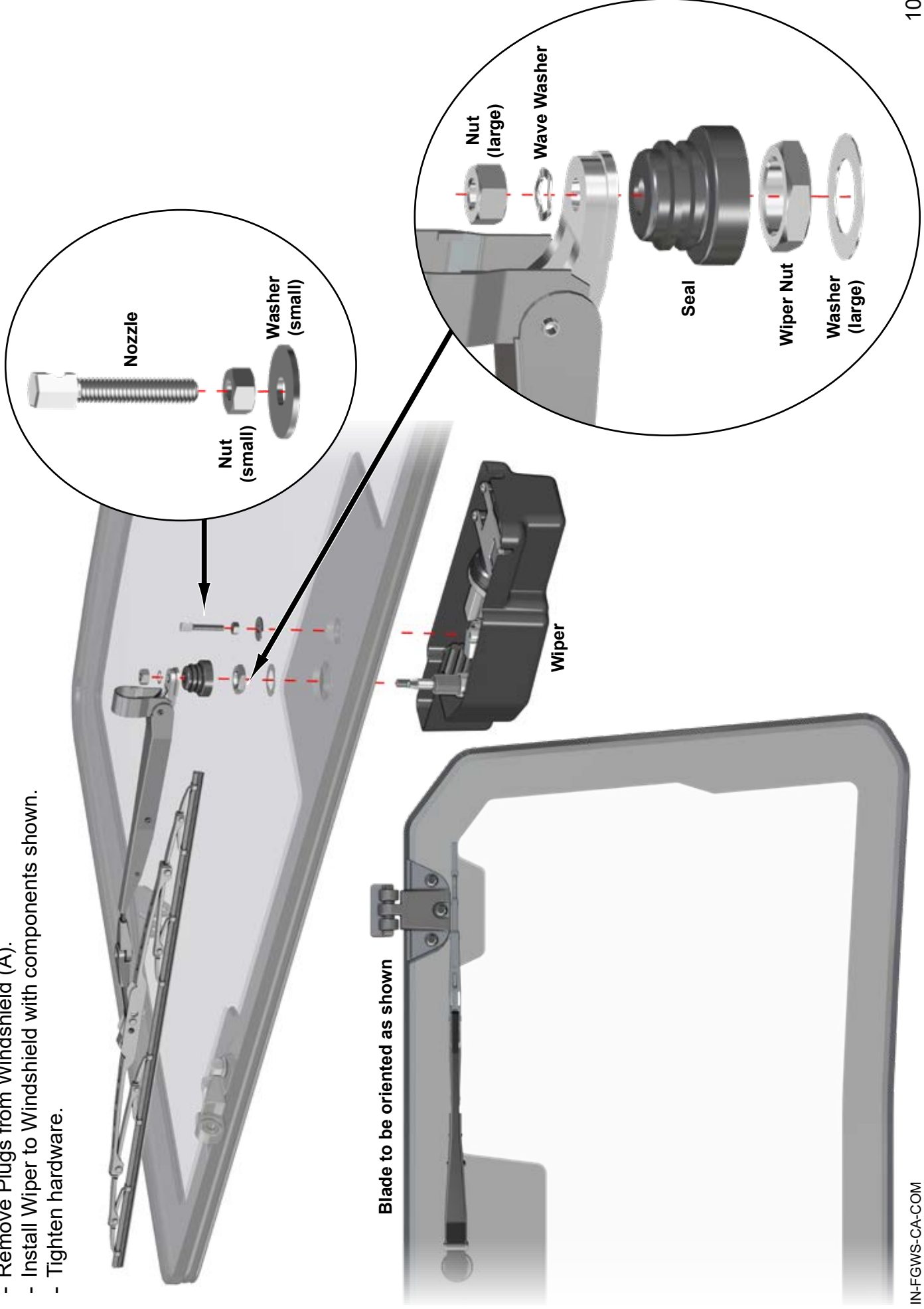

- Assemble Actuator Mount R (C) to Actuator Bracket R (E) with hardware shown; do not tighten.

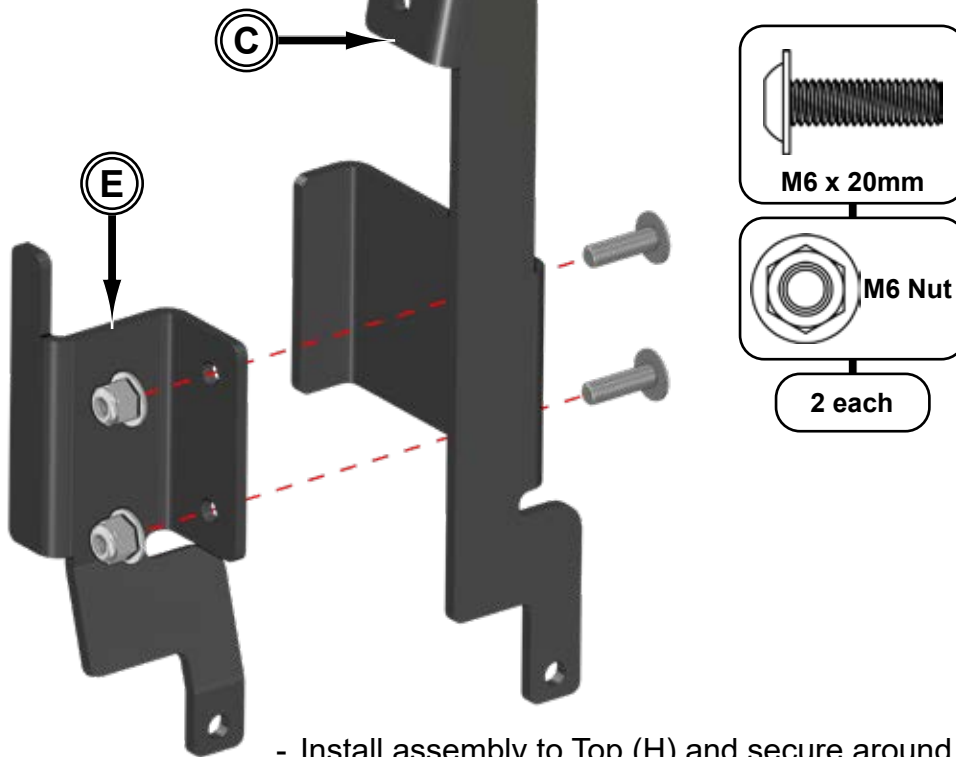

- Install assembly to Top (H) and secure around Frame with hardware shown.
- Tighten *all* hardware.



- Secure Actuator (G) with hardware shown; tighten.
- Repeat for driver side.

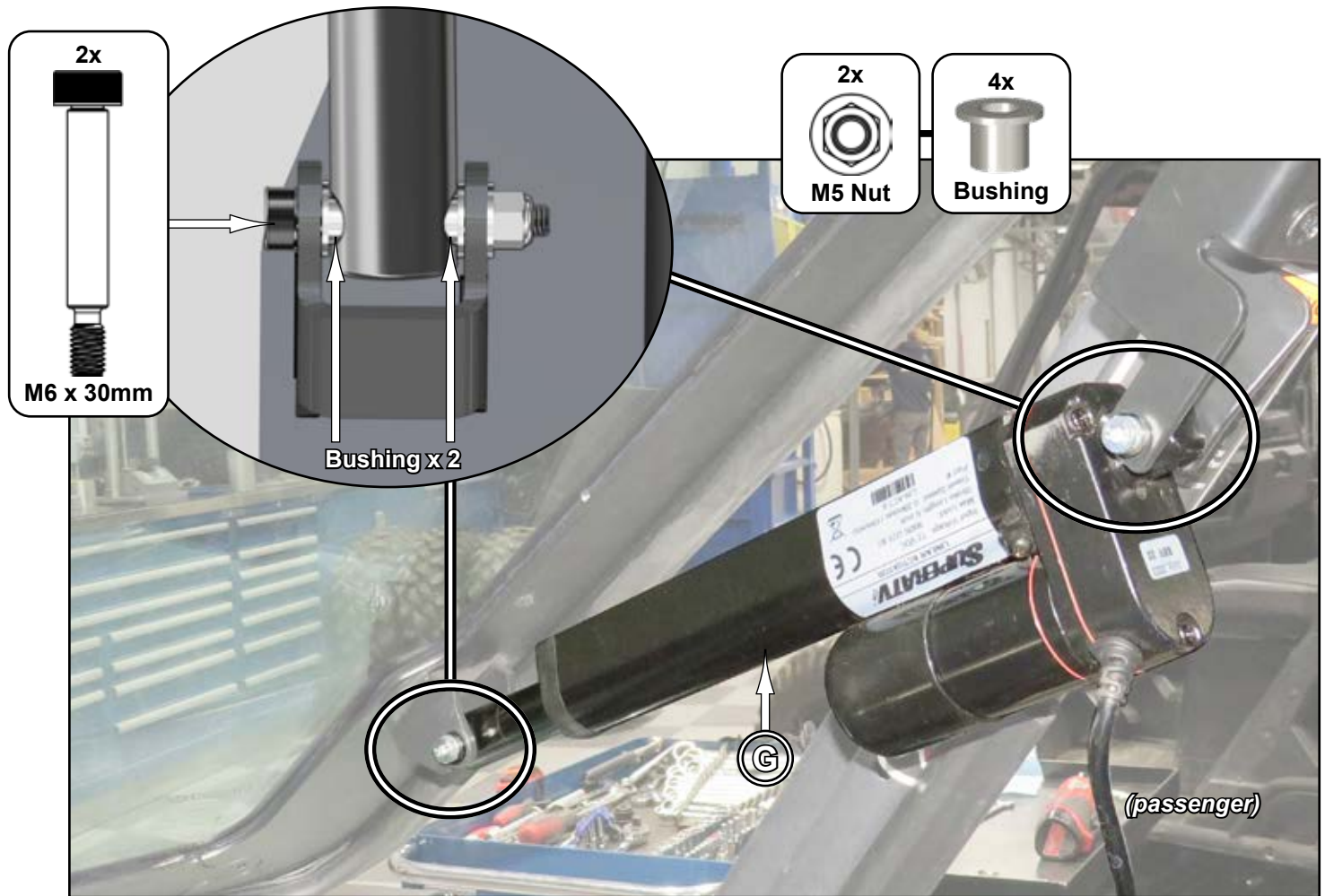



Route Switch Harness components shown through Boot...

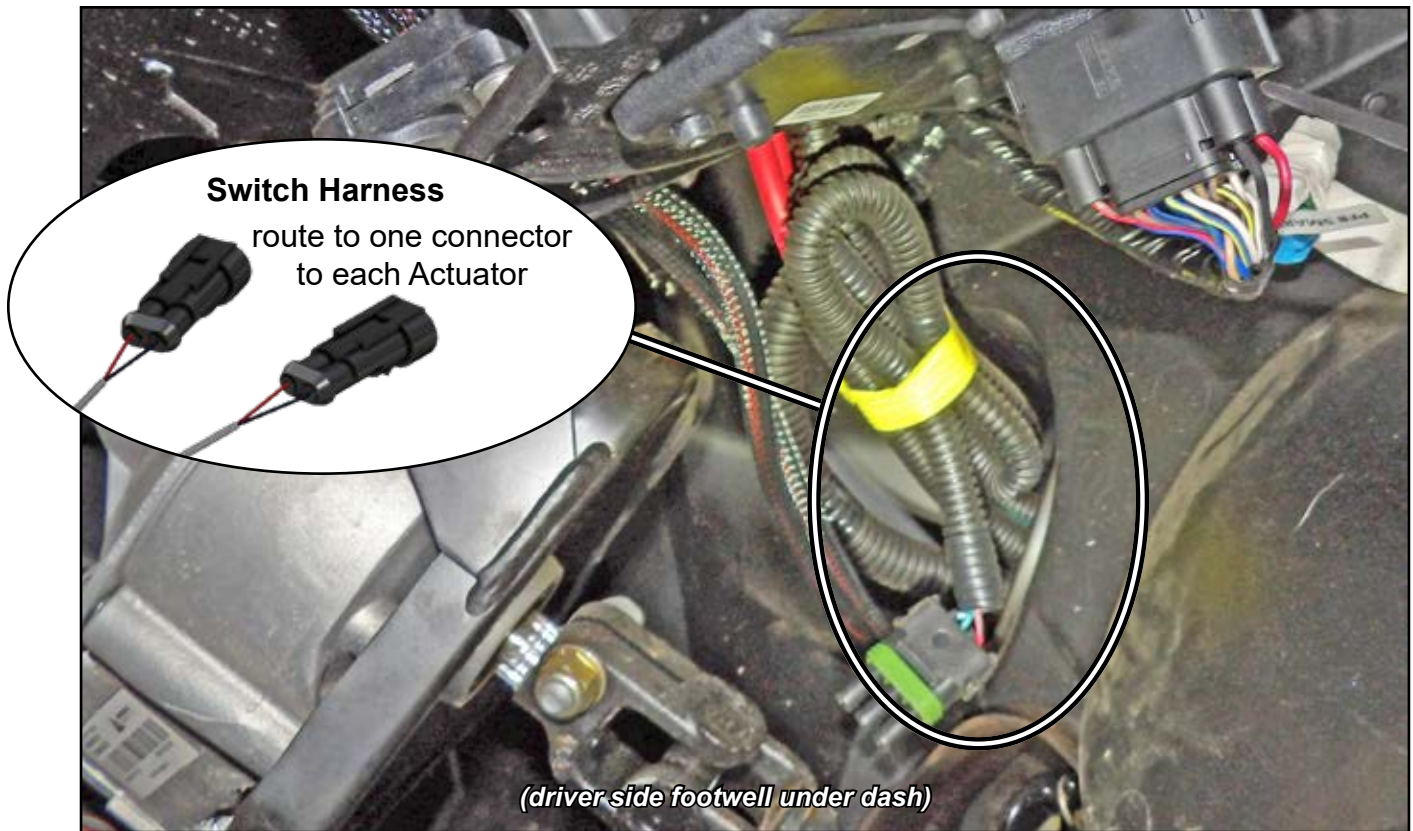

...and into Hood area shown.

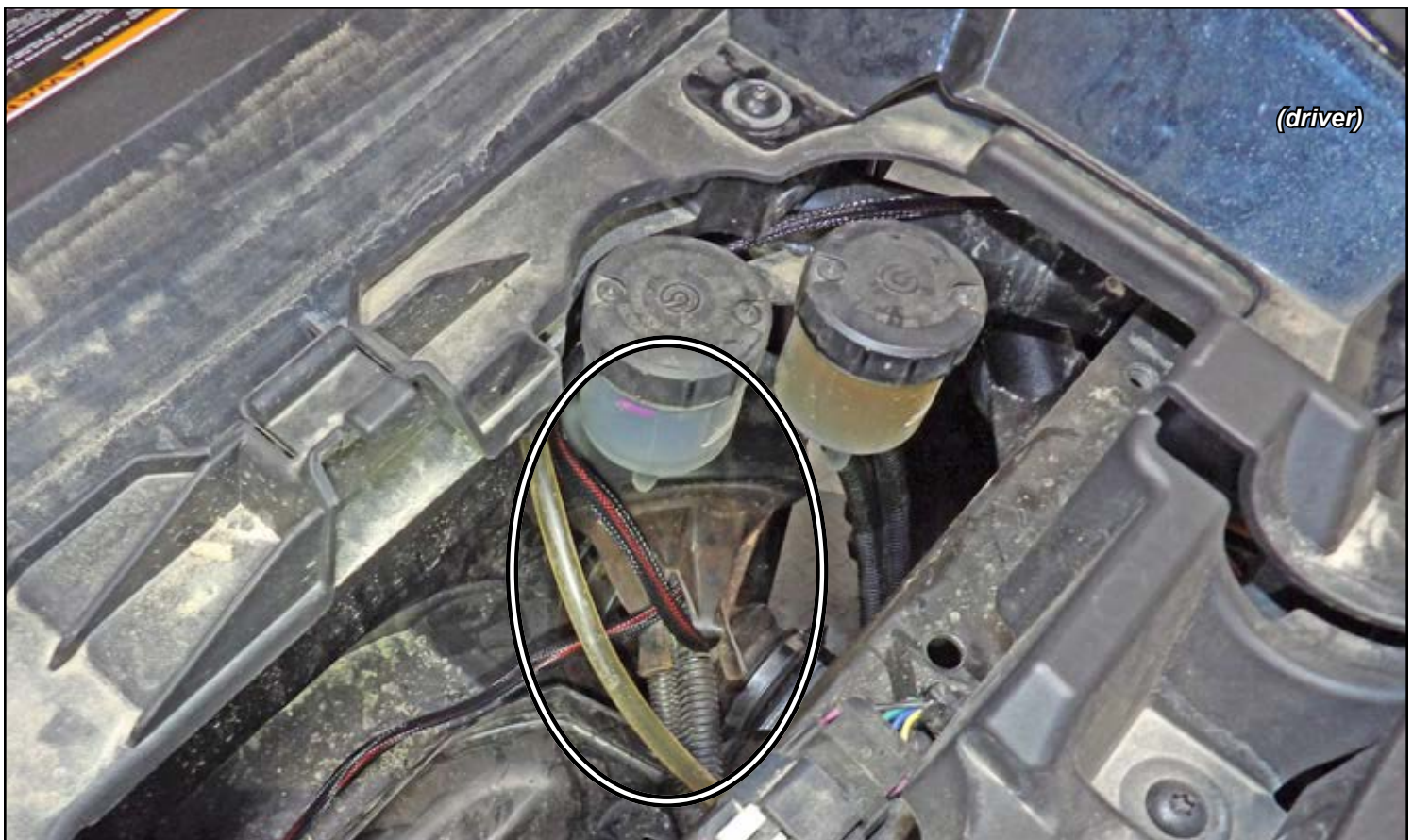

- Route Actuator connections to locations shown and connect.



Windshield Wiper Kit only

- Route Tubing and Extension along same path as passenger side Actuator wiring and through Boot shown on page 14.

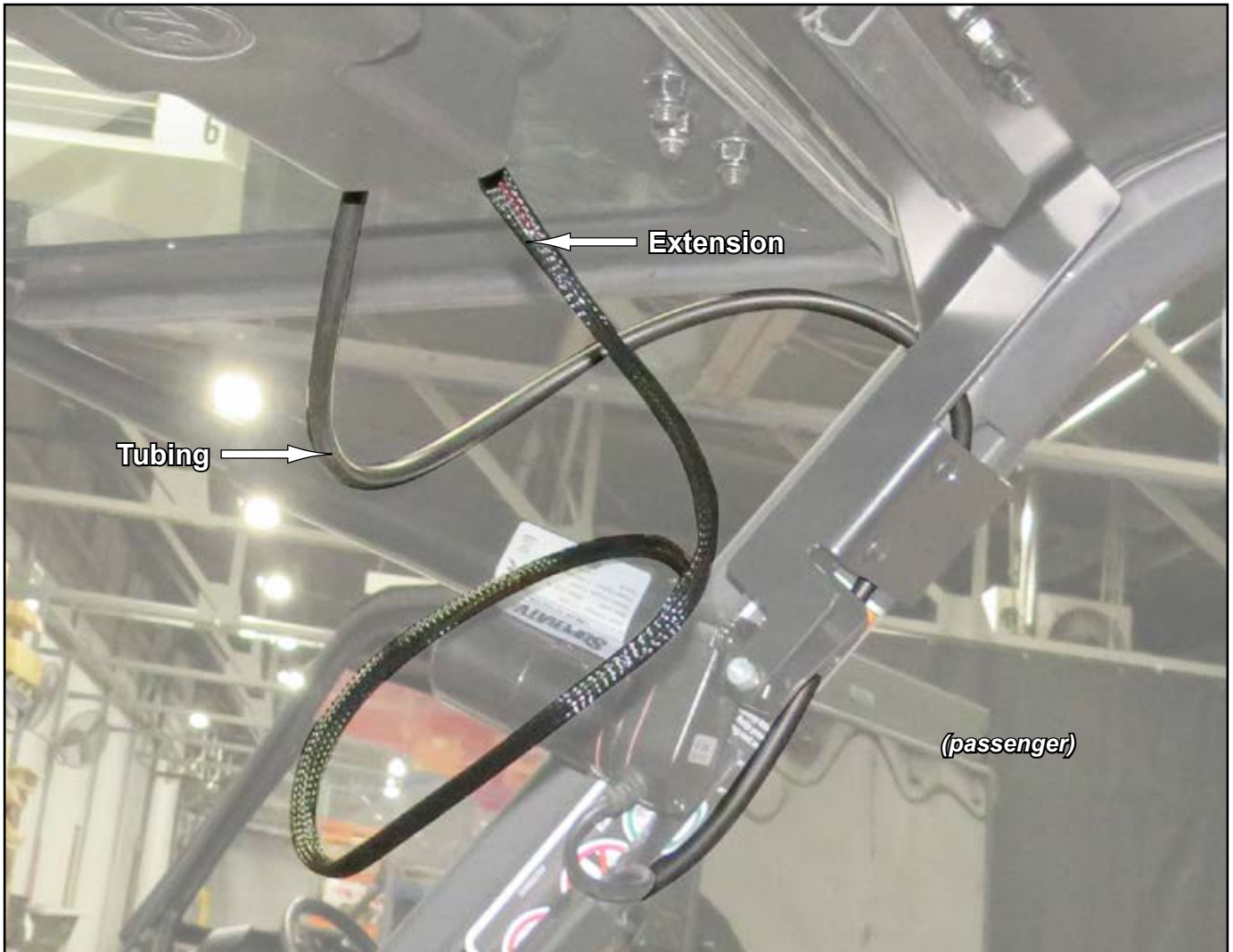

Switch Mounting:

- User may install Switch in location different than shown.
- Verify that Harness will reach components.
- Remove stock Knockout or cut a new location.

Before drilling any holes, check behind area to be drilled for any interference.

If no openings are available, see following pages 20 and 21 for alternate Switch mounting locations.

- Connect Harness and install Switch.

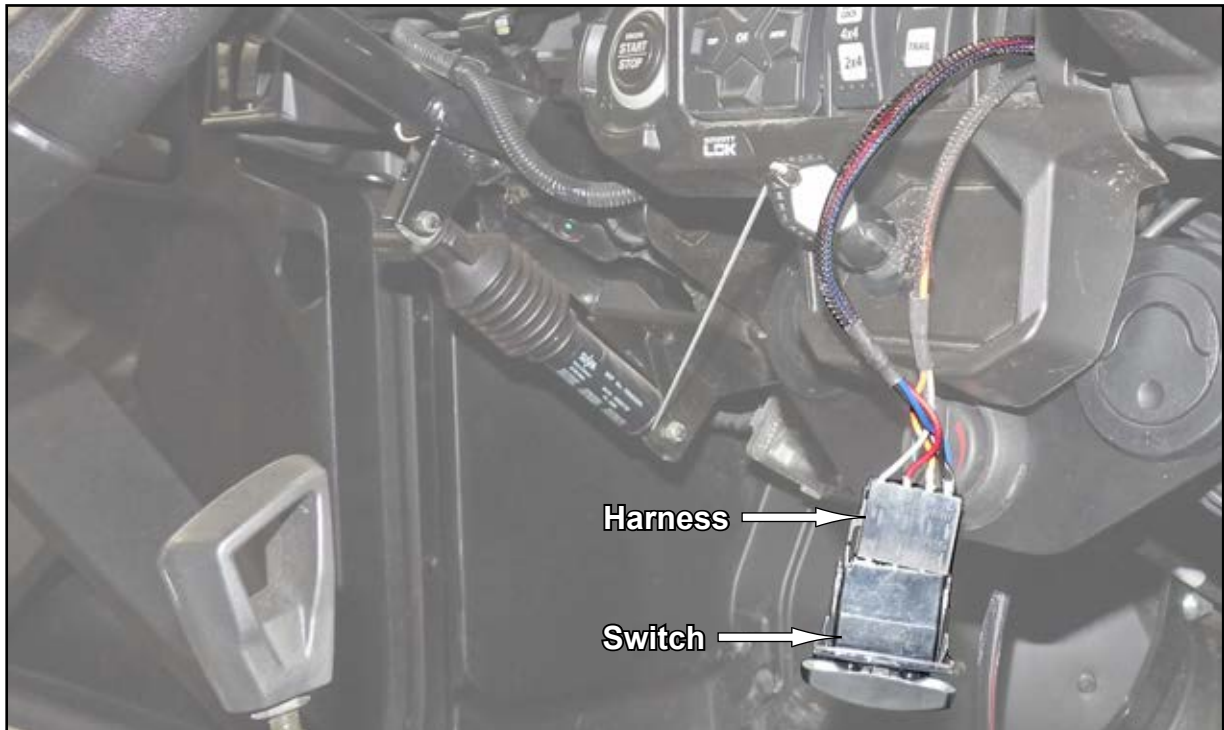

- Cut Wire Guide (J) into 4 pieces; dimensions shown below.
- Place Actuator Wire into Wire Guide (J) and secure Wire Guide (J) to machine in location shown.
- Installer may use provided Clip instead of cutting and installing Wire Guide (J).
- Insert Extension and Tubing, remove previously installed Nut shown, and install Clip with Nut: tighten.

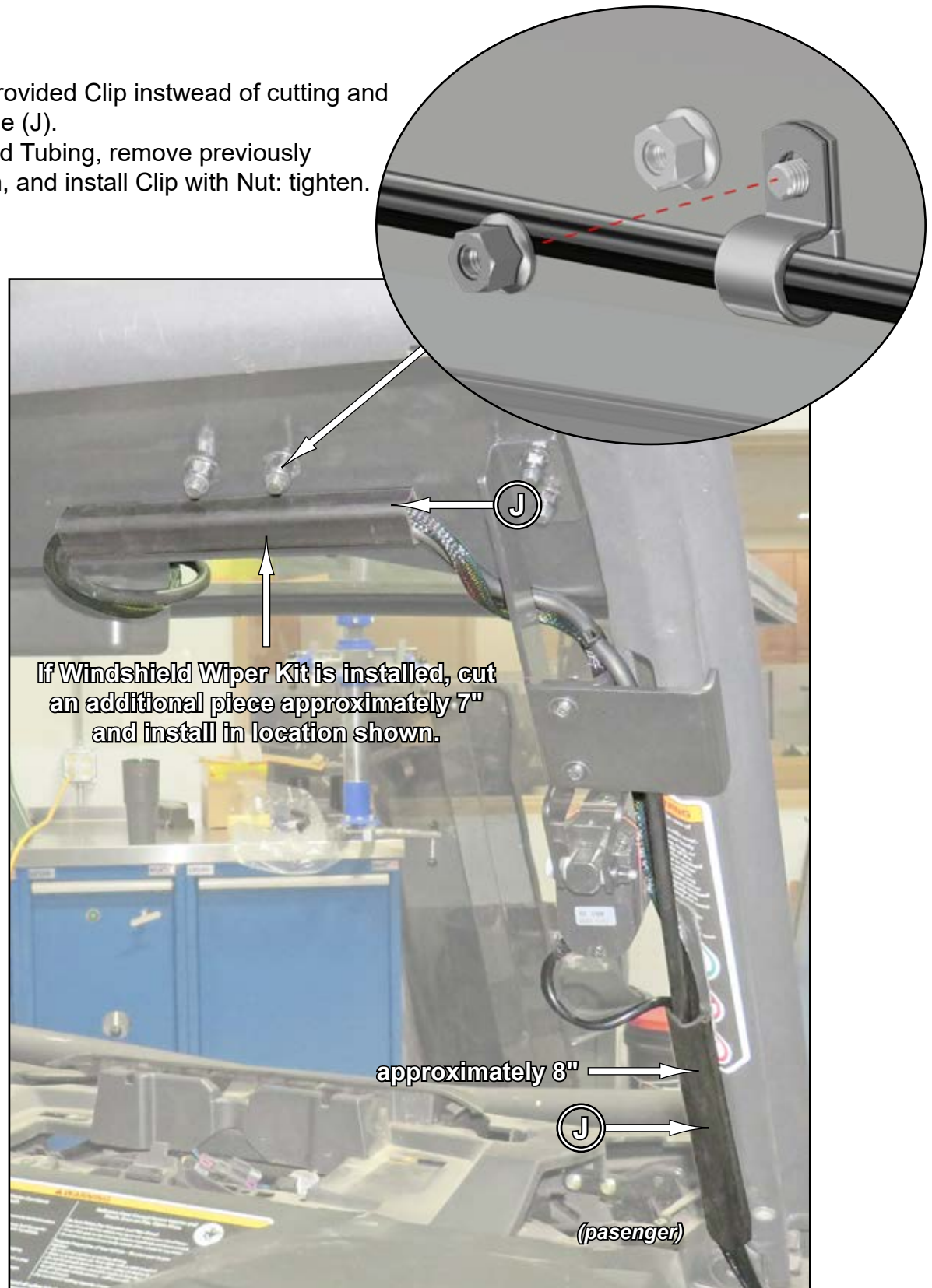

Power connection:

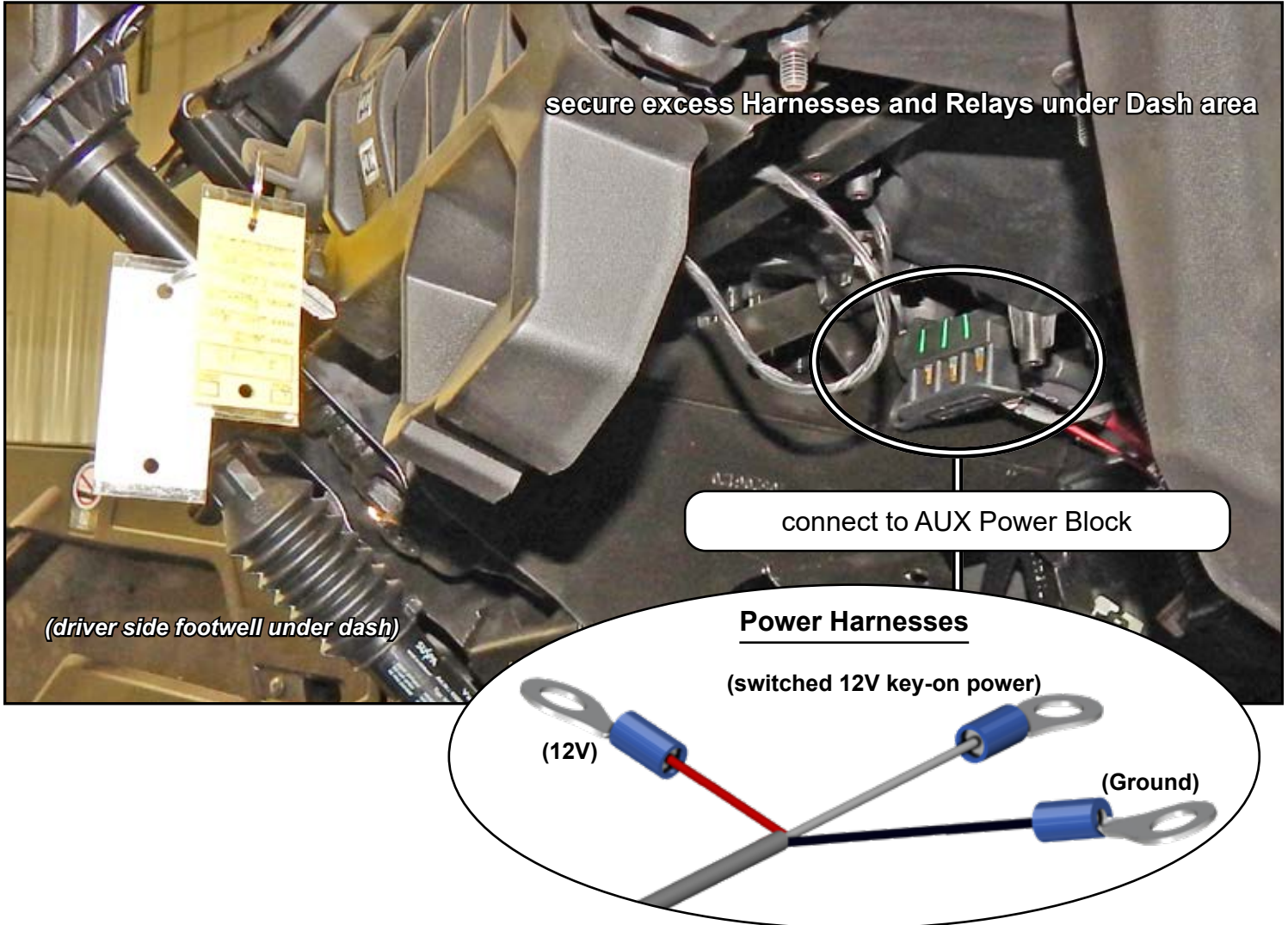

Alternative Switch Mounting locations:

- Remove Seat Bottoms and components shown.



- Route Switch connector from Switch Harness and if applicable, Windshield Wiper Kit Switch Harness towards rear of machine.
- If installing Windshield Wiper Kit, route Tubing and Tank Connector to rear of machine at this time.



Alternative Switch Mounting locations continued:

- Remove stock Knockout(s) and install Switch(es).
- Connect to corresponding Harness connections.
- Center Console shown out of machine for clarity only.



If Windshield Wiper Kit is not being installed, secure Harnesses with provided wire-ties and reinstall previously removed stock components (see previous page)

Windshield Wiper Kit only:

- Raise Cargo Bed. Lower *after* Tank has been installed.
- Route Tank Connector and Tubing through opening shown and to outside of machine.



Windshield Wiper Kit only continued:

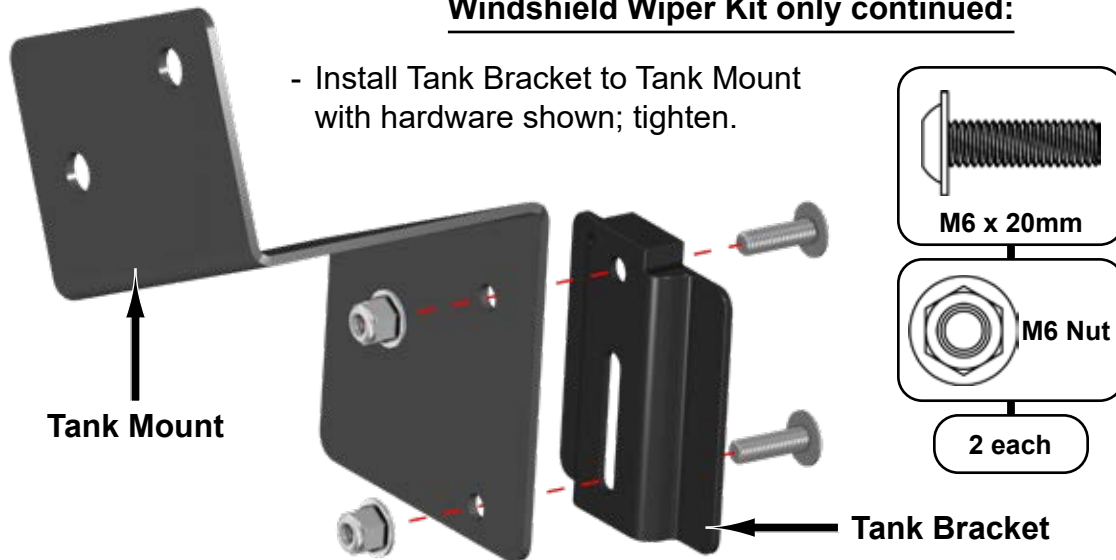

- Slide Tank back onto Tank Bracket.

- Install Tank Mount to Frame with hardware shown; tighten.



- Connect Tank connector to Tank.
- Trim excess Tubing and connect to Tank.

