

- Do not discard packaging until product has been successfully installed.
- A Press or Ball Joint tool is required to remove and install Ball Joints.

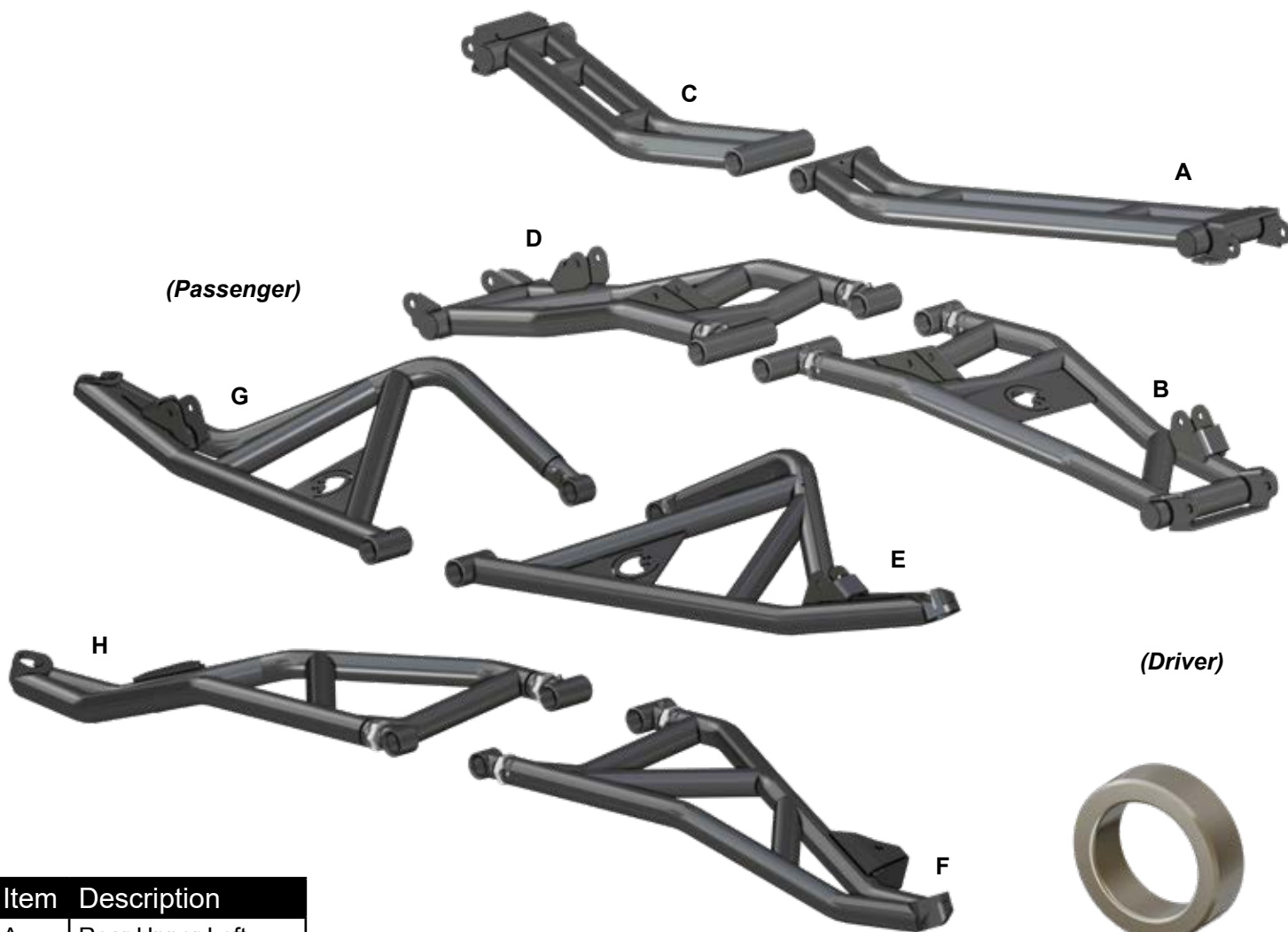

Steering Stop x 2

Item	Description
A	Rear Upper Left
B	Rear Lower Left
C	Rear Upper Right
D	Rear Upper Left
E	Front Upper Left
F	Front Lower Left
G	Front Upper Right
H	Front Lower Right

*(kit contents continue on following pages)*

**Need help with your installation?**



sales@superatv.com



www.superatv.com



1-855-743-3427



8:00am - 8:00pm EST M-Th  
8:00am - 7:00pm EST Friday  
9:00am - 2:00pm EST Saturday

**Read instructions and view illustrations before beginning.**

*Thank You  
For Choosing*

**SUPERATV**.COM<sup>®</sup>

(kit contents continued)

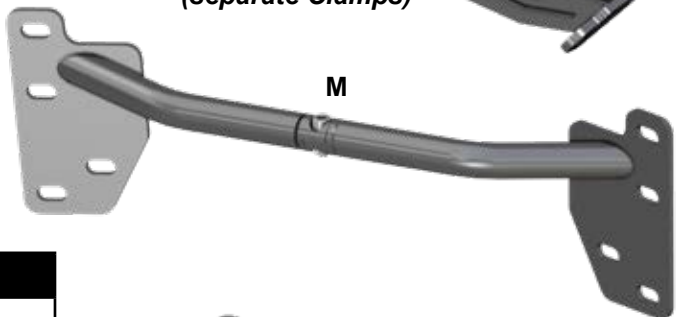
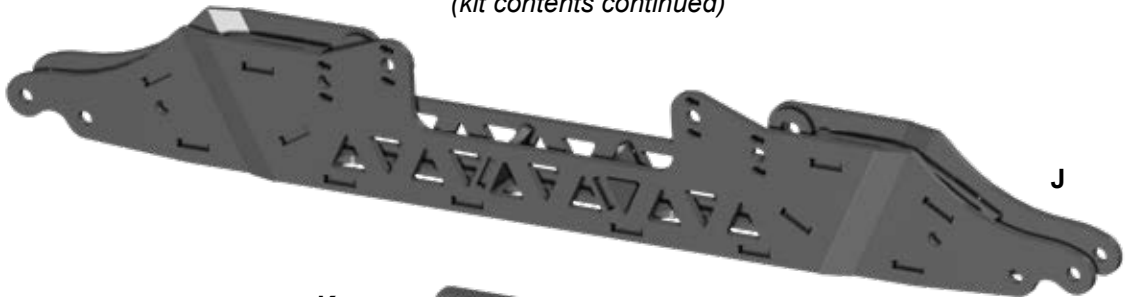

Item	Description
J	Front Bracket
K	Front Brace Left
L	Front Brace Right
M	Rear Brace
N	Rear Base Left
P	Rear Base Right
Q	Shock Bracket x 2

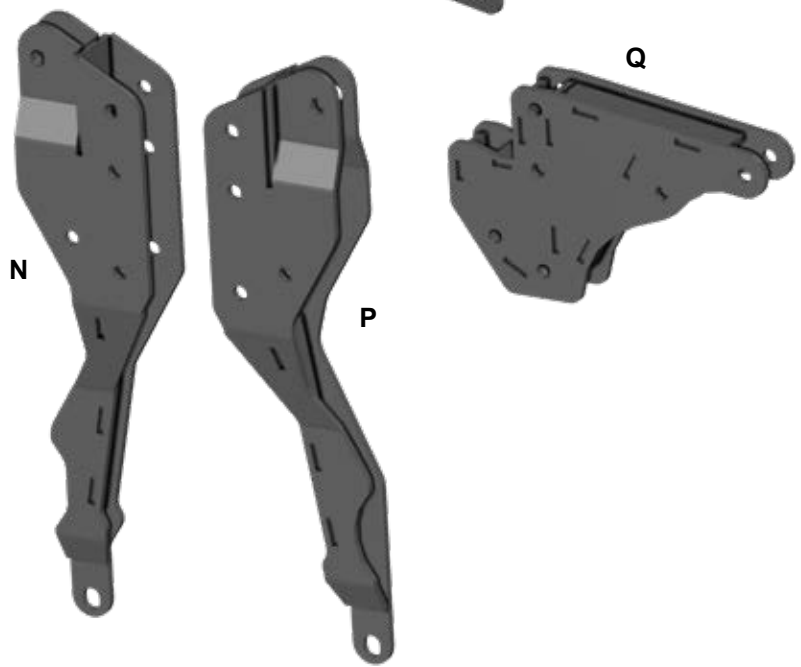

(kit contents continued)

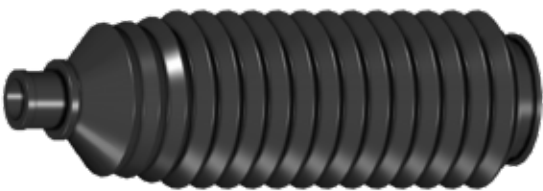

Boot x 2



Tie Rod End x 2



Ball and Socket x 2



Wire Tie x 4

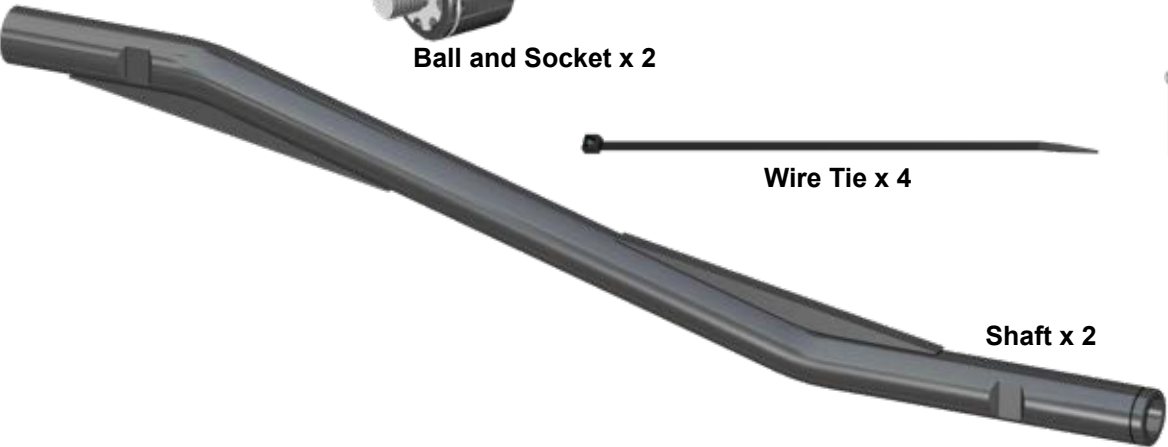

Shaft x 2

Hardware Kit



Template  
(2 Seat)

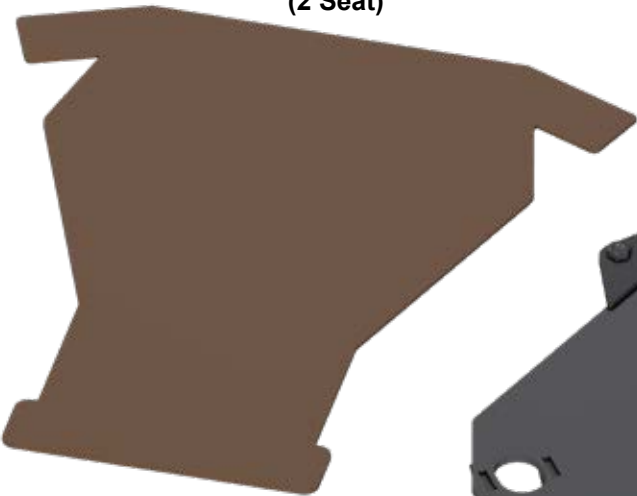

Item	Description	Item	Description
R	Link Mount	U	Mount Plate Assembly
S	Mount Brace	V	Mount Plate
T*	Tube Clamp x 4	W	Radius Link x 2

*\*separate Clamps (T) and set aside*

R



S



T\*



U



(4 Seat)

V



(2 Seat)

W



Template  
(4 Seat)





**Front Components Removal:** *Keep all components removed from machine.*



**Rear Components Removal:** *Keep all components removed from machine.*

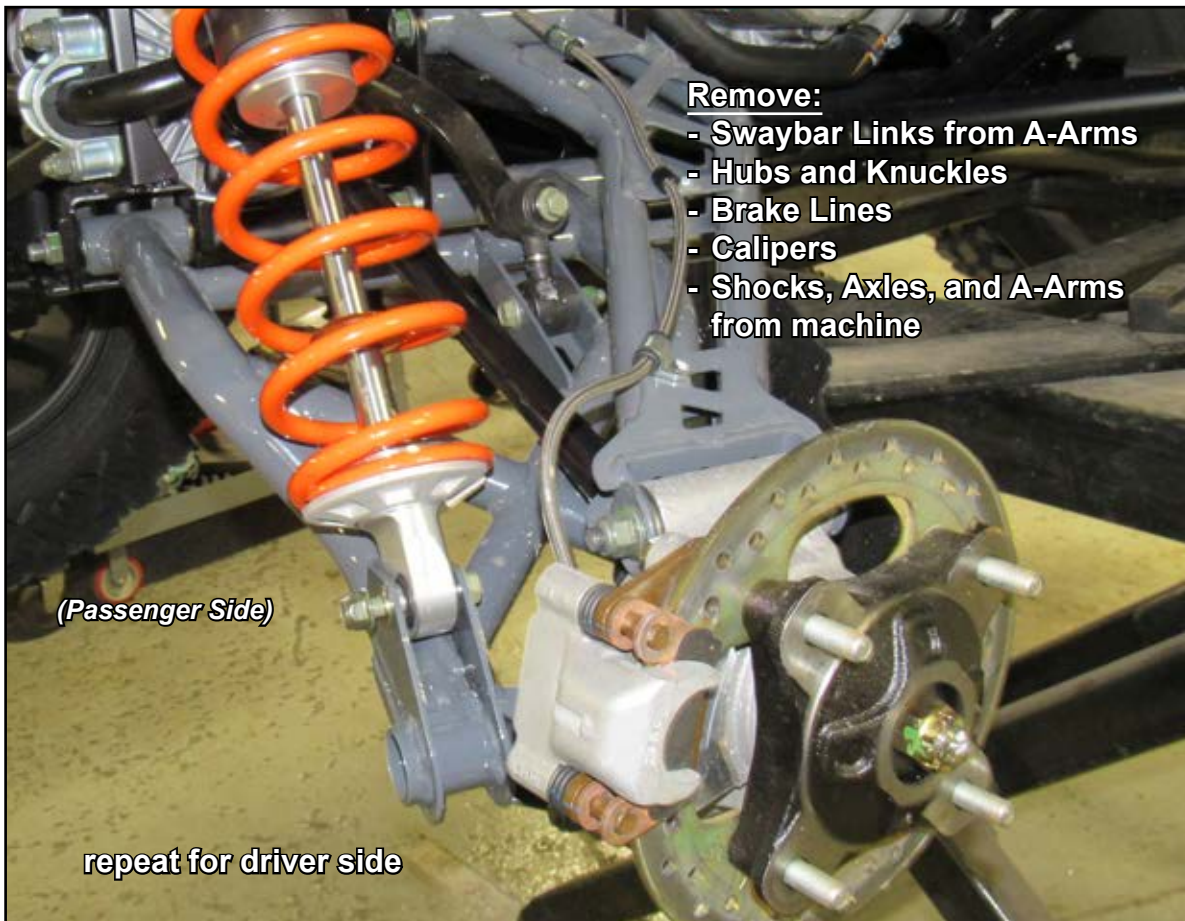

## Front A-Arms Prep:

- Install Fittings shown.
- Install stock or SuperATV Bushings.

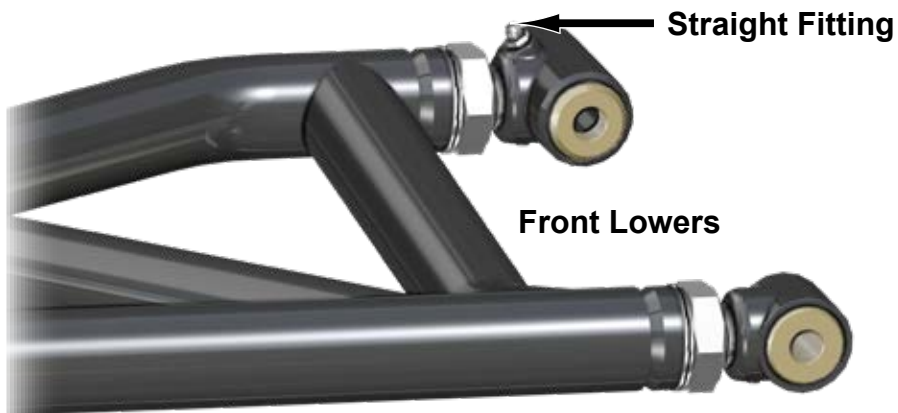
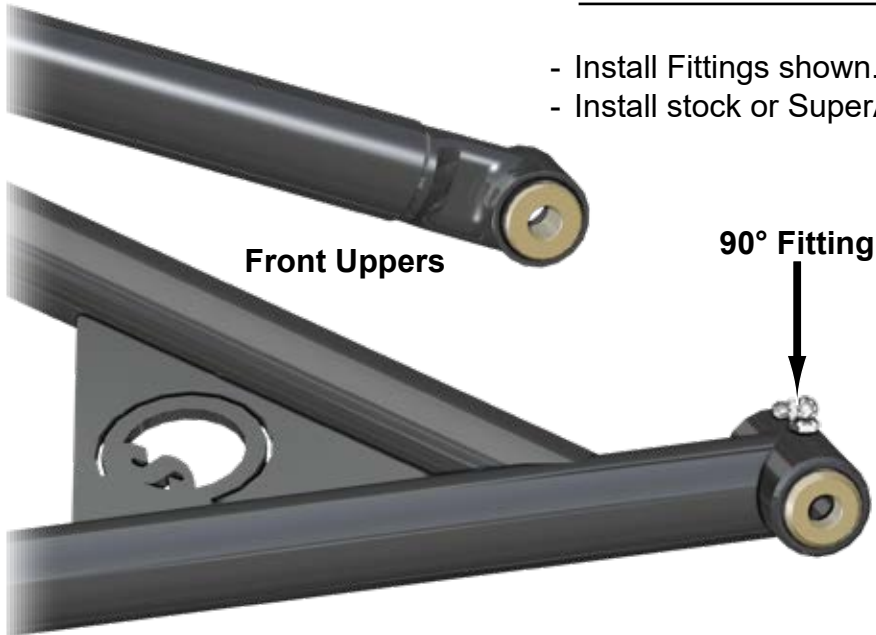

## Rear A-Arms Prep:

- Install Fittings shown.
- Install stock or SuperATV Bushings.

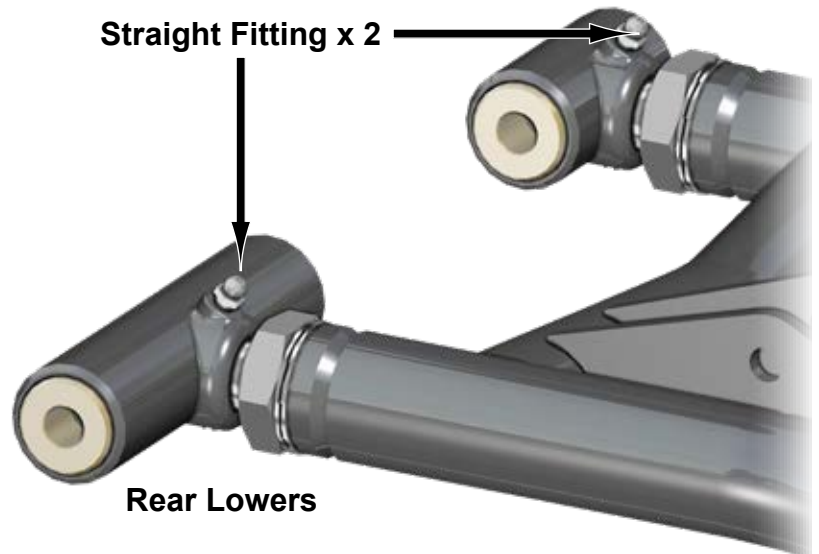
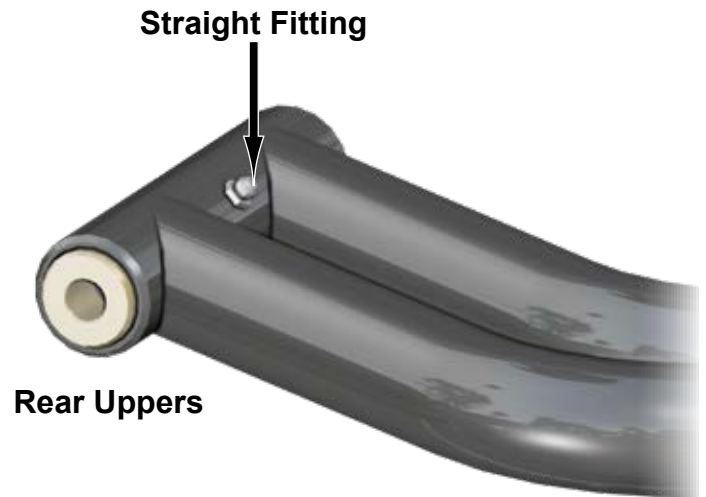

*Rack and Pinion shown off machine for clarity only*

- Install Steering Stop onto Shaft.
- Repeat for opposite side.

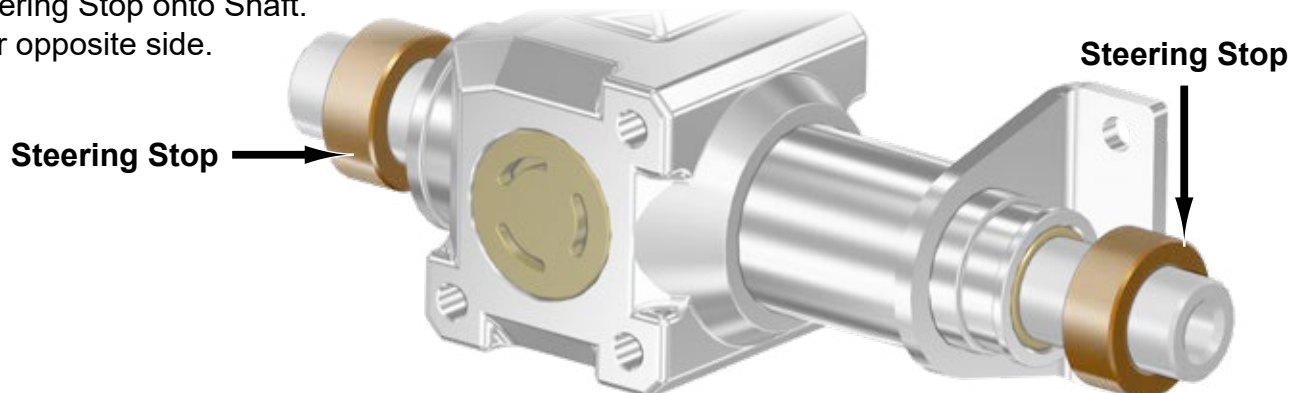



## PIVOT BLOCK SETTINGS

- Place new A-Arms onto a flat surface and verify dimension shown.
- *Negative 1° camber setting is achieved when Pivot Blocks are set to this dimension.*
- See last page for additional camber information.

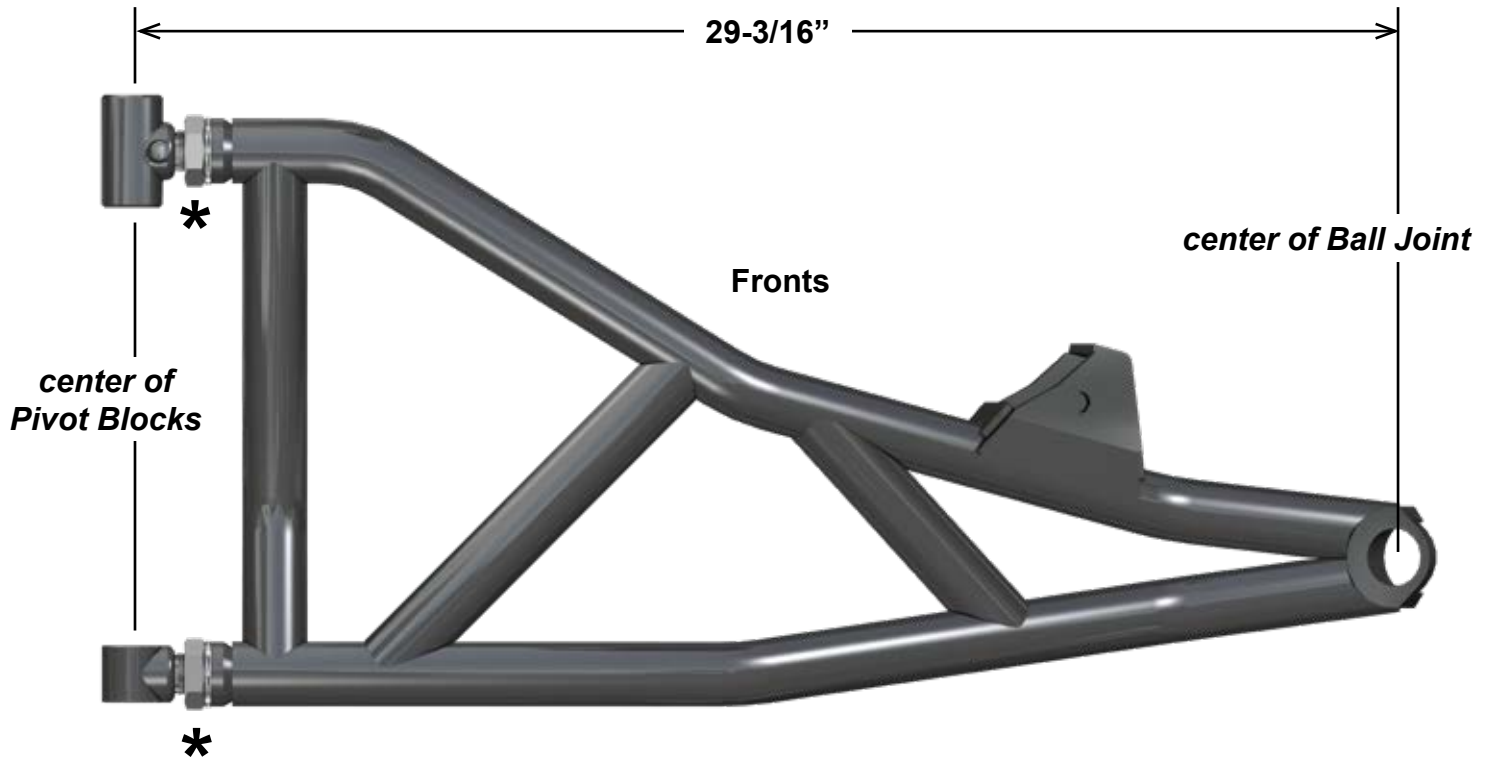

**\*Leave Jam Nuts loose. Tighten after final adjustments have been made.**

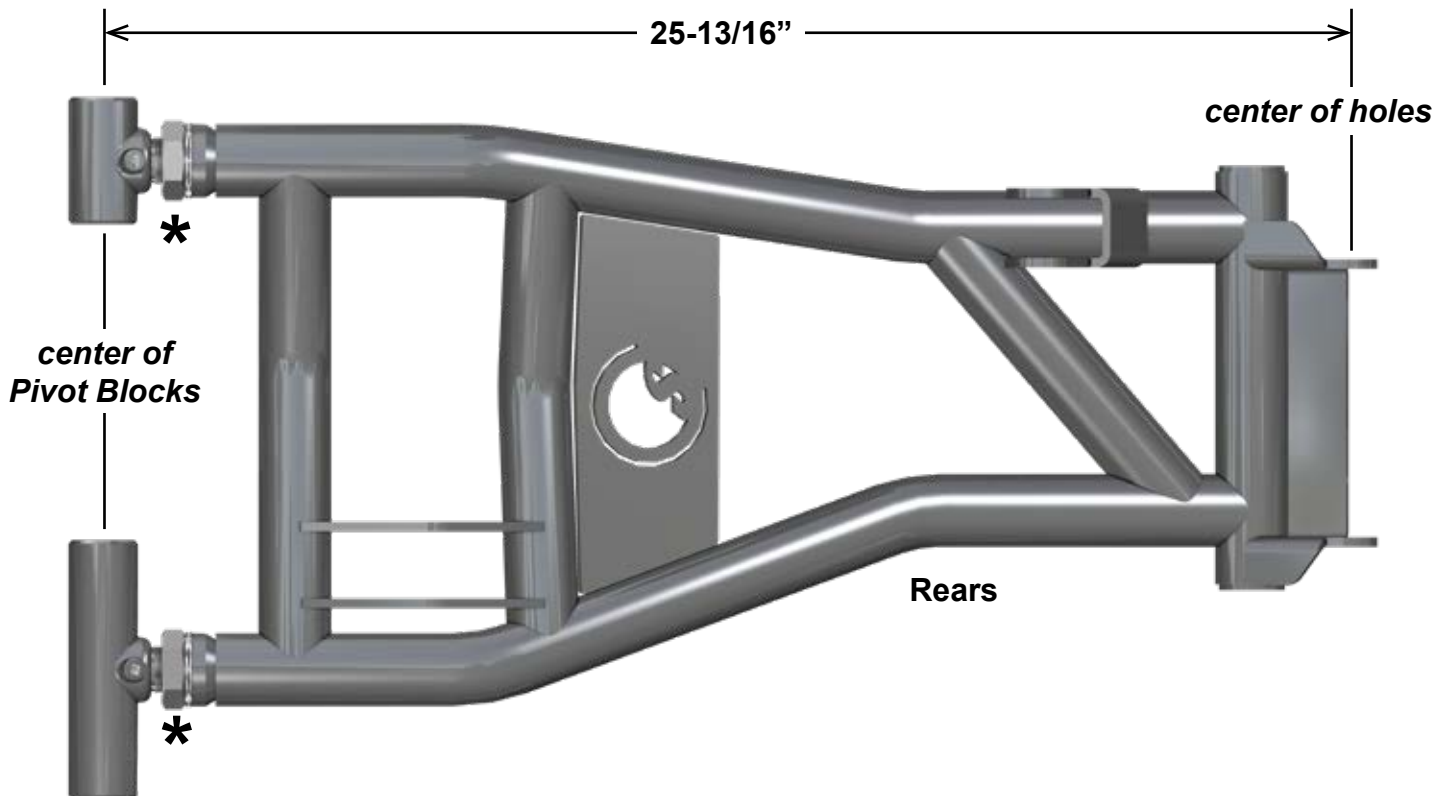

- Install Front Lower Left (F) to Frame with stock hardware; **keep Nuts loose until all final adjustments have been completed.**

- Remove Jam Nuts from Ball and Sockets.
- Install Ball and Sockets to Rack and Pinion. Use Loctite.
- Install Boots to Rack and Pinion and secure with Wire Ties.
- Reinstall Jam Nuts to Ball and Sockets.
- Install Tie Rod Shafts to Ball and Sockets.

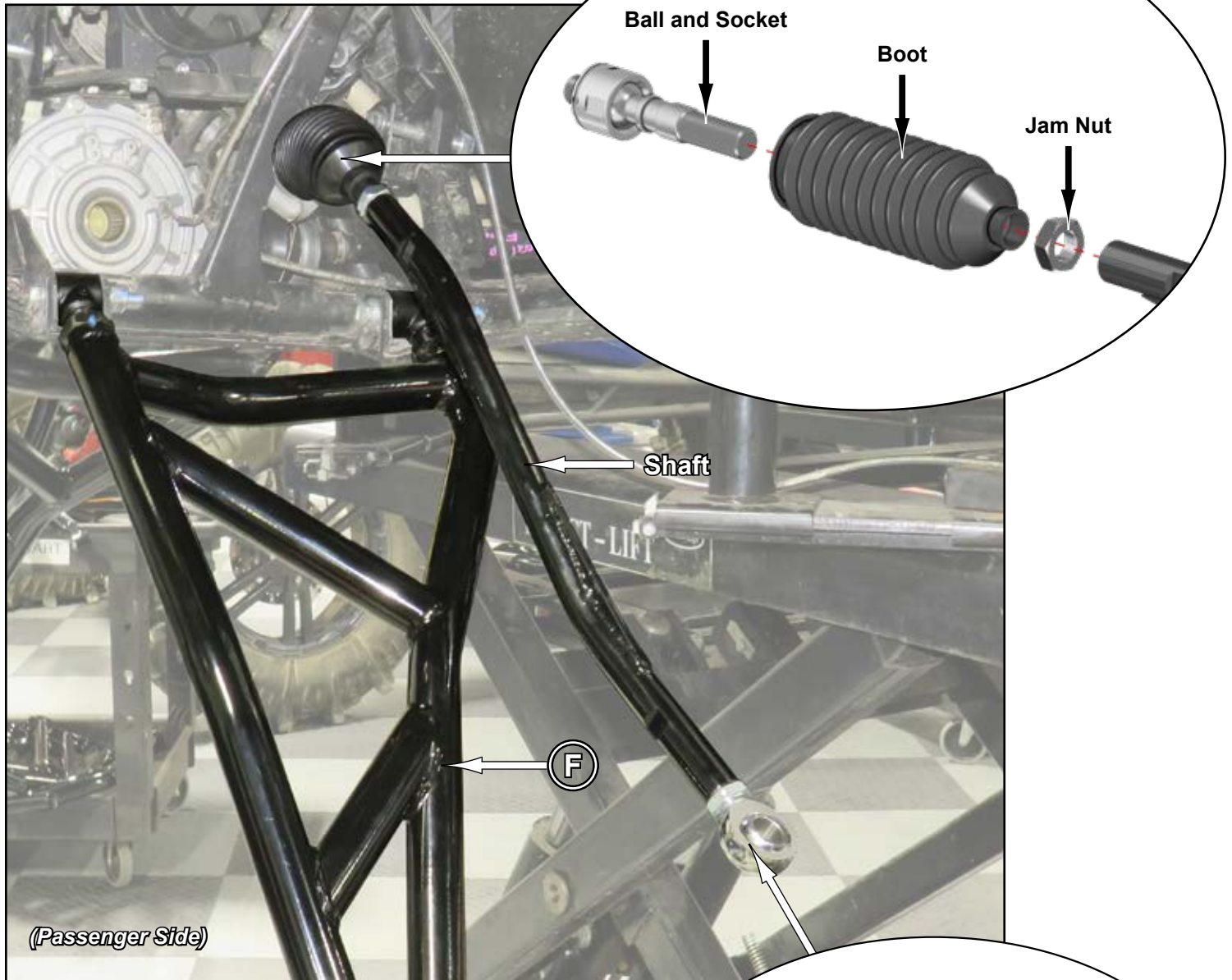

- Install Tie Rod Ends to Shafts.

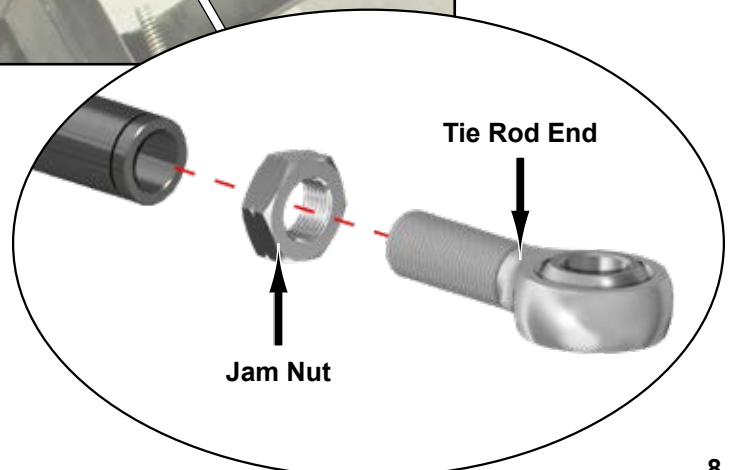



- Install new Front Axle.
- Install Front Upper Left (E) to Frame with stock hardware. Tighten hardware. SuperATV recommends using Loc-Tite on Nuts.



- Install Sway Bar Link to Upper A-Arm with stock hardware.
- Install Knuckle to Arms with stock hardware; **keep Lower Nuts loose until all final adjustments have been completed.**



- Secure Tie Rod End to Knuckle with hardware shown.

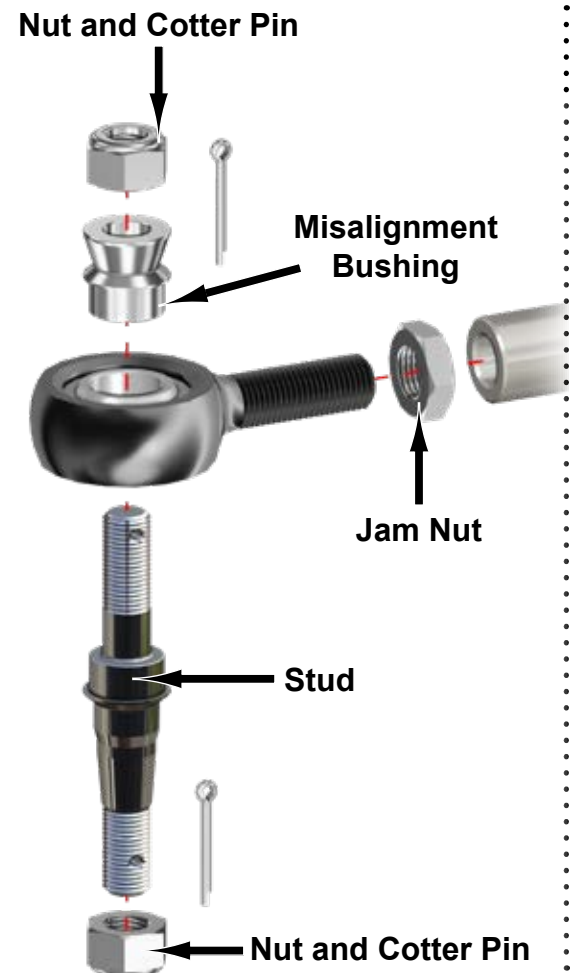

- Repeat steps for driver side A-Arms installation.

- Reinstall Hubs and Calipers.
- Install provided Brake Lines to Calipers and Master Cylinder.
- Secure Brake Lines to Upper A-Arms with components shown.
- Ensure that no binding occurs after Brake Line has been installed and secured.

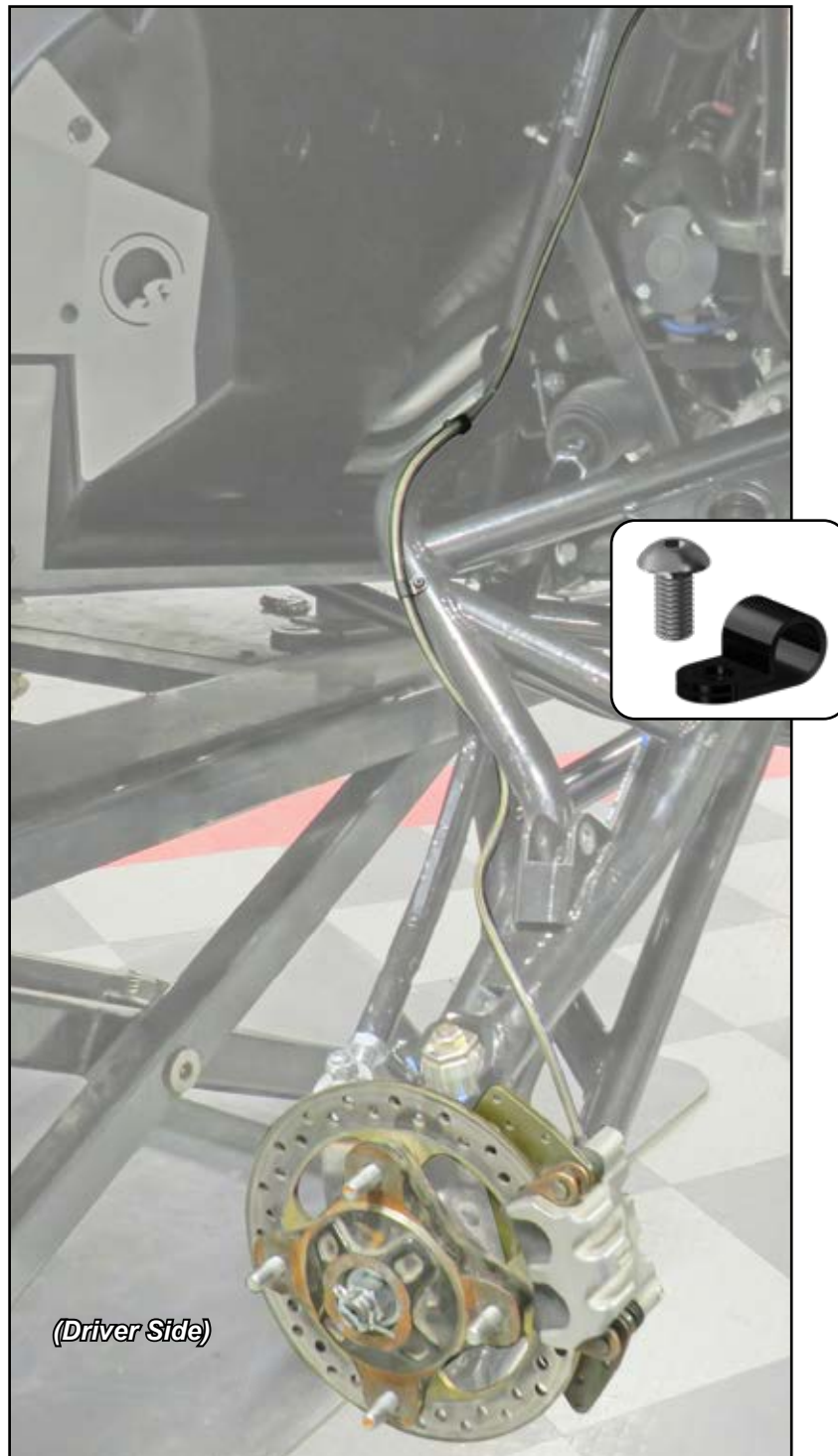



- Install Front Bracket (J) to Frame with hardware shown; do not tighten.
- Repeat for driver side.





- Secure Front Bracket (J) to stock Shock Mounts with hardware shown; do not tighten.
- Install Front Brace Right (L) to Cage and Front Bracket (J) with hardware shown; do not tighten.
- Repeat for Front Brace Left (K).
- Tighten all hardware.

3 each

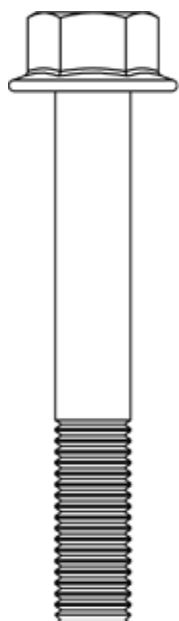

M10 x 70mm



M10 Nut

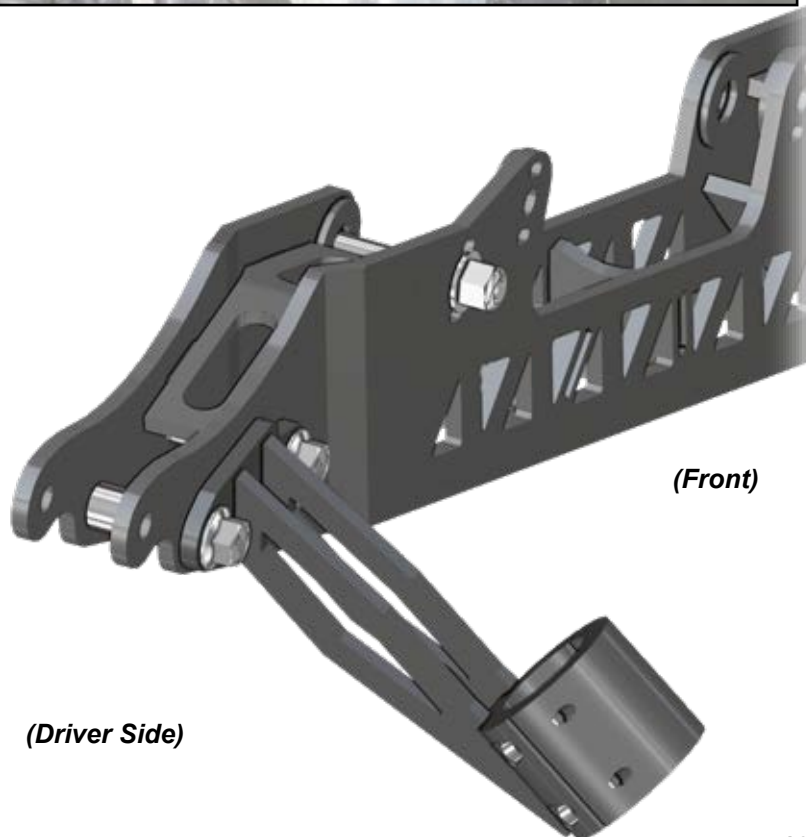

- Install Shocks to Front Bracket (J) and Upper A-Arms with hardware shown; tighten.

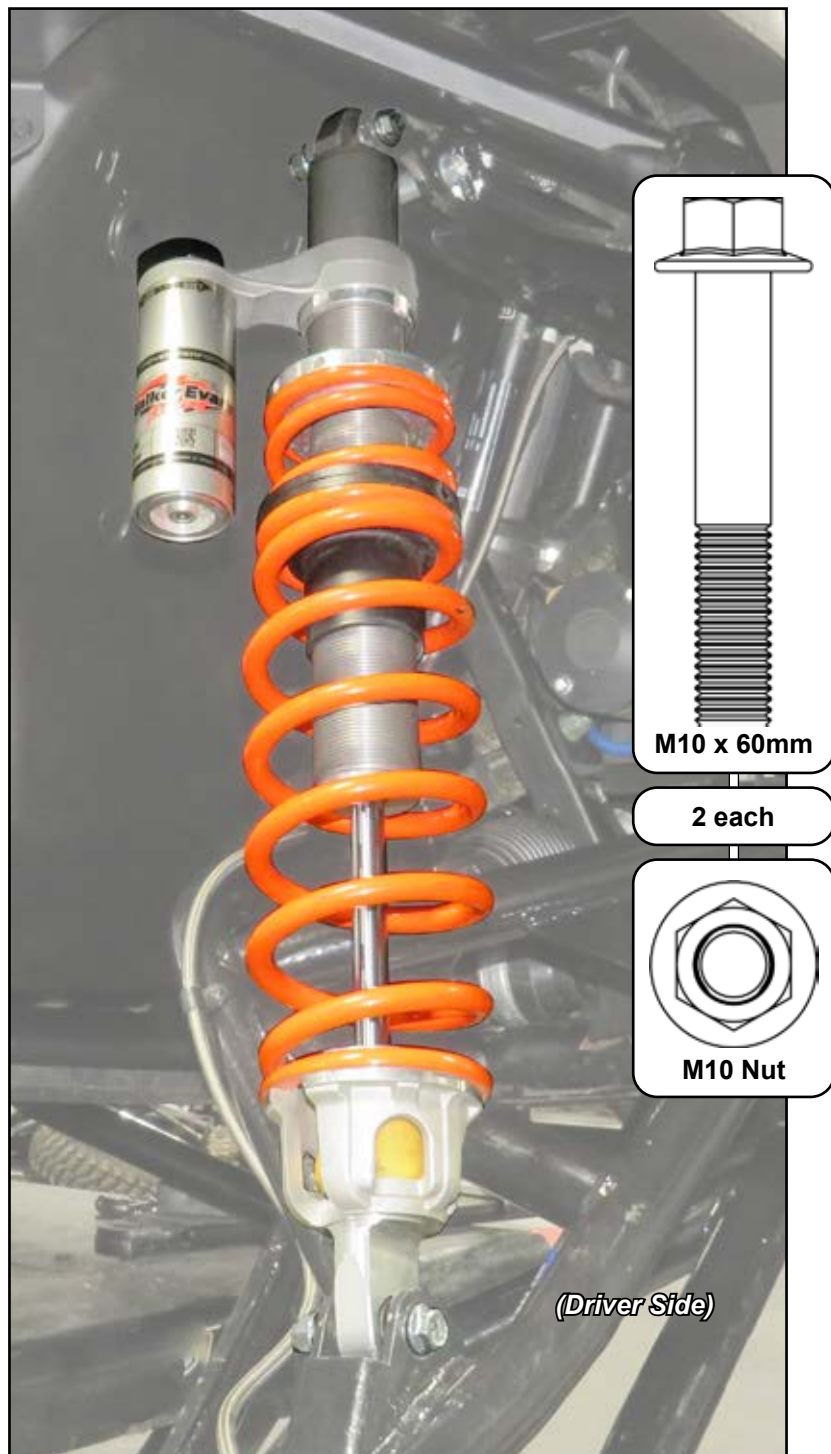

- From driver side, slide Rear Brace (M) through machine to location shown.

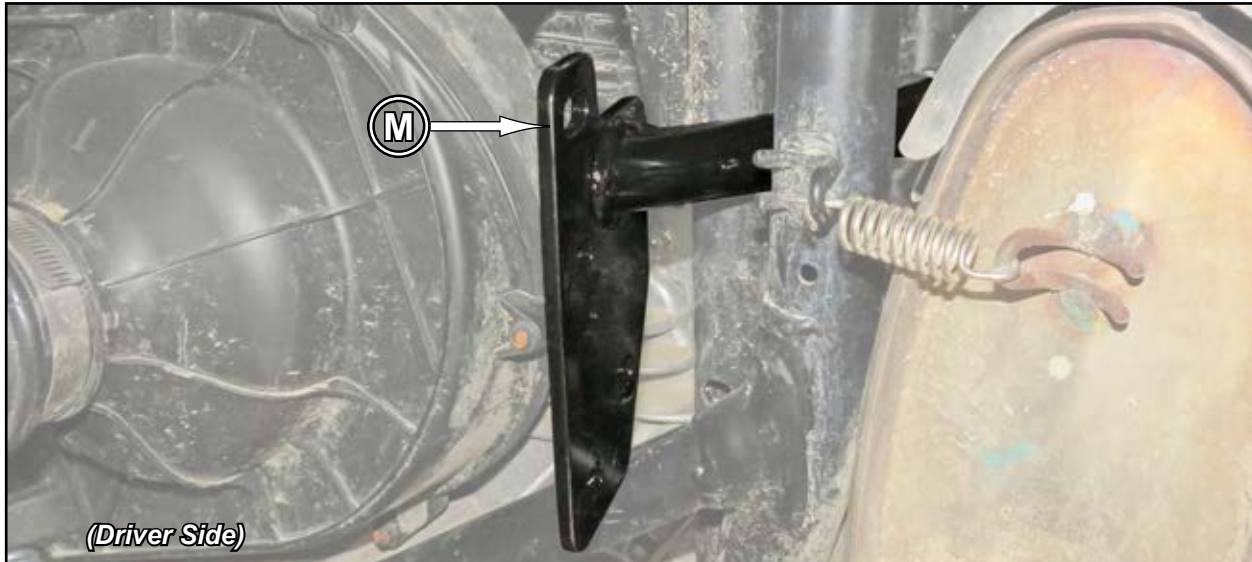

- Install Rear Base Left (N) to stock Shock Mount with hardware shown; do not tighten.
- Install Rear Lower Left (B) with hardware shown; **keep Nuts loose until all final adjustments have been completed.**

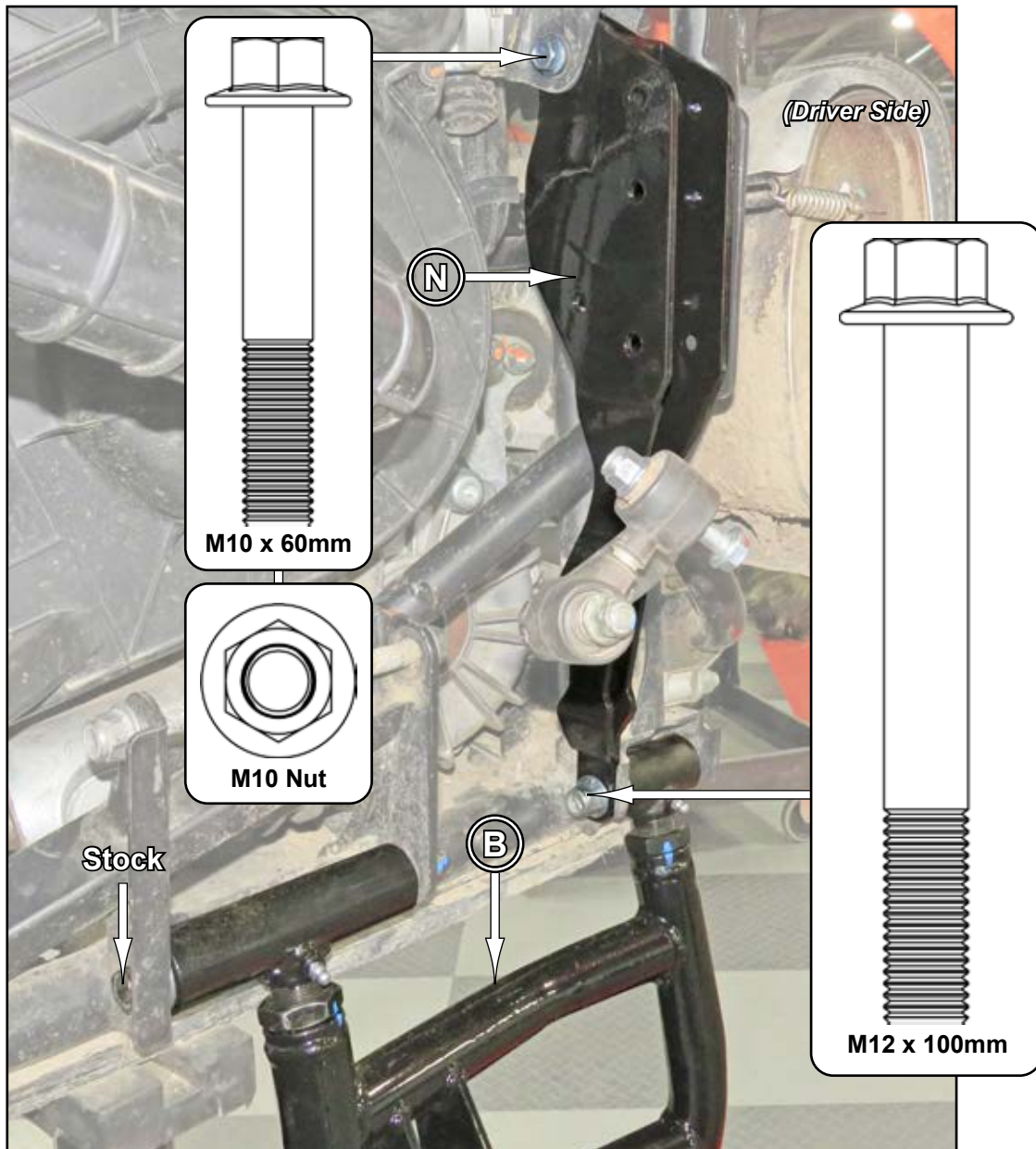



- Install Shock Bracket (Q) into stock Shock Mount.
- Secure Rear Brace (M), Shock Bracket (Q), and Rear Base Left (N) with hardware shown; do not tighten.
- Repeat for passenger side components.

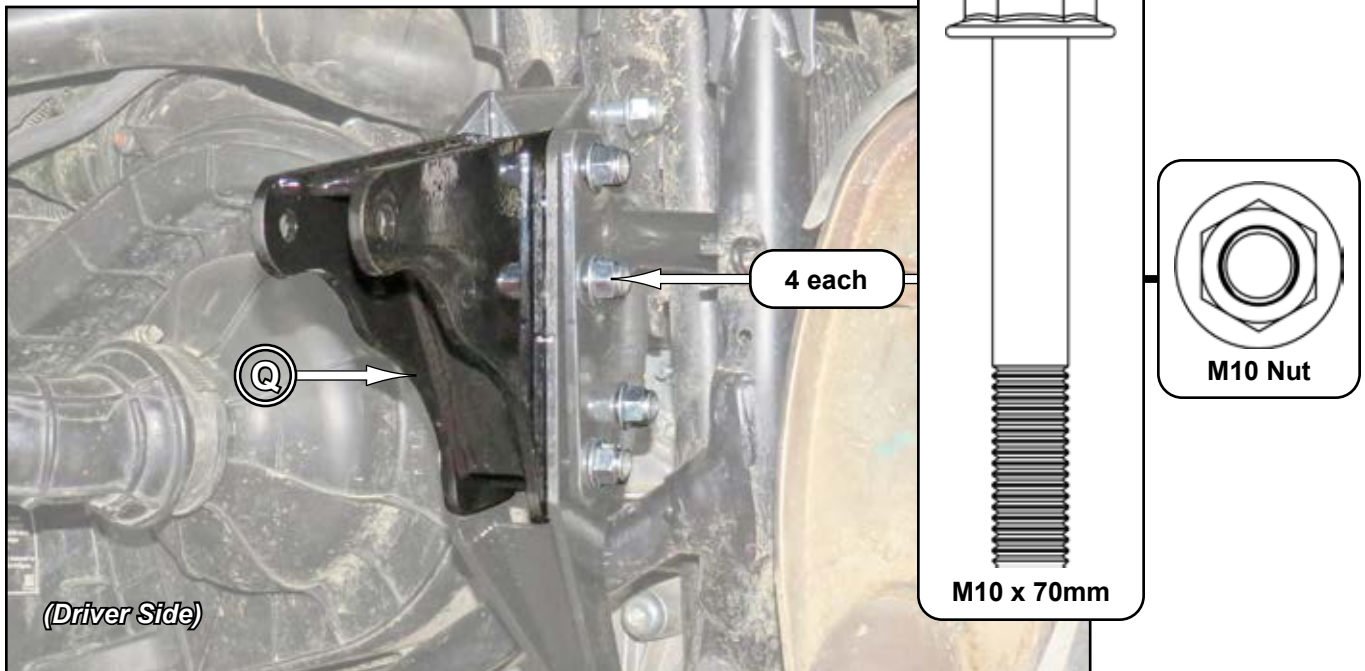

- Install new Rear Axle.
- Install Rear Upper Left (A) to Frame with stock hardware. Tighten hardware. SuperATV recommends using Loc-Tite on Nuts.



- Repeat for passenger side components.



- Reinstall Hubs with stock hardware; **keep Lower Nuts loose until all final adjustments have been completed.**
- Install Shocks to Shock Brackets (Q) and Upper A-Arms with hardware shown; tighten.

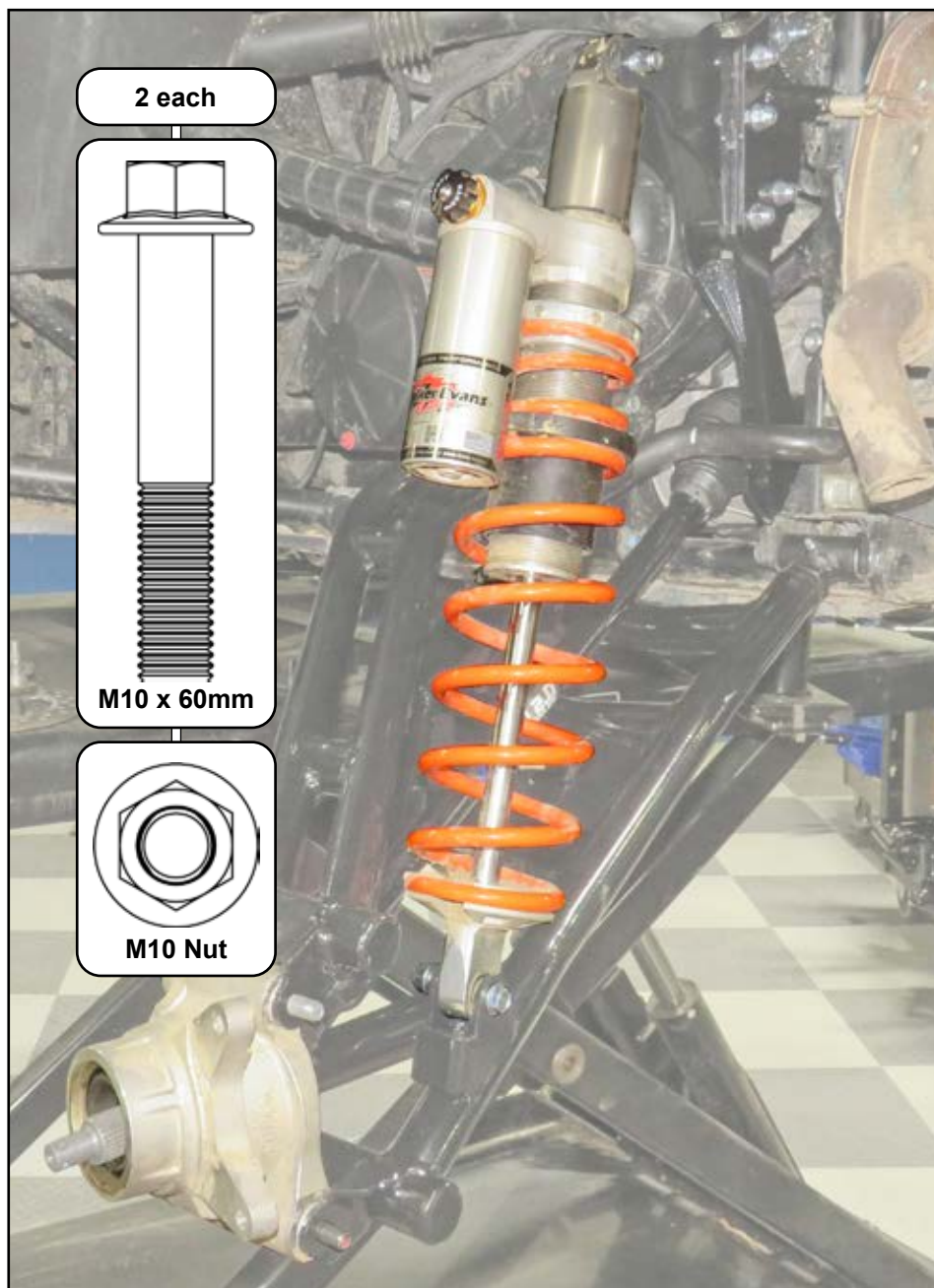

- Reinstall Calipers.
- Install provided Brake Lines to Calipers and T-Fitting.
- Secure Brake Lines to Upper A-Arms with components shown.
- Ensure that no binding occurs after Brake Line has been installed and secured.

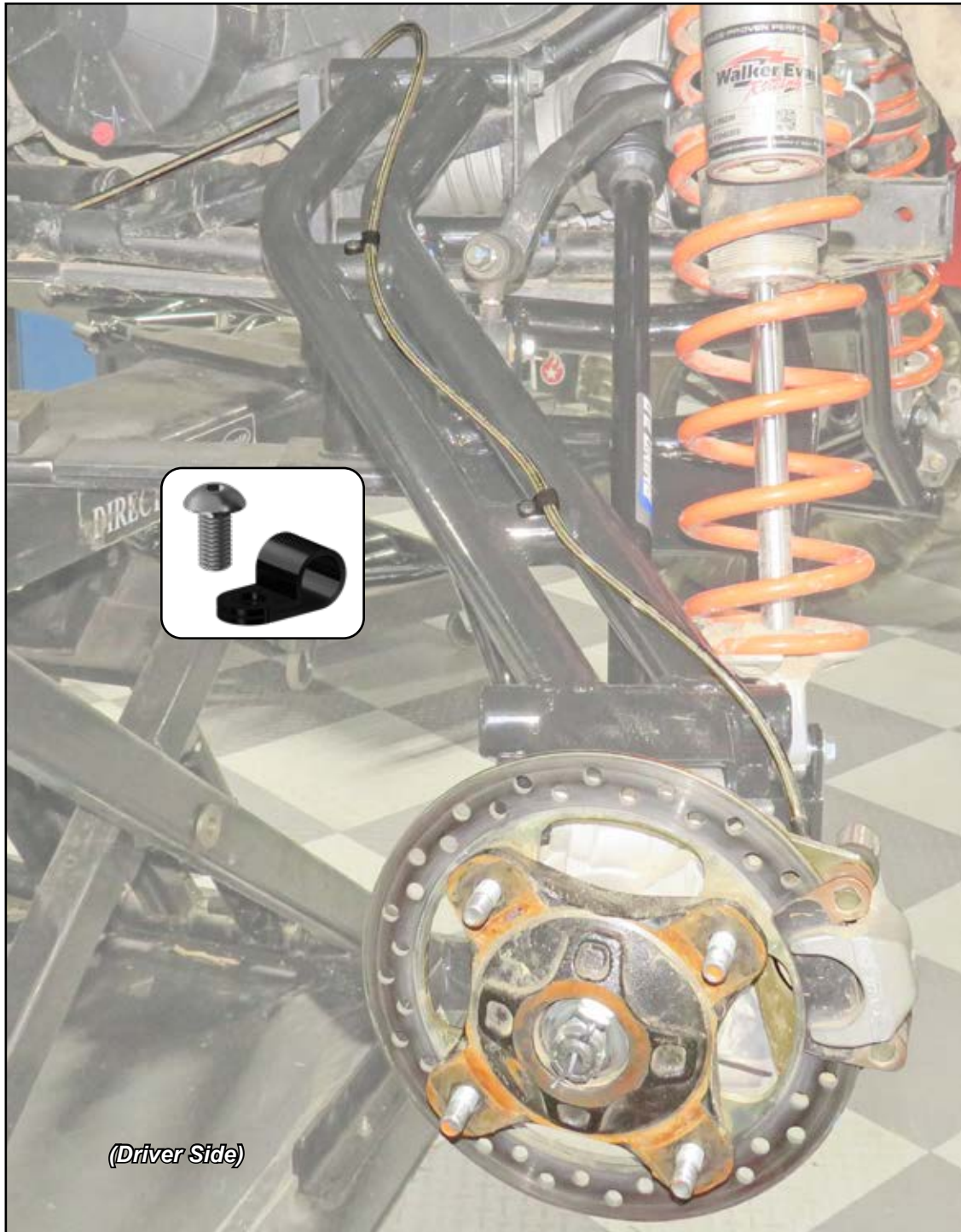

- Reinstall Tires and check Camber settings; see following page.
- Tighten Nuts completely. SuperATV recommends using Loc-Tite on Nuts.



## CAMBER

- Tires must have equal air pressure before making adjustments.
- Adjustments to be made after all suspension components have been completely assembled.
- Tires must not be in contact with ground when making adjustments.
- Perform adjustments in small increments.



### Adjusting Camber:

- Remove A-Arms from Frame and turn Pivot Blocks to adjust camber. Reinstall Arms.
- Lower machine and settle suspension components by rolling machine back and forth several feet at a time.
- Check settings and make small adjustments as needed.
- Each time an adjustment is made, machine must be rolled back and forth to settle suspension components.
- Once desired setting is achieved, tighten hardware completely. Loc-tite on Nuts is recommended.

**A NEGATIVE CAMBER SETTING OF 1° to 2° IS RECOMMENDED.**

### LOWER:

Too much positive camber: adjust Pivot Blocks **OUT**.

Too much negative camber: adjust Pivot Blocks **IN**.

*note: 2 full turns is 1°*

### UPPER A-ARMS:

Too much positive camber: adjust Pivot Blocks **IN**.

Too much negative camber: adjust Pivot Blocks **OUT**.

*note: 2 full turns is 1°*

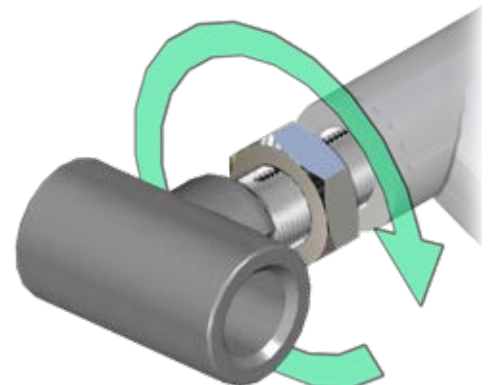

## 2 Seat Models

- Measure back approximately 6" as shown in below illustration.
- Center Template on Skid Plates and mark outline of Template onto Skid Plates.
- Remove Skid Plates from machine, follow outlines and cut out material.
- Reinstall Skid Plate to machine; tighten hardware.

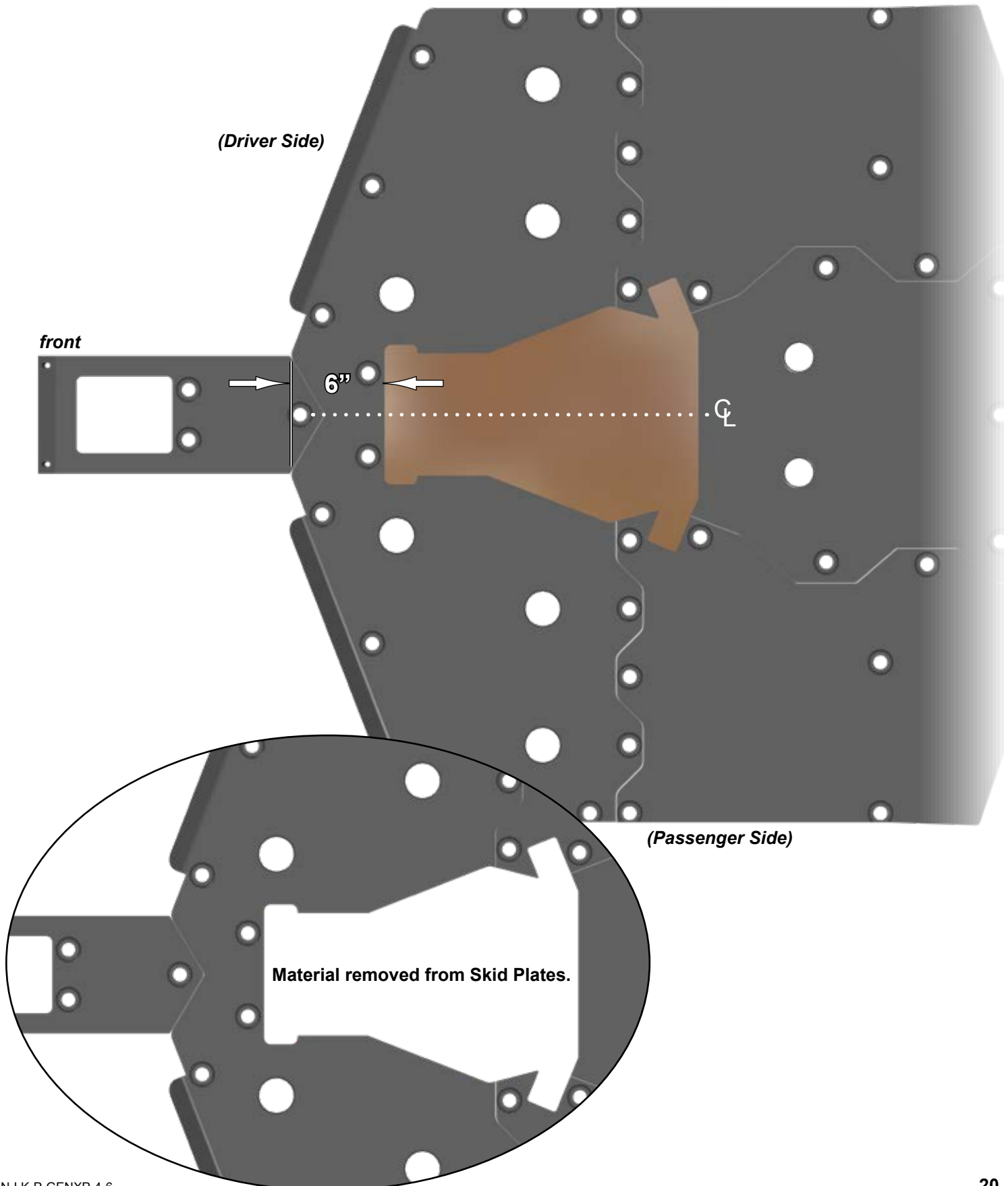



## 4 Seat Models

- Measure back approximately 6" as shown in below illustration.
- Center Template on Skid Plates and mark outline of Template onto Skid Plates.
- Remove Skid Plates from machine, follow outlines and cut out material.
- Reinstall Skid Plate to machine; tighten hardware.

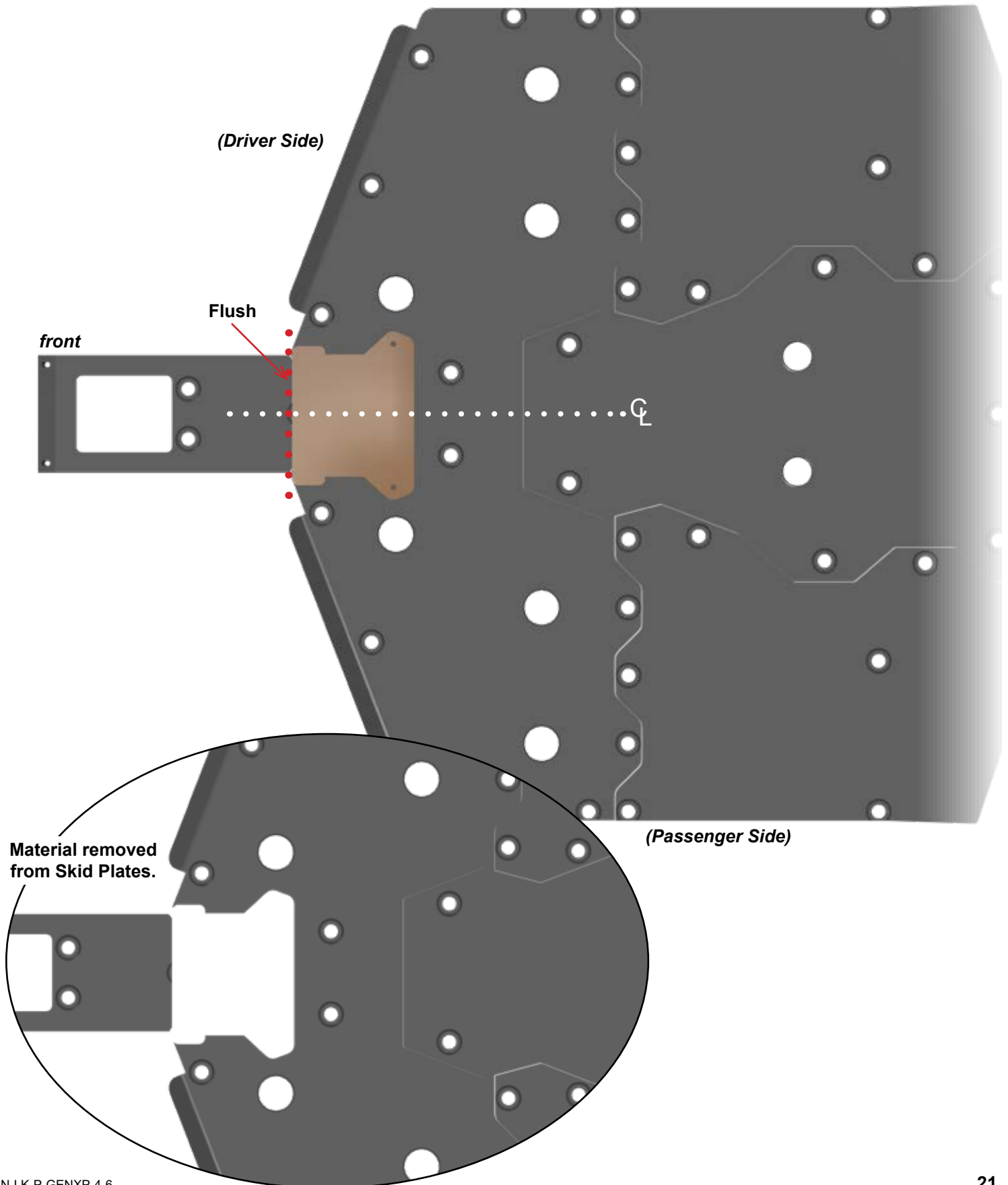

## 2 Seat Models

- Install Mount Brace (S) and Mount Plate (V) to Link Mount (R) with hardware shown; tighten.

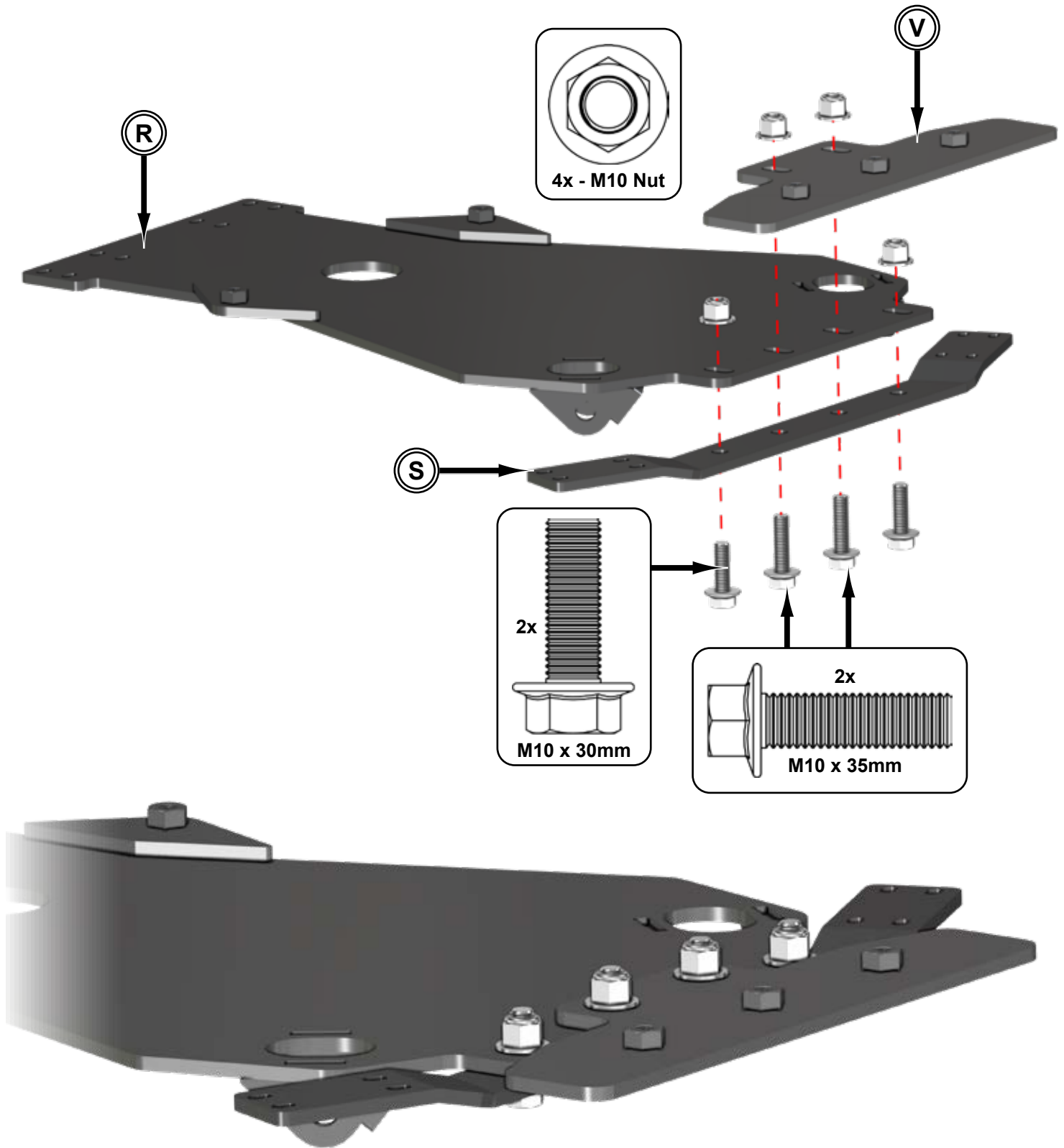

#### 4 Seat Models

- Install Mount Plate Assembly (U) to Link Mount (R) with hardware shown; tighten.

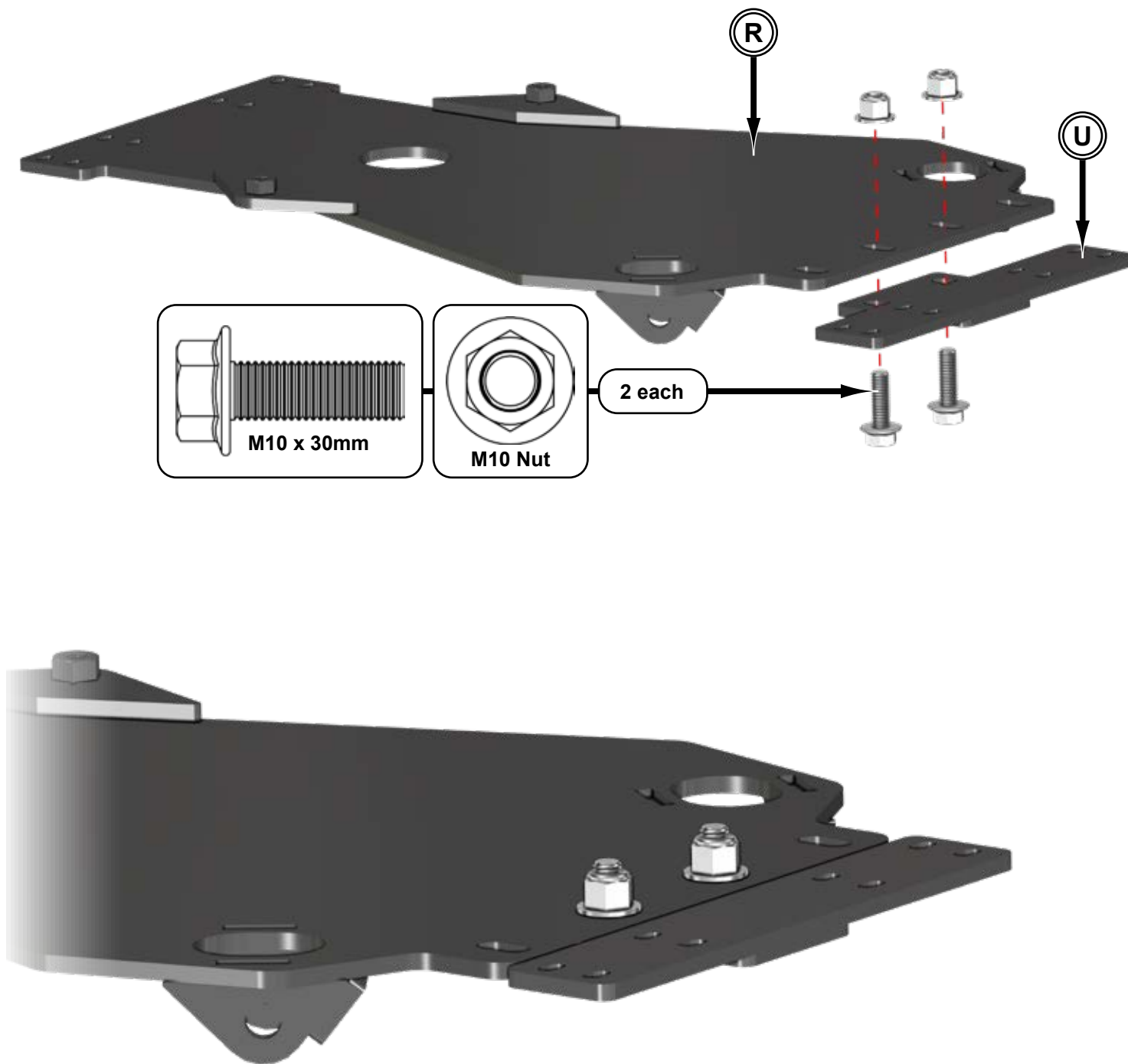

- Place Clamp (T) halves onto Frame in general locations shown.





- Align holes in Clamp (T) halves and Link Mount (R).
- Use tape to temporarily secure halves.

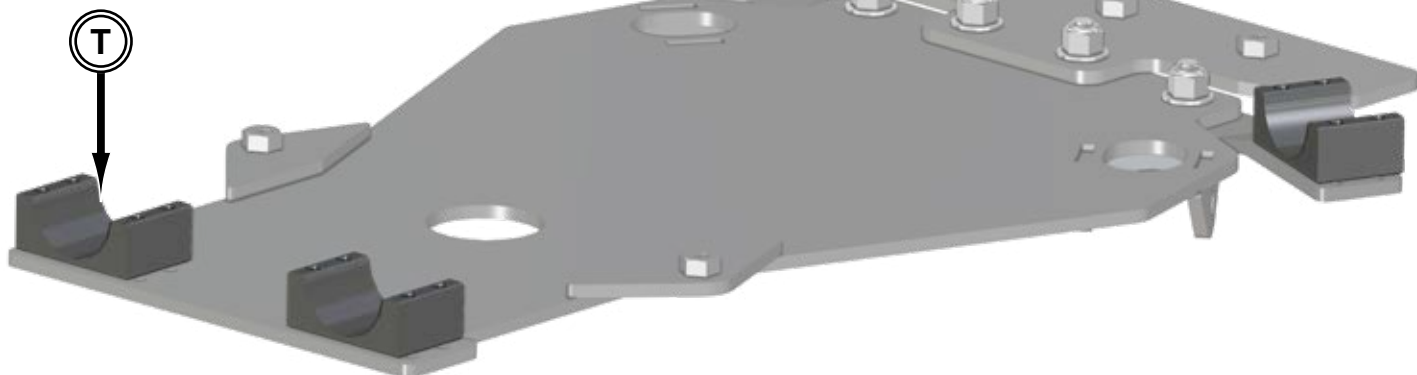

- Secure Link Mount (R) to previously installed Clamp (T) halves on Frame. Use previously removed Clamp hardware.

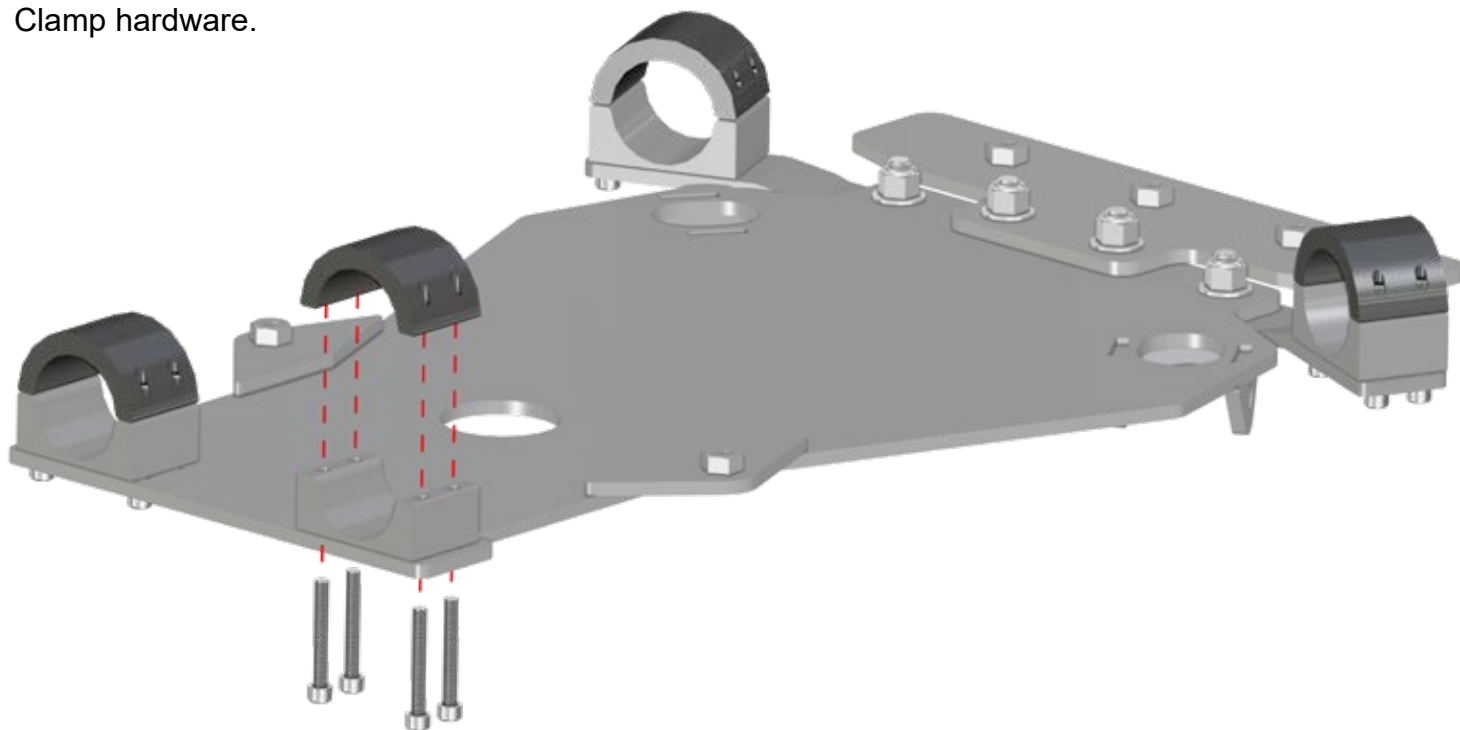

**Tighten all hardware.**

- Secure Skid Plate to Link Mount (R) and Mount Plate (V) with hardware shown; tighten.

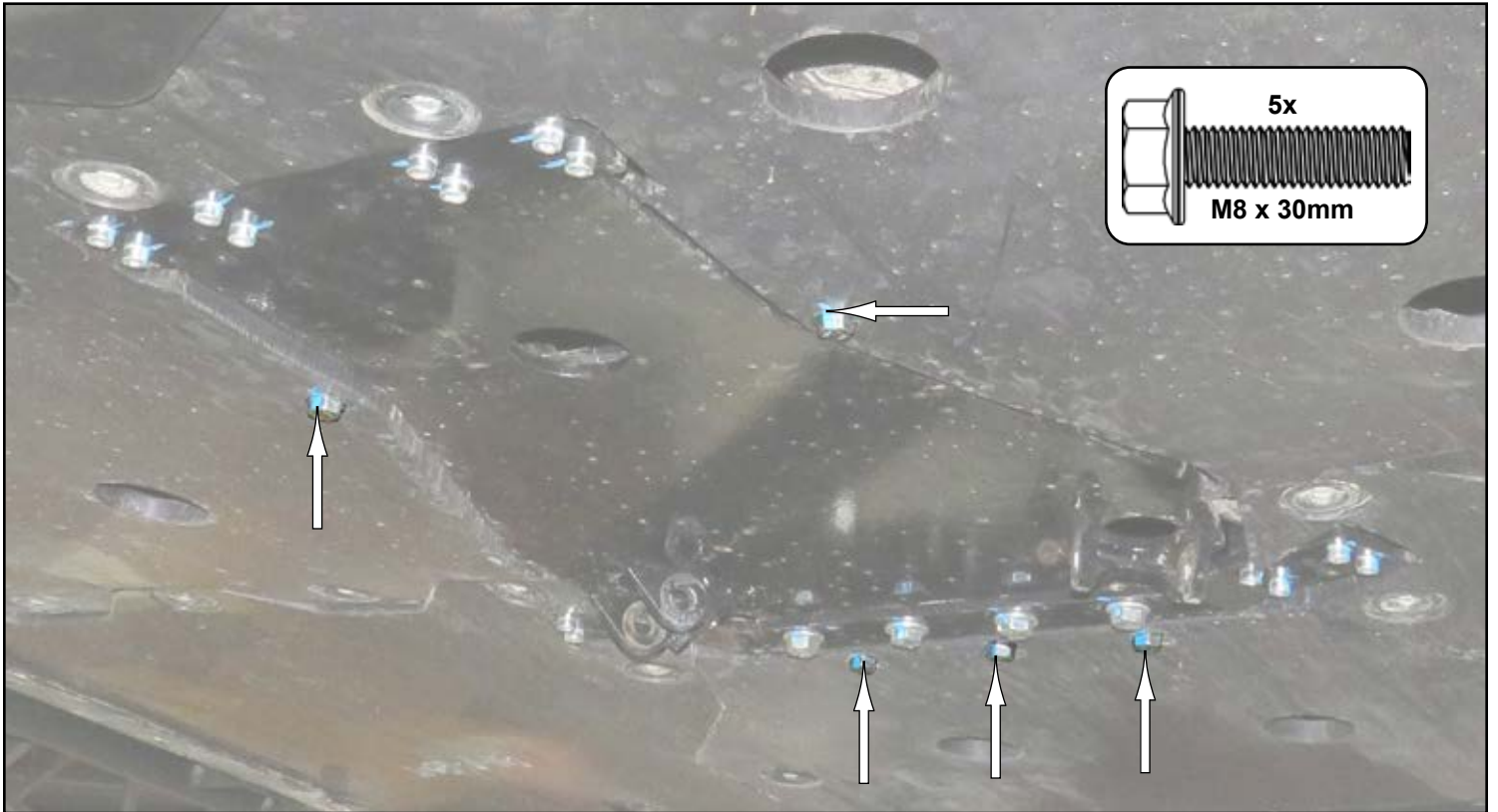

- Install Radius Link (W) to Front Lower Right (H) and Link Mount (R) with hardware shown; tighten hardware.
- Repeat for opposite Radius Link (W).

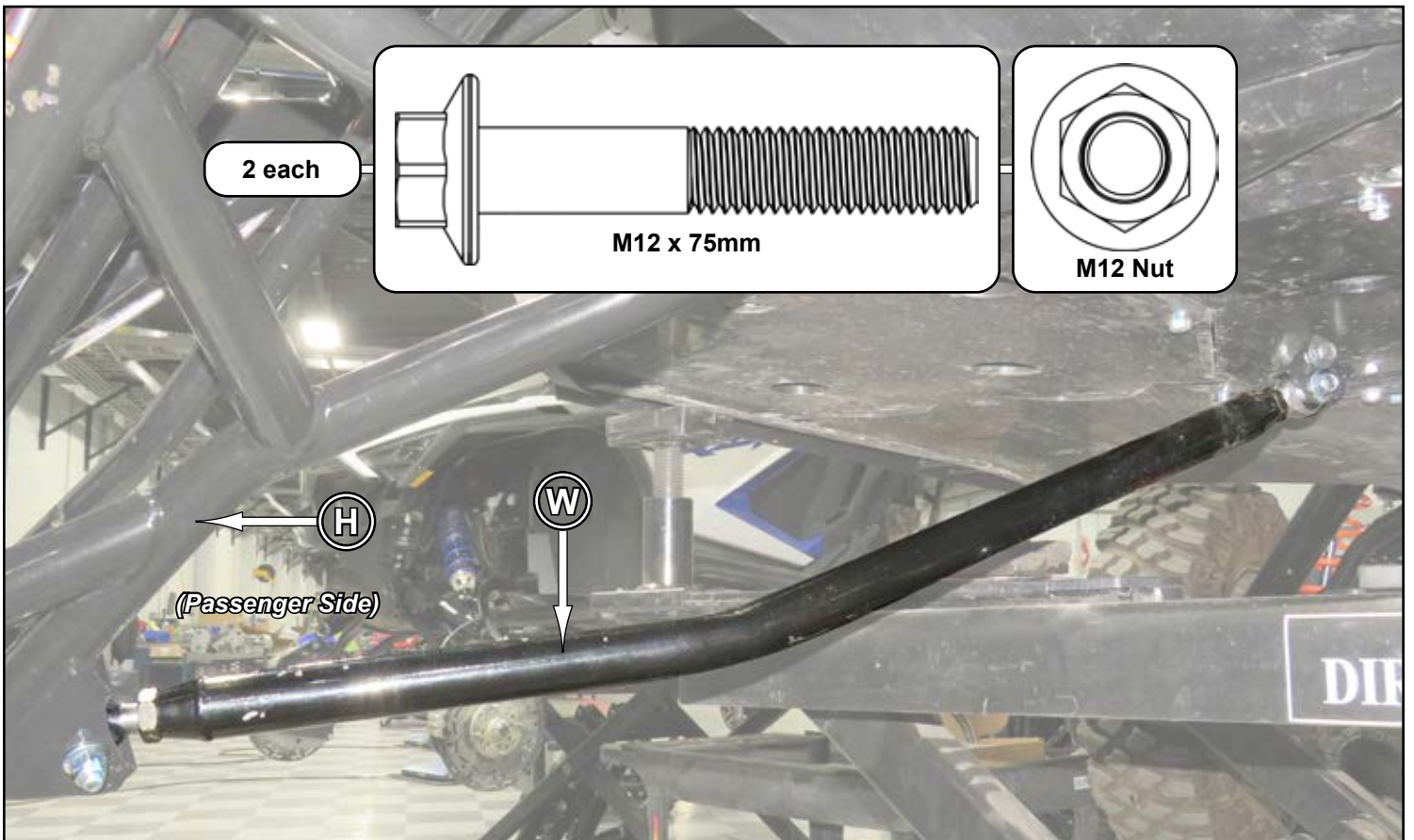

**Liability Statement**

SuperATV's® products are designed to best fit user's ATV/UTV under stock conditions. Adding, modifying, or fabricating any factory or aftermarket parts will void any warranty provided by SuperATV® and is not recommended. SuperATV's® products could interfere with other aftermarket accessories. If user has aftermarket products on machine, contact SuperATV® to verify that they will work together.

Although SuperATV® has thousands of satisfied customers, user should be aware that installing lift kits, long travel, or suspension kits, tires, etc. will change the ride of machine and may increase maintenance and part wear. Operating any off-road machine while, or after, consuming alcohol and/or drugs increases risk of bodily harm or death. No warranty or representation is made as to this product's ability to protect user from severe injury or death. SuperATV® urges operators and occupants to wear a helmet and appropriate riding gear at all times.

By purchasing and installing SuperATV® products, user agrees that should damages occur, SuperATV® will not be held responsible for loss of time, use, labor fees, replacement parts, or freight charges. SuperATV®, nor any 3rd party, will not be held responsible for any direct, indirect, incidental, special, or consequential damages that result from any product purchased from SuperATV®. The total liability of seller to user for all damages, losses, and causes of action, if any, shall not exceed the total purchase price paid for the product that gave rise to the claim.

SuperATV® will warranty only parts provided by SuperATV®. Any damage or problems with OEM housings, bearings, seals, or other manufacturers' products will not be covered by SuperATV®. SuperATV® parts and products are not warranted if item was not installed properly, misused, or modified.

Installing, adding, modifying, or fabricating any factory or aftermarket product to your ATV/UTV may violate certain local, state, and federal laws. Be advised that laws vary depending on town, city, county, state, etc. Use of certain products on public streets, roads, or highways may be in violation law. The Buyer is solely and exclusively legally and personally responsible for any violation of the law by the installation or use of the product. You must abide by all local, state, and federal laws, including but not limited to vehicle safety, traffic laws, and ordinances. It is your responsibility to know the laws and how they apply to you.

The Buyer is responsible to fully understand the capability and limitations of his/her vehicle according to manufacturer specifications, warnings and instructions and agrees to hold SuperATV® harmless from any damage resulting from failure to adhere to such specifications, warnings and/ or instructions. The Buyer is also responsible to obey all applicable federal, state, and local laws and ordinances when operating his/her vehicle while using this product, and the Buyer agrees to hold SuperATV® harmless from any violation thereof.