



Cable Ties
(10pcs)

M6x30
Socket
Shoulder
(4pcs)

M6x20
Hex
Flanged
(4pcs)

M5x45
Button FT
Screw
(2pcs)

M6x25
Button
Sealing
(4pcs)

M5
Hex
Nut
(4pcs)

M6
Flanged
Nylock
(8pcs)

Crimp-On
Wire
Splice
(1pc)

6AWG
Ring
Terminal
(1pc)

M5
Nylock
Nut
(2pcs)

M5
Flat
Washer
(8pcs)

Flanged
Sleeve
Bearing
(8pcs)

M6x45
Button FT
Screw
(2pcs)

M6
Nylock
Nut
(2pcs)

1. The first thing you need to do is install the seals all around the Windshield Assembly. **Fig.1** shows the windshield with all the seals installed to show placement.



Fig.1

2. Then **Install** the **90° Seal** along the **Bottom Edge** of the windshield as shown in **Fig.2a-b**.
(Note: Seals are all Cut-to-Fit) Cut to length and slip over edge of windshield.



Fig.2a

Fig.2b

3. Next, **Install** the **Top Corners** using the **90° Seal** also as shown in **Fig.3a-b**. Repeat for both upper corners of the Windshield. Be sure it is facing in the direction shown.



Fig.3a

Fig.3b

4. Then **Install** the **90° Seal** along the center Top Section except you will face the Bulb part facing out and away from the windshield. See **Fig.4a-b**.



Fig.4a

Fig.4b

5.Next will be the **Adhesive Backed D-Deal** on the “**L**” **Bracket**. **Peel the Adhesive Backing** off the seal and **Apply** it to the top part of the **Center Bracket** as shown in **Fig.5a-b**.

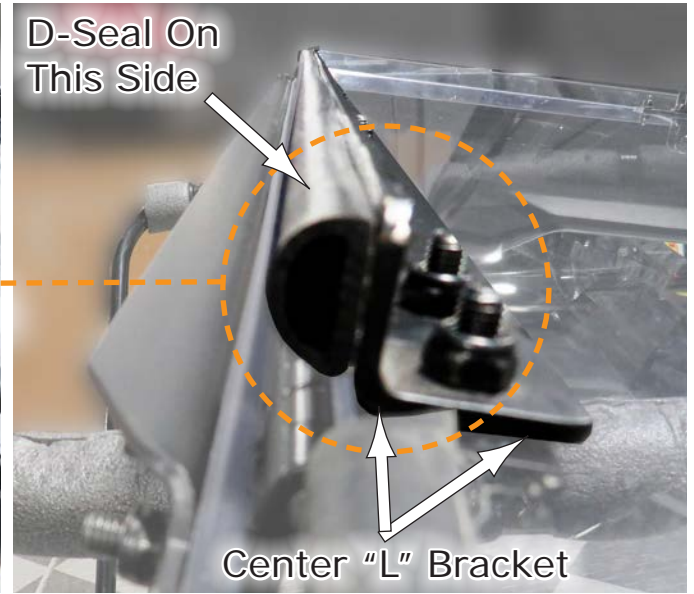

Fig.5a

Fig.5b

6.Now you can Install the **Edge Seal** in Two (2) places. **Fig.6a-c** show this small area that uses the **Edge Seal**, both left and right sides of the **L-Bracket**.



Fig.6a



Fig.6b



7. Next you will start to run the Harness Cable Thru the Dash to the Power hook-up and also to each side for the actuators that lift the windshield. But first you will need to **Remove the Center Dash Panel** as shown in **Fig.7a-b**. Just pop it off and let it rest there in place.



Fig.7a



Fig.7b

8. Once the panel out of the way you can now feed the **Harness Cable** with the **Red & Black wires** with the **Terminal Ends** on them Thru the Dash and Firewall as shown in **Fig.8a**. Then up to under the hood area thru a small space as shown in **Fig.8b**. Then pull up and over to wards the battery as shown in **Fig.8c**. Will need to remove hood.

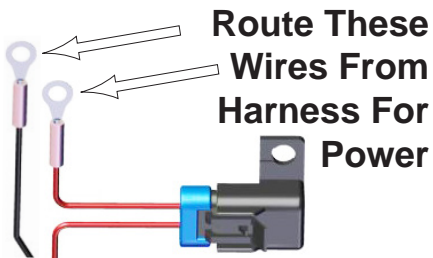

Fig.8a

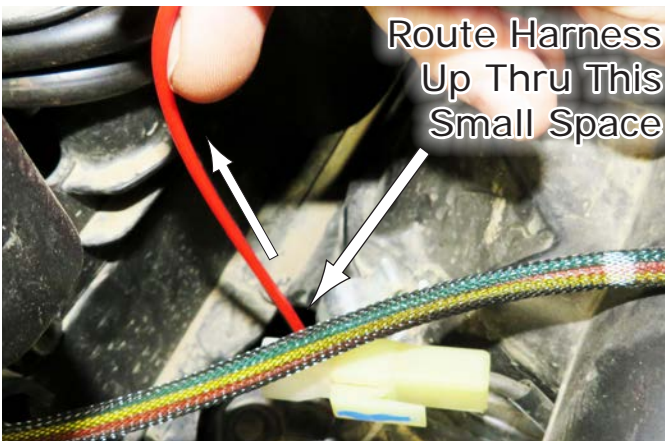

Fig.8b

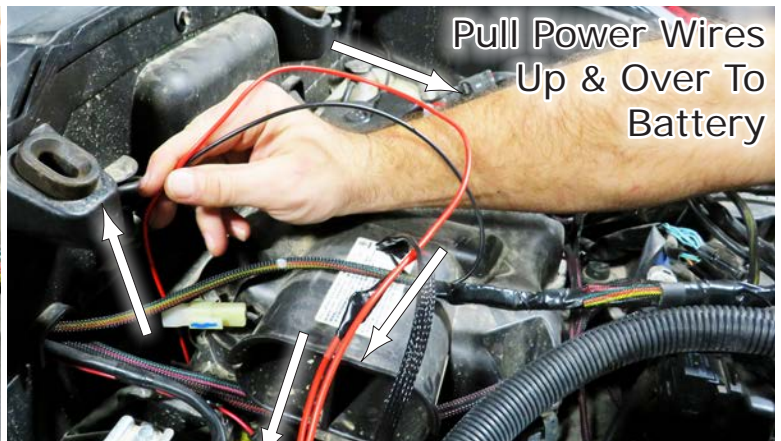

Fig.8c

9. Now there are Two (2) different ways you can connect the power to the windshield. One goes straight to the battery and will be live power to the windshield all the time, and the other way is connecting to a factory plug to give you "Key-On" power so you can only operate it when the key is in the ON position. We will show you the direct hook-up to the battery first.

Simply run the **Red & Black** wires with the **Ring Terminals** on them to the battery and screw the terminals to the battery posts. Red to Positive and Black to Negative as shown in **Fig.9**.

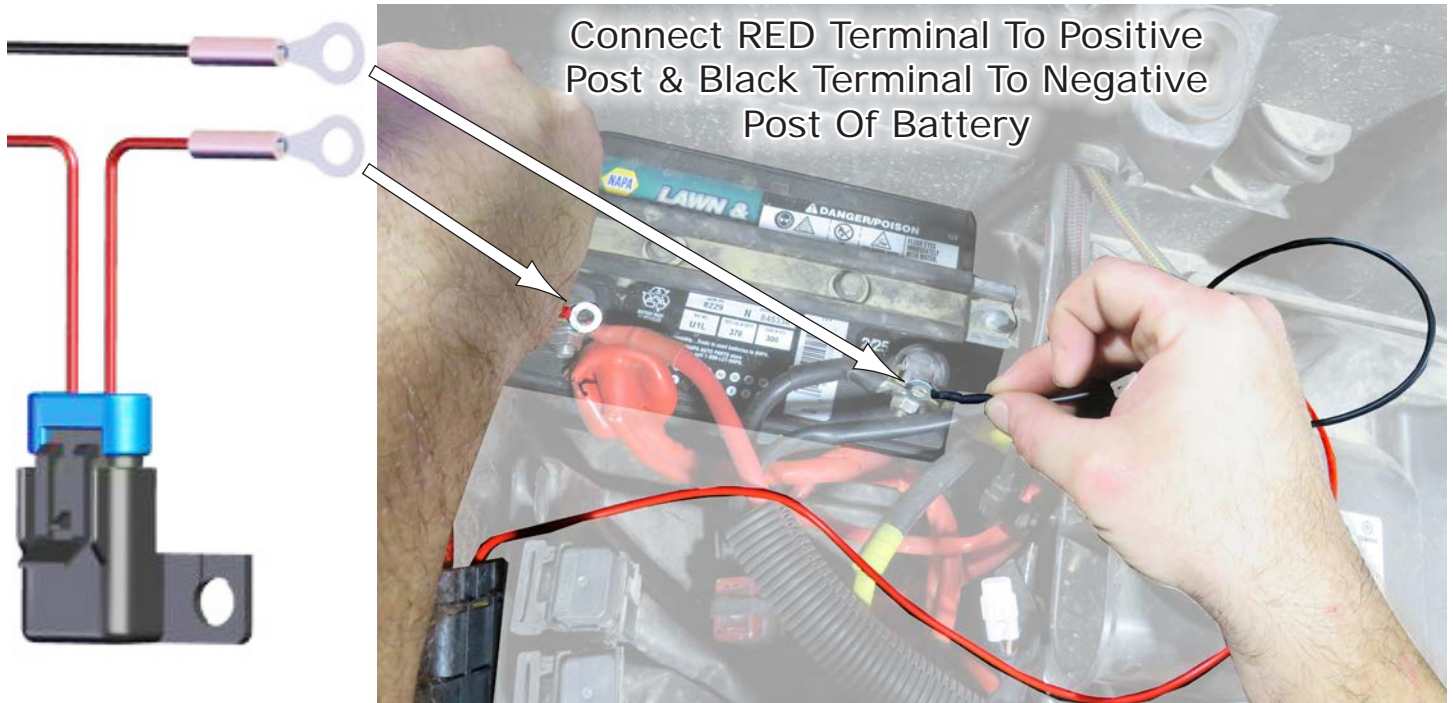

Fig.9

10. The **Key-On** hook-up is shown next. Find the **Optional Power Supply Pigtail** connector in your kit. Then you will connect the Black wire from the pigtail to the black wire with the Ring Terminal on it. You can Solder together or cut and splice them together. Then connect the Red wire from the pigtail and connect it to the Red wire Terminal from the harness as shown in **Fig.10a**. Once those are connected together, then find the **Factory Connector** with the **Brown & Black Wires** located in that same area laying loose in the machine, as shown in **Fig.10b**.



Fig.10a



Fig.10b

11. Then **Connect the Brown & Black Factory Connector** to the **Pigtail**. This has connected the Key-On power for the windshield. See **Fig.11**.

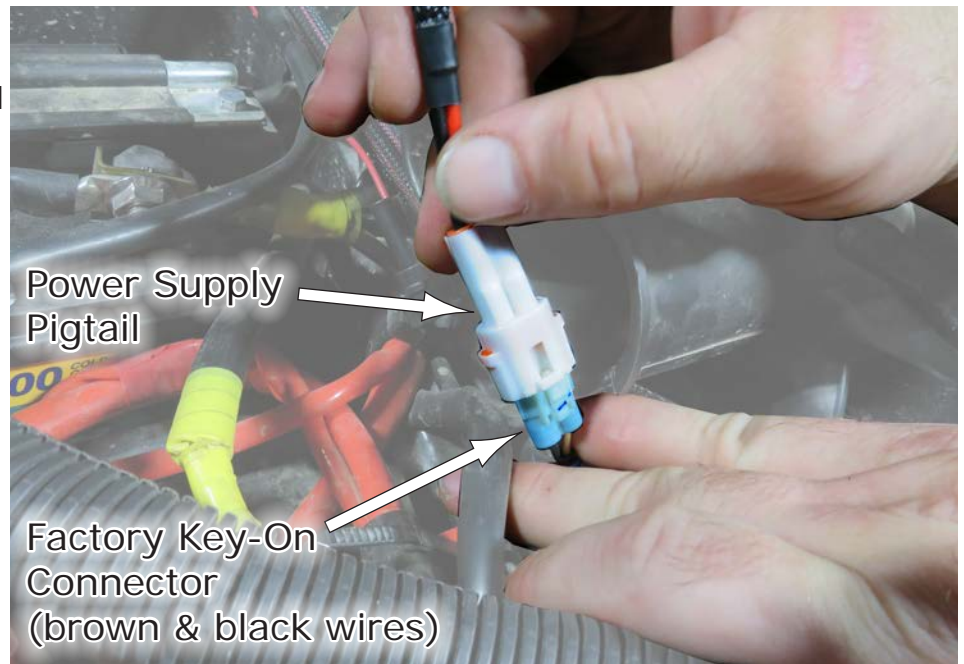

Fig.11

12. Now you are ready to **Route the Actuator Power Cables** from the Harness to each side. Route the cables thru the dash and thru the opening towards the passenger's side wheel well, as shown in **Fig.12a-b**.

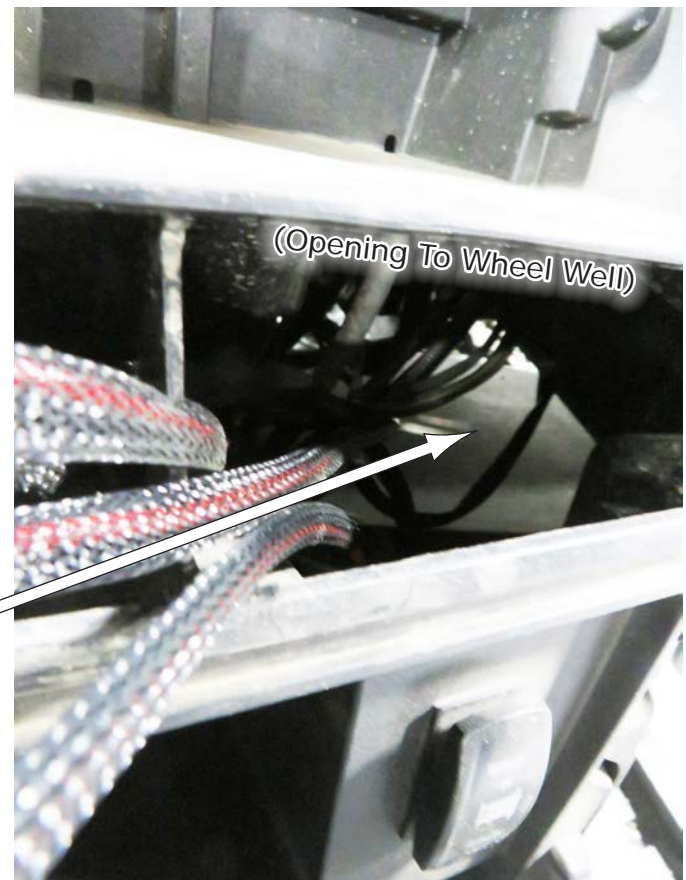

Fig.12a

Fig.12b

13. Then go around to the wheel well (we are doing the driver's side here first), and pull the Actuator Power Connector out a little as shown in **Fig.13a**. Then Route the connector up thru the small hole by the frame Tube as shown in **Fig.13b**, then up and out a little as shown in **Fig.13c**. This will make it easier to connect the Actuator to the harness cable connector.



Fig.13a

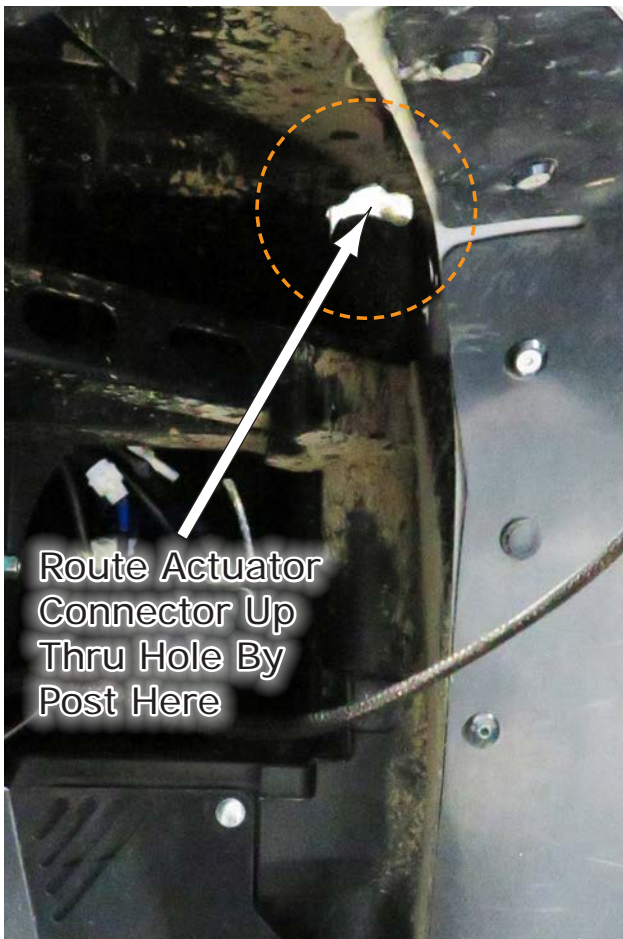

Fig.13b



Fig.13c

NOTE: You will need to remove One Screw on each side to loosen the dash to gain more space to make it easier to pull the connectors thru the hole. See below.



14. Now take one of the **Actuator Cylinders** and **Connect** it to the **Power Connector** you just pushed up thru the hole as shown in **Fig.14a**. Then you can pull it back down thru the hole into the wheel well area if you want, or wait until the actuator is completely installed, either way. See **Fig.14b**. Repeat the same for opposite side.

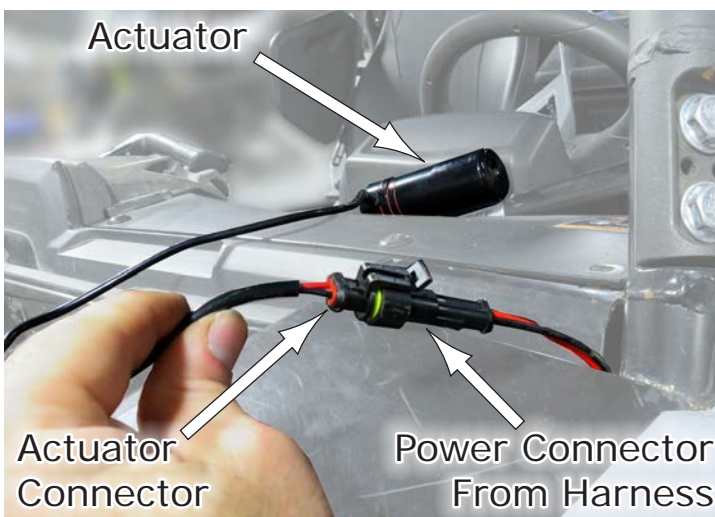

Fig.14a

Fig.14b

15. After you have both the Actuators connected to the power harness connectors, now you can install the **Actuator Brackets**. Install them using the **M5x45 Button FT Screws** and **M6x45 Button FT Screws** along with the **M5 & M6 Nylock Nuts** provided in your kit. The following diagram shows where each screw goes in the **Actuator Brackets**. **Install the Screws & Hardware but leave them slightly loose to adjust after Actuator is installed and installed onto windshield.** Repeat the same for the opposite side. See Fig.15a-d.



Fig.15a

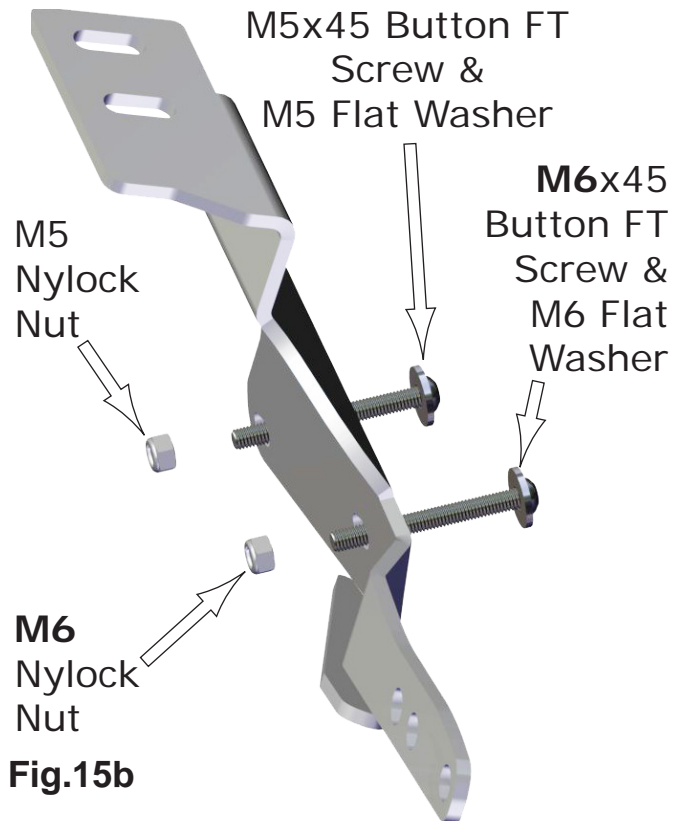

Fig.15b



Fig.15c



Fig.15d

16. Now you can install the **Bracket-2** to the Actuator Bracket. Do this using the **M6x20 Hex Flanged Bolt** and **M6 Nylock Nuts**, and tighten secure. Repeat for the opposite side. See **Fig.16a-b**.



Fig.16a



Fig.16b

17. Once all the brackets are installed, you can now **Place** the **Windshield** on the machine as shown in **Fig.17a**. You will slide the top of the windshield up under the roof and align the holes in the Actuator Brackets you just installed to the holes in the windshield. As shown in **Fig.17b**. Then install using the **M6x25 Button Sealing Screws** and **M6 Nylock Nuts** as shown in **Fig.17c-d**. Install but do not tighten down in case of adjustments after Actuators are installed. Repeat same for opposite side.



Fig.17a

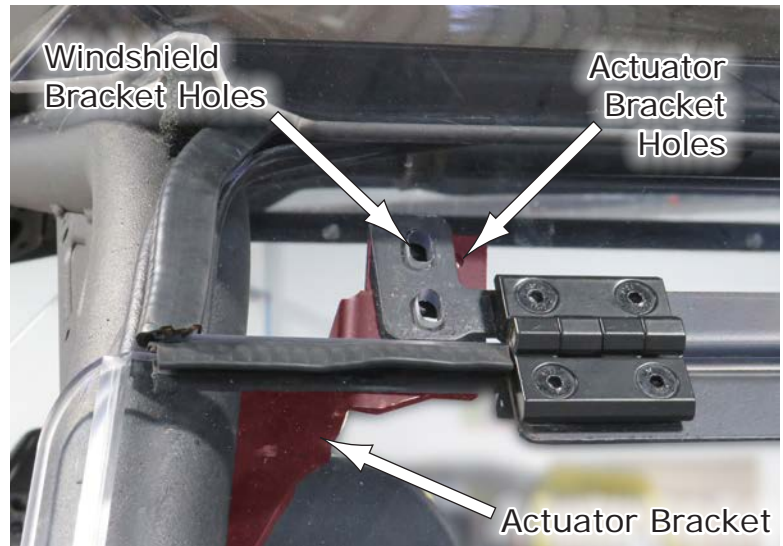

Fig.17b

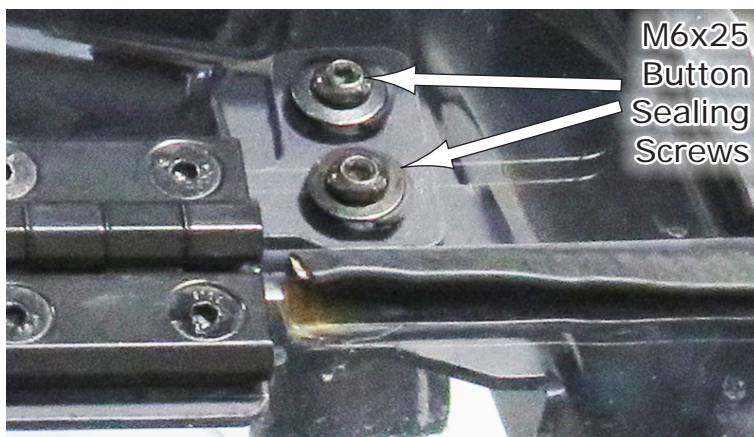

Fig.17c

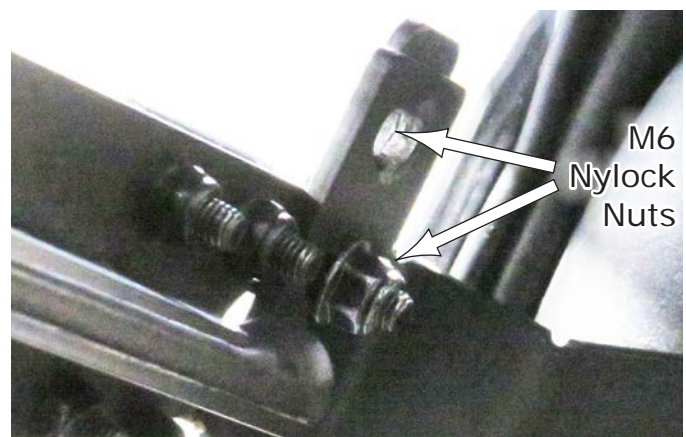

Fig.17d

18. Now you can **Install** the **Actuator** to the Actuator Brackets. **Fig.18a** shows how the hardware assembles onto the top of the Actuator. **Fig.18b** show them installed. Install and tighten secure. Repeat for the opposite side.

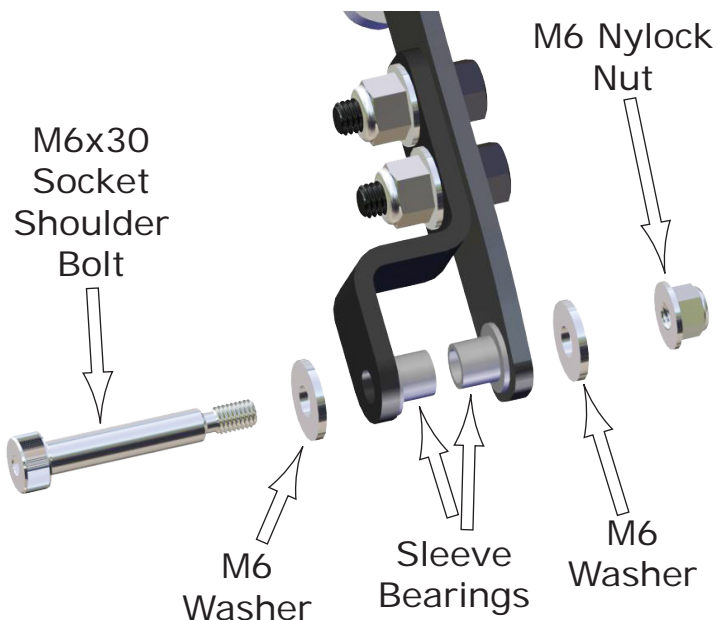

Fig.18a



Fig.18b



19. After you hook up the Actuator to the bracket, now you can **Install** the **Lower** end of the **Actuator** to the **Windshield Bracket**. Install using the same hardware as you used for the upper bracket you just installed. **Fig.19a-b** show how these are assembled onto the actuator and windshield bracket. Repeat for the opposite side. After the actuators are hooked up, then go back and tighten down all bolts and nuts secure.



Fig.19a

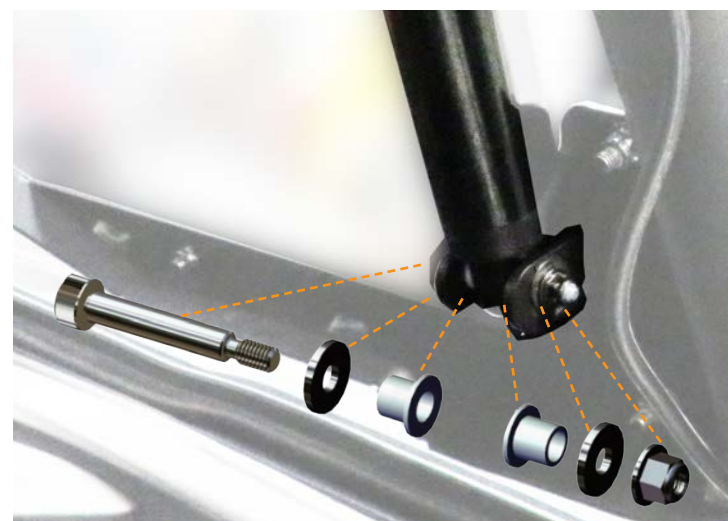

Fig.19b

20. Next you can **Install** the **Actuator Switch** in to the **Dash Panel**. Pick a slot to install the switch into in the dash panel and snap it into place. See **Fig.20a**. Then **Connect** the **Harness Connector** from your Harness to the switch as shown in **Fig.20b**. Then pop the dash panel back onto the dash and secure ready to go. See **Fig.20c-d**.

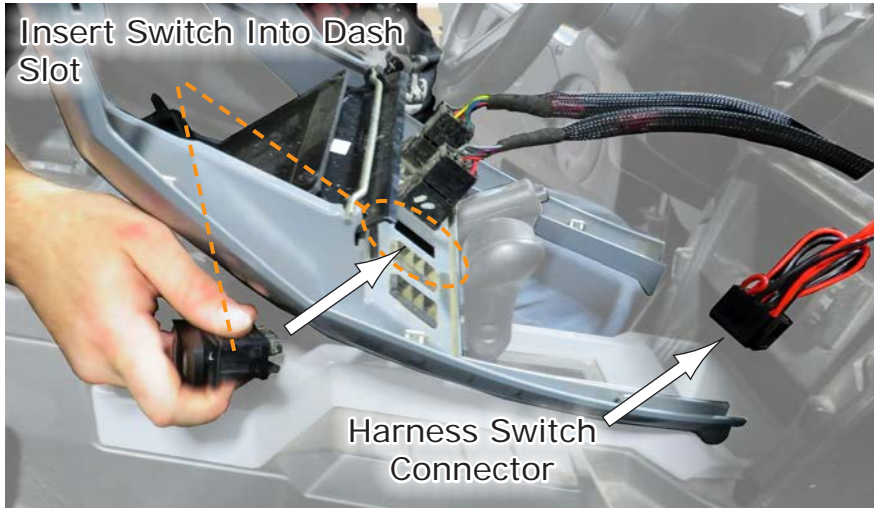

Fig.20a

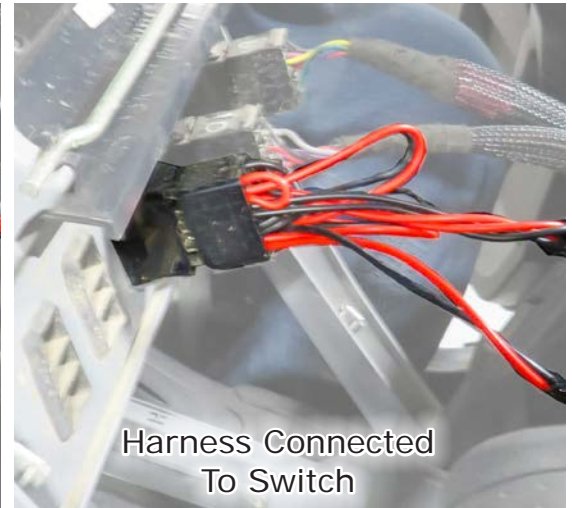

Fig.20b

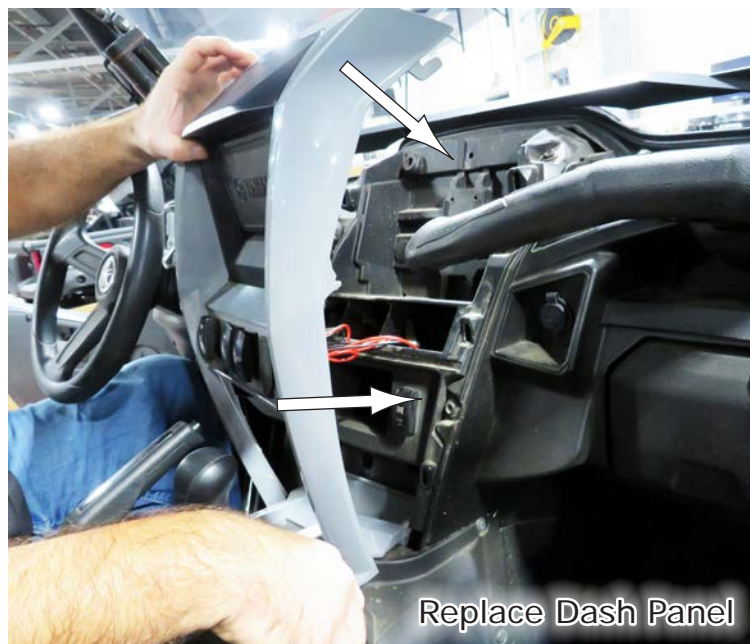

Fig.20c



Fig.20d



Liability Statement

SuperATV's® products are designed to best fit user's ATV/UTV under stock conditions. Adding, modifying, or fabricating any factory or aftermarket parts will void any warranty provided by SuperATV® and is not recommended. SuperATV's® products could interfere with other aftermarket accessories. If user has aftermarket products on machine, contact SuperATV® to verify that they will work together.

Although SuperATV® has thousands of satisfied customers, user should be aware that installing lift kits, long travel, or suspension kits, tires, etc. will change the ride of machine and may increase maintenance and part wear. Operating any off-road machine while, or after, consuming alcohol and/or drugs increases risk of bodily harm or death. No warranty or representation is made as to this product's ability to protect user from severe injury or death. SuperATV® urges operators and occupants to wear a helmet and appropriate riding gear at all times.

By purchasing and installing SuperATV® products, user agrees that should damages occur, SuperATV® will not be held responsible for loss of time, use, labor fees, replacement parts, or freight charges. SuperATV®, nor any 3rd party, will not be held responsible for any direct, indirect, incidental, special, or consequential damages that result from any product purchased from SuperATV®. The total liability of seller to user for all damages, losses, and causes of action, if any, shall not exceed the total purchase price paid for the product that gave rise to the claim.

SuperATV® will warranty only parts provided by SuperATV®. Any damage or problems with OEM housings, bearings, seals, or other manufacturers' products will not be covered by SuperATV®. SuperATV® parts and products are not warranted if item was not installed properly, misused, or modified.

Installing, adding, modifying, or fabricating any factory or aftermarket product to your ATV/UTV may violate certain local, state, and federal laws. Be advised that laws vary depending on town, city, county, state, etc. Use of certain products on public streets, roads, or highways may be in violation law. The Buyer is solely and exclusively legally and personally responsible for any violation of the law by the installation or use of the product. You must abide by all local, state, and federal laws, including but not limited to vehicle safety, traffic laws, and ordinances. It is your responsibility to know the laws and how they apply to you.

The Buyer is responsible to fully understand the capability and limitations of his/her vehicle according to manufacturer specifications, warnings and instructions and agrees to hold SuperATV® harmless from any damage resulting from failure to adhere to such specifications, warnings and/ or instructions. The Buyer is also responsible to obey all applicable federal, state, and local laws and ordinances when operating his/her vehicle while using this product, and the Buyer agrees to hold SuperATV® harmless from any violation thereof.

If you have any problems/questions on this kit, contact us by email at Superatv.com.

Need help with your installation?



sales@superatv.com



www.superatv.com



1-855-743-3427



8:00am - 9:00pm EST M-Th
8:00am - 7:00pm EST Friday
9:00am - 2:00pm EST Saturday

*Thank You
For Choosing*



Like SuperATV on Facebook to keep up to date on new products!