

- Do not discard packaging until product has been successfully installed.

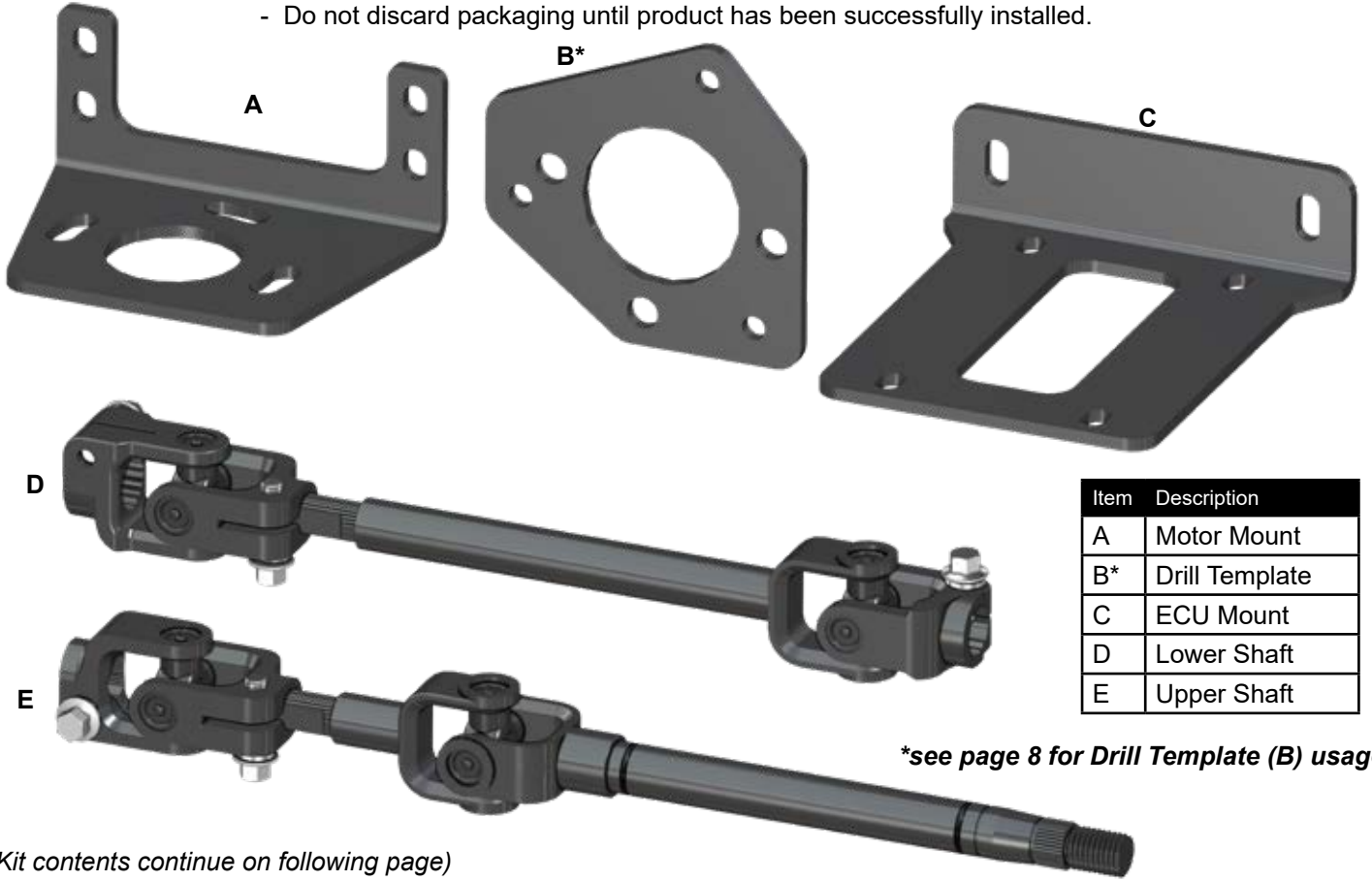

| Item | Description |
|------|----------------|
| A | Motor Mount |
| B* | Drill Template |
| C | ECU Mount |
| D | Lower Shaft |
| E | Upper Shaft |

**see page 8 for Drill Template (B) usage*

(Kit contents continue on following page)

Liability Statement
 SuperATV's® products are designed to best fit user's ATV/UTV under stock conditions. Adding, modifying, or fabricating any factory or aftermarket parts will void any warranty provided by SuperATV® and is not recommended. SuperATV's® products could interfere with other aftermarket accessories. If user has aftermarket products on machine, contact SuperATV® to verify that they will work together.

Although SuperATV® has thousands of satisfied customers, user should be aware that installing lift kits, long travel, or suspension kits, tires, etc. will change the ride of machine and may increase maintenance and part wear. Operating any off-road machine while, or after, consuming alcohol and/or drugs increases risk of bodily harm or death. No warranty or representation is made as to this product's ability to protect user from severe injury or death. SuperATV® urges operators and occupants to wear a helmet and appropriate riding gear at all times.

By purchasing and installing SuperATV® products, user agrees that should damages occur, SuperATV® will not be held responsible for loss of time, use, labor fees, replacement parts, or freight charges. SuperATV®, nor any 3rd party, will not be held responsible for any direct, indirect, incidental, special, or consequential damages that result from any product purchased from SuperATV®. The total liability of seller to user for all damages, losses, and causes of action, if any, shall not exceed the total purchase price paid for the product that gave rise to the claim.

SuperATV® will warranty only parts provided by SuperATV®. Any damage or problems with OEM housings, bearings, seals, or other manufacturers' products will not be covered by SuperATV®. SuperATV® parts and products are not warranted if item was not installed properly, misused, or modified.

Installing, adding, modifying, or fabricating any factory or aftermarket product to your ATV/UTV may violate certain local, state, and federal laws. Be advised that laws vary depending on town, city, county, state, etc. Use of certain products on public streets, roads, or highways may be in violation law. The Buyer is solely and exclusively legally and personally responsible for any violation of the law by the installation or use of the product. You must abide by all local, state, and federal laws, including but not limited to vehicle safety, traffic laws, and ordinances. It is your responsibility to know the laws and how they apply to you.

The Buyer is responsible to fully understand the capability and limitations of his/her vehicle according to manufacturer specifications, warnings and instructions and agrees to hold SuperATV® harmless from any damage resulting from failure to adhere to such specifications, warnings and/ or instructions. The Buyer is also responsible to obey all applicable federal, state, and local laws and ordinances when operating his/her vehicle while using this product, and the Buyer agrees to hold SuperATV® harmless from any violation thereof.

Need help with your installation?

✉ sales@superatv.com 🖥 www.superatv.com

☎ 1-855-743-3427 🕒 8:00am - 8:00pm EST M-Th
 8:00am - 7:00pm EST Friday
 9:00am - 2:00pm EST Saturday

Read instructions and view illustrations before beginning.

Thank You
For Choosing
SUPERATV.COM[®]

| Item | Description |
|------|--------------|
| G | Motor |
| H | ECU |
| J | Wire Harness |

(Kit contents continued)

(Upper Shaft connects to this Shaft on Motor)



Connectors

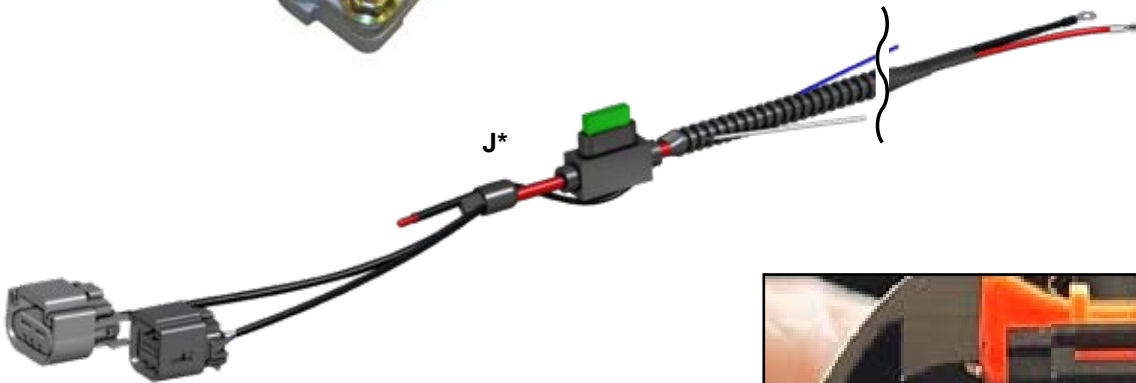
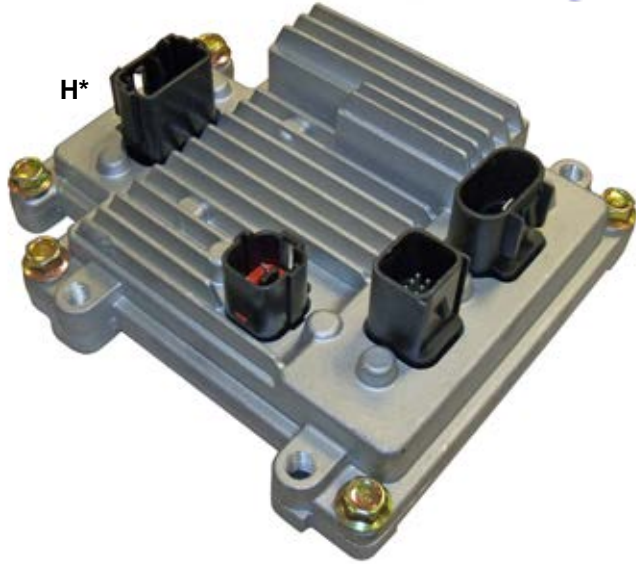

*Connections

- Before installing, ensure that all Gaskets in electrical connections are properly seated.
- If Gaskets are not seated use a Flathead Screwdriver to seat.

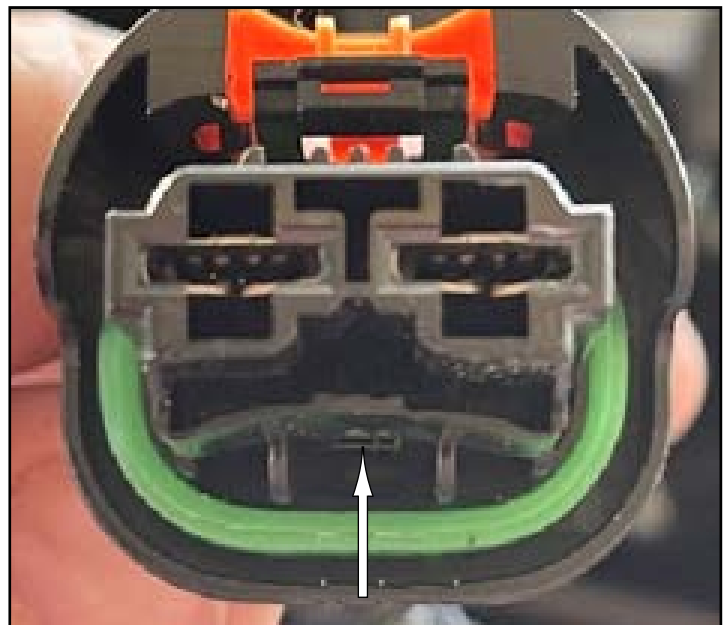

On **600W Motor Connector**, where arrow is pointing, is a small spring which needs to be slightly nudged up when plugging in.





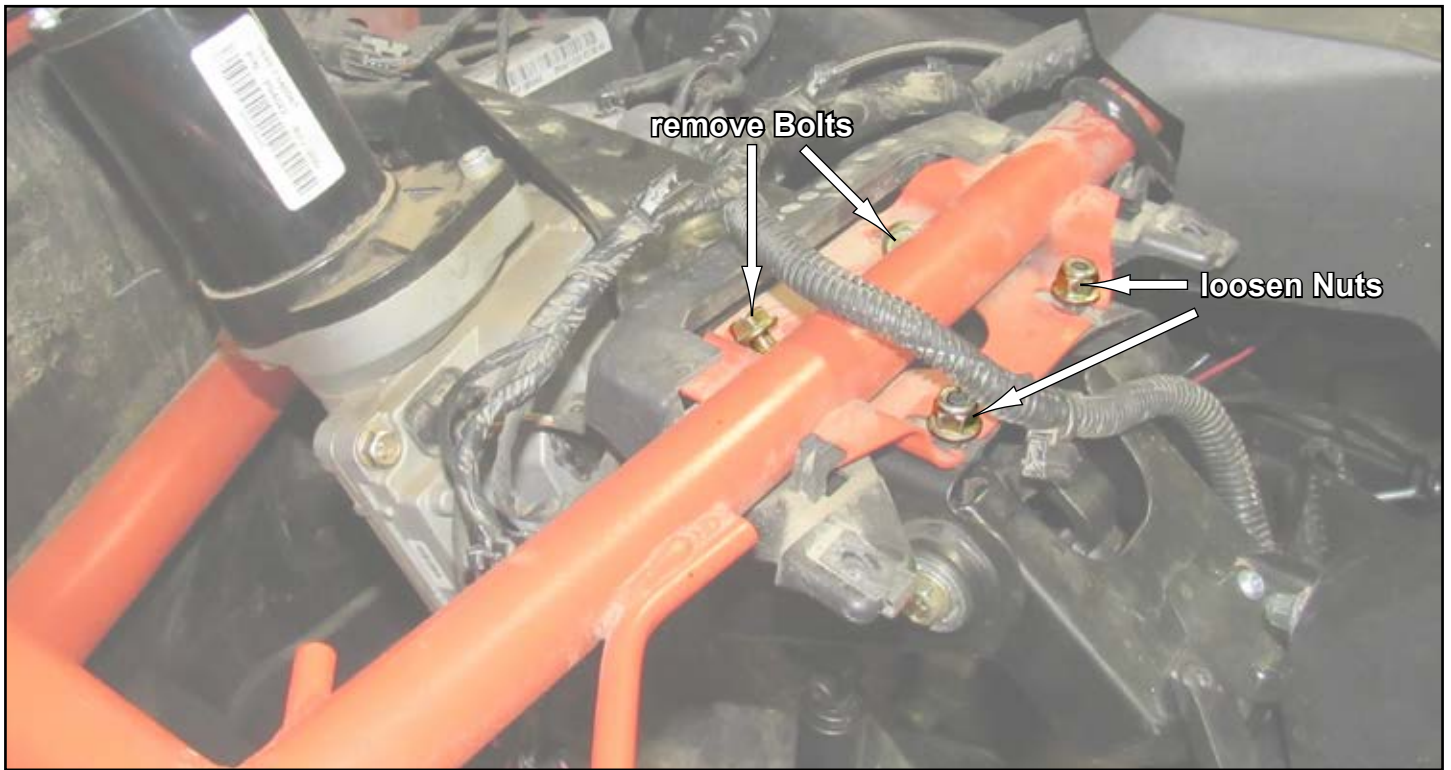

- Wrap stock connections with plastic and tape to keep water out.
- Secure in an out of the way location.

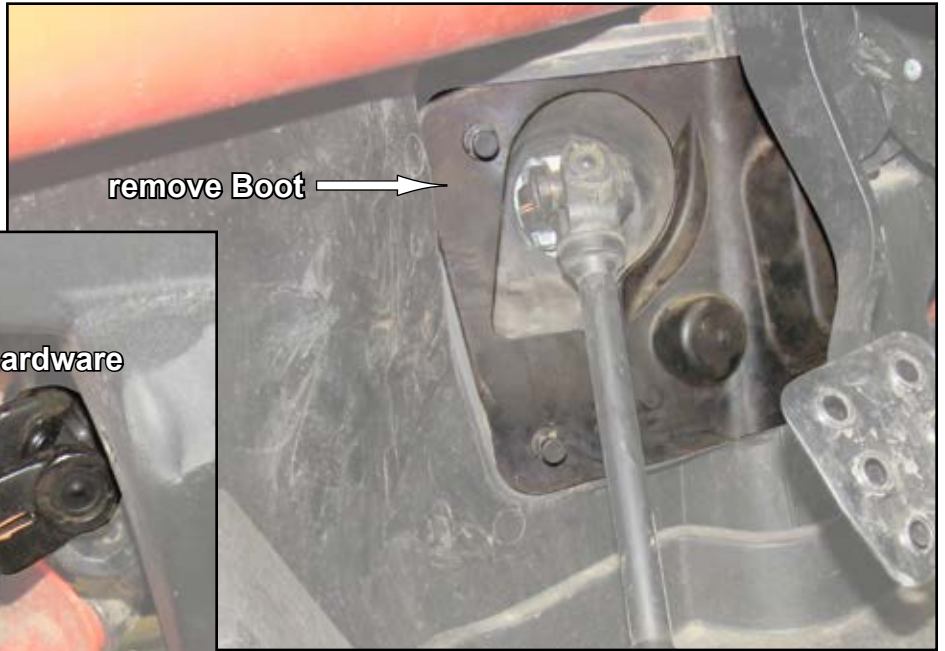



2017, 2022, and some early 2018 models, have Bracket shown. Use provided Drill Template (B) to create new holes. Motor (G) will bolt directly to stock Bracket. See *following page*.
2018+ (except 2022) models do not need to be drilled. Motor Mount (A) will bolt directly to stock Motor Mount location on Frame. See *page 13*.



If DPS Support has welded in plate, use Drill Template (B) and create mounting holes.



- Install Drill Template (B) to stock Motor Mount with hardware shown.
- Create (3) holes in stock Motor Mount.
- Remove Drill Template (B) and hardware.

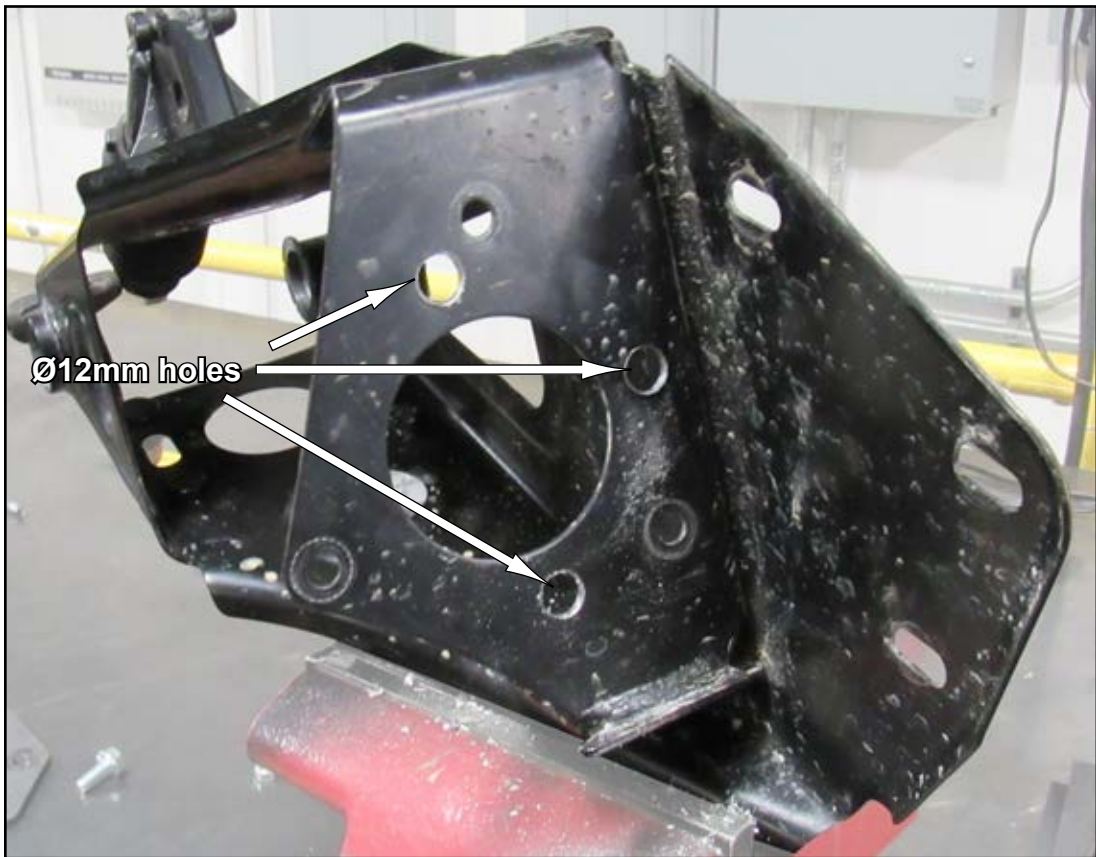
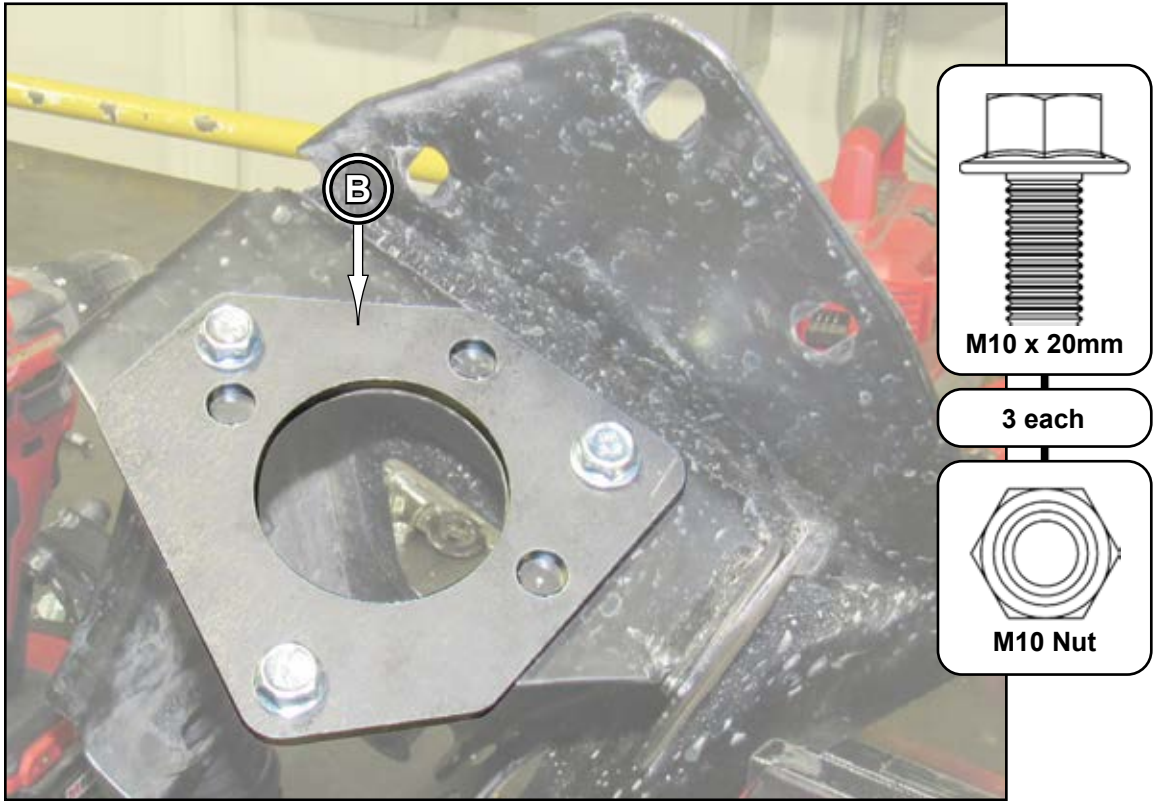

- Reinstall stock Motor Mount with stock hardware.

Installation: *Do not tighten hardware completely unless noted.*

- Insert Lower Shaft (D) through Firewall and secure to Rack and Pinion with provided Shaft hardware.



- Install ECU (H) to ECU Mount (C) with hardware shown; tighten hardware.
- Install Clamps to ECU Mount (C) with hardware shown; do not tighten hardware.

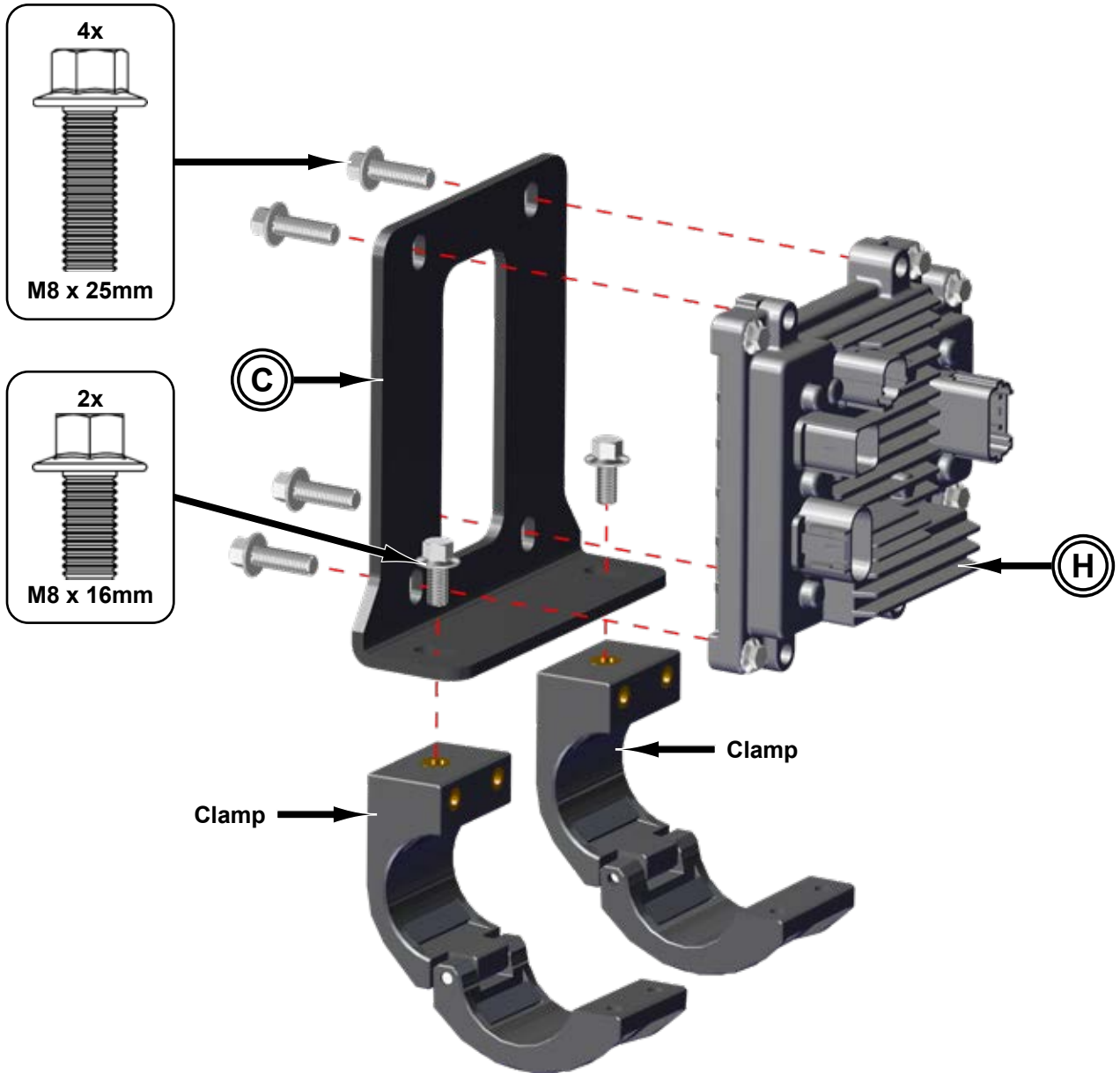

- Secure ECU Mount (C) assembly to Cage.



- Install Motor Mount (A) with hardware shown; do not tighten hardware.

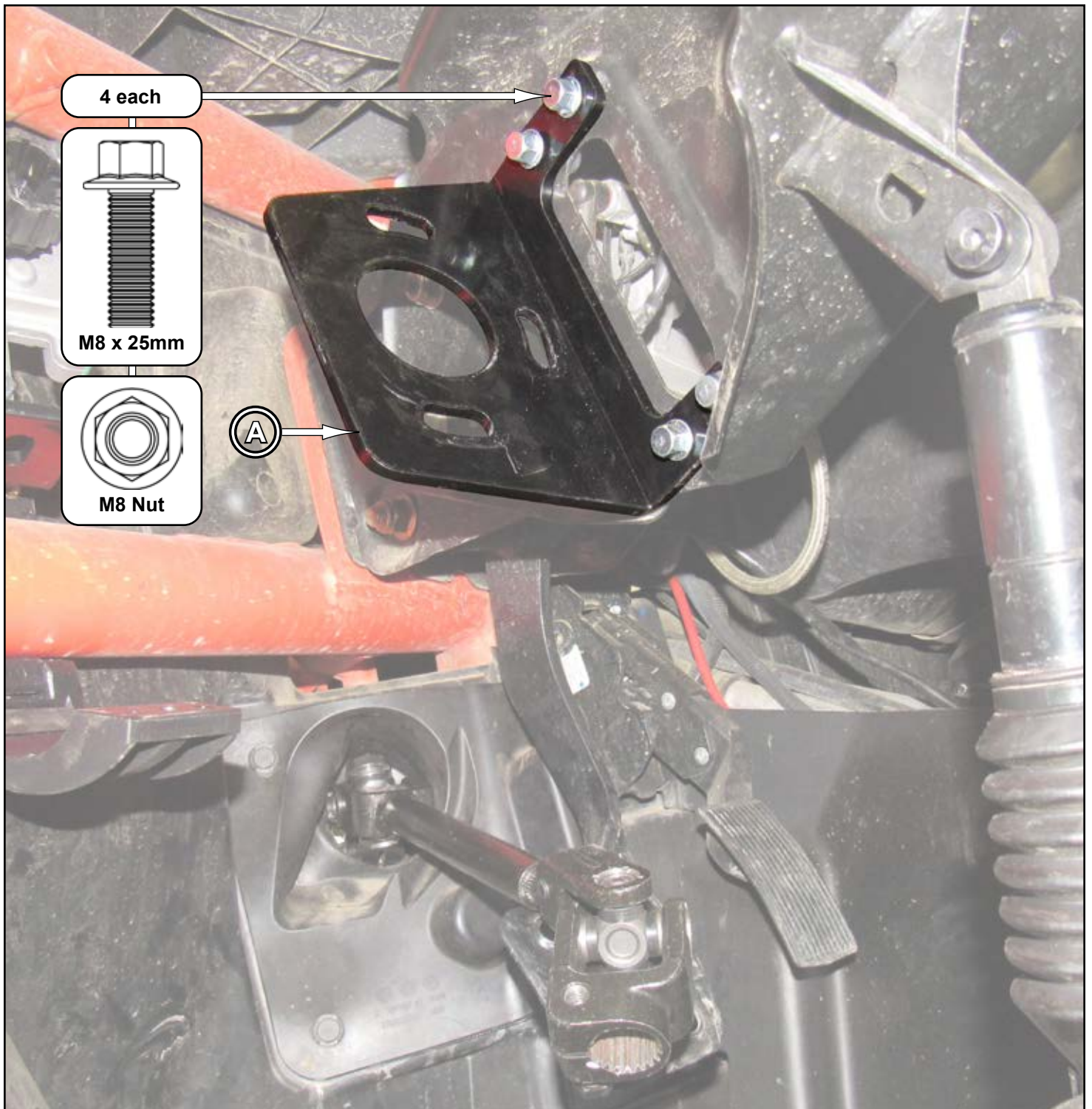

- Secure Lower Shaft (D) to Motor (G) with provided hardware.
- Secure Motor (G) to Motor Mount (A), or stock Motor Mount depending on model year, with hardware shown.

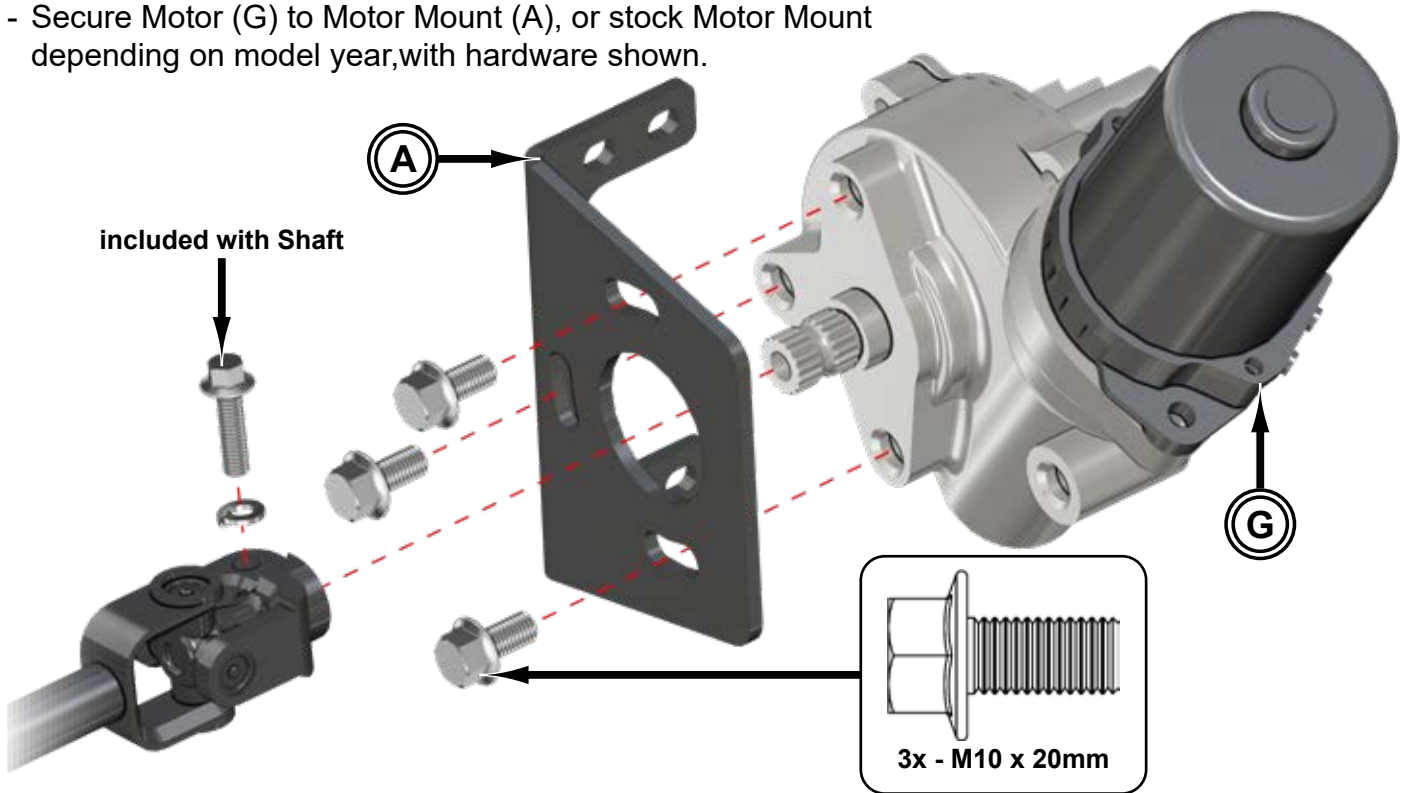

- Insert Upper Shaft (E) into Steering Support and secure with Snap Ring.
- Secure Upper Shaft to Motor (G) with provided Shaft hardware.
- Secure Steering Support and Tilt Adjustor with stock hardware.
- Reinstall Steering Wheel.

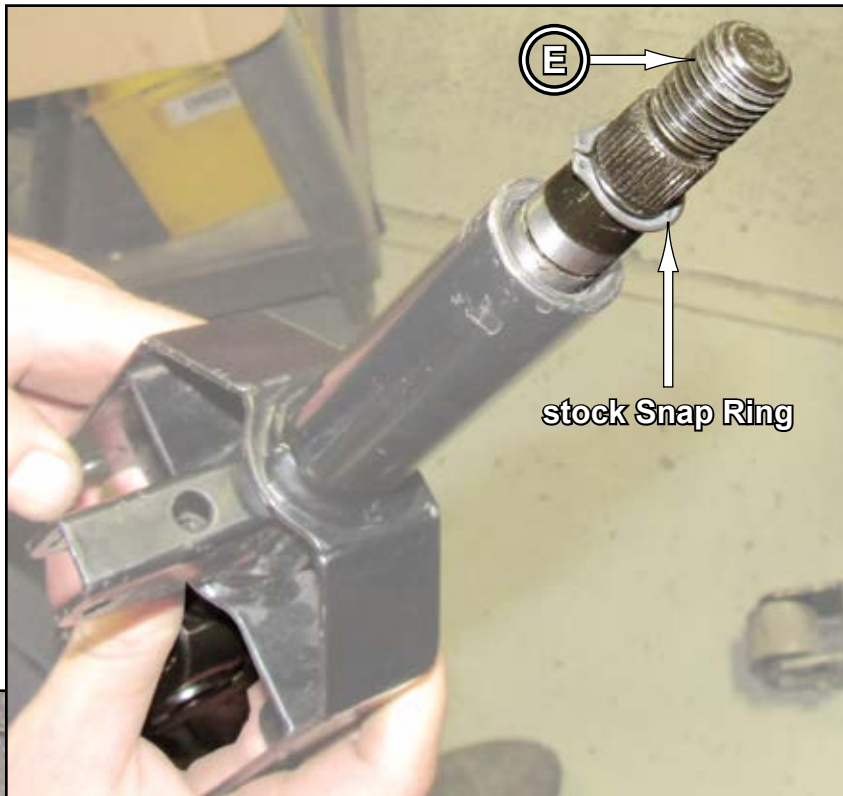

Wiring Details

BLUE WIRE IS NOT USED. SEAL END OF BLUE WIRE AND SECURE OUT OF WAY.

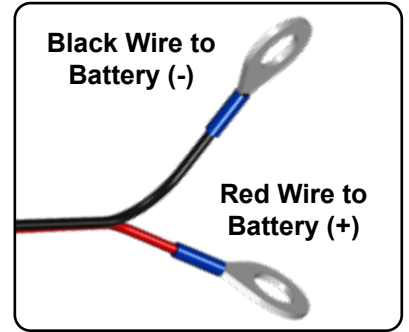

When activated, LED Diagnostic Light will flash once for about 1 second before turning off indicating proper function. If different patterns occur, contact SuperATV.

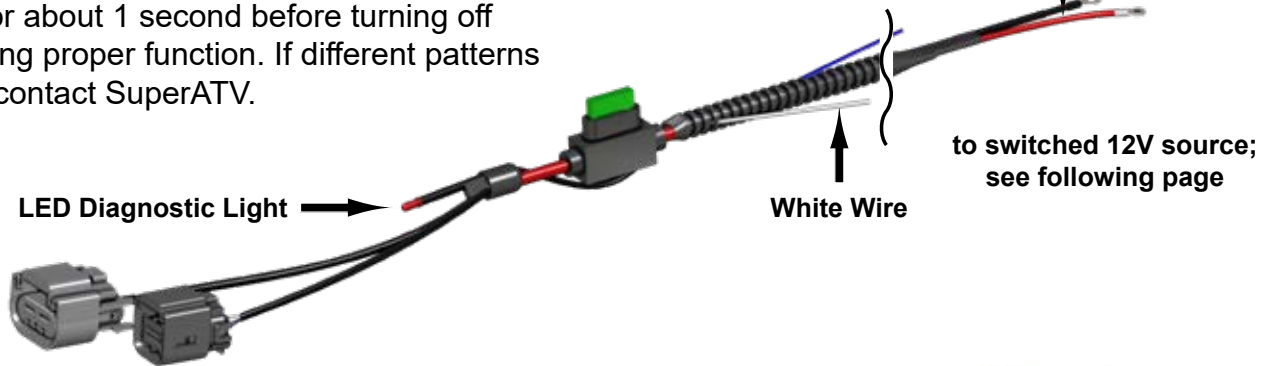

Plug into ECU

ECU Functions

| Plug | Function |
|------|--|
| A | Motor |
| B | Main Power and Ground |
| C | No Contact Sensor |
| D | Key-On Power, Speed Sensor Wire, and LED |

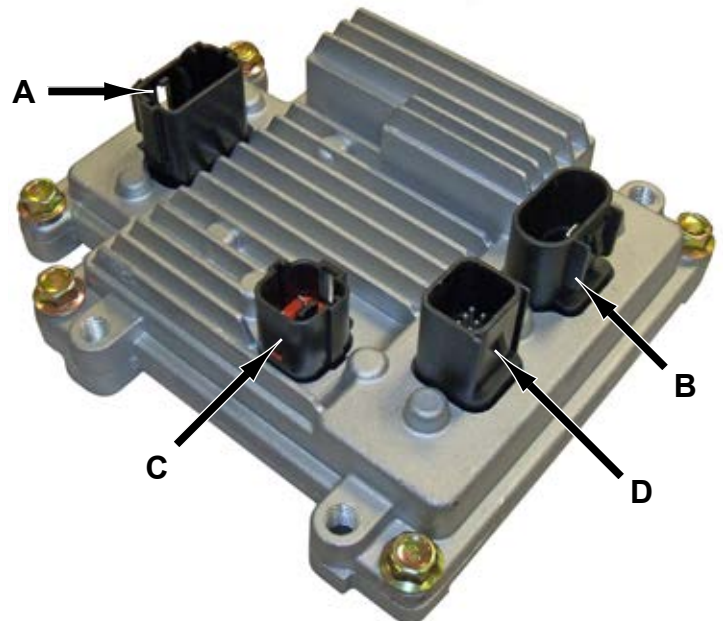

Wiring Details continued

- Wire Switched 12V Source (white wire) into stock Terminal Block. Use provided Connectors (K).

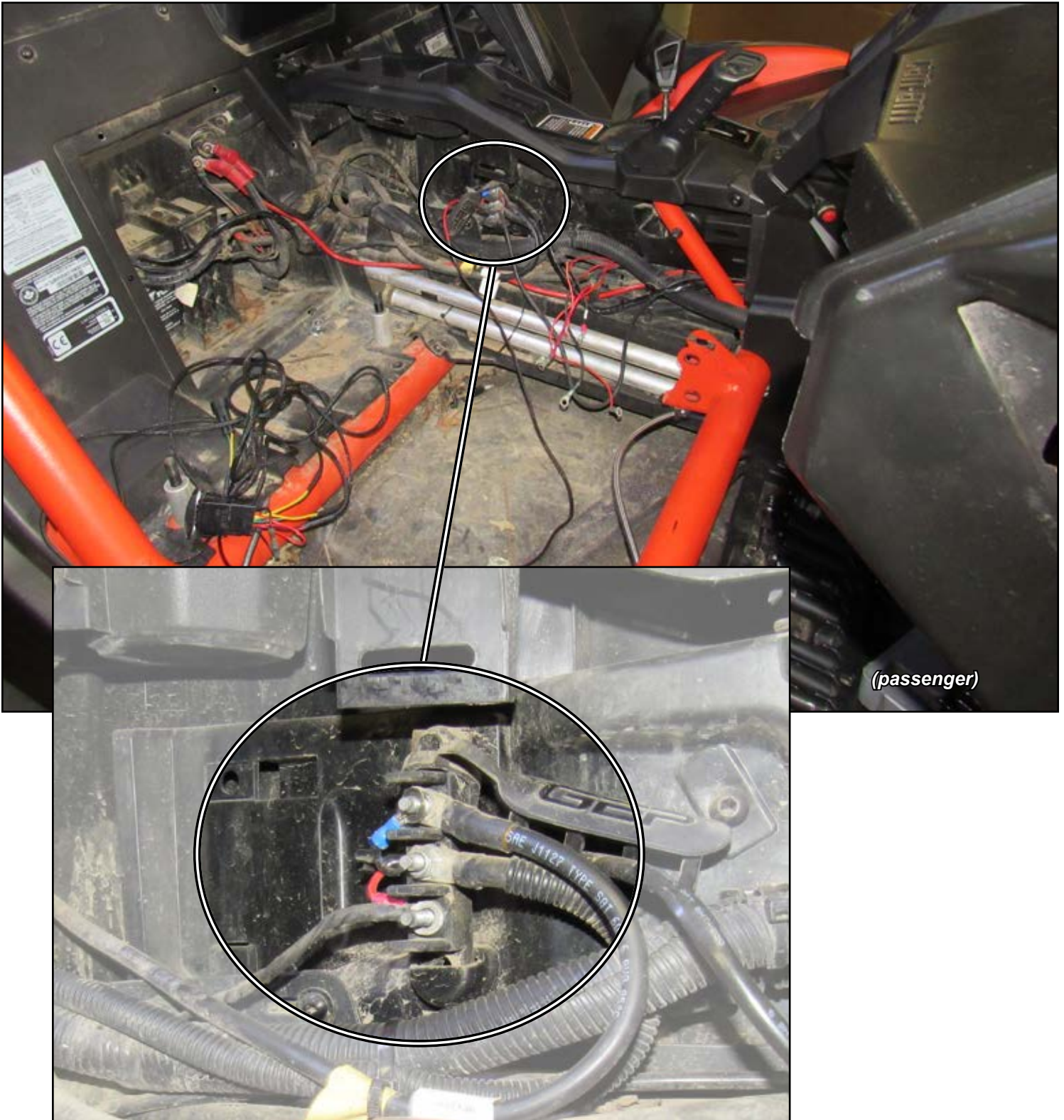

- Reinstall previously removed stock components.