

INSTALLATION INSTRUCTIONS

(Universal)

Fairlead Auto-off Switch: WN-FL-AS

- ⓘ Please look through and read these instructions BEFORE starting so you understand what processes you'll be doing, and possible extra tools you may need.
- ⓘ Do Not discard product packaging until installation is complete and functioning properly.

NOTE: *These instructions are for an Upgrade Kit for vehicles that already have a winch in stalled on the machine, and will not be showing how to install the Winch itself. Please reference the Winch Kit instructions for those procedures.*

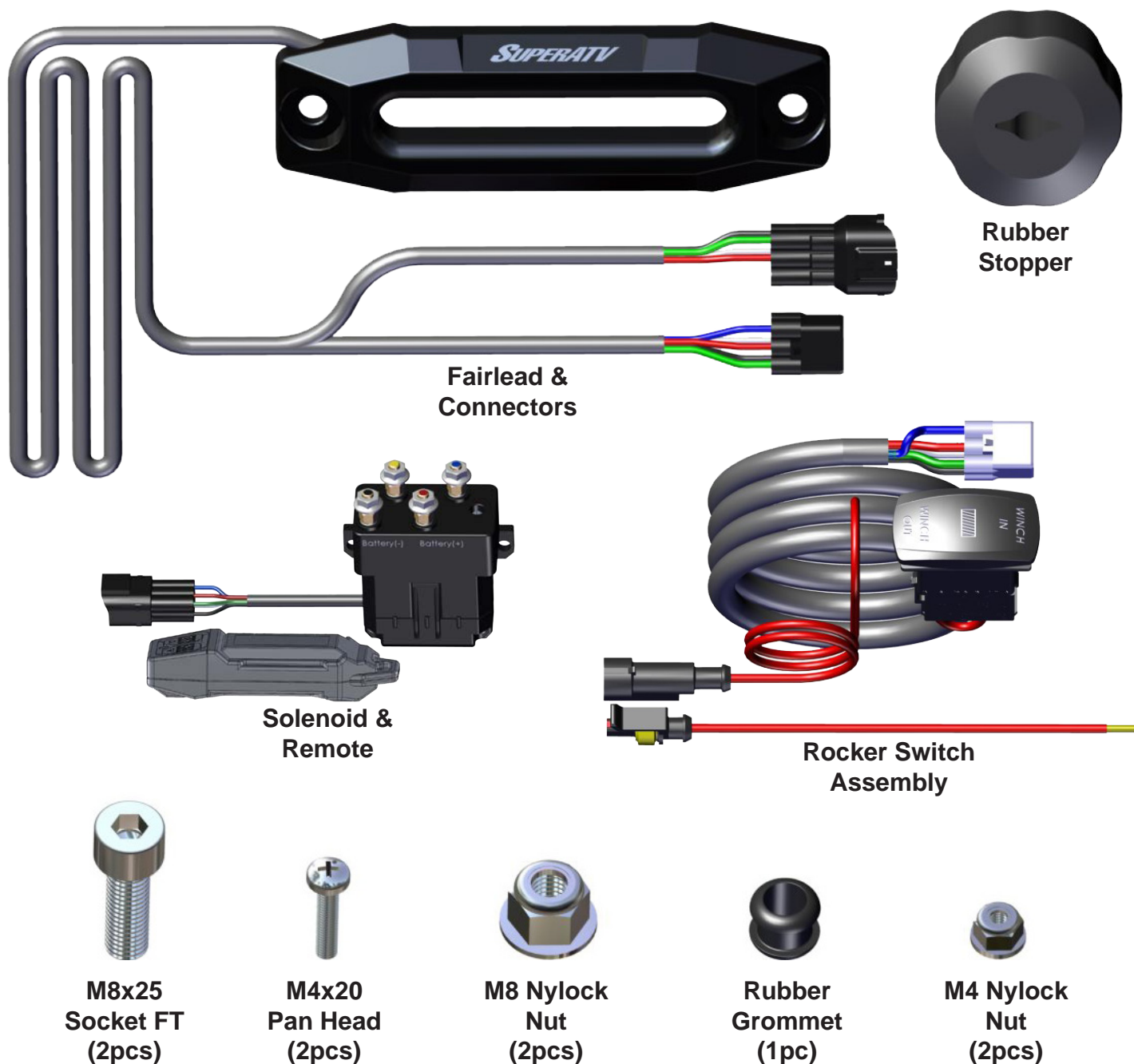

Reference Connection Diagram



1. The first thing you need to do is **Disconnect the Battery** to prevent any electrical issues. Then, you will **Remove the Hook and Rubber Bumper** from your existing winch. See **Fig.1a-b**.

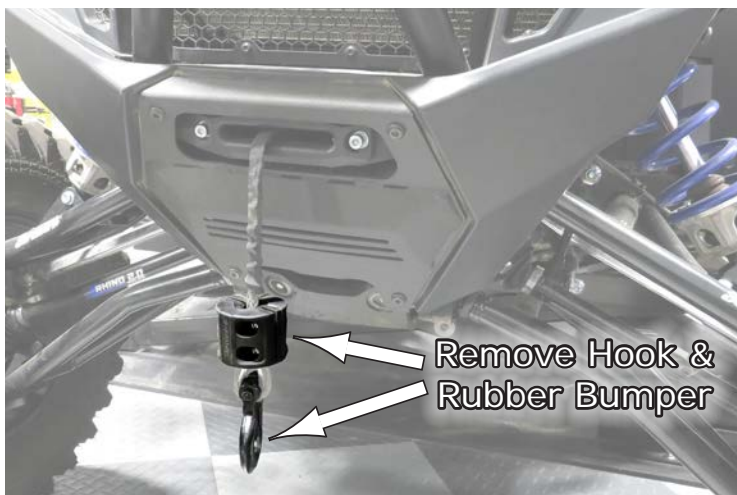

Fig.1a

Fig.1b

2. Then **Remove** the **Four (4) Screws** holding the **Winch Cover** on and **Remove** the **Cover**. See **Fig.2a-b**.



Fig.2a



Fig.2b

3. Now you will remove the **Face Guard** from the vehicle but removing the **Screws** on the outside edges and where attached to the vehicle. Keep as you will reuse them. See **Fig.3a-b**.



Fig.3a



Fig.3b

4. Now **Remove** the **Face Guard** from the vehicle and set aside. Now you will have room for the installation next.



Fig.4



5. The next thing you need to **Remove** is the **Fairlead Bolts** to **Remove** the existing **Fairlead**. Once the bolts are out, slide the **Fairlead** & existing **Spacer Plate** off the rope. See **Fig.5a-c**.



Fig.5a



Fig.5b

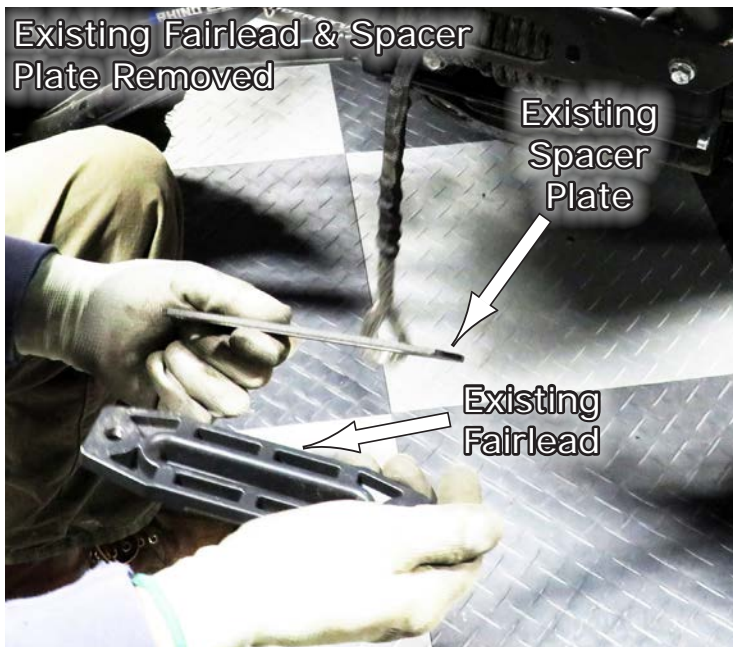
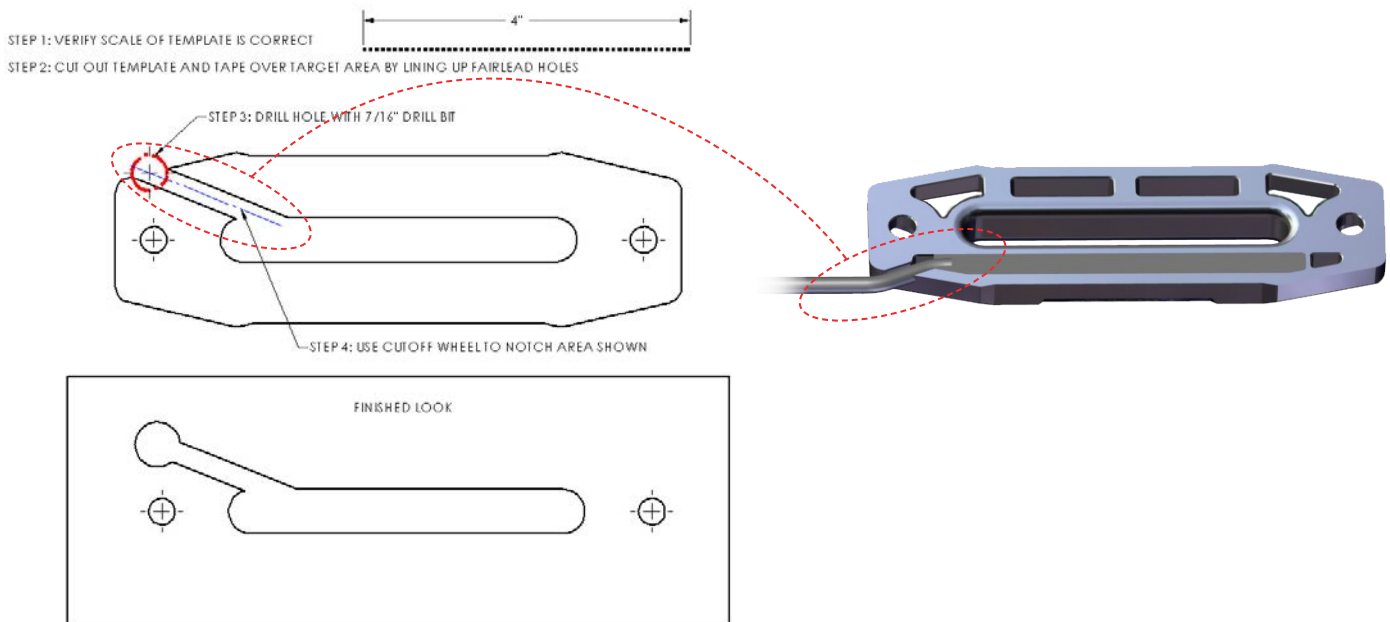

Fig.5c

NOTE: Keep Spacer Plate as you will need to modify it to accommodate the wires coming out of the New Fairlead next.

Modifying Your Spacer Plate

To modify the Spacer Plate to use it with your New Fairlead, you will need to use the paper cut-out template at the end of these instructions. Below is what this page looks like and how the Fairlead will fit when using it. Copy or cut this page out and use the outline template to match the two (2) holes in the Spacer Plate, then mark and cut the slot in the Spacer Plate. This slot will give room for the cable coming out of the Fairlead to sit down into when mounting it to the vehicle. Do not use this illustration for the template but the whole page actual size template at the end of the instructions. Modify the Spacer Plate before continuing on.



6. Then, install the **Modified Spacer Plate** onto the rope and then the **New Fairlead** with cable as shown in **Fig.6a-b**.



Fig.6a

Fig.6b

7 .Now you need to **Remove** the **Front Grill** and set aside as shown in **Fig.7a-b**.



Fig.7a



Fig.7b

8. Then **Route** the **New Fairlead Wires** up thru the **Bumper** and out as shown in **Fig.8a-b**. Then connect **Female End** of the Fairlead cable to the **Male End** of the **Switch Cable Connector**, and the other Connector from the Fairlead will go to the New Solenoid in the next steps. See **Fig.8a-e**.



Fig.8a



Fig.8b



Fig.8c



Fig.8d

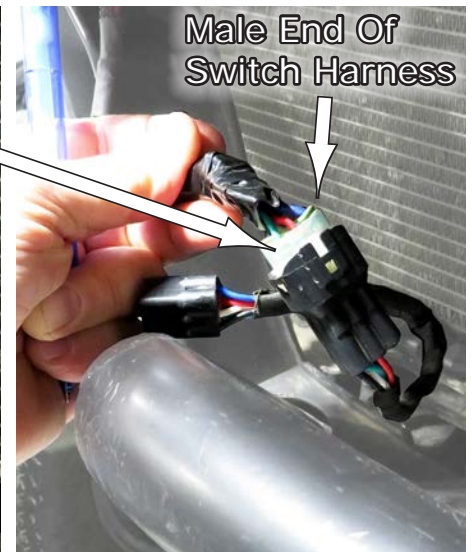

Fig.8e

9. Now, find the **Existing Winch Solenoid**, see **Fig.9a**, and disconnect it completely. Then find your **New Solenoid** and connect it to the same cables you removed from the previous solenoid as shown in **Fig.9a**. Notice you will have one **Female Connector** cable coming out of the **New Solenoid**, also shown in **Fig.9b**. This will connect to the Male Connector from the Fairlead Harness.



Fig.9a



Fig.9b

10. Hook Up the **New Solenoid** to the Fairlead Connector, as shown in **Fig.10a**, you will need to feed the **Fairlead Connector** back down to the underneath side from the front corner of the grill, as shown in **Fig.10b-c**, where the Solenoid is mounted at, and connect them there or in a place hidden out of view. This was where we chose to connect them at. Then mount the Solenoid secure.



Fig.10a

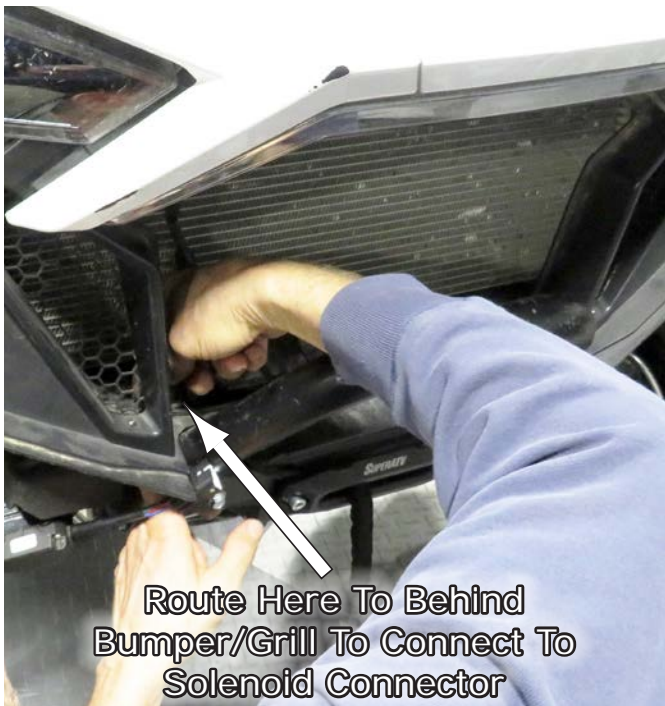

Fig.10b



Fig.10c

11. After the **Solenoid** is mounted secure, you can now route the **Winch Switch** to your dash area. To do this you will need to feed it from where you plugged it into the **Fairlead** to the **Firewall** where you'll see a **Large Rubber Grommet** in the **Firewall**. **Fig.11a-b**, then push the **Switch** thru the **Grommet** to the inside of the **Cab Area** as shown in **Fig.11c**.

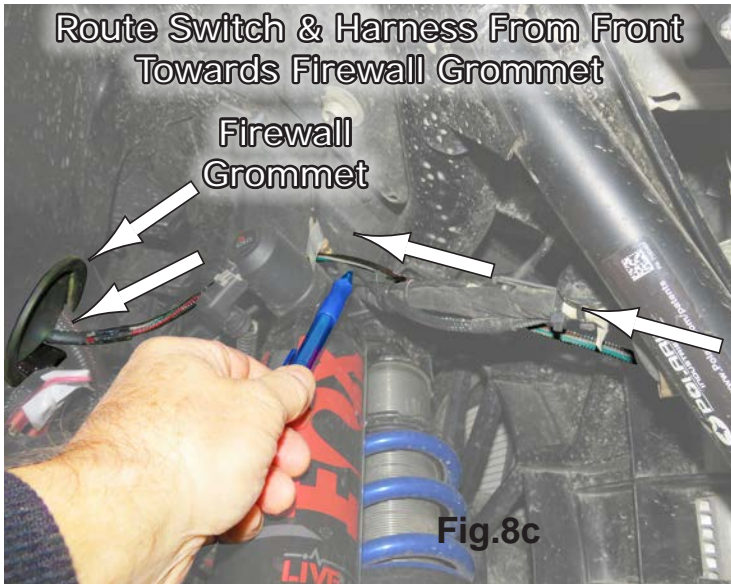

Fig.11a



Fig.11b

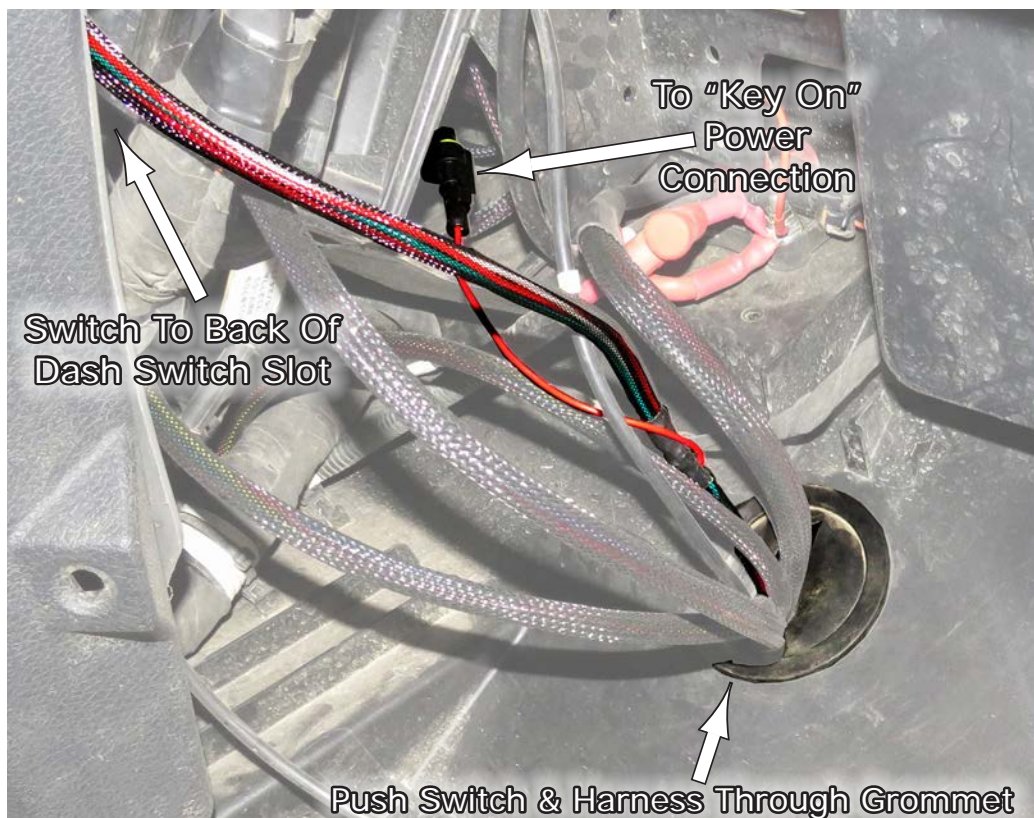

Fig.11c

12. Next, you will need to hook the **Red Wire** stripped on the end to a “**Key On**” **Power Supply** source somewhere on the vehicle. We have chosen to use an existing connector, unused, to tap into for the power supply. So we routed the **Red Wire** to the area under the front console area as shown in **Fig.12a-b**, and tapped into it there. You can choose where to hook this up on your machine.

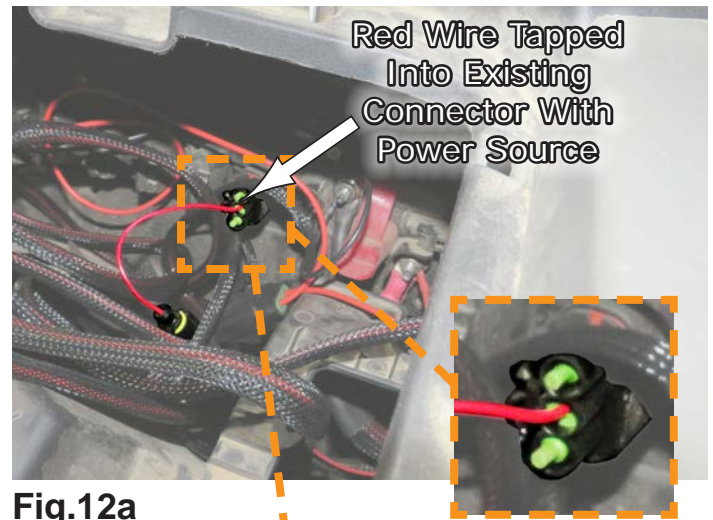

Fig.12a

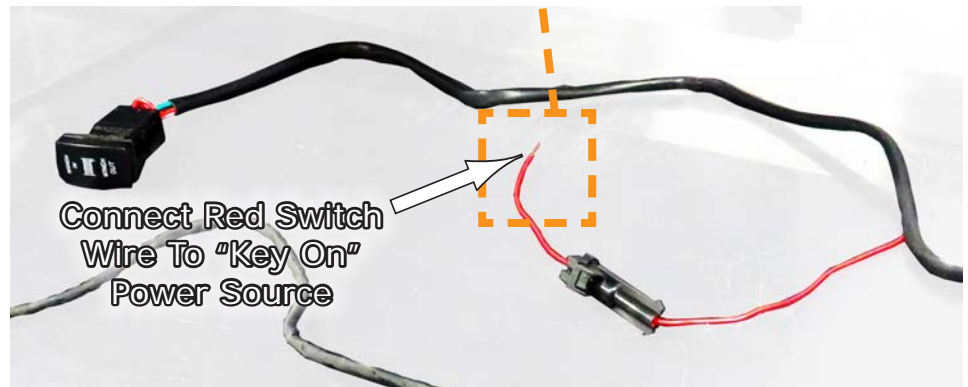

Fig.12a

13. After the Power is hooked up the Switch, now select a **Switch Slot** in the **Front Dash Panel** and push the **Switch Connector** thru it from the back side and reconnect the **Rocker Switch** to the **Connector** as shown in **Fig.13a-b**. Leave it hanging out of the slot until you have tested the system as working correctly so you won't have to remove it from the dash, in case you have to make any adjustments to the switch or cable.



Fig.13a



Fig.13a

14. Next, you will need to install the **New Rubber Stopper**. To do that, you will need to remove the metal insert at the end of the rope where the Hook attaches to. **Fig.14a** shows removing this insert. Keep as you will be reinstalling it in the next steps. Now you can install the **New Stopper** from you kit. The easiest way is to get a piece of strong wire and tie it onto the end of the rope loop as shown in **Fig.14b**, run the wire through the **New Stopper**, then push the stopper onto the rope while pulling on the wire to help you force it onto rope. Then replace the **Metal Insert** into the rope loop as shown in **Fig.14c**, and then reinstall the **Hook** and Bolt.

Once the Hook is finished, then reinstall all other items the may have been removed from the vehicle to perform these instructions.



Fig.14a

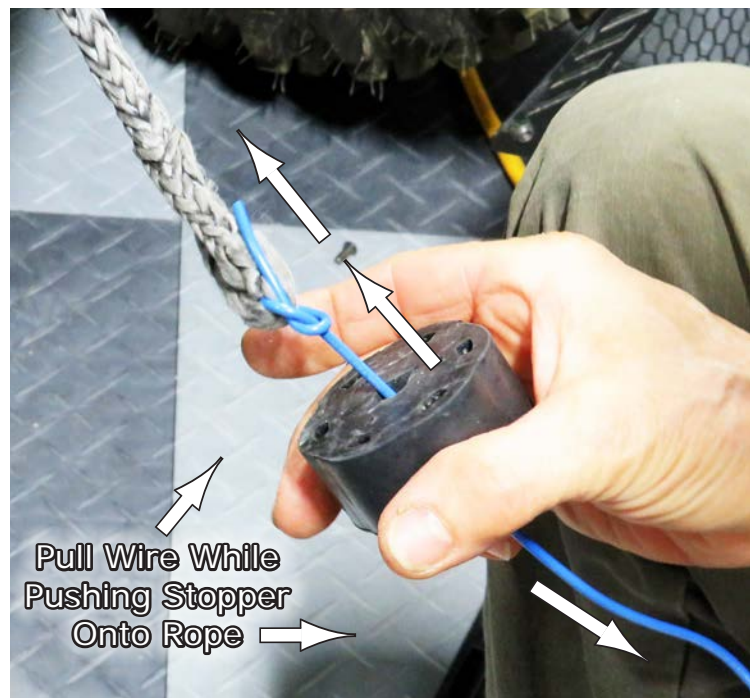

Fig.14b



Fig.14c

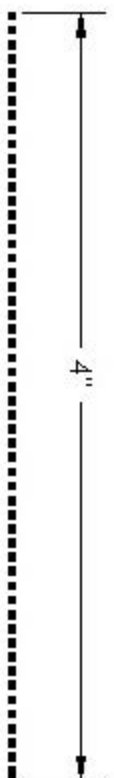

Fig.14d

NOTE: Cut and use THIS template for correct scale. If you decide to make a copy of this page, BE SURE you copy at 100% with no "Fit" or "Scaling" as this will change the size and hole spacing!

STEP 1: VERIFY SCALE OF TEMPLATE IS CORRECT

STEP 2: CUT OUT TEMPLATE AND TAPE OVER TARGET AREA BY LINING UP FAIRLEAD HOLES



STEP 3: DRILL HOLE WITH 7/16" DRILL BIT

STEP 4: USE CUTOFF WHEEL TO NOTCH AREA SHOWN

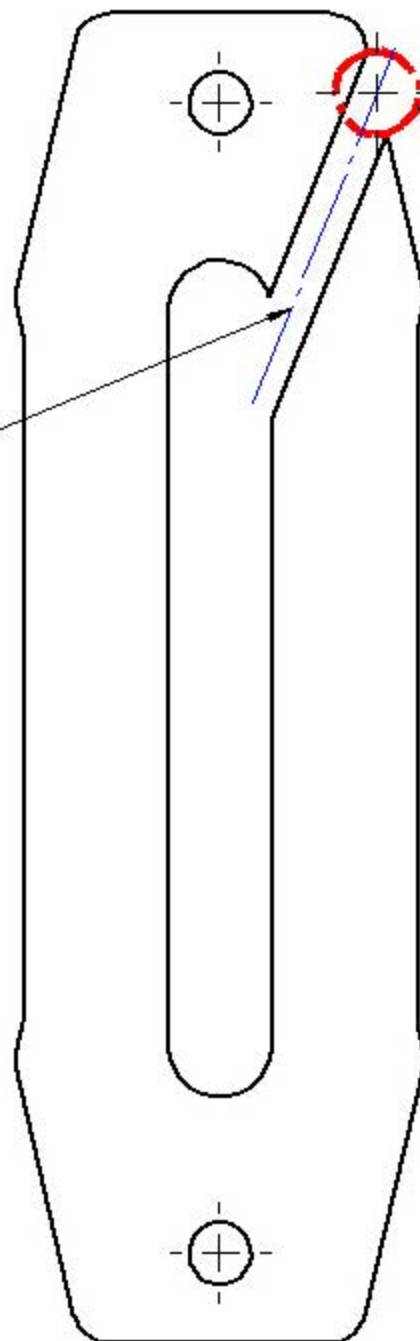

FINISHED LOOK





Liability Statement

SuperATV's® products are designed to best fit user's ATV/UTV under stock conditions. Adding, modifying, or fabricating any factory or aftermarket parts will void any warranty provided by SuperATV® and is not recommended. SuperATV's® products could interfere with other aftermarket accessories. If user has aftermarket products on machine, contact SuperATV® to verify that they will work together.

Although SuperATV® has thousands of satisfied customers, user should be aware that installing lift kits, long travel, or suspension kits, tires, etc. will change the ride of machine and may increase maintenance and part wear. Operating any off-road machine while, or after, consuming alcohol and/or drugs increases risk of bodily harm or death. No warranty or representation is made as to this product's ability to protect user from severe injury or death. SuperATV® urges operators and occupants to wear a helmet and appropriate riding gear at all times.

By purchasing and installing SuperATV® products, user agrees that should damages occur, SuperATV® will not be held responsible for loss of time, use, labor fees, replacement parts, or freight charges. SuperATV®, nor any 3rd party, will not be held responsible for any direct, indirect, incidental, special, or consequential damages that result from any product purchased from SuperATV®. The total liability of seller to user for all damages, losses, and causes of action, if any, shall not exceed the total purchase price paid for the product that gave rise to the claim.

SuperATV® will warranty only parts provided by SuperATV®. Any damage or problems with OEM housings, bearings, seals, or other manufacturers' products will not be covered by SuperATV®. SuperATV® parts and products are not warrantied if item was not installed properly, misused, or modified.

Installing, adding, modifying, or fabricating any factory or aftermarket product to your ATV/UTV may violate certain local, state, and federal laws. Be advised that laws vary depending on town, city, county, state, etc. Use of certain products on public streets, roads, or highways may be in violation law. The Buyer is solely and exclusively legally and personally responsible for any violation of the law by the installation or use of the product. You must abide by all local, state, and federal laws, including but not limited to vehicle safety, traffic laws, and ordinances. It is your responsibility to know the laws and how they apply to you.

The Buyer is responsible to fully understand the capability and limitations of his/her vehicle according to manufacturer specifications, warnings and instructions and agrees to hold SuperATV® harmless from any damage resulting from failure to adhere to such specifications, warnings and/ or instructions. The Buyer is also responsible to obey all applicable federal, state, and local laws and ordinances when operating his/her vehicle while using this product, and the Buyer agrees to hold SuperATV® harmless from any violation thereof.

If you have any problems/questions on this kit, contact us by email
at Superatv.com.

Need help with your installation?



sales@superatv.com



www.superatv.com



1-855-743-3427



8:00am - 9:00pm EST M-Th
8:00am - 7:00pm EST Friday
9:00am - 2:00pm EST Saturday

*Thank You
For Choosing*



Like SuperATV on Facebook to keep up to date on new products!