



# **Polaris Xpedition Plow Mount MA11708**

INSTALLATION INSTRUCTIONS

Thank you for purchasing a DENALI Plow Mount.  
You now own a premium, custom mount to allow you to use your plow with your ATV.  
**Please note the following instructions and heed all warnings.**



- Your ATV and plow system can cause death or injury. Please use caution and common sense when operating your unit.
- Read your Plow Operator Manual, your Winch Operator Manual, and all warning labels before operating your ATV.
- Operate your ATV at a walking speed with the blade installed. Do not exceed 5mph (8km/h) even with the blade up.
- Do not operate the ATV on slopes greater than 10 degrees with the plow installed.
- Always lower the plow to the down position before leaving your ATV unattended.

**SEVERE INJURY OR DEATH MAY RESULT IF YOU ARE NEGLIGENT.**

## PARTS LIST

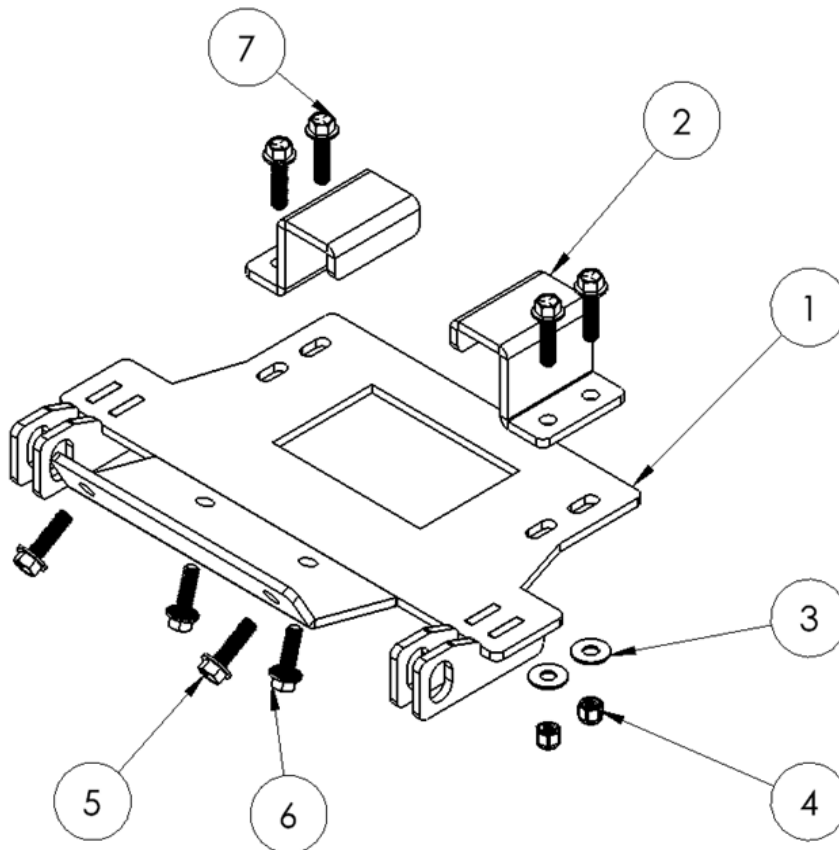

Please verify that all hardware and parts are included in your package.

Part#	Qty	Item Description
1	1	MA11708-1
2	4	MA11708-2
3	4	3/8 Washer
4	4	3/8 - 16 Nylock Nut
5	2	M10-1.5x35mm Serrated Flange Bolt
6	2	3/8 - 16x1.25 Serrated Flange Bolt
7	4	3/8 - 16x1.5 Serrated Flange Bolt

**Figures Color Key** |  Parts native to the machine  Parts native to DENALI Plow Mount

## INSTALLATION INSTRUCTIONS

1. Remove the two front bumper M10 Bolts. *Figure 1*

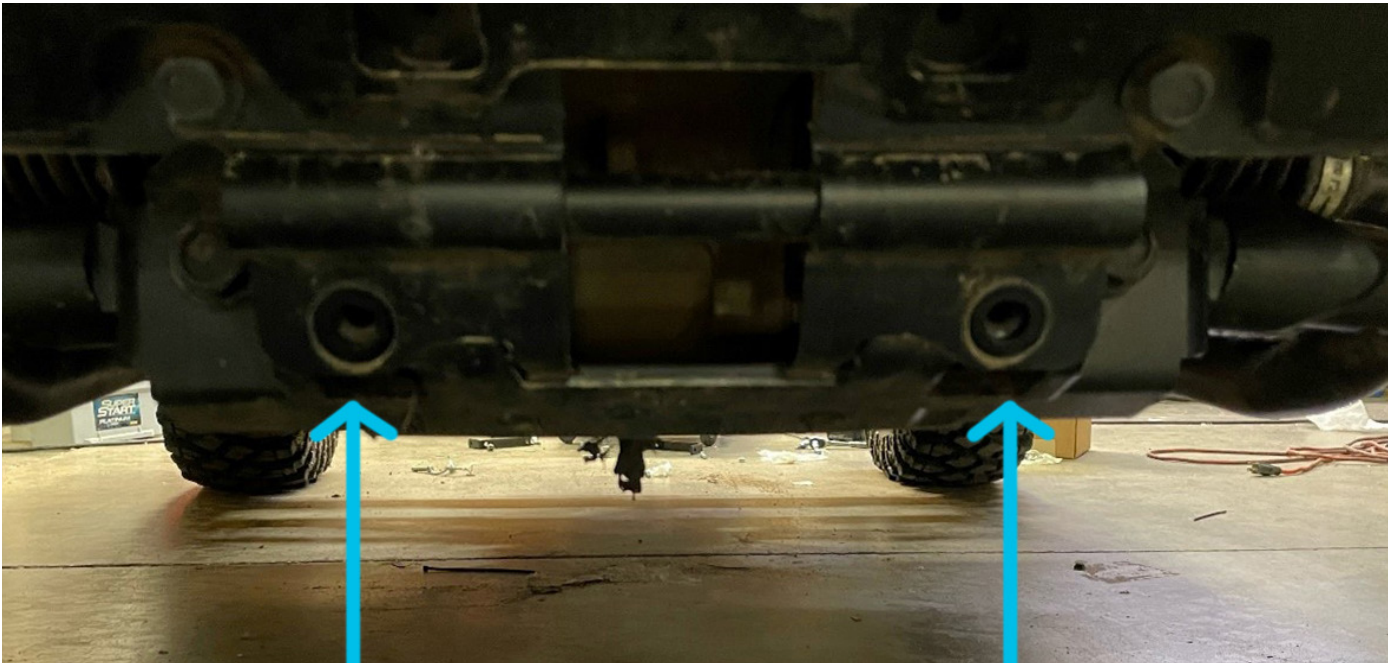

2. Place Mount up to machine and loosely connect provided M10 Hardware.
3. Place MA11708-2 Brackets over the frame and connect the 3/8 - 16x1.5" hardware. *Figure 2*





4. Use the 3/8 - 16x1.25 Serrated flange bolt to secure the mount to the frame. *Figure 3*

